

F.A.U. RTE.	SECTION	COUNTY	TOTAL SHEETS	SHEET NO.
0085	00-00246-02-FP	MCHENRY	292	062
STA.		TO STA.		
FED. ROAD DIST. NO. 1 ILLINOIS FED. AID PROJECT				
CONTRACT NO: 63522				

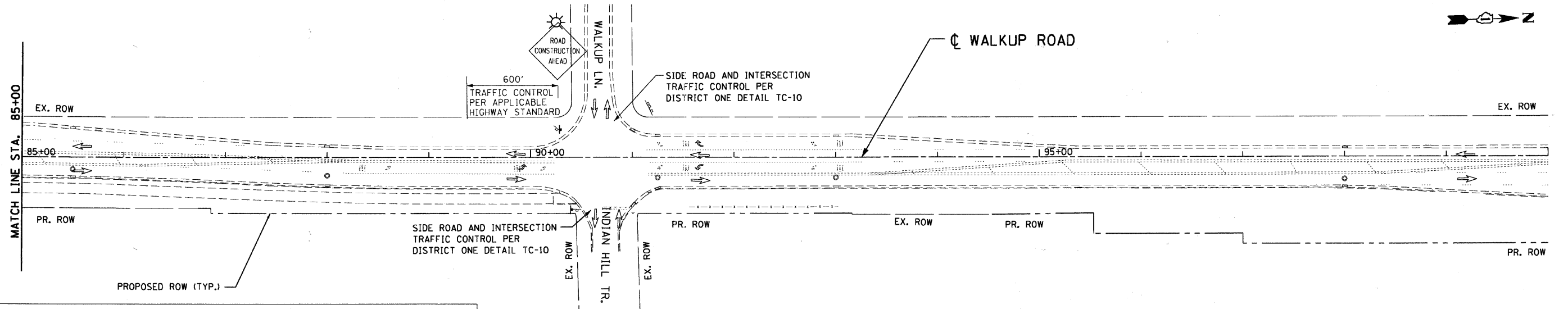
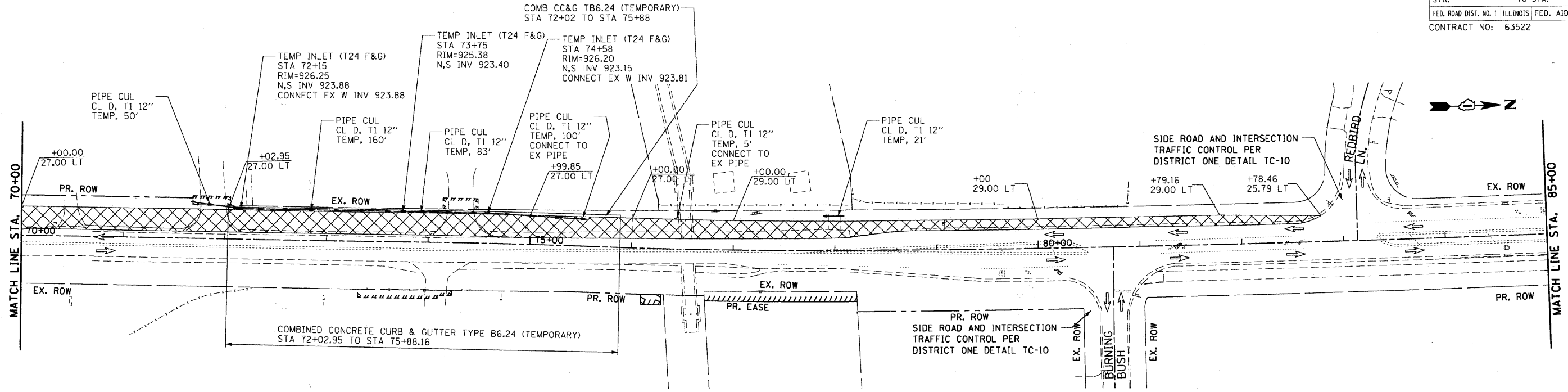

LEGEND

- WORK AREA
- TEMPORARY PAVEMENT
- BARRICADE, TYPE III, W/ TY A FLASHER
- PREVIOUS TRAFFIC PATTERN
- PR TRAFFIC PATTERN
- SIGN
- VERTICAL PANEL W/ STEADY BURNING LIGHT
- DRUMS WITH STEADY BURNING LIGHT @ 50' C-C
- TYPE B MONODIRECTIONAL FLASHING LIGHT

REVISIONS	
NAME	DATE

MCHENRY COUNTY DIVISION OF TRANSPORTATION
WALKUP ROAD F.A.U. 0085

MOT & PRESTAGE CONSTRUCTION
WALKUP ROAD
STA 70+00 TO STA 100+00

SCALE: 1" = 50'
DATE: 06/10/11

DRAWN BY: CC
CHECKED BY: KA

TENG
TENG & ASSOCIATES, INC.
ENGINEERS/ARCHITECTS/PLANNERS
200 N. ROSELAND AVE. CHICAGO, IL 60608
TELEPHONE: 312.467.4000

\\P021A002.DGN, \\P021A004.DGN, \\P021A005.DGN, \\P021A006.DGN, \\P021A007.DGN, \\P021A008.DGN, \\P021A009.DGN, \\P021A010.DGN, \\P021A011.DGN, \\P021A012.DGN, \\P021A013.DGN, \\P021A014.DGN, \\P021A015.DGN, \\P021A016.DGN, \\P021A017.DGN, \\P021A018.DGN, \\P021A019.DGN, \\P021A020.DGN, \\P021A021.DGN, \\P021A022.DGN, \\P021A023.DGN, \\P021A024.DGN, \\P021A025.DGN, \\P021A026.DGN, \\P021A027.DGN, \\P021A028.DGN, \\P021A029.DGN, \\P021A030.DGN, \\P021A031.DGN, \\P021A032.DGN, \\P021A033.DGN, \\P021A034.DGN, \\P021A035.DGN, \\P021A036.DGN, \\P021A037.DGN, \\P021A038.DGN, \\P021A039.DGN, \\P021A040.DGN, \\P021A041.DGN, \\P021A042.DGN, \\P021A043.DGN, \\P021A044.DGN, \\P021A045.DGN, \\P021A046.DGN, \\P021A047.DGN, \\P021A048.DGN, \\P021A049.DGN, \\P021A050.DGN, \\P021A051.DGN, \\P021A052.DGN, \\P021A053.DGN, \\P021A054.DGN, \\P021A055.DGN, \\P021A056.DGN, \\P021A057.DGN, \\P021A058.DGN, \\P021A059.DGN, \\P021A060.DGN