

F.A.U. RTE.	SECTION	COUNTY	TOTAL SHEETS	SHEET NO.
0085	00-00246-02-FF	MCHENRY	292	064
STA.	TO STA.			
FED. ROAD DIST. NO. 1	ILLINOIS	FED. AID PROJECT		
CONTRACT NO: 63522				

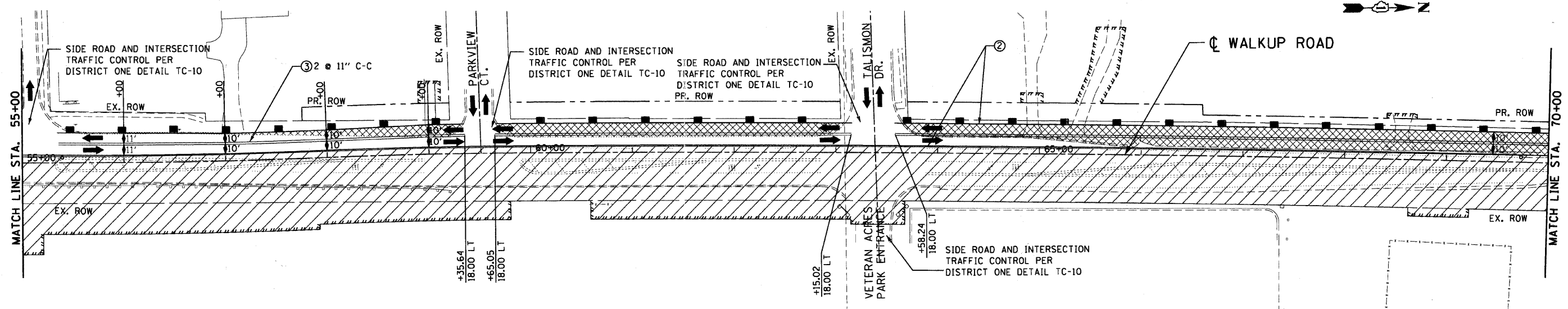
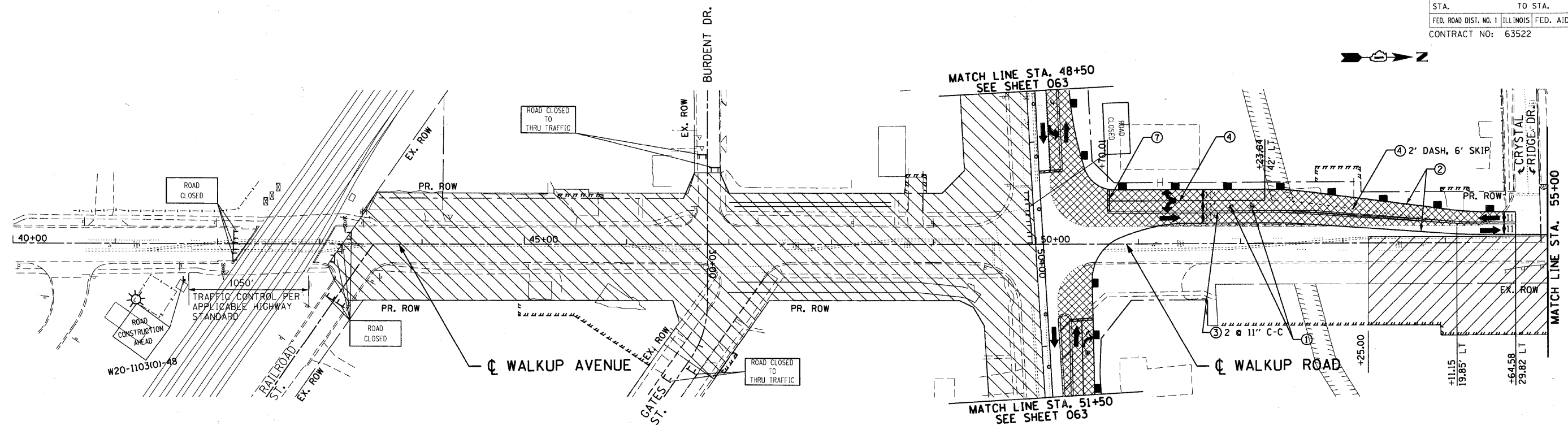

LEGEND

- WORK AREA
- TEMPORARY PAVEMENT
- TEMPORARY PAVEMENT FROM PREVIOUS STAGE
- BARRICADE, TYPE III, W/ TY A FLASHER
- PREVIOUS TRAFFIC PATTERN
- PR TRAFFIC PATTERN

- SIGN
- VERTICAL PANEL W/ STEADY BURNING LIGHT
- BARRICADE OR DRUMS
- TYPE B MONODIRECTIONAL FLASHING LIGHT

PAVEMENT MARKING LEGEND

- ① TEMPORARY PAVEMENT MARKING - LETTERS AND SYMBOLS
- ② TEMPORARY PAVEMENT MARKING - LINE 4 inch (WHITE)
- ③ TEMPORARY PAVEMENT MARKING - LINE 4 inch (YELLOW)
- ④ TEMPORARY PAVEMENT MARKING - LINE 6 inch (WHITE)
- ⑤ TEMPORARY PAVEMENT MARKING - LINE 8 inch (YELLOW)
- ⑥ TEMPORARY PAVEMENT MARKING - LINE 12 inch (YELLOW)
- ⑦ TEMPORARY PAVEMENT MARKING - LINE 24 inch (WHITE)

REVISIONS	
NAME	DATE

MCHENRY COUNTY DIVISION OF TRANSPORTATION
WALKUP ROAD F.A.U. 0085

**MOT & STAGE 1 CONSTRUCTION
WALKUP ROAD
STA 40+00 TO STA 70+00**

SCALE: 1" = 50'
DATE: 06/10/11
DRAWN BY: CC
CHECKED BY: KA



TENG & ASSOCIATES, INC.
ENGINEERS/ARCHITECTS/PLANNERS
305 N. MICHIGAN AVE. CHICAGO, IL 60601
TELEPHONE: 312.467.4000

\\s01\eng\04\m\walkup\1.d - TRANS_07_2202_300-03\CIVIL\CAD\02_CONTRACT\11\TENG\SHEET\MOT02IA02.SHT
 6-09-2011 16:36:34
 \\s01\eng\04\m\walkup\1.d - TRANS_07_2202_300-03\CIVIL\CAD\02_CONTRACT\11\TENG\SHEET\MOT02IA02.SHT
 2 3 4 5 6 7 8 9 10 11 12 13 14 15 16 17 18 19 20 21 22 23 24 25 26 27 28 29 30 31 32 33 34 35 36 37 38 39 40 41 42 43 44 45 46 47 48 49 50 51 52 53 54 55 56 57 58 59 60 61 62 63