

F.A.U. RTE.	SECTION	COUNTY	TOTAL SHEETS	SHEET NO.
0085	00-00246-02-FP	MCHENRY	292	149
STA.		TO STA.		
FED. ROAD DIST. NO. 1		ILLINOIS FED. AID PROJECT		
CONTRACT NO: 63522				

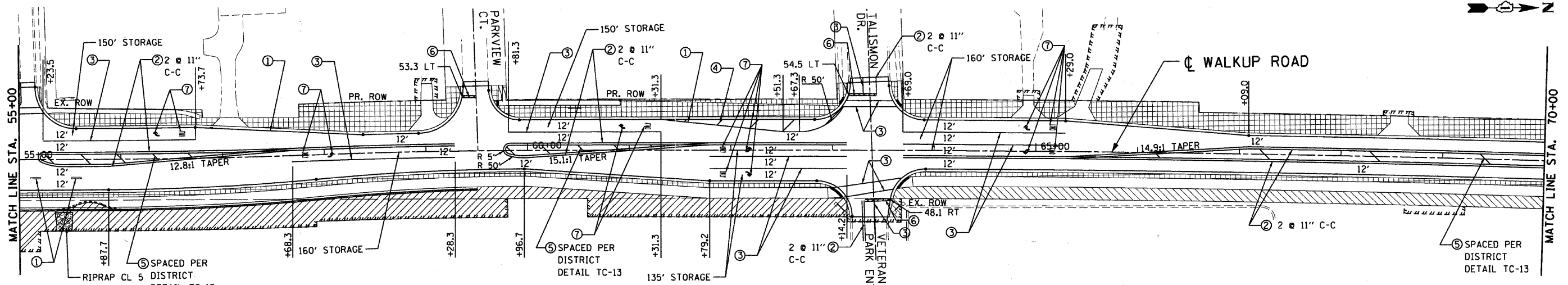
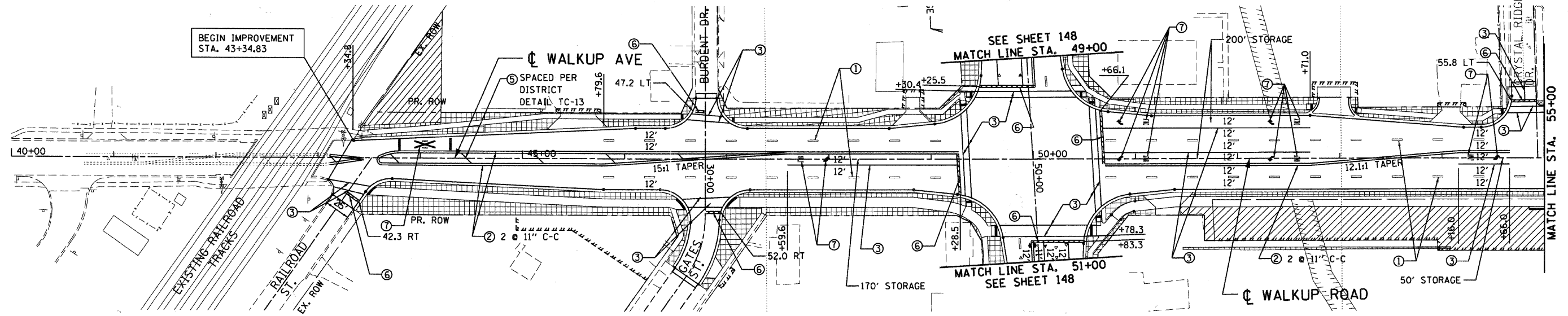

LANDSCAPING LEGEND

- TOPSOIL F & P 4, SEEDING CL 2A
- SODDING SALT TOLERANT & TURF REINF MAT (SEE DETAIL ON SHEET 154)
- TOPSOIL F & P 4
- TOPSOIL F & P 4, SEEDING CL 4A
- TOPSOIL F & P 8, SEEDING CL 4B MODIFIED
- STONE RIPRAP

PAVEMENT MARKING LEGEND

- ① THERM MK LINE 4" (WHITE) ◀ ONE-WAY AMBER MARKER
 - ② THERM MK LINE 4" (YELLOW) ◀ ONE-WAY CRYSTAL MARKER
 - ③ THERM MK LINE 6" (WHITE) (W/O)
 - ④ THERM MK LINE 12" (WHITE) ▶ TWO-WAY AMBER MARKER
 - ⑤ THERM MK LINE 12" (YELLOW)
 - ⑥ THERM MK LINE 24" (WHITE)
 - ⑦ THERM MK L&S
- PAVEMENT MARKING TO FOLLOW IDOT D1 DETAIL TC-13
- EROSION CONTR BLANKET OR HD EROSION CONTR BLANKET FOR ALL SEEDING (SEE DETAIL ON SHEET 154)

REVISIONS	
NAME	DATE

MCHENRY COUNTY DIVISION OF TRANSPORTATION
WALKUP ROAD F.A.U. 0085

PAVT MARKING & LANDSCAPING
WALKUP ROAD
STA 40+00 TO STA 70+00

SCALE: 1" = 50' DRAWN BY: KV
DATE: 06/10/11 CHECKED BY: MCD

TENG TENG & ASSOCIATES, INC.
ENGINEERING ARCHITECTS
305 N. MICHIGAN AVE. CHICAGO, IL 60601
TELEPHONE: 312-666-0000

I:\A02\A02.DGN, I:\B02\B02.DGN, I:\C02\C02.DGN, I:\D02\D02.DGN, I:\E02\E02.DGN, I:\F02\F02.DGN, I:\G02\G02.DGN, I:\H02\H02.DGN, I:\I02\I02.DGN, I:\J02\J02.DGN, I:\K02\K02.DGN, I:\L02\L02.DGN, I:\M02\M02.DGN, I:\N02\N02.DGN, I:\O02\O02.DGN, I:\P02\P02.DGN, I:\Q02\Q02.DGN, I:\R02\R02.DGN, I:\S02\S02.DGN, I:\T02\T02.DGN, I:\U02\U02.DGN, I:\V02\V02.DGN, I:\W02\W02.DGN, I:\X02\X02.DGN, I:\Y02\Y02.DGN, I:\Z02\Z02.DGN, I:\00\00.DGN, I:\01\01.DGN, I:\02\02.DGN, I:\03\03.DGN, I:\04\04.DGN, I:\05\05.DGN, I:\06\06.DGN, I:\07\07.DGN, I:\08\08.DGN, I:\09\09.DGN, I:\10\10.DGN, I:\11\11.DGN, I:\12\12.DGN, I:\13\13.DGN, I:\14\14.DGN, I:\15\15.DGN, I:\16\16.DGN, I:\17\17.DGN, I:\18\18.DGN, I:\19\19.DGN, I:\20\20.DGN, I:\21\21.DGN, I:\22\22.DGN, I:\23\23.DGN, I:\24\24.DGN, I:\25\25.DGN, I:\26\26.DGN, I:\27\27.DGN, I:\28\28.DGN, I:\29\29.DGN, I:\30\30.DGN, I:\31\31.DGN, I:\32\32.DGN, I:\33\33.DGN, I:\34\34.DGN, I:\35\35.DGN, I:\36\36.DGN, I:\37\37.DGN, I:\38\38.DGN, I:\39\39.DGN, I:\40\40.DGN, I:\41\41.DGN, I:\42\42.DGN, I:\43\43.DGN, I:\44\44.DGN, I:\45\45.DGN, I:\46\46.DGN, I:\47\47.DGN, I:\48\48.DGN, I:\49\49.DGN, I:\50\50.DGN, I:\51\51.DGN, I:\52\52.DGN, I:\53\53.DGN, I:\54\54.DGN, I:\55\55.DGN, I:\56\56.DGN, I:\57\57.DGN, I:\58\58.DGN, I:\59\59.DGN, I:\60\60.DGN