

F.A.U. RTE.	SECTION	COUNTY	TOTAL SHEETS	SHEET NO.
0085 00-00246-02-FP		MCHENRY	292	178
STA.	TO STA.	FED. ROAD DIST. NO. 1 ILLINOIS FED. AID PROJECT		
		CONTRACT NO: 63522		

**NOTES:**

1. ALL PEDESTRIAN SIGNAL HEADS SHALL BE BAGGED AND DISCONNECTED AT LOCATIONS WHERE EXISTING PAVEMENT IS REMOVED. ALL PEDESTRIAN SIGNAL HEADS SHALL REMAIN BAGGED UNTIL THE PAVEMENT IS RESTORED TO PROVIDE A SAFE CROSSING AREA. USAGE OF PEDESTRIAN SIGNAL HEADS IS BASED ON CONSTRUCTION STAGING AND SHALL BE DETERMINED BY THE RESIDENT ENGINEER. IF SIDEWALKS AND PED CROSSINGS ARE NOT PROVIDED, THE PEDESTRIAN SIGNAL EQUIPMENT SHALL REMAIN DISCONNECTED UNTIL WARRANTED PRIOR TO PERMANENT SIGNAL TURN-ON.
2. WALKUP AVENUE SOUTH OF IL ROUTE 176 SHALL BE CLOSED TO TRAFFIC DURING STAGE 1.
3. THE NORTHBOUND SIGNAL HEADS SHALL BE COVERED AND THE DETECTION SHALL BE DISCONNECTED DURING STAGE 1.
4. THE WESTBOUND LEFT TURN SIGNAL SECTIONS SHALL BE COVERED AND DISCONNECTED AND DETECTION SHALL BE DISCONNECTED DURING STAGE 1.
5. THE SOUTHBOUND GREEN AND YELLOW LEFT TURN SIGNAL SECTIONS SHALL BE COVERED AND DISCONNECTED AND THE SOUTHBOUND LEFT LANE DETECTOR SHALL PLACE CALLS INTO PHASE 4 DURING STAGE 1.
6. THE SOUTHBOUND NEAR RIGHT AND FAR RIGHT GREEN SIGNAL SECTIONS SHALL BE REPLACED WITH GREEN RIGHT ARROWS AND THE SOUTHBOUND FAR MID MOUNT GREEN SIGNAL SECTION SHALL BE REPLACED WITH A GREEN LEFT ARROW DURING STAGE 1.

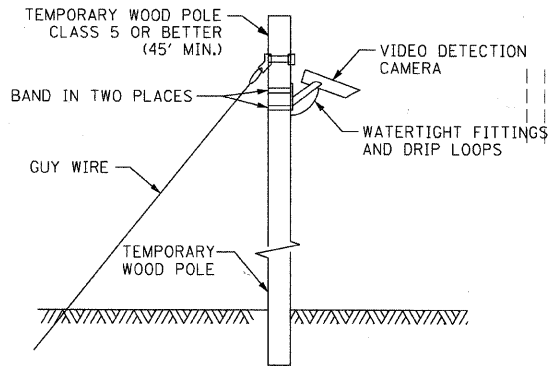

**TEMPORARY VIDEO DETECTION MOUNTING DETAIL**  
(NOT TO SCALE)

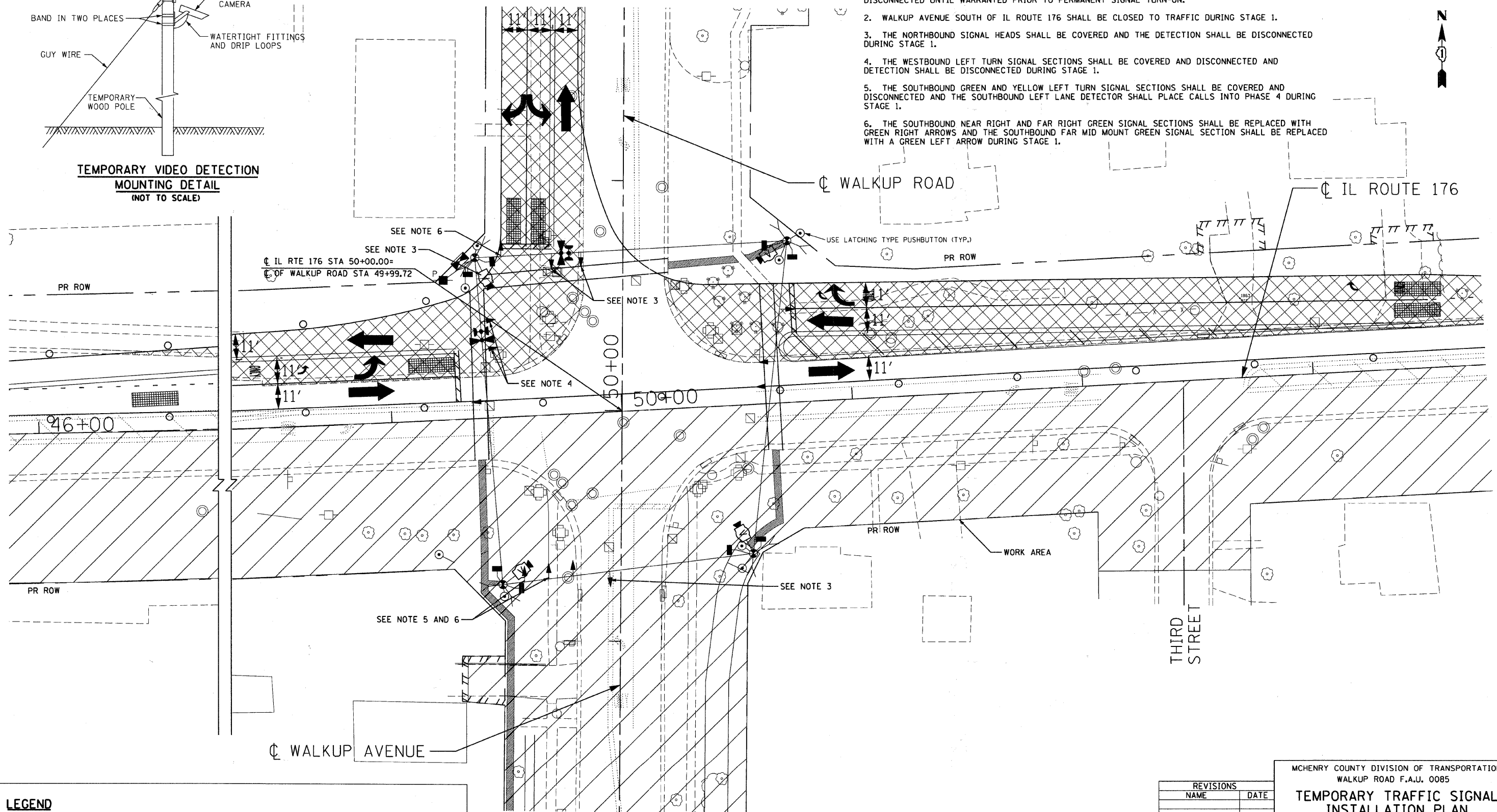

**LEGEND**

- |  |  |  |                          |
|--|--|--|--------------------------|
|  | TEMPORARY SIDEWALK (3' WIDTH)          |  | PREVIOUS TRAFFIC PATTERN |
|  | TEMPORARY PAVEMENT                     |  | PR TRAFFIC PATTERN       |
|  | TEMPORARY PAVEMENT FROM PREVIOUS STAGE |  |                          |

REVISIONS	
NAME	DATE

MCHENRY COUNTY DIVISION OF TRANSPORTATION  
WALKUP ROAD F.A.U. 0085

**TEMPORARY TRAFFIC SIGNAL INSTALLATION PLAN STAGE 1**

IL ROUTE 176 & WALKUP ROAD

SCALE: 1" = 20'      DRAWN BY: SNB  
DATE: 06/10/11      CHECKED BY: RRM

**TENG**  
TENG & ASSOCIATES, INC.  
ENGINEERS/ARCHITECTS/PLANNERS  
800 N. MICHIGAN AVE. CHICAGO, IL 60611  
TELEPHONE: 312.661-6000

C:\P021A001.DGN, ...V\F021A001.DGN, ...V\F021A002.DGN, ...V\F021A003.DGN, ...V\F021A004.DGN, ...V\F021A005.DGN, ...V\F021A006.DGN, ...V\F021A007.DGN, ...V\F021A008.DGN, ...V\F021A009.DGN, ...V\F021A010.DGN, ...V\F021A011.DGN, ...V\F021A012.DGN, ...V\F021A013.DGN, ...V\F021A014.DGN, ...V\F021A015.DGN, ...V\F021A016.DGN, ...V\F021A017.DGN, ...V\F021A018.DGN, ...V\F021A019.DGN, ...V\F021A020.DGN, ...V\F021A021.DGN, ...V\F021A022.DGN, ...V\F021A023.DGN, ...V\F021A024.DGN, ...V\F021A025.DGN, ...V\F021A026.DGN, ...V\F021A027.DGN, ...V\F021A028.DGN, ...V\F021A029.DGN, ...V\F021A030.DGN, ...V\F021A031.DGN, ...V\F021A032.DGN, ...V\F021A033.DGN, ...V\F021A034.DGN, ...V\F021A035.DGN, ...V\F021A036.DGN, ...V\F021A037.DGN, ...V\F021A038.DGN, ...V\F021A039.DGN, ...V\F021A040.DGN, ...V\F021A041.DGN, ...V\F021A042.DGN, ...V\F021A043.DGN, ...V\F021A044.DGN, ...V\F021A045.DGN, ...V\F021A046.DGN, ...V\F021A047.DGN, ...V\F021A048.DGN, ...V\F021A049.DGN, ...V\F021A050.DGN, ...V\F021A051.DGN, ...V\F021A052.DGN, ...V\F021A053.DGN, ...V\F021A054.DGN, ...V\F021A055.DGN, ...V\F021A056.DGN, ...V\F021A057.DGN, ...V\F021A058.DGN, ...V\F021A059.DGN, ...V\F021A060.DGN, ...V\F021A061.DGN, ...V\F021A062.DGN, ...V\F021A063.DGN, ...V\F021A064.DGN, ...V\F021A065.DGN, ...V\F021A066.DGN, ...V\F021A067.DGN, ...V\F021A068.DGN, ...V\F021A069.DGN, ...V\F021A070.DGN, ...V\F021A071.DGN, ...V\F021A072.DGN, ...V\F021A073.DGN, ...V\F021A074.DGN, ...V\F021A075.DGN, ...V\F021A076.DGN, ...V\F021A077.DGN, ...V\F021A078.DGN, ...V\F021A079.DGN, ...V\F021A080.DGN, ...V\F021A081.DGN, ...V\F021A082.DGN, ...V\F021A083.DGN, ...V\F021A084.DGN, ...V\F021A085.DGN, ...V\F021A086.DGN, ...V\F021A087.DGN, ...V\F021A088.DGN, ...V\F021A089.DGN, ...V\F021A090.DGN, ...V\F021A091.DGN, ...V\F021A092.DGN, ...V\F021A093.DGN, ...V\F021A094.DGN, ...V\F021A095.DGN, ...V\F021A096.DGN, ...V\F021A097.DGN, ...V\F021A098.DGN, ...V\F021A099.DGN, ...V\F021A100.DGN