

PLAN	SURVEYED	DATE
	ALIGNED	
	CHECKED	
	BY	
	NO. OF WAYS CHECKED	
	NO.	
	CADD FILE NAME	

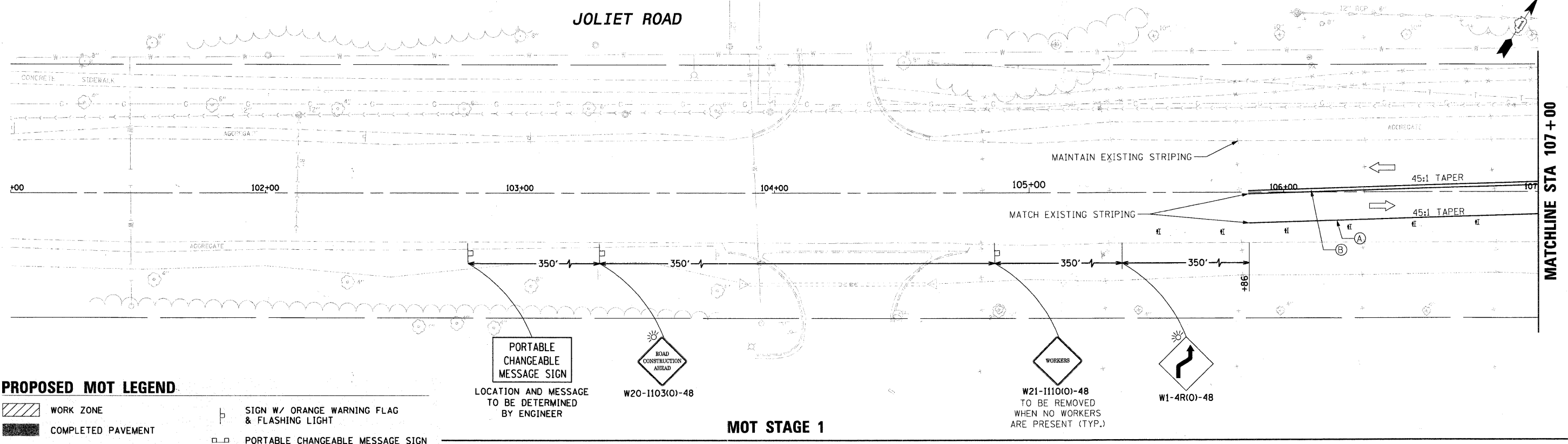

**PROPOSED MOT LEGEND**

- WORK ZONE
- COMPLETED PAVEMENT
- DIRECTION OF TRAFFIC FLOW
- TYPE II BARRICADE OR DRUM
- SIGN W/ ORANGE WARNING FLAG & FLASHING LIGHT
- PORTABLE CHANGEABLE MESSAGE SIGN
- TYPE III BARRICADE WITH TWO FLASHING AMBER LIGHTS
- DIRECTION INDICATOR BARRICADE

PROFILE	SURVEYED	DATE
	ALIGNED	
	CHECKED	
	BY	
	NO. OF WAYS CHECKED	
	NO.	
	CADD FILE NAME	

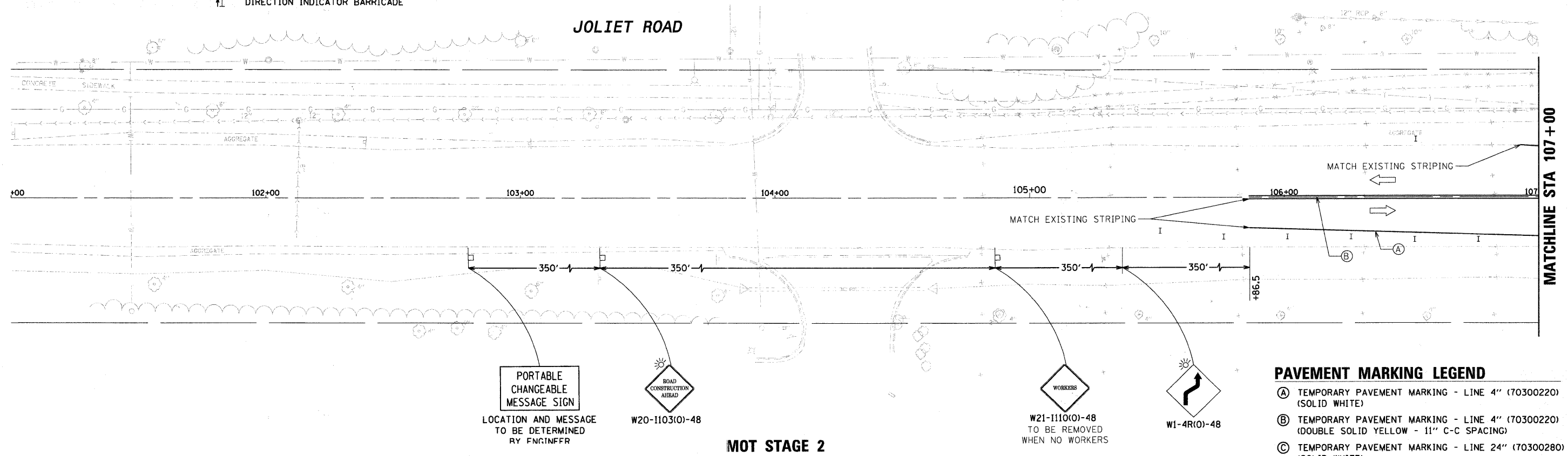

**PAVEMENT MARKING LEGEND**

- (A) TEMPORARY PAVEMENT MARKING - LINE 4" (70300220) (SOLID WHITE)
- (B) TEMPORARY PAVEMENT MARKING - LINE 4" (70300220) (DOUBLE SOLID YELLOW - 11" C-C SPACING)
- (C) TEMPORARY PAVEMENT MARKING - LINE 24" (70300280) (SOLID WHITE)

FILE NAME = 01353887-SHT-MOT-01.DGN

USER NAME = bhenrich	DESIGNED - DW	REVISED -
	DRAWN - DW	REVISED -
PLOT SCALE = #SCALE#	CHECKED - JC	REVISED -
PLOT DATE = 6/22/2011	DATE - 03-28-2011	REVISED -

STATE OF ILLINOIS  
DEPARTMENT OF TRANSPORTATION

VILLAGE OF BURR RIDGE JOLIET RD AT MADISON ST  
SUGGESTED MAINTENANCE OF TRAFFIC PLANS STAGE 1 & 2

F.A.U. RTE. 2674	SECTION 06-00034-00-PV	COUNTY	TOTAL SHEETS 69	SHEET NO. 23
SCALE: NTS		SHEET NO. 1 OF 6 SHEETS		STA. 101+00.00 TO STA. 107+00.00
FED. ROAD DIST. NO.		ILLINOIS FED. AID PROJECT		
CONTRACT NO. 63581				