

MATCHLINE STA. 34+00

MATCHLINE STA. 39+00

SOUTH OLD RAND ROAD

SOUTH OLD RAND ROAD

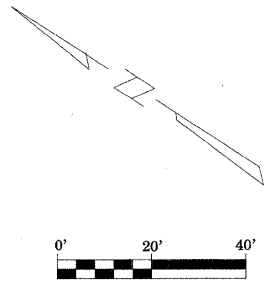
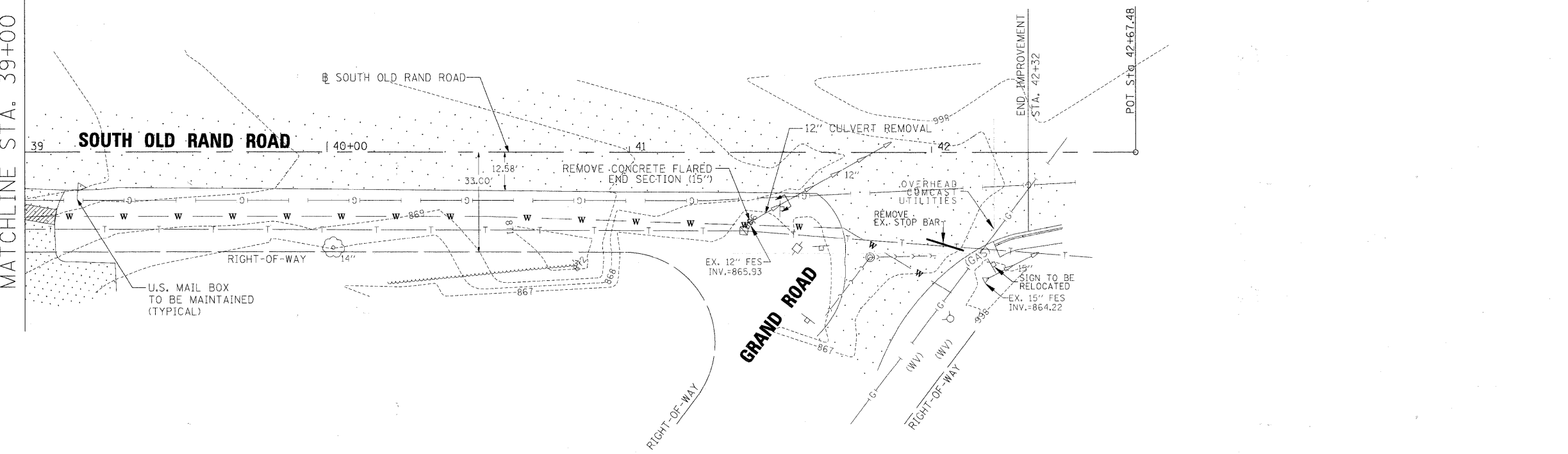
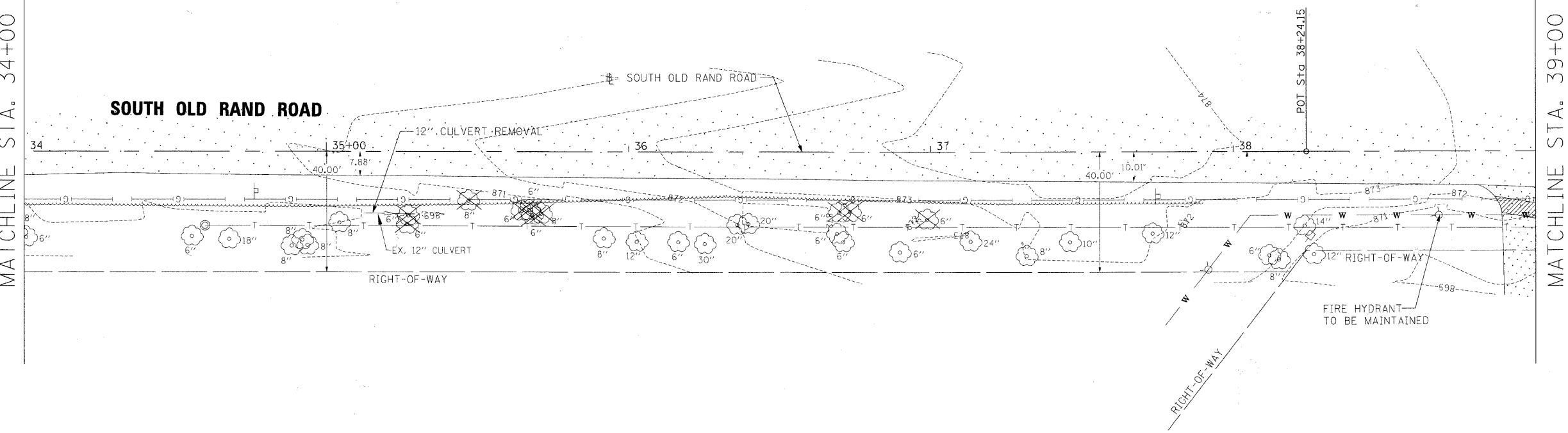

LEGEND

EXISTING ELEMENTS

- >—>— SANITARY SEWER
- >—>— STORM SEWER
- w— WATERMAIN
- T— TELEPHONE
- ⊙ MANHOLE
- CATCH BASIN
- (WV) VALVE VAULT
- ⊕ FIRE HYDRANT
- UTILITY POWER POLE
- (GAS) GAS VALVE/METER
- T— MAILBOX
- T— TRAFFIC SIGN
- T— TRAFFIC LIGHT
- ⊙ 18" TREE W/DIAMETER
- ⊙ UTILITY LIGHT POLE

REMOVALS

- ⊗ 18" TREE REMOVAL
- ▨ DRIVEWAY/SIDEWALK PAVEMENT REMOVAL
- ▩ PAVEMENT REMOVAL

FILE NAME =	DESIGNED <i>LSM</i>	REVISED -
USER NAME = TRICE	DRAWN <i>AO</i>	REVISED -
PLOT DATE = 03/28/2011	CHECKED <i>OIU</i>	REVISED -
	DATE <i>03/28/2011</i>	REVISED -



**STATE OF ILLINOIS
DEPARTMENT OF TRANSPORTATION**

**VILLAGE OF LAKE ZURICH
REMOVAL PLAN - SOUTH OLD RAND ROAD**

SCALE: SHEET NO. 3 OF 4 SHEETS STA. 34+00 TO STA. 42+67.48

F.A.U. RTE. 3504	SECTION 09-00071-00-SW	COUNTY LAKE	TOTAL SHEETS 27	SHEET NO. 11
CONTRACT NO. 63589				
ILLINOIS FED. AID PROJECT				