

MATCHLINE STA. 20+00

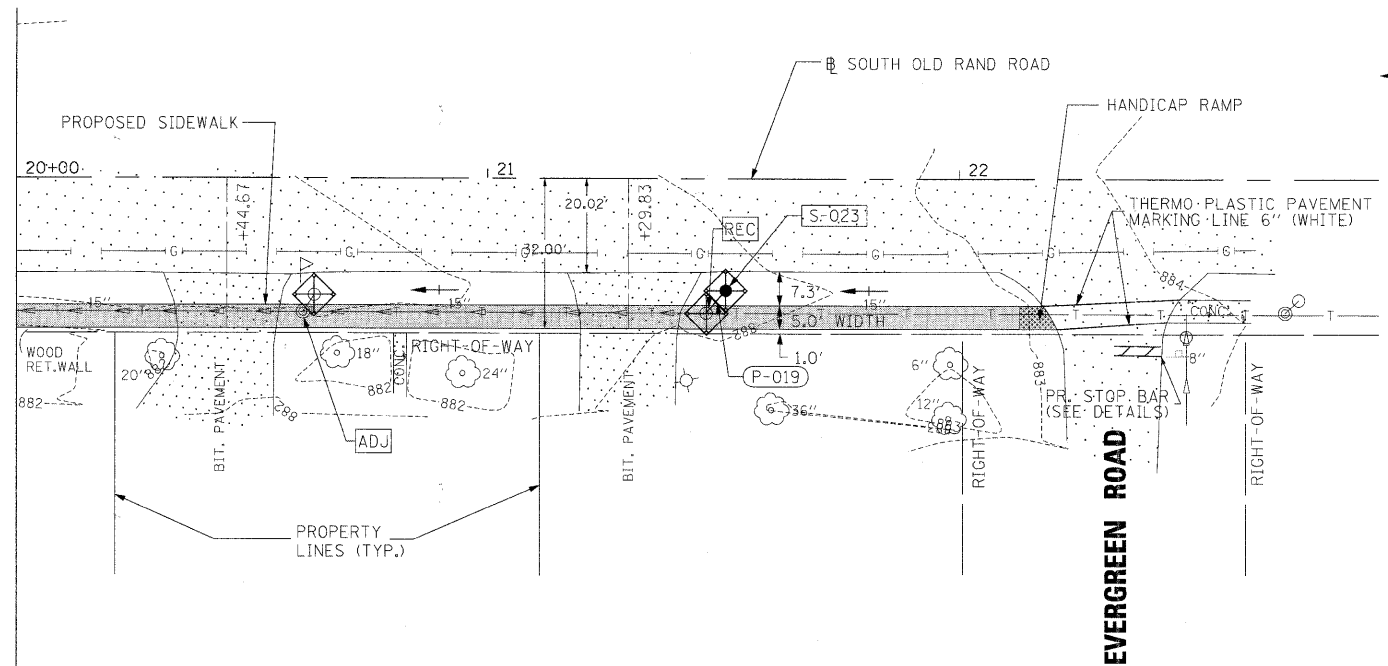

WORK OMISSION
FROM STATION 22+50
(EVERGREEN ROAD) TO
STATION 29+00
(CEDAR ROAD).

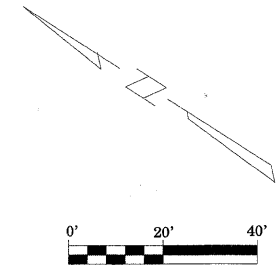

LEGEND

PROPOSED ELEMENTS

- CATCH BASIN
- STORM SEWER
- ADJ CATCH BASINS TO BE ADJUSTED WITH NEW TYPE 1 FRAME, CLOSED LID
- REC CATCH BASINS TO BE RECONSTRUCTED WITH NEW TYPE 1 FRAME, CLOSED LID
- Handicap Ramp Symbol HANDICAP RAMP
- Sidewalk Symbol SIDEWALK
- Perimeter Erosion Barrier Symbol PERIMETER EROSION BARRIER
- Inlet and Pipe Protection Symbol INLET AND PIPE PROTECTION

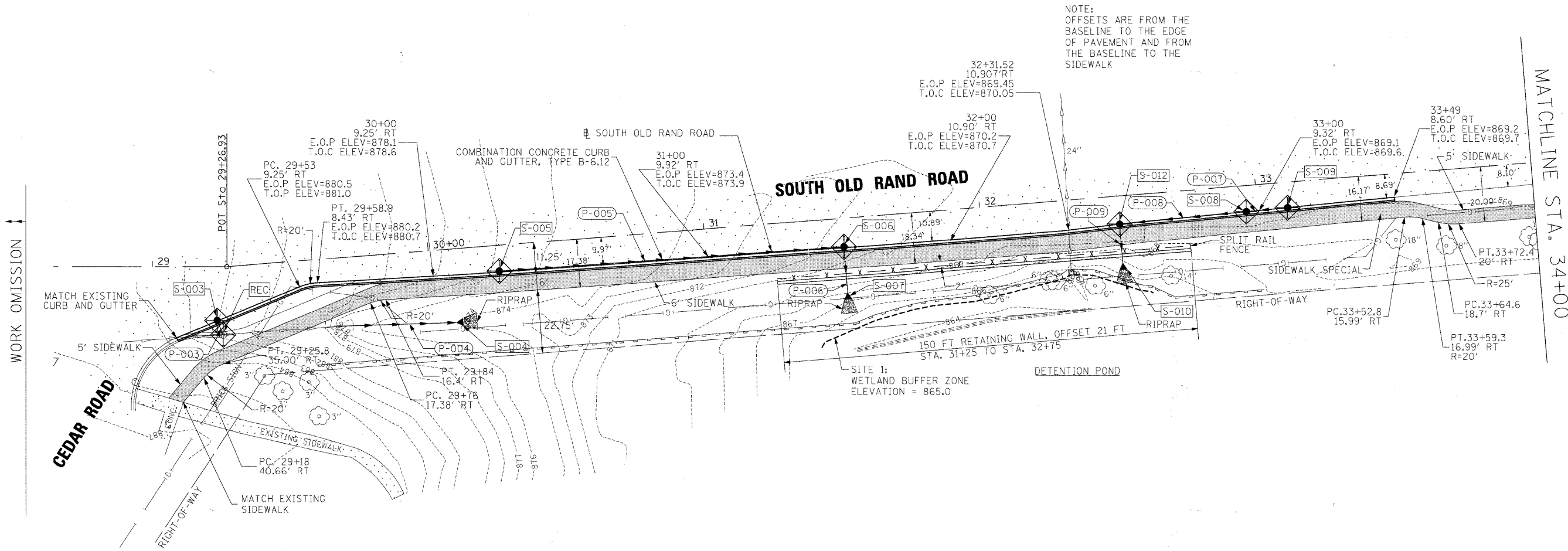

NOTE:
OFFSETS ARE FROM THE
BASELINE TO THE EDGE
OF PAVEMENT AND FROM
THE BASELINE TO THE
SIDEWALK

MATCHLINE STA. 34+00

FILE NAME =	DESIGNED LSM	REVISED -
USER NAME = TRICE	DRAWN AO	REVISED -
PLOT DATE = 03/28/2011	CHECKED OTU	REVISED -
	DATE 03/28/2011	REVISED -



STATE OF ILLINOIS
DEPARTMENT OF TRANSPORTATION

VILLAGE OF LAKE ZURICH
SIDEWALK PLAN - SOUTH OLD RAND ROAD

SCALE: SHEET NO. 2 OF 4 SHEETS STA. 20+00 TO STA. 34+00

F.A.U. RTE. 3504	SECTION 09-00071-00-SW	COUNTY LAKE	TOTAL SHEETS 27	SHEET NO. 14
CONTRACT NO. 63589				
ILLINOIS FED. AID PROJECT				