

NOTE
SIGN IN ACCORDANCE WITH STD. 701606
(POSTED SPEED 35 M.P.H.)

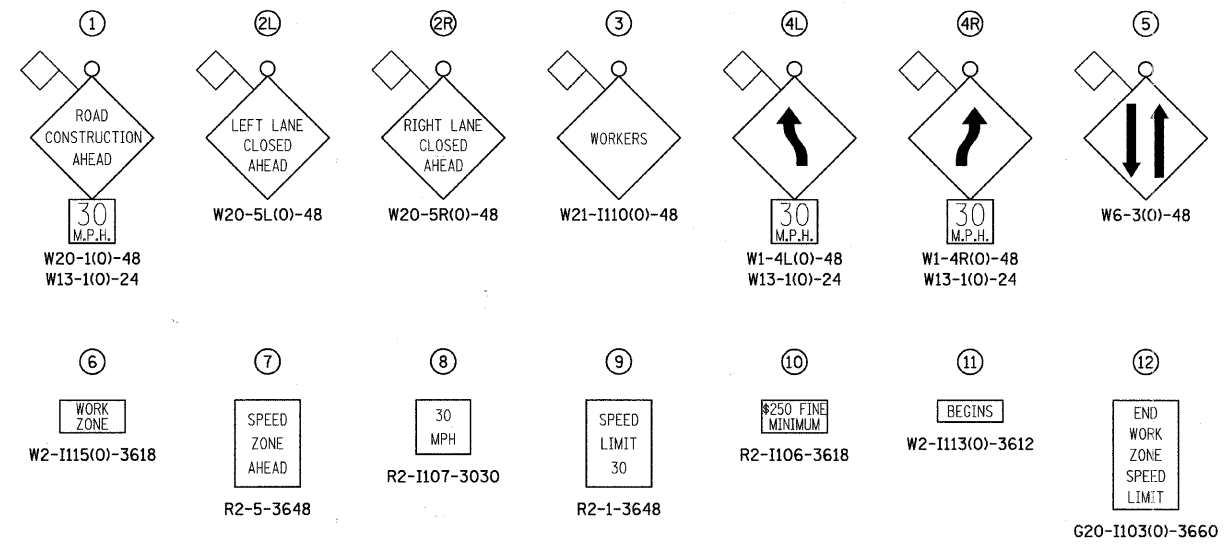
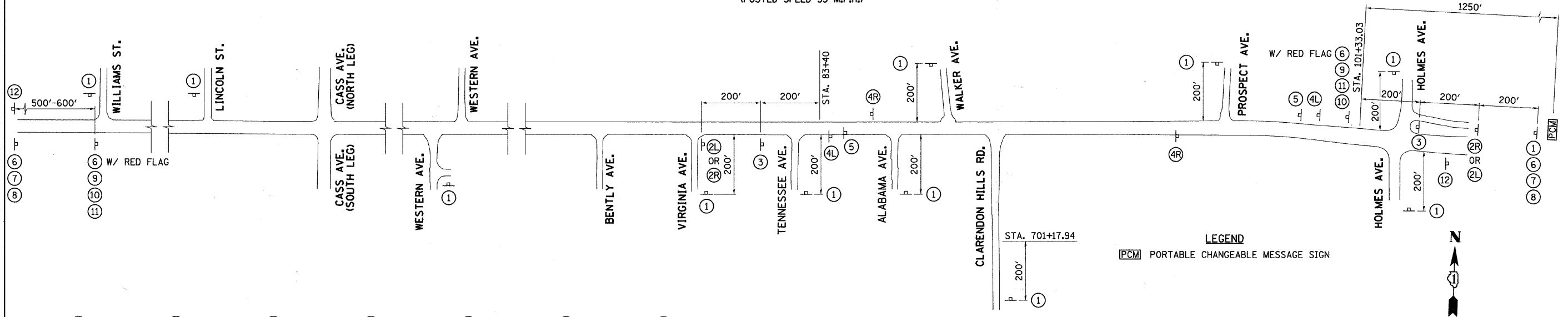

TRAFFIC CONTROL AND PROTECTION

TRAFFIC CONTROL AND PROTECTION SHALL BE PERFORMED IN ACCORDANCE WITH THE TRAFFIC CONTROL PLAN, SECTION 701 OF THE STANDARD SPECIFICATIONS AND THE SPECIAL PROVISIONS.

TWO WAY TRAFFIC SHALL BE ACCOMMODATED AT ALL TIMES EXCEPT DURING ISOLATED FLAGGER CONTROLLED LANE CLOSURES.

EXISTING CONFLICTING TRAFFIC CONTROL SIGNS AND DEVICES WILL BE REMOVED OR COVERED BY THE CONTRACTOR AFTER THE PROPOSED TRAFFIC CONTROL REQUIREMENTS ARE MET, OR AS AUTHORIZED BY THE ENGINEER. SIGNS OR DEVICES LEFT IN PLACE AT THIS TIME ARE TO BE PROTECTED FROM DAMAGE BY THE CONTRACTOR.

DRUMS WITH WORKING LIGHTS SHALL BE REQUIRED TO DELINEATE THE TRAVELED WAY. THE MAXIMUM SPACING SHALL BE 50 FEET, CENTER TO CENTER ALONG TANGENTS; AND 25 FEET, CENTER TO CENTER ALONG RADII TO SIDE ROADS AND ENTRANCES.

SUPPLEMENTAL CONSTRUCTION SPEED LIMIT SIGNING IS TO BE INSTALLED AT THE LOCATIONS AS DIRECTED BY THE ENGINEER.

THE FOLLOWING TRAFFIC CONTROL STANDARDS ARE THE MINIMUM REQUIREMENTS FOR THE TRAFFIC CONTROL FOR THIS PROJECT: 701201, 701301, 701311, 701606, 701901, 704001.

STAGE 1 MAINTENANCE OF TRAFFIC
CLOSE OUTSIDE WESTBOUND LANE ON C.H. 35 (55TH ST.) USING STANDARDS 701201 AND 701606, MAINTAINING ONE LANE OF TRAFFIC IN EACH DIRECTION WITH A CONTINUOUS CENTER TURN LANE.

STAGE 1 CONSTRUCTION
REMOVE EXISTING CURB AND GUTTER AND CONSTRUCT TEMPORARY WIDENING ON THE NORTH SIDE OF C.H. 35 (55TH ST.) FROM STA. 84+00 TO STA. 96+62.

STAGE 2 MAINTENANCE OF TRAFFIC
CLOSE EASTBOUND LANES USING STAGE 2 TRAFFIC CONTROL PLANS.
MOVE TRAFFIC TO WESTBOUND LANES AND MAINTAIN ONE LANE OF TRAFFIC IN EACH DIRECTION.
MAINTAIN TRAFFIC ON CLARENDON HILLS RD. WITH DAY TIME LANE CLOSURES USING STANDARD 701201.
PROHIBIT LEFT HAND TURNS FROM C.H. 35 (55TH ST.) ONTO CLARENDON HILLS RD., WALKER AVE., AND PROSPECT AVE.
CLOSE ALABAMA AVE. AND IMPLEMENT DETOUR FOR NORTHBOUND LEFT TURN @ CLARENDON HILLS RD.

STAGE 2 CONSTRUCTION
INSTALL STORM SEWER AND CONSTRUCT DITCHES ON SOUTH SIDE OF C.H. 35 (55TH ST.) AND ALONG CLARENDON HILLS RD.
CONSTRUCT LEVELING OVERLAY AND WIDENING UP TO BASE COURSE ON SOUTH SIDE OF C.H. 35 (55TH ST.) FROM STA. 84+35 TO STA. 89+98 AND FROM STA. 93+81 TO STA. 98+00.
RECONSTRUCT C.H. 35 (55TH ST.) FROM STA. 89+98 TO STA. 93+81.
CONSTRUCT WIDENING UP TO BINDER COURSE ON CLARENDON HILLS RD.

STAGE 3 MAINTENANCE OF TRAFFIC
CLOSE WESTBOUND LANES USING STAGE 3 TRAFFIC CONTROL PLANS.
MOVE TRAFFIC TO EASTBOUND LANES AND MAINTAIN ONE LANE OF TRAFFIC IN EACH DIRECTION.
PROHIBIT LEFT HAND TURNS FROM C.H. 35 (55TH ST.) ONTO CLARENDON HILLS RD., WALKER AVE., ALABAMA AVE., AND PROSPECT AVE.

STAGE 3 CONSTRUCTION
INSTALL STORM SEWER ON NORTH SIDE OF C.H. 35 (55TH ST.).
CONSTRUCT LEVELING OVERLAY AND WIDENING UP TO BASE COURSE ON NORTH SIDE OF C.H. 35 (55TH ST.) FROM STA. 83+40 TO STA. 89+98 AND FROM STA. 93+81 TO STA. 101+33.
RECONSTRUCT C.H. 35 (55TH ST.) FROM STA. 89+98 TO STA. 93+81.
CONSTRUCT CAST-IN-PLACE CONCRETE RETAINING WALL FROM STA. 91+25 TO STA. 94+45.

STAGE 4 MAINTENANCE OF TRAFFIC
CLOSE LANES AS NECESSARY USING STANDARD 701606.

STAGE 4 CONSTRUCTION
MILL EXISTING PAVEMENT 2" ALONG C.H. 35 (55TH ST.) IN WIDENING AND RESURFACING AREAS.

STAGE 5 MAINTENANCE OF TRAFFIC
CLOSE LANES AS NECESSARY USING STANDARD 701606.

STAGE 5 CONSTRUCTION
MILL EXISTING PAVEMENT 1-3/4" ALONG C.H. 35 (55TH ST.) IN WIDENING AND RESURFACING AREAS.

STAGE 6 MAINTENANCE OF TRAFFIC
CLOSE LANES AS NECESSARY USING STANDARD 701606.

STAGE 6 CONSTRUCTION
CONSTRUCT 2-1/4" BINDER COURSE ALONG C.H. 35 (55TH ST.) AND CLARENDON HILLS RD.
COMPLETE TRAFFIC SIGNAL INSTALLATION AT INTERSECTION.

STAGE 7 MAINTENANCE OF TRAFFIC
CLOSE LANES AS NECESSARY USING STANDARD 701606.

STAGE 7 CONSTRUCTION
COMPLETE LANDSCAPING FOR ENTIRE AREA.
TEMPORARILY STRIPE C.H. 35 (55TH ST.) AND CLARENDON HILLS RD. IN THE FINAL CONFIGURATION.

STAGE 8 MAINTENANCE OF TRAFFIC
CLOSE LANES AS NECESSARY USING STANDARD 701606.

STAGE 8 CONSTRUCTION
CONSTRUCT 1-1/2" SURFACE COURSE ALONG C.H. 35 (55TH ST.) AND CLARENDON HILLS RD.
PLACE FINAL PAVEMENT MARKING AND RECESSED PAVEMENT MARKERS.

NOTES:

LANE CLOSURES NECESSARY FOR WORK WEST OF CASS AVE., SHALL BE COORDINATED WITH THE TRAFFIC CONTROL & PROTECTION IMPLEMENTED FOR THE VARIOUS STAGES AT CASS AVE. AND TO THE EAST.

ALL PROPOSED STORM SEWER THAT CROSSES SIDE ROADS THAT ARE NOT CLOSED SHALL BE CONSTRUCTED HALF AT A TIME USING FLAGGERS IN ORDER TO KEEP THE SIDE ROAD OPEN.

ALL STORM SEWER LATERALS SHALL BE CONSTRUCTED TO THE @ USING FLAGGERS.

BEGIN TRAFFIC SIGNAL INSTALLATION DURING ANY STAGE PRIOR TO STAGE 6.

FILE NAME = V:\2791\2791\F001.dgn	USER NAME = shughes	DESIGNED -	REVISED -	STATE OF ILLINOIS DEPARTMENT OF TRANSPORTATION	C.H. 35 (55TH ST.) TRAFFIC CONTROL AND STAGING PLAN			F.A.U. RTE.	SECTION	COUNTY	TOTAL SHEETS	SHEET NO.	
	PLOT SCALE = 250.0000' / IN.	DRAWN -	REVISED -		SCALE: 1"=250'	SHEET NO. 1 OF 2 SHEETS	STA. N/A	TO STA. N/A	1504	94-00302-00-FP	DU PAGE	240	60
	PLOT DATE = 5/19/2011	CHECKED -	REVISED -							CONTRACT NO. 63609			
		DATE -	REVISED -							ILLINOIS FED. AID PROJECT			