

EJM ENGINEERING, INC.
 411 South Wells Street Suite 800
 Chicago, Illinois 60607

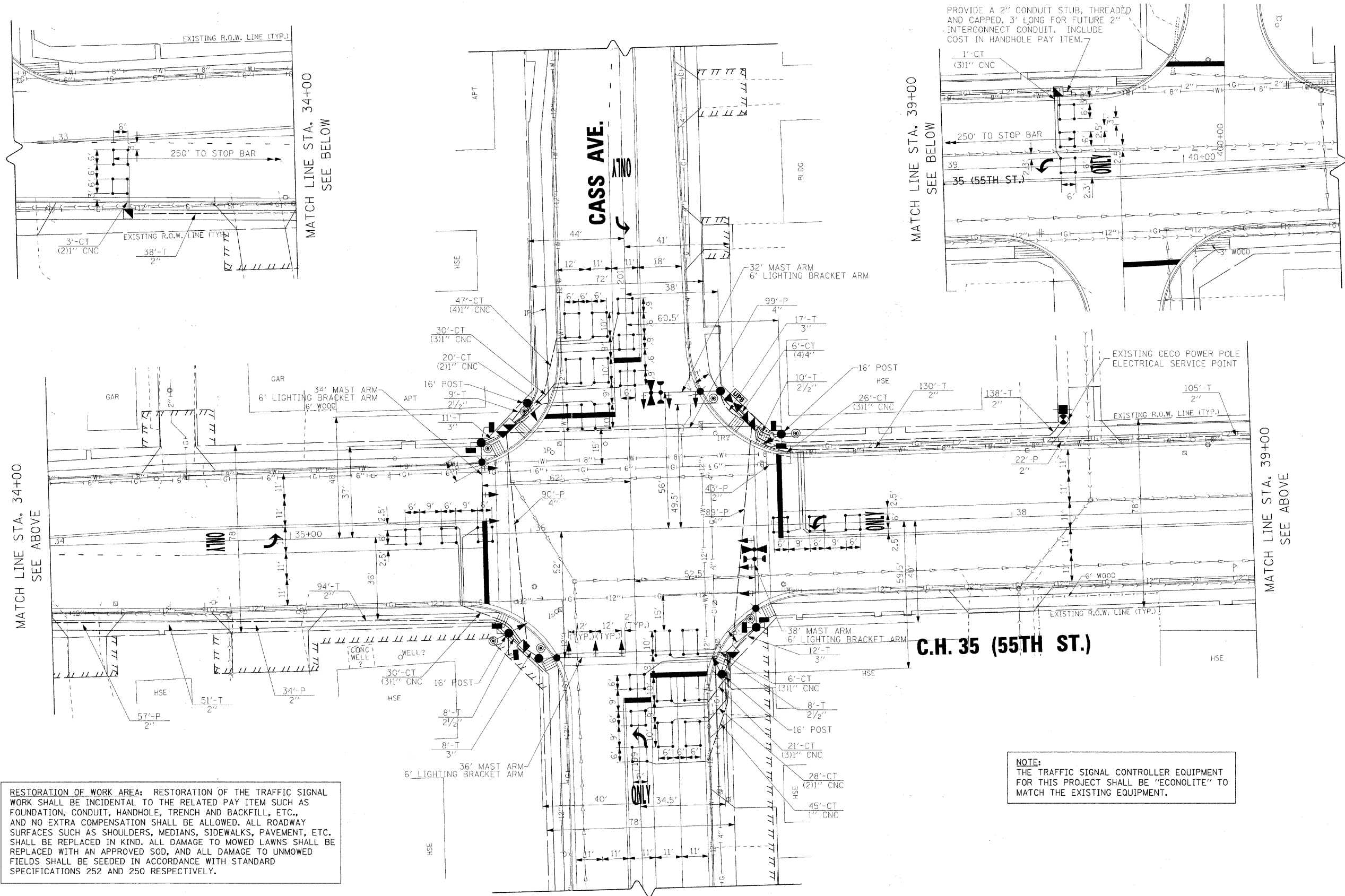

RESTORATION OF WORK AREA: RESTORATION OF THE TRAFFIC SIGNAL WORK SHALL BE INCIDENTAL TO THE RELATED PAY ITEM SUCH AS FOUNDATION, CONDUIT, HANDHOLE, TRENCH AND BACKFILL, ETC., AND NO EXTRA COMPENSATION SHALL BE ALLOWED. ALL ROADWAY SURFACES SUCH AS SHOULDERS, MEDIANS, SIDEWALKS, PAVEMENT, ETC. SHALL BE REPLACED IN KIND. ALL DAMAGE TO MOWED LAWNS SHALL BE REPLACED WITH AN APPROVED SOD, AND ALL DAMAGE TO UNMOWED FIELDS SHALL BE SEEDED IN ACCORDANCE WITH STANDARD SPECIFICATIONS 252 AND 250 RESPECTIVELY.

NOTE:
 THE TRAFFIC SIGNAL CONTROLLER EQUIPMENT FOR THIS PROJECT SHALL BE "ECONOLITE" TO MATCH THE EXISTING EQUIPMENT.



MATCH LINE STA. 34+00
SEE ABOVE

MATCH LINE STA. 34+00
SEE BELOW

MATCH LINE STA. 39+00
SEE BELOW

MATCH LINE STA. 39+00
SEE ABOVE

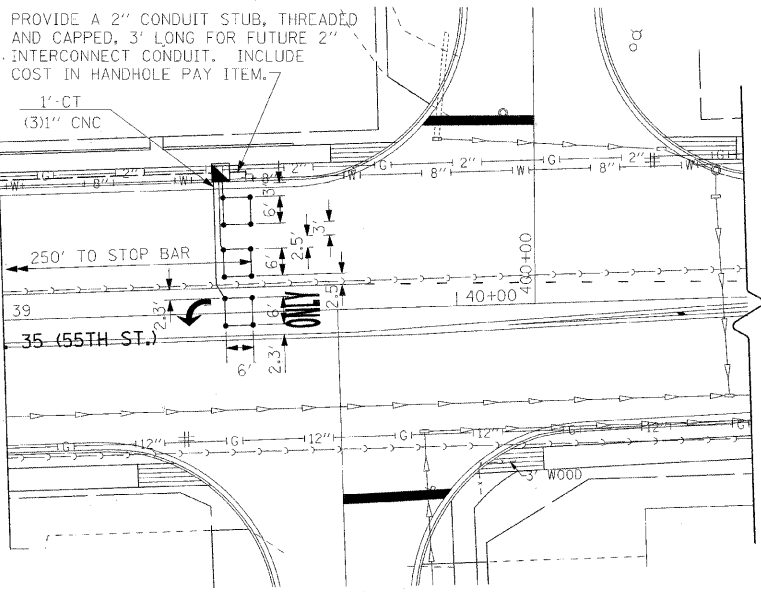

FILE NAME =
 ...traffic signals\2902TS11.dgn

USER NAME = rswanson
 PLOT SCALE = NONE
 PLOT DATE = 5/13/2011

DESIGNED - JM
 DRAWN - MS
 CHECKED - CK
 DATE - 05/11/2011

REVISED -
 REVISED -
 REVISED -
 REVISED -

**STATE OF ILLINOIS
 DEPARTMENT OF TRANSPORTATION**

**TRAFFIC SIGNAL MODERNIZATION PLAN
 C.H. 35 (55TH STREET) & CASS AVENUE**

SCALE: 1"=20' SHEET NO. 1 OF 2 SHEETS

F.A.U. RTE.	SECTION	COUNTY	TOTAL SHEETS NO.	SHEET NO.
1504	94-00302-00-FP	DUPAGE	240	132
FED. ROAD DIST. NO. 1 ILLINOIS FED. AID PROJECT			CONTRACT NO. 63609	