

PLAN	SURVEYED	DATE
	ALIGNED	
	NOTED	
	RT. OF WAY CHECKED	
	CADD FILE NAME	

PROFILE	SURVEYED	DATE
	GRADES CHECKED	
	NOTED	
	STRUCTURE NOTATING CHRD	

FILE NAME : P:\2010\ME10015_Roselle_IL\PROJECT\CADD\Shots\Roselle-sht-D001.dgn
 PLOT SCALE : 20'0000' / IN
 USER NAME : Millennium Professional Services

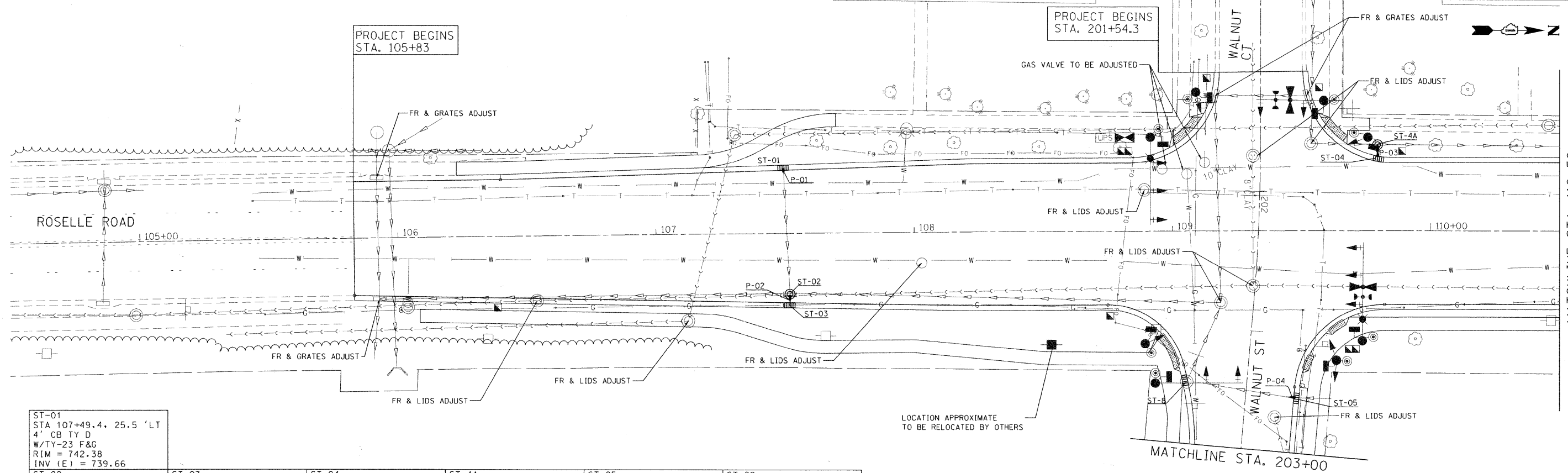

ST-01 STA 107+49.4, 25.5' LT 4' CB TY D W/TY-23 F&G RIM = 742.38 INV (E) = 739.66	ST-03 STA 107+51.6, 27.6' RT 4' CB TY D W/TY-23 F&G RIM = 742.35 INV = 737.80 (W)	ST-04 STA 109+74.5, 29.2' LT 4' CB TY D W/TY-23 F&G RIM = 743.59 INV (NW) = 740.29	ST-4A STA 109+79.5, 33.5' LT 4' MH TY A W/ FR & LIDS T1 CL RIM = 744.45 INV (NW) = 740.29	ST-05 STA 202+78.6, 19.5' LT 4' CB TY D W/TY-23 F&G RIM = 743.23 INV (S) = 740.57	ST-08 STA 202+76.0, 23.2' RT EX MH TO BE ADJUST W/ TY-23 F&G RIM = 743.15 INV (W) = 740.76
--	--	---	--	--	---

P-01 EXTEND EX STORM SEW 4 LF - 10" STORM SEW CL A, TY-1	P-2 EXTEND EX STORM SEW 4 LF - 10" STORM SEW CL A, TY-1	P-3 6 LF - 10" STORM SEW CL A, TY-1 TO NEW CB	P-4 EXTEND EX STORM SEW 4 LF - 10" STORM SEW CL A, TY-1
---	--	--	--

LOCATION APPROXIMATE TO BE RELOCATED BY OTHERS

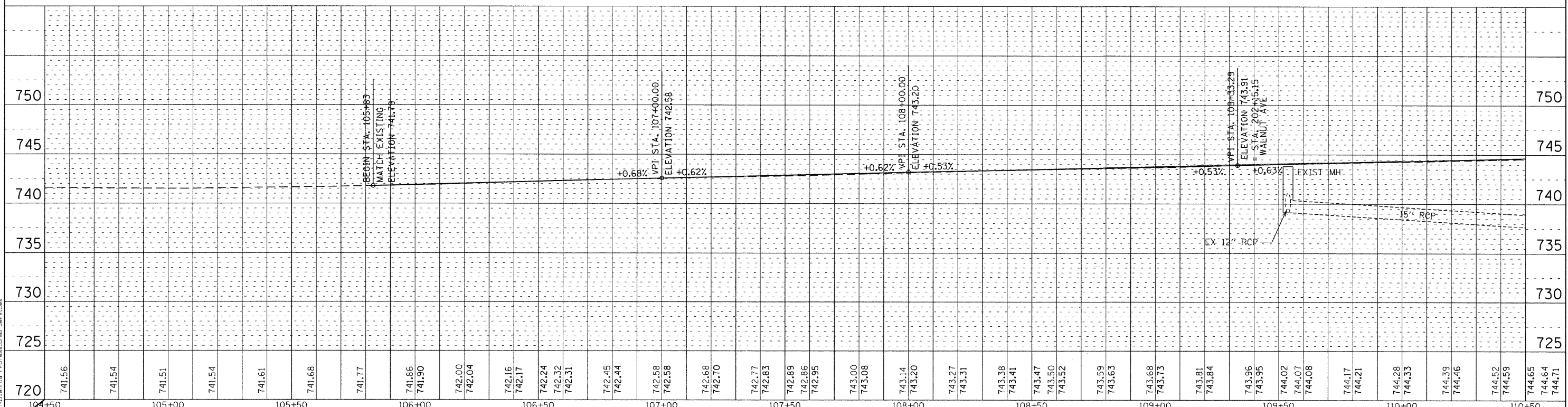

200 22ND Street, Suite 216, Lombard, IL 60148
 630.785.0110 voice, 630.839.2566 fax
 WWW.MPS-IL.COM

MILLENNIA PROFESSIONAL SERVICES

DESIGNED - TVN	REVISED -
DRAWN - TVN	REVISED -
CHECKED - RPD	REVISED -
DATE - 5/25/2011	REVISED -

**DUPAGE COUNTY
DEPARTMENT OF TRANSPORTATION**

**ROSELLE RD. & WALNUT ST.
INTERSECTION IMPROVEMENTS**

DRAINAGE AND UTILITIES PLAN

SCALE: 1"=20' SHEET NO. 1 OF 3 SHEETS STA. 105+83 TO STA. 110+50

F.A.P. RTE. 364	SECTION 07-00184-12-CH	COUNTY DUPAGE	TOTAL SHEETS 49	SHEET NO. 20
CONTRACT NO. 63611				
FED. ROAD DIST. NO. 1 ILLINOIS FED. AID PROJECT				