

## US 150 (RAMP A) TO IL 6 CLOSURE WITH DETOUR.

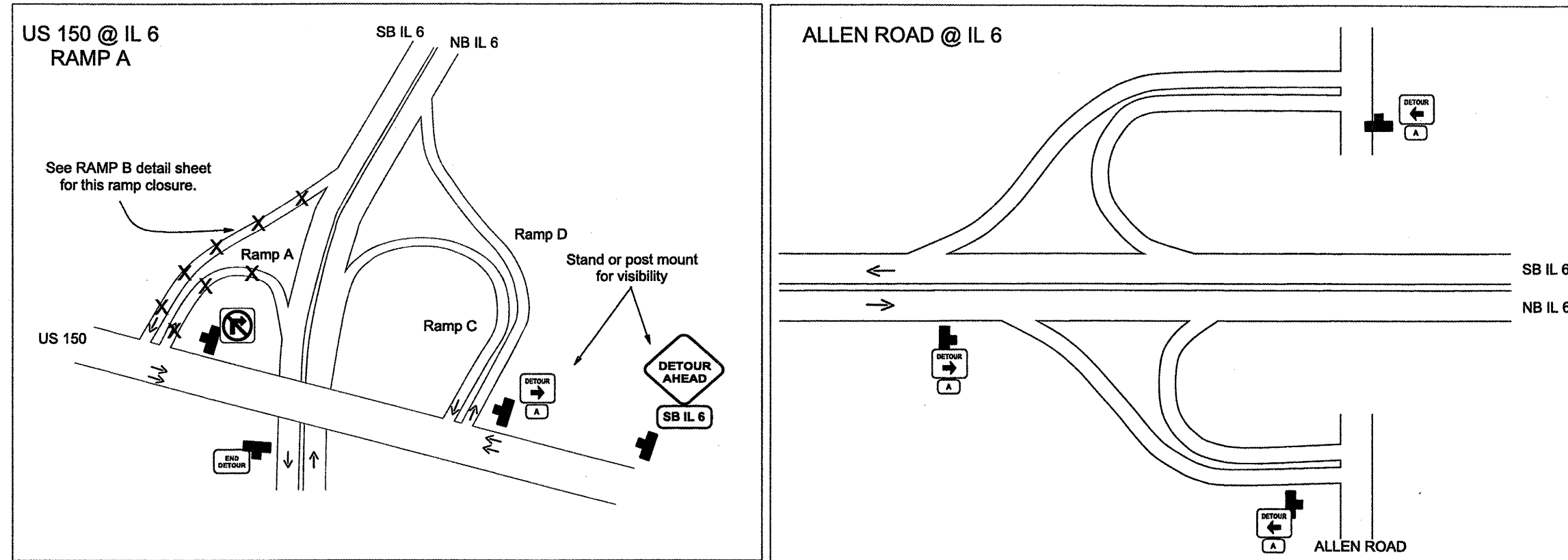

### General Notes

- 1) Ramps A & B shall be closed simultaneously. One Changeable Message Sign shall be utilized 3 days in advance of each ramp closure- one on IL 6 and one on WB US 150. Changeable message signs shall be utilized during the closure.
- 2) TIME RESTRICTIONS: Complete closures are allowed on Thursday night from 6:00 pm to 6:00 am & from Friday 6:00 pm to Monday 6:00 am.
- 3) The advanced signs on WB US 150 shall be post or stand mounted for better visibility.
- 4) Barrels shall be placed on IL 6 at the State u-turn to prevent motorist from doing a u-turn.
- 5) Ramp entrance shall be closed per standard 701901 "ROAD CLOSED TO ALL TRAFFIC."
- 6) Devices a@ 25' cts. to delineate closed turn lanes of affected ramps.

FILE NAME = general.dgn	USER NAME = AdadeSA	DESIGNED -	REVISED -	<b>STATE OF ILLINOIS DEPARTMENT OF TRANSPORTATION</b>	<b>TRAFFIC CONTROL PLAN DETAIL</b>	F.A.P. RTE. 318	SECTION 772-71RS-1	COUNTY PEORIA	TOTAL SHEETS 32	SHEET NO. 23
	PLOT SCALE = 400.0001' / 1" =	DRAWN -	REVISED -							
	PLOT DATE = 5/12/2011	CHECKED -	REVISED -		SCALE: SHEET NO. OF SHEETS STA. TO STA.					
		DATE -	REVISED -							CONTRACT NO. 68673
ILLINOIS FED. AID PROJECT										