

F.A.P. RTE.	SECTION	COUNTY	TOTAL SHEETS	SHEET NO.
318	72-17, 7-31RS-1(7-2)RS	PEORIA	32	1
FED. ROAD DIST. NO.	ILLINOIS	CONTRACT NO. 68673		

D-94-002-07

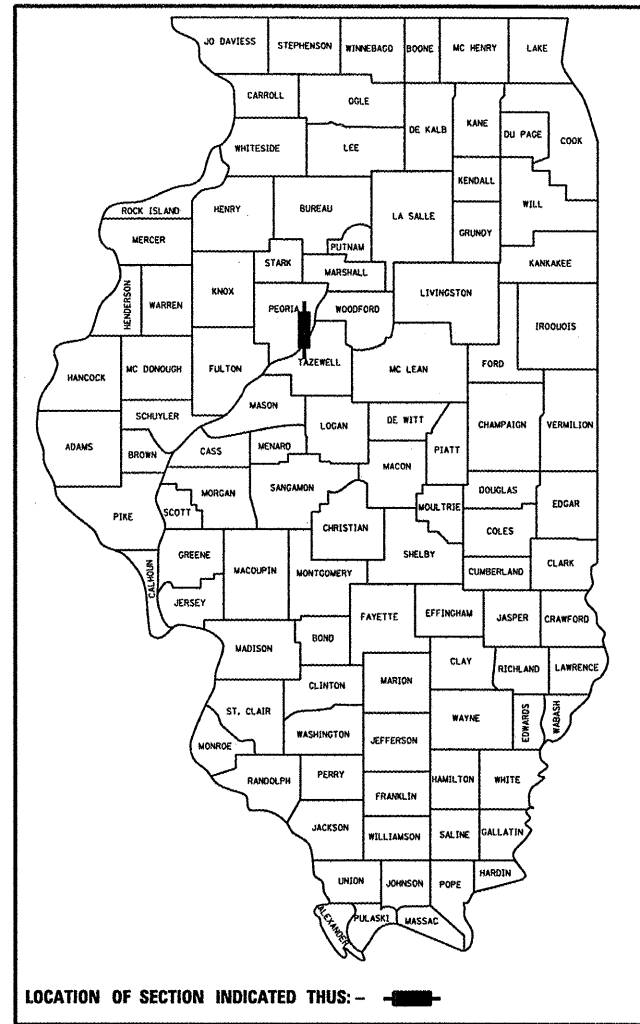

LOCATION OF SECTION INDICATED THUS: - [black rectangle] -

FOR INDEX OF SHEETS, SEE SHEET NO. 2

**HIGHWAY STANDARDS**

- 420701-02 701406-06
- 442001-04 701411-07
- 442101-07 701426-04
- 482006-03 701451-01
- 642001-01 701456-01
- 701101-02 701901-01
- 701400-05 780001-02
- 701401-06 781001-03

IL 6  
 ADT = 36,300  
 MU = 8.5%  
 SU = 3.4%

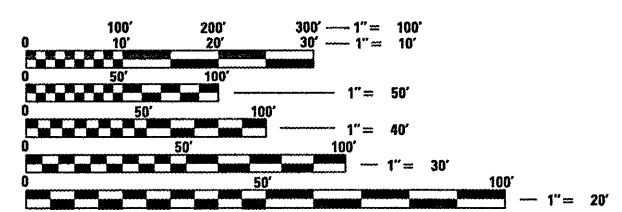

FULL SIZE PLANS HAVE BEEN PREPARED USING STANDARD ENGINEERING SCALES. REDUCED SIZED PLANS WILL NOT CONFORM TO STANDARD SCALES. IN MAKING MEASUREMENTS ON REDUCED PLANS, THE ABOVE SCALES MAY BE USED.

J.U.L.I.E.  
 JOINT UTILITY LOCATION INFORMATION FOR EXCAVATION  
 1-800-892-0123  
 OR 811

PROJECT ENGINEER: CHRISTOPHER MAUSHARD 309-671-3453  
 DESIGN ENGINEER: RAYMOND SAMARA 309-671-3477  
 CATALOG NO. 032307-05D  
 CONTRACT NO. 68673

STATE OF ILLINOIS  
 DEPARTMENT OF TRANSPORTATION  
 DIVISION OF HIGHWAYS

**PROPOSED  
 HIGHWAY PLANS**

FAP 318 (IL 6)  
 SECTION (72-7)RS-1  
 PEORIA COUNTY  
 C-94-003-07  
 PROJECT NHF-0318(014)

R 7 E | R 8 E

Project Begins  
 Sta. 20 + 04 SBL  
 Sta. 19 + 35 NBL

Bridge Omission  
 Sta. 57 + 35 to 58 + 39

Project Ends  
 Sta. 97 + 07 NBL  
 Sta. 91 + 84 SBL

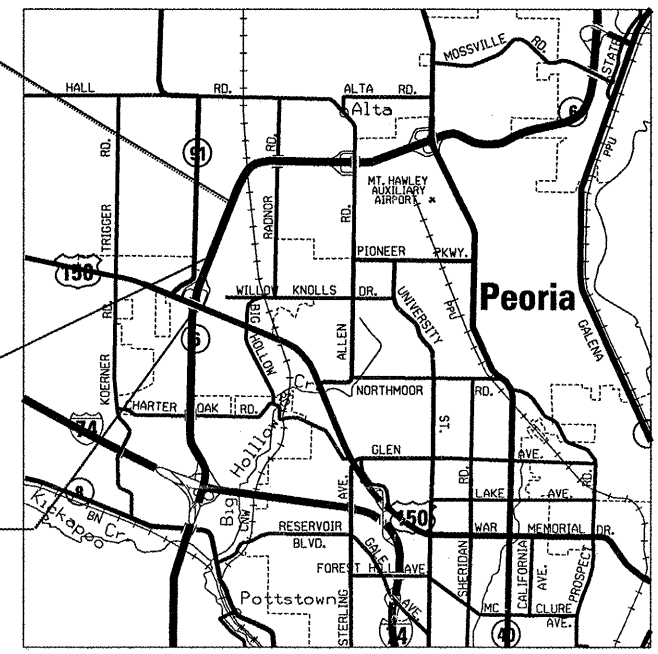

T 9 N

DESCRIPTION  
 This project consists of patching, milling and overlay on IL 6 from US 150 to 0.7 miles north of Hoerr's Pond in Peoria County.

GROSS LENGTH = 7,646 FT. = 1.45 MILE  
 NET LENGTH = 7,542 FT. = 1.43 MILE

STATE OF ILLINOIS  
 DEPARTMENT OF TRANSPORTATION  
 DIVISION OF HIGHWAYS

SUBMITTED MM 12 20 11

[Signature]  
 DEPUTY DIRECTOR OF HIGHWAYS, REGION ENGINEER

July 1 20 11  
Scott E. Stitt, P.E.  
 acting ENGINEER OF DESIGN AND ENVIRONMENT

July 1 20 11  
Christine M. Reed  
 DIRECTOR OF HIGHWAYS, CHIEF ENGINEER

**PRINTED BY THE AUTHORITY  
 OF THE STATE OF ILLINOIS**

**INDEX OF SHEETS**

- 1 COVER SHEET
- 2-3 INDEX OF SHEETS AND GENERAL NOTES
- 4 SUMMARY OF QUANTITIES
- 5-7 TYPICAL SECTIONS
- 8-12 SCHEDULE OF QUANTITIES
- 13 LINE DIAGRAM
- 14-22 PLAN SHEETS
- 23-26 TRAFFIC CONTROL PLAN DETAIL
- 27 EXPANSION JOINT (SPECIAL) DETAIL
- 28 PAVEMENT MARKING DETAIL
- 29-32 DISTRICT STANDARDS

**COMMITMENTS**

There are no commitments for this project.

**ENVIRONMENTAL REVIEWS**

Prior to the use of any proposed borrow areas, use areas (temporary access roads, detours, run-arounds, etc.) and/or waste areas, the Contractor shall file the required environmental resource request surveys according to Section 107.22 of the Standard Specifications. These surveys are required in order for the Department to conduct cultural and biological resource surveys for the proposed site.

Prior to any waste materials being removed from the construction site the required environmental resource surveys will need to be obtained and filed by the Contractor. Excess waste products removed from the construction site shall be disposed of as required in Section 202.03 of the Standard Specifications.

Any protruding metal bars shall be removed prior to the disposal of broken concrete at approved disposal sites.

The required environmental resource documentation shall include the following:

- \* BDE Form 2289 (Environmental Survey Request)
- \* A location map showing the size limits and location of the use area
- \* Signed property owner agreement form-D4 PI0100
- \* Color photographs depicting the use area
- \* Borrow Area Entry Agreement form-D4 PI0101

Please note that a minimum of two weeks shall be allowed for the District to obtain the required environmental clearances.

**PAVEMENT STATIONING NUMBERS & PLACEMENT**

The Contractor shall provide labor and materials required to imprint pavement station numbers in the finished surface of the pavement and/or overlay. The numbers shall be approximately 3/4 inch (20mm) wide, 5 inches (125 mm ) high and 5/8 inch (15 mm ) deep.

The pavement station numbers shall be installed as specified herein:

Interval – 200 feet (English stationing) or 100 meters (metric stationing)

Bottom of Numbers – 6 inches (150 mm ) from the inside edge of the pavement marking

**Location:**

- \* 2,3, & 5 Lane Pavements – right edge of pavement in direction of increasing stations
- \* Multi-Lane Divided Roadways – outside edge of pavement in both directions
- \* Ramps – along baseline edge of pavement

Position – stations shall be placed so they can be read from the adjacent shoulder

Format – English (Metric) pavement stations shall use this format "XXX (XX+X00)" where X represents the pavement station

This work will not be paid for separately, but will be considered included in the cost of the associated pavement and/or overlay pay items.

**MINIMUM VERTICAL CLEARANCE**

The Contractor shall verify the existing structure vertical clearance prior to placing bituminous overlay under any structure. A minimum 16'-9" vertical clearance shall be maintained under all structures.

**PAVING SURFACE COURSE**

Continuous paving operations on the main roadway shall be maintained at all times during the construction of the hot-mix asphalt surface. No interruptions for side roads, entrances, turn lanes, etc. will be allowed.

**POLYMERIZED BITUMINOUS MATERIALS (PRIME COAT) RATES**

Surface Type	Estimated Truck Application Rate	Residual Rate
Milled (HMA or PCC)	0.08 gal/sy (0.00034 ton/sy)	0.04 gal/sy
Existing Pavement	0.05 gal/sy (0.00022 ton/sy)	0.025 gal/sy
Fog Coat (between lifts)	0.05 gal/sy (0.00022 ton/sy)	0.025 gal/sy

Note: Estimated truck application rate is used for estimating quantities.

**HOT-MIX ASPHALT MIXTURE REQUIREMENTS**

Mixture Use(s):	Surface Course	Binder Course	HMA Shoulders Lower lift	HMA Shoulders Surface lift	Ramp Surface Course
AC/PG:	SBS or SBR 76-22	SBS or SBR 76-22	PG 64-22	PG 64-22	SBS or SBR 76-22
RAP% (Max): **	10%	10%	25%	15%	10%
Design Air Voids:	4.0% @ N=90	4.0% @ N=70	4.0% @ N=50	3.0% @ N=50	4.0% @ N=90
Mixture Composition: (Gradation Mixture)	IL 9.5 or IL12.5	IL 19.0	IL 19.0	IL 9.5 or IL12.5	IL 9.5 or IL12.5
Friction Aggregate:	Mixture E	NA	NA	Mixture C	Mixture E

**Notes: Individual lift thickness of each mix type will be no less than 3 times nominal maximum aggregate size and no more than 6 times nominal aggregate size.**

**CROSSING EXISTING STRUCTURES WITH EQUIPMENT**

The following structures SN 072-0141 & SN 072-0142 may be crossed with a loaded Material Transfer Device.

Any structures not listed above shall be verified by the resident prior to beginning work.

**ENGINEERS FIELD OFFICE**

Add the following sentence to the end of paragraph 670.02 (i) and 670.04 (e):

All of the telephone lines provided shall have unpublished numbers.

**JOB SPECIFIC NOTE**

A 6' milling machine shall be used for milling the shoulders.

FILE NAME = general.dgn	USER NAME = AdedeSA	DESIGNED -	REVISED -	<b>STATE OF ILLINOIS DEPARTMENT OF TRANSPORTATION</b>	<b>INDEX OF SHEETS &amp; GENERAL NOTES</b>	F.A.P. RTE. 318	SECTION (72-7)RS-1	COUNTY PEORIA	TOTAL SHEETS 32	SHEET NO. 3
	PLOT SCALE = 400,0000' / in.	DRAWN -	REVISED -			CONTRACT NO. 68673				
	PLOT DATE = 5/12/2011	CHECKED -	REVISED -	SCALE:      SHEET NO.    OF    SHEETS    STA.                    TO STA.		ILLINOIS FED. AID PROJECT				

SUMMARY OF QUANTITIES			CONSTRUCTION TYPE CODE		
CODE NO	ITEM	UNIT	TOTAL QUANTITIES	URBAN 80% FED 20% STATE 0005	100% STATE
40600215	POLYMERIZED BITUMINOUS MATERIALS (PRIME COAT)	TON	25.3	25.3	
40600895	CONSTRUCTING TEST STRIP	EACH	2	2	
40600982	HOT - MIX ASPHALT SURFACE REMOVAL - BUTT JOINT	SQ YD	5312	5312	
40600990	TEMPORARY RAMP	SQ YD	736	736	
40603235	POLYMERIZED HOT - MIX ASPHALT BINDER COURSE, IL - 19.0, N70	TON	3800	3800	
40603570	POLYMERIZED HOT - MIX ASPHALT SURFACE COURSE, MIX "E", N90	TON	5467	5467	
44000157	HOT - MIX ASPHALT SURFACE REMOVAL, 2 "	SQ YD	53860	53860	
44000166	HOT - MIX ASPHALT SURFACE REMOVAL, 4 1/4"	SQ YD	26151	26151	
44200620	CLASS A PATCHES, TYPE II, 14 INCH	SQ YD	194	194	
44200624	CLASS A PATCHES, TYPE III, 14 INCH	SQ YD	109	109	
44200628	CLASS A PATCHES, TYPE IV, 14 INCH	SQ YD	300	300	
44201019	CLASS B PATCHES, TYPE II, 14 INCH	SQ YD	234	234	
44201023	CLASS B PATCHES, TYPE III, 14 INCH	SQ YD	37	37	
44201025	CLASS B PATCHES, TYPE IV, 14 INCH	SQ YD	627	627	
44201299	DOWEL BARS 1 1/2"	EACH	816	816	
44213000	PATCHING REINFORCEMENT	SQ YD	608	608	
44213100	PAVEMENT FABRIC	SQ YD	664	664	
44213200	SAW CUTS	FOOT	7964	7964	
44213204	TIE BARS 3/4"	EACH	130	130	
48101200	AGGREGATE SHOULDERS, TYPE B	TON	673	673	
48203100	HOT - MIX ASPHALT SHOULDERS	TON	8283	8283	
64200105	SHOULDER RUMBLE STRIP	FOOT	28020	28020	
67000400	ENGINEER'S FIELD OFFICE, TYPE A	CAL MO	2	2	
67100100	MOBILIZATION	L SUM	1	1	

SUMMARY OF QUANTITIES			CONSTRUCTION TYPE CODE		
CODE NO	ITEM	UNIT	TOTAL QUANTITIES	URBAN 80% FED 20% STATE 0005	100% STATE
70100420	TRAFFIC CONTROL AND PROTECTION, STANDARD 701411	EACH	4	4	
70100700	TRAFFIC CONTROL AND PROTECTION, STANDARD 701406	L SUM	1	1	
70100800	TRAFFIC CONTROL AND PROTECTION, STANDARD 701401	L SUM	1	1	
70100820	TRAFFIC CONTROL AND PROTECTION, STANDARD 701451	L SUM	1	1	
70100825	TRAFFIC CONTROL AND PROTECTION, STANDARD 701456	L SUM	1	1	
70103815	TRAFFIC CONTROL SURVEILLANCE	CAL DA	10	10	
70300100	SHORT-TERM PAVEMENT MARKING	FOOT	18524	18524	
70300210	TEMPORARY PAVEMENT MARKING - LETTERS AND SYMBOLS	SQ FT	343.2	343.2	
70300220	TEMPORARY PAVEMENT MARKING - LINE 4"	FOOT	48648	48648	
70300240	TEMPORARY PAVEMENT MARKING - LINE 6"	FOOT	3739	3739	
70300250	TEMPORARY PAVEMENT MARKING - LINE 8"	FOOT	3759	3759	
70301000	WORK ZONE PAVEMENT MARKING REMOVAL	SQ FT	3088	3088	
* 78004230	PREFORMED PLASTIC PAVEMENT MARKING, TYPE B -INLAID-LINE 6"	FOOT	3739	3739	
* 78100100	RAISED REFLECTIVE PAVEMENT MARKER	EACH	362	362	
78300200	RAISED REFLECTIVE PAVEMENT MARKER REMOVAL	EACH	362	362	
X2503100	MOWING	UNIT	77		77
X7015005	CHANGEABLE MESSAGE SIGN	CAL DA	120	120	
* X7800605	URETHANE PAVEMENT MARKING - LETTERS AND SYMBOLS	SQ FT	343.2	343.2	
* X7800610	URETHANE PAVEMENT MARKING - LINE 4"	FOOT	48648	48648	
* X7800640	URETHANE PAVEMENT MARKING - LINE 8"	FOOT	3759	3759	
XZ013798	CONSTRUCTION STATION LAYOUT	L SUM	1	1	
Z0021400	EXPANSION JOINT (SPECIAL)	FOOT	96	96	
Z0034105	MATERIAL TRANSFER DEVICE	TON	9266	9266	

\*SPECIALTY ITEM

FILE NAME general.dgn	USER NAME = AdadaSA	DESIGNED -	REVISED -	STATE OF ILLINOIS DEPARTMENT OF TRANSPORTATION	SUMMARY OF QUANTITIES	F.A. RTE. 318	SECTION (72-7)RS-1	COUNTY PEORIA	TOTAL SHEETS 32	SHEET NO. 4	
	PLOT SCALE = 100.0000' / in.	DRAWN -	REVISED -			CONTRACT NO. 68673					
	PLOT DATE = 5/12/2011	CHECKED -	REVISED -			FED. ROAD DIST. NO. [ILLINOIS] FED. AID PROJECT					
		DATE -	REVISED -								

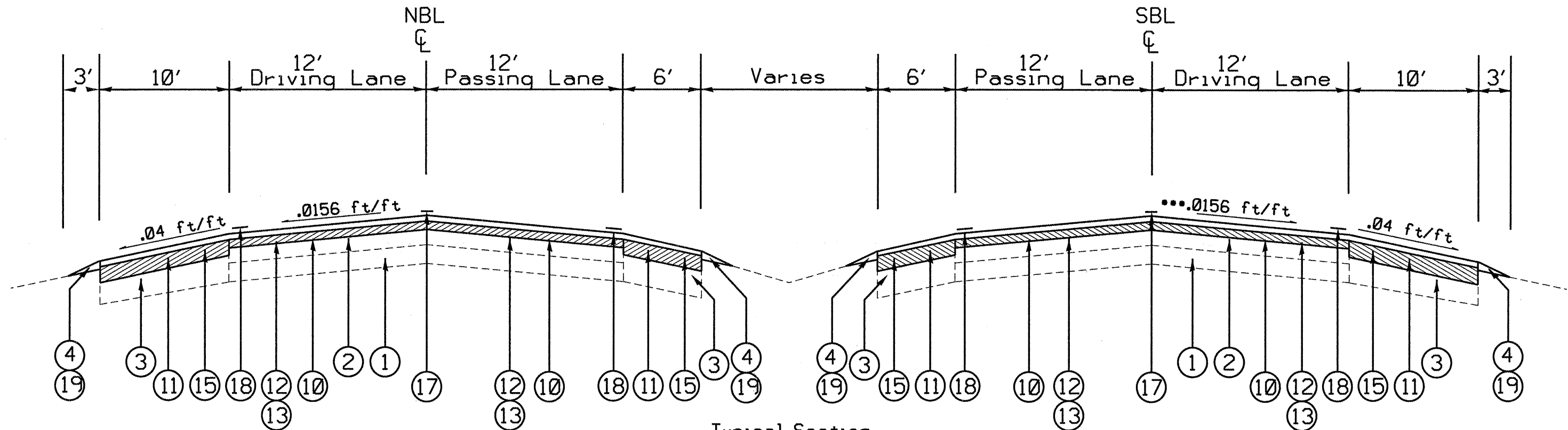

Typical Section  
 IL Route 6  
 Northbound  
 Sta. 19+35 to 88+00  
 Southbound  
 Sta. 20+04 to 72+00

Bridge Omission 57+35.25 to 58+38.75

LEGEND

1. Existing PCC Pavement
2. Existing Hot-Mix Asphalt Overlay\*
3. Existing BAM Shoulder with Hot-Mix Asphalt Overlay
4. Existing Aggregate Shoulder, Type B
5. Existing 6" Pipe Underdrain
10. Proposed Hot-Mix Asphalt Surface Removal 2"\*\*\*
11. Proposed Hot-Mix Asphalt Surface Removal 4 1/4"
12. Proposed Hot-Mix Asphalt Binder Course, N70 2 1/4"
13. Proposed Hot-Mix Asphalt Surface Course, Mix "E", N70 1 1/2"
14. Proposed Hot-Mix Asphalt Surface Course, Mix "E", N70 2"
15. Proposed Hot-Mix Asphalt Shoulders 6", Mix "C", N50
16. Proposed Hot-Mix Asphalt Shoulders 4 1/4", Mix "C", N50
17. Proposed Preformed Plastic Pavement Marking, Type B-Inlaid, 6"
18. Proposed Urethane Pavement Marking, 4"
19. Proposed Aggregate Shoulder, Type B

Match existing slope for HOT-MIX ASPHALT SURFACE REMOVAL for the depths specified.

\*Existing HMA Overlay thickness

NBL 19+35 to 31+00 5"  
 NBL 31+00 to 97+07 3 1/4"

SBL 20+04 to 75+00 5"  
 SBL 75+00 to 91+84 3 1/4"

Ramps A-D 3 1/2"

\*\* See Resurfacing Table for HMA SURFACE REMOVAL BUTT JOINT locations.

\*\*\* Match slope in superelevation locations  
 NBL Full Superelevation 0.06 Sta. 81+95 to 89+92  
 SBL Full Superelevation 0.06 Sta. 81+95 to 89+92

FILE NAME = general.dgn	USER NAME = AdadesA	DESIGNED -	REVISED -	<b>STATE OF ILLINOIS DEPARTMENT OF TRANSPORTATION</b>	<b>TYPICAL SECTIONS</b>	F.A.P. RTE. 318	SECTION (72-7RS-1)	COUNTY PEORIA	TOTAL SHEETS 32	SHEET NO. 5	
PLOT SCALE = 400.0001' / in.	DRAWN -	REVISED -	SCALE:			SHEET NO. OF SHEETS	STA. TO STA.	CONTRACT NO. 68673			
PLOT DATE = 5/11/2011	CHECKED -	REVISED -	ILLINOIS FED. AID PROJECT								
DATE -	REVISED -										

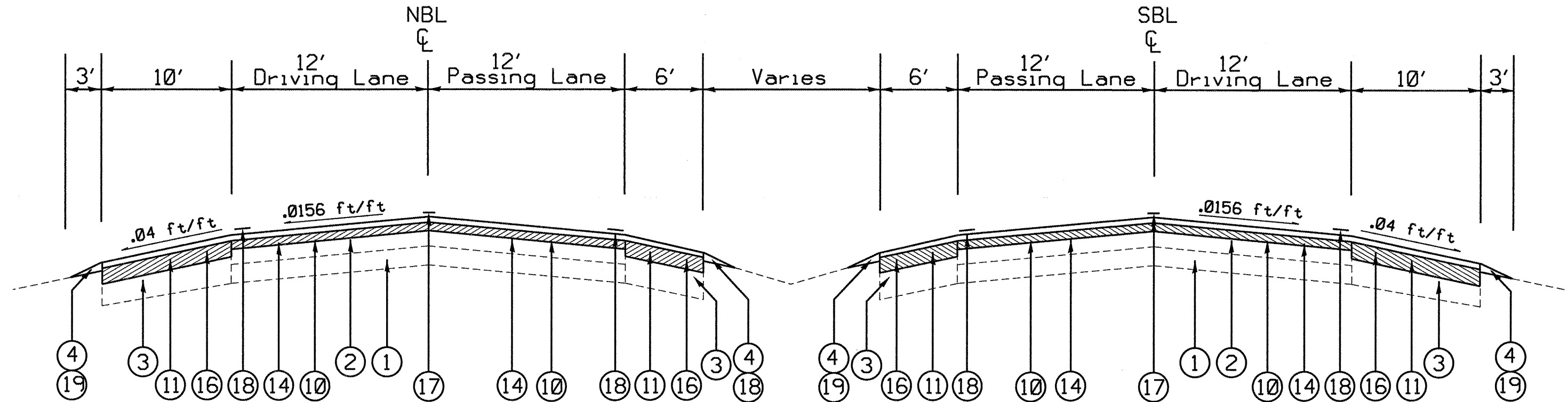

Typical Section  
 IL Route 6  
 Northbound  
 Sta. 88+00 to 97+07

Southbound  
 Sta. 72+00 to 91+84

Bridge Omission 57+35.25 to 58+38.75

Match existing slope for HOT-MIX ASPHALT SURFACE  
 REMOVAL for the depths specified.

•Existing HMA Overlay thickness

NBL 19+35 to 31+00 5'  
 NBL 31+00 to 97+07 3 1/4"

SBL 20+04 to 75+00 5'  
 SBL 75+00 to 91+84 3 1/4"

Ramps A-D 3 1/2"

•• See Resurfacing Table for HMA SURFACE REMOVAL BUTT JOINT  
 locations.

LEGEND

1. Existing PCC Pavement
2. Existing Hot-Mix Asphalt Overlay\*
3. Existing BAM Shoulder with Hot-Mix Asphalt Overlay
4. Existing Aggregate Shoulder, Type B
5. Existing 6" Pipe Underdrain
10. Proposed Hot-Mix Asphalt Surface Removal 2"••
11. Proposed Hot-Mix Asphalt Surface Removal 4 1/4"
12. Proposed Hot-Mix Asphalt Binder Course, N70 2 1/4"
13. Proposed Hot-Mix Asphalt Surface Course, Mix "E", N70 1 1/2"
14. Proposed Hot-Mix Asphalt Surface Course, Mix "E", N70 2"
15. Proposed Hot-Mix Asphalt Shoulders 6", Mix "C", N50
16. Proposed Hot-Mix Asphalt Shoulders 4 1/4", Mix "C", N50
17. Proposed Preformed Plastic Pavement Marking, Type B-Inlaid, 6"
18. Proposed Urethane Pavement Marking, 4"
19. Proposed Aggregate Shoulder, Type B

FILE NAME = general.dgn	USER NAME = AdadaSA	DESIGNED -	REVISED -	<b>STATE OF ILLINOIS DEPARTMENT OF TRANSPORTATION</b>	<b>TYPICAL SECTIONS</b>	F.A.P. RTE. 318	SECTION (72-7)RS-1	COUNTY PEORIA	TOTAL SHEETS 32	SHEET NO. 6			
	PLOT SCALE = 400.0001' / 1"	DRAWN -	REVISED -			SCALE:	SHEET NO. OF SHEETS	STA.	TO STA.	CONTRACT NO. 68673			
	PLOT DATE = 5/11/2011	CHECKED -	REVISED -			ILLINOIS FED. AID PROJECT							
		DATE -	REVISED -										

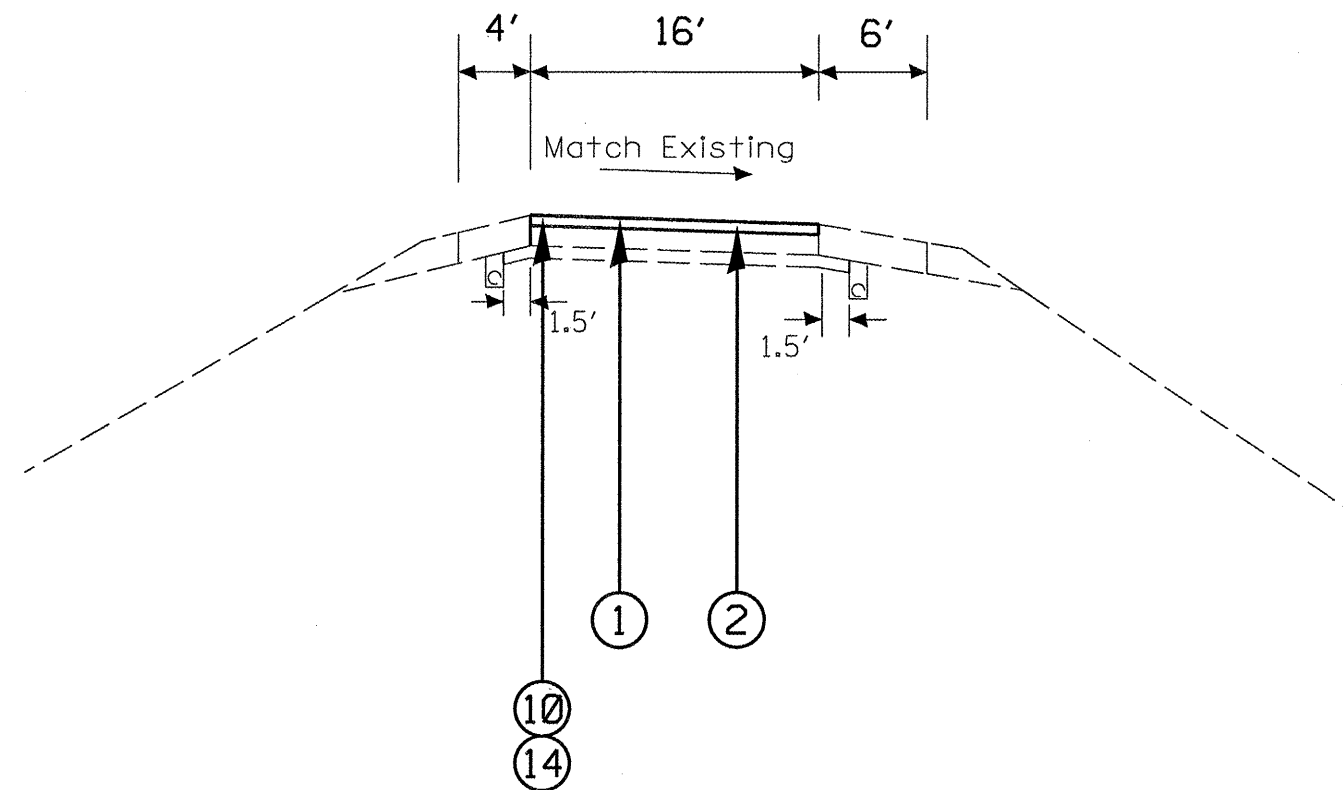

RAMP A STA. 0+00 - 21+42  
 RAMP B STA. 1+71 - 9+86  
 RAMP C STA. 0+00 - 25+89  
 RAMP D STA. 1+56 - 33+54

LEGEND

1. Existing PCC Pavement
2. Existing Hot-Mix Asphalt Overlay\*
3. Existing BAM Shoulder with Hot-Mix Asphalt Overlay
4. Existing Aggregate Shoulder, Type B
5. Existing 6" Pipe Underdrain
10. Proposed Hot-Mix Asphalt Surface Removal 2" \*\*
11. Proposed Hot-Mix Asphalt Surface Removal 4 1/4"
12. Proposed Hot-Mix Asphalt Binder Course, N70 2 1/4"
13. Proposed Hot-Mix Asphalt Surface Course, Mix "E", N70 1 1/2"
14. Proposed Hot-Mix Asphalt Surface Course, Mix "E", N70 2"
15. Proposed Hot-Mix Asphalt Shoulders 6", Mix "C", N50
16. Proposed Hot-Mix Asphalt Shoulders 4 1/4", Mix "C", N50
17. Proposed Preformed Plastic Pavement Marking, Type B-Inlaid, 6"
18. Proposed Urethane Pavement Marking, 4"
19. Proposed Aggregate Shoulder, Type B

Match existing slope for HOT-MIX ASPHALT SURFACE REMOVAL for the depths specified.

\*Existing HMA Overlay thickness

NBL 19+35 to 31+00 5"  
 NBL 31+00 to 97+07 3 1/4"

SBL 20+04 to 75+00 5"  
 SBL 75+00 to 91+84 3 1/4"

Ramps A-D 3 1/2"

\*\* See Resurfacing Table for HMA SURFACE REMOVAL BUTT JOINT locations.

FILE NAME = general.dgn	USER NAME = AdadeSA	DESIGNED -	REVISED -	<b>STATE OF ILLINOIS DEPARTMENT OF TRANSPORTATION</b>	<b>TYPICAL SECTIONS</b>		F.A.P. RTE. 318	SECTION (72-7)RS-1	COUNTY PEORIA	TOTAL SHEETS 32	SHEET NO. 7	
		DRAWN -	REVISED -		SCALE:	SHEET NO. OF SHEETS	STA. TO STA.	CONTRACT NO. 68673				
		CHECKED -	REVISED -		ILLINOIS FED. AID PROJECT							
		DATE -	REVISED -									

Resurfacing Table

Location	Length	Width	Area	Butt Joint Depth	HMA Surface Removal Butt Joint	Temporary Ramp	Polymerized Bituminous Materials (Prime Coat)	Polymerized	Polymerized	Polymerized	Material Transfer Device	RDWY	SHLDR	HMA	HMA	Aggregate Shoulder Type B	Shoulder Rumble Strip
								HMA Surf Cse Mix E, N90 2"	HMA Surf Cse Mix E, N90 1.5"	HMA Binder Cse Mix E, N90 2.25"		HMA Surface Removal 2"	HMA Surface Removal 4.25"	HMA Shoulder 4.25"	HMA Shoulder 6"		
	Feet	Feet	Sq Yd	Inches	Sq Yd	Sq Yd	Ton	Ton	Ton	Ton	Ton		Sq Yd	Ton	Ton	Ton	foot
SB IL 6																	
20+04 TO 20+74	70	24	186.7	3.75	311.1	40.0	0.1		15.7	23.5	39.2		124.4		41.8	4.0	140.0
20+74 TO 55+27	3453	24	9208				4.8		773.5	1160.2	1933.7	9208.0	6138.7		2062.6	196.6	6906.0
55+27 TO 55+97	70	24	186.7	3.75	311.1	40.0	0.1		15.7	23.5	39.2		124.4		41.8	4.0	140.0
Expansion Joint																	
56+03 TO 57+35	132	24	352	2	586.7	80.0	0.2	39.4			39.4		234.7		78.8	7.5	264.0
Structure 072-0142																	
58+39 TO 59+62	123	24	328	2	546.7	80.0	0.2	36.7			36.7		218.7		73.5	7.0	246.0
Expansion Joint																	
59+68 TO 60+38	70	24	186.7	3.75	311.1	40.0	0.1		15.7	23.5	39.2		124.4		41.8	4.0	140.0
60+48 TO 71+10	1062	24	2832				1.5		237.9	356.8	594.7	2832.0	1888.0		634.4	60.5	2124.0
71+10 TO 72+00	90	24	240	2.25	400		0.1		20.2	30.2	50.4	240.0	160.0		53.8	5.1	180.0
72+00 TO 91+74	1974	24	5264				2.7	589.6			589.6	5264.0	3509.3	835.2			3248.0
91+74 TO 91+84	10	24	26.7	2	44.4	40.0	0.0	3.0			3.0		17.8	4.2			20.0
NB IL 6																	
19+35 TO 20+05	70	24	186.7	3.75	311.1	40.0	0.1		15.7	23.5	39.2		124.4		41.8	4.0	140.0
20+05 TO 55+27	3522	24	9392				4.9		788.9	1183.4	1972.3	9392.0	6261.3		2103.8	200.6	7044.0
55+27 TO 55+97	70	24	186.7	3.75	311.1	40.0	0.1		15.7	23.5	39.2		124.4		41.8	4.0	140.0
Expansion Joint																	
56+03 TO 57+35	132	24	352	2	586.7	80.0	0.2	39.4			39.4		234.7		78.8	7.5	264.0
Structure 072-0141																	
58+39 TO 59+62	123	24	328	2	546.7	80.0	0.2	36.7			36.7		218.7		73.5	7.0	246.0
Expansion Joint																	
59+68 TO 60+38	70	24	186.7	3.75	311.1	40.0	0.1		15.7	23.5	39.2		124.4		41.8	4.0	140.0
60+38 TO 87+10	2672	24	7125.3				3.7		598.5	897.8	1496.3	7125.3	4750.2		1596.1	152.2	5344.0
87+10 TO 88+00	90	24	240	2.25	400		0.1		20.2	30.2	50.4	240.0	160.0		53.8	5.1	180.0
88+00 TO 96+97	897	24	2392				1.2	267.9			267.9	2392.0	1594.7	379.5			1094.0
96+97 TO 97+07	10	24	26.7	2	44.4	40.0	0.0	3.0			3.0		17.8	4.2			20.0
Ramps*																	
				2	290	96.1	4.9	1917.4			1917.4	17166.5					
TOTAL	14710.0		39226.9		5312.2	736.1	25.3	2933.1	2533.4	3799.6	9266.1	53859.8	26151.1	1223.2	7059.9		28020.0
								5466.5						8283.1	673.0		

\* See Ramp Resurfacing Table for quantities

PRIME COAT APPLICATION RATES		
SURFACE TYPE	BITUMINOUS PRIME COAT	AGGREGATE PRIME COAT
	(GAL/SQ YD)	(LB/SQ YD)
ON GRANULAR BASE	0.5	4
ON COLD MILLED SURFACE	0.1	4
EXISTING PAVEMENT	0.05	4
FOG COAT ON NEW BINDER	0.03	2
0.004 TONS PER GALLON FOR BITUMINOUS PRIME COAT		

HMA AND COARSE AGGREGATE APPLICATION RATES	
HMA SURFACE AND BINDER	112 LB/SQ YD IN
ALL OTHER HMA	112 LB/SQ YD IN
COARSE AGGREGATE	2.05 TONS/CU YD







Class A Patching Schedule						
Location	Class A Type II Patch 14"	Class A Type III Patch 14"	Class A Type IV Patch 14"	Patching Reinforcement	Saw Cuts	Tie Bars
	Sq Yd	Sq Yd	Sq Yd	Sq Yd	Foot	Each
	Northbound Lane	130.17	56.00	100.00	290.17	1639.5
Southbound Lane	64.00	53.33	200.00	317.33	1338	75.00
<b>Total</b>	<b>194.17</b>	<b>109.33</b>	<b>300.00</b>	<b>607.50</b>	<b>2977.50</b>	<b>130.00</b>

Class B Patching Schedule						
Location	Type II Patch 14"	Type III Patch 14"	Type IV Patch 14"	Dowel Bars	Pavement Fabric	Saw Cuts
	Sq Yd	Sq Yd	Sq Yd	Each	Sq Yd	Each
	Ramp Locations					
Ramp A			213	56	213	1200
Ramp B			213	76	213	1224
Ramp C	220	21	72	608	93	1746
Ramp D	14	16	128	76	144	816
<b>TOTAL</b>	<b>234</b>	<b>37</b>	<b>627</b>	<b>816</b>	<b>664</b>	<b>4986</b>

ENGINEER'S FIELD OFFICE	
LOCATION	CAL MO
Jobsite	2
<b>TOTAL</b>	<b>2</b>

TRAFFIC CONTROL & PROTECTION 701401	
LOCATION	LSUM
Jobsite	1
<b>TOTAL</b>	<b>1</b>

TRAFFIC CONTROL SURVEILLANCE	
LOCATION	CAL DAYS
Jobsite	10
<b>TOTAL</b>	<b>10</b>

MOBILIZATION	
LOCATION	L SUM
Jobsite	1
<b>TOTAL</b>	<b>1</b>

TRAFFIC CONTROL & PROTECTION 701406	
LOCATION	L SUM
Jobsite	1
<b>TOTAL</b>	<b>1</b>

SHOULDER RUMBLE STRIP	
LOCATION	FOOT
Jobsite	15084
<b>TOTAL</b>	<b>15084</b>

MOWING	
LOCATION	UNIT
Jobsite	77
<b>TOTAL</b>	<b>77</b>

TRAFFIC CONTROL & PROTECTION 701411	
LOCATION	EACH
IL 6 / US 150	4
<b>TOTAL</b>	<b>4</b>

CHANGEABLE MESSAGE SIGN	
LOCATION	CAL DAYS
Jobsite	120
4 signs @ 30 days each	
<b>TOTAL</b>	<b>120</b>

CONSTRUCTION STATION LAYOUT	
LOCATION	L SUM
Jobsite	1
<b>TOTAL</b>	<b>1</b>

TRAFFIC CONTROL & PROTECTION 701451	
LOCATION	L SUM
Jobsite	1
<b>TOTAL</b>	<b>1</b>

CONSTRUCTING TEST STRIP	
LOCATION	EACH
Jobsite	2
<b>TOTAL</b>	<b>2</b>

TRAFFIC CONTROL & PROTECTION 701456	
LOCATION	L SUM
Jobsite	1
<b>TOTAL</b>	<b>1</b>

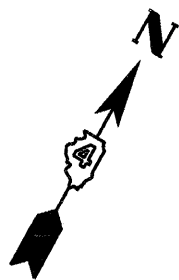

Project Begins  
Sta. 20+04 SBL  
STA. 19+35 NBL

Project Ends  
NB Sta. 97+07  
SB Sta. 91+84

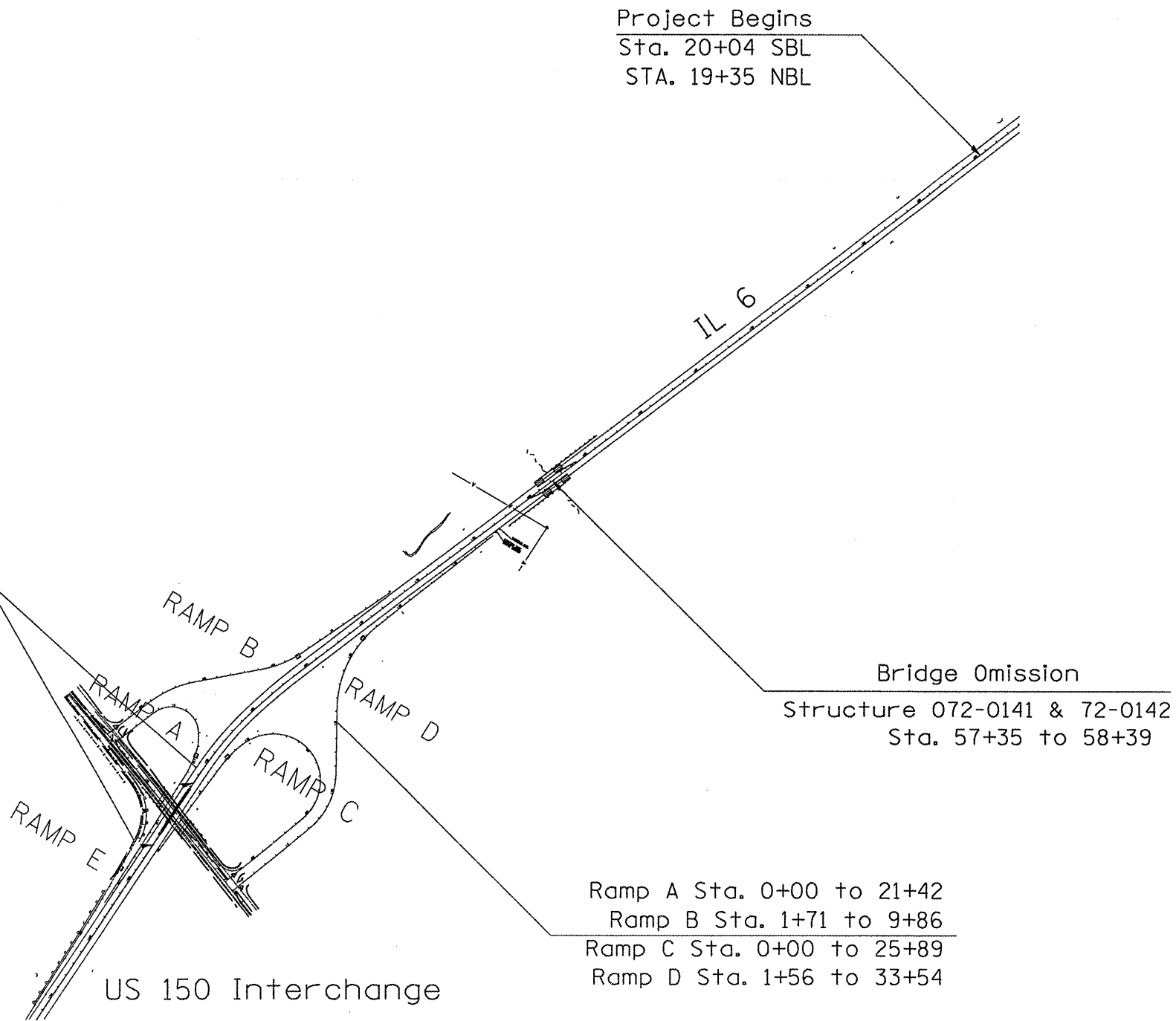

Ramp A Sta. 0+00 to 21+42  
Ramp B Sta. 1+71 to 9+86  
Ramp C Sta. 0+00 to 25+89  
Ramp D Sta. 1+56 to 33+54

Bridge Omission  
Structure 072-0141 & 72-0142  
Sta. 57+35 to 58+39

US 150 Interchange

FILE NAME = general.dgn	USER NAME = AdedeSA	DESIGNED -	REVISED -	<b>STATE OF ILLINOIS DEPARTMENT OF TRANSPORTATION</b>	<b>LINE DIAGRAM</b>	F.A.P. RTE. 318	SECTION (72-7)RS-1	COUNTY PEORIA	TOTAL SHEETS 30	SHEET NO. 13	CONTRACT NO. 68673	
	PLOT SCALE = 400.0001' / in.	DRAWN -	REVISED -			SCALE:	SHEET NO. OF SHEETS STA. TO STA.	ILLINOIS FED. AID PROJECT				
	PLOT DATE = 5/11/2011	CHECKED -	REVISED -									
		DATE -	REVISED -									

T9N - R7E - 4PM  
SECTION 14

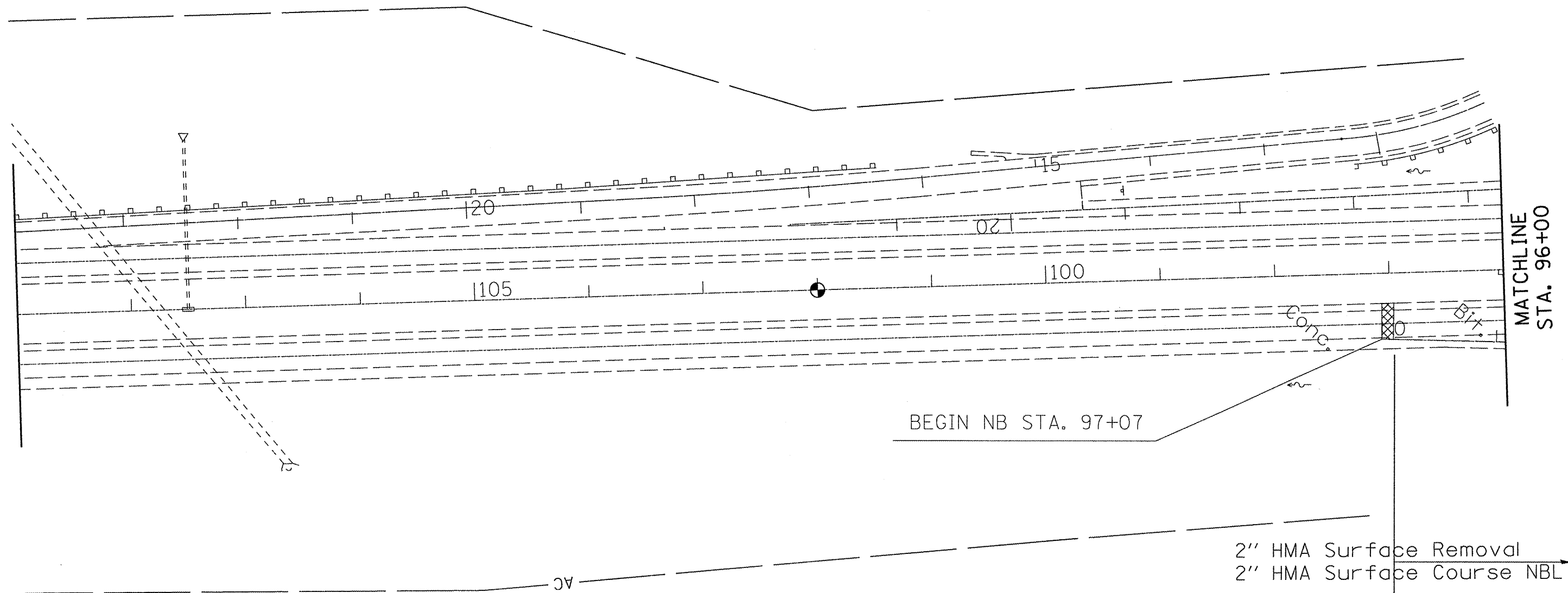

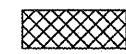
 Butt Joint

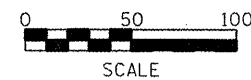

PLOT DATE = 5/11/2011  
FILE NAME = general.dgn  
PLOT SCALE = 90.9091' / in.  
USER NAME = AdedeSA

FILE NAME = general.dgn	USER NAME = AdedeSA	DESIGNED -	REVISED -
		DRAWN -	REVISED -
	PLOT SCALE = 90.9091' / in.	CHECKED -	REVISED -
	PLOT DATE = 5/11/2011	DATE -	REVISED -

**STATE OF ILLINOIS  
DEPARTMENT OF TRANSPORTATION**

<b>PLAN SHEET</b>			
SCALE:	SHEET NO.	OF SHEETS	STA. TO STA.

F.A.P. RTE. 318	SECTION (72-7)RS-1	COUNTY PEORIA	TOTAL SHEETS 32	SHEET NO. 14
CONTRACT NO. 68673				
ILLINOIS FED. AID PROJECT				



BEGIN SB STA. 91+84

STA. 94+37.78 FAP 405 =  
STA. 13+12.84 US 150

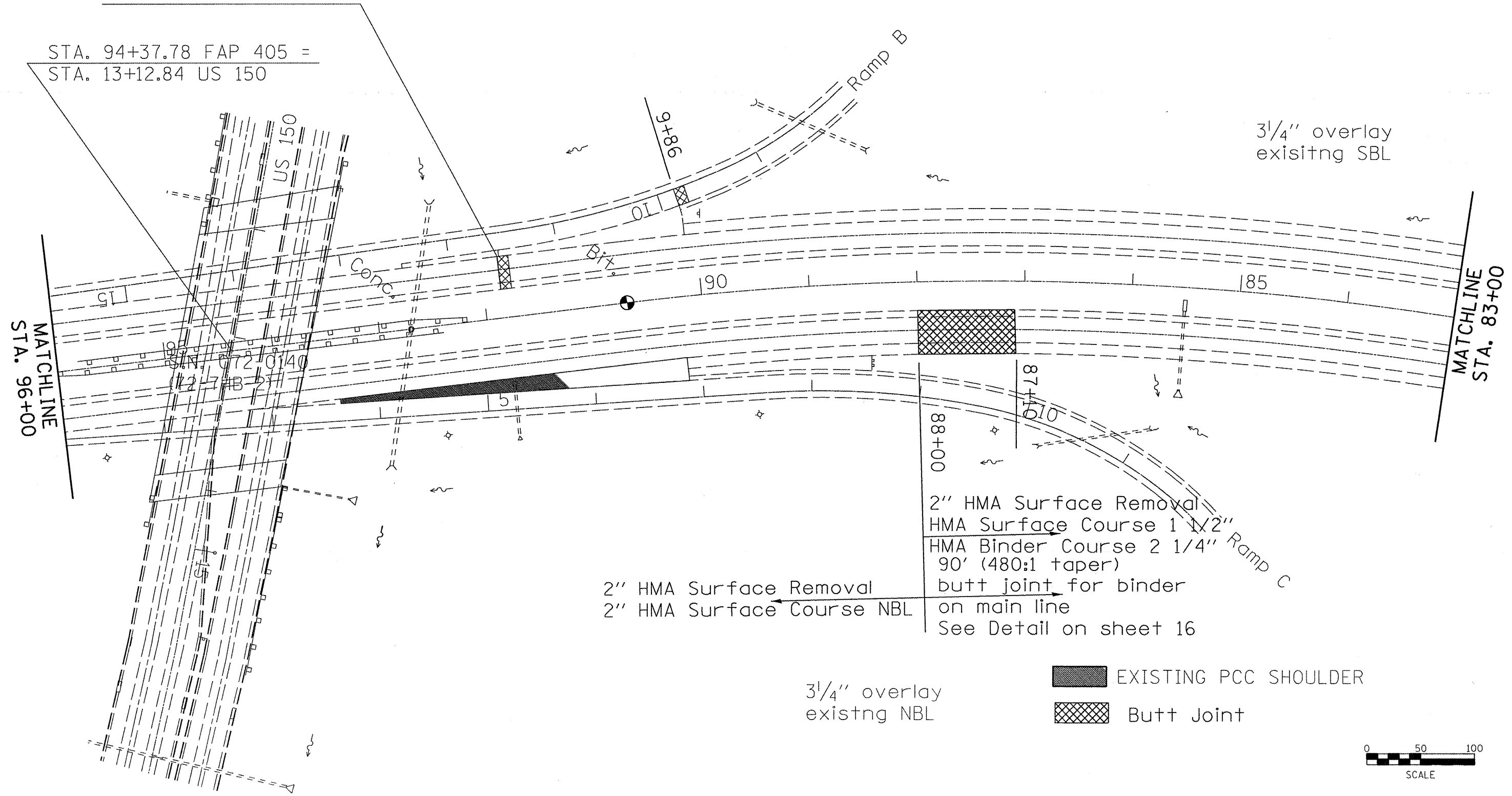

3 1/4" overlay  
existing SBL

2" HMA Surface Removal  
HMA Surface Course 1 1/2"  
HMA Binder Course 2 1/4" Ramp C  
90' (480:1 taper)  
butt joint for binder  
on main line  
See Detail on sheet 16

2" HMA Surface Removal  
2" HMA Surface Course NBL

3 1/4" overlay  
existing NBL

 EXISTING PCC SHOULDER  
 Butt Joint

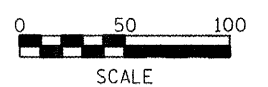

PLOT DATE = 5/11/2011  
FILE NAME = general.dgn  
PLOT SCALE = 90.9091' / in.  
USER NAME = AdedeSA

FILE NAME = general.dgn	USER NAME = AdedeSA	DESIGNED -	REVISED -	<b>STATE OF ILLINOIS DEPARTMENT OF TRANSPORTATION</b>	<b>PLAN SHEET</b>			F.A.P. RTE. 318	SECTION (72-7)RS-1	COUNTY PEORIA	TOTAL SHEETS 32	SHEET NO. 15
	PLOT SCALE = 90.9091' / in.	DRAWN -	REVISED -		SCALE:	SHEET NO.	OF	SHEETS	STA.	TO STA.	<b>CONTRACT NO. 68673</b>	
	PLOT DATE = 5/11/2011	CHECKED -	REVISED -								ILLINOIS FED. AID PROJECT	
		DATE -	REVISED -									

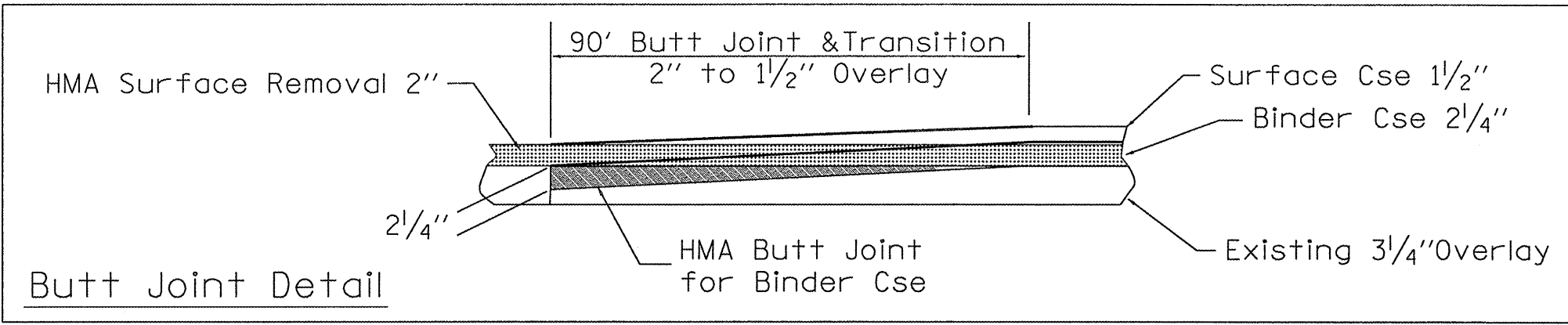

2" HMA Surface Removal  
HMA Surface Course 1 1/2"  
HMA Binder Course 2 1/4"

2" HMA Surface Removal  
2" HMA Surface Course SBL

90' (480:1 taper)  
butt joint for binder  
See Butt Joint Detail

STA. 0+00 RAMP A =  
STA. 72+00.31 FAP 405

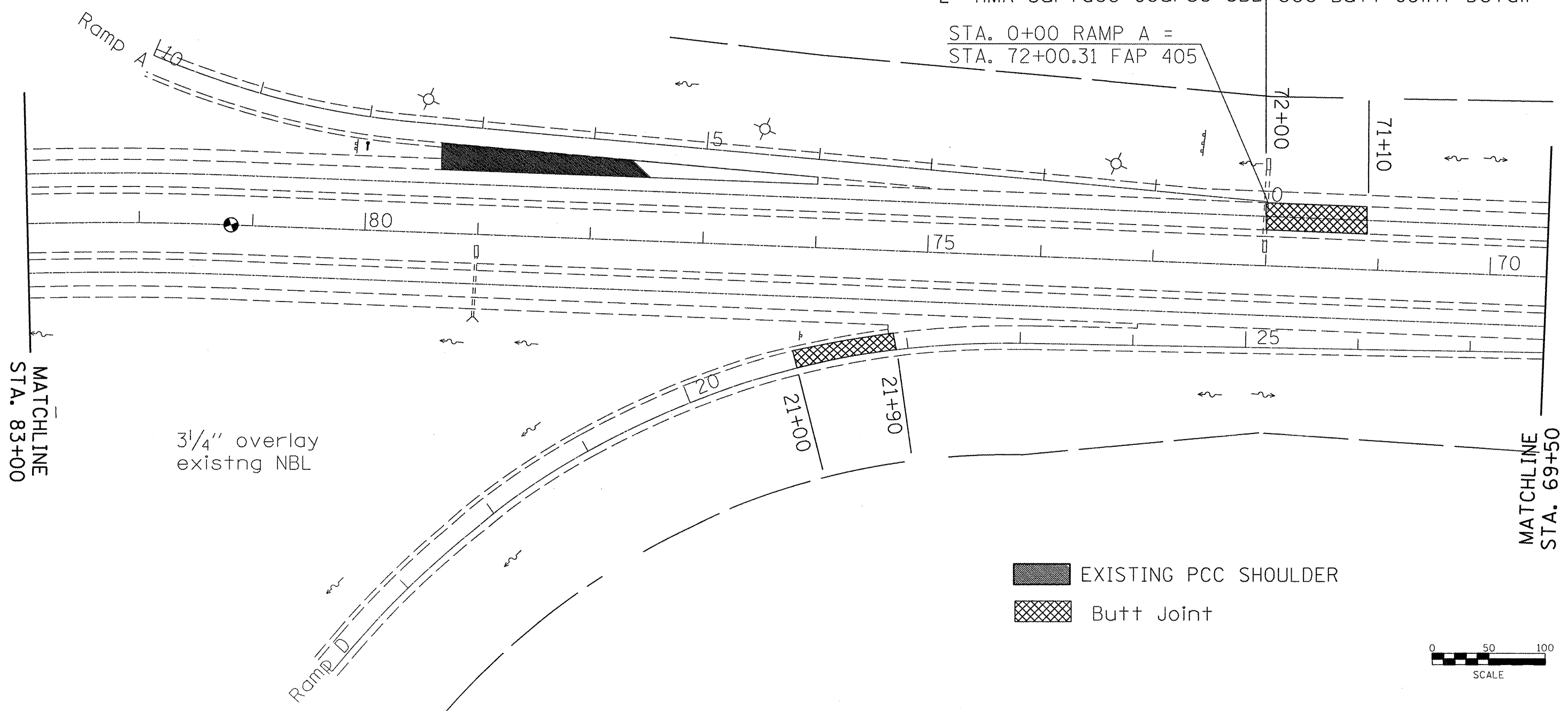

EXISTING PCC SHOULDER

Butt Joint

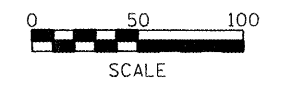

PLOT DATE = 5/11/2011  
FILE NAME = general.dgn  
PLOT SCALE = 90.9091' / in.  
USER NAME = AdedeSA

FILE NAME = general.dgn	USER NAME = AdedeSA	DESIGNED -	REVISED -
		DRAWN -	REVISED -
		CHECKED -	REVISED -
		DATE -	REVISED -

STATE OF ILLINOIS  
DEPARTMENT OF TRANSPORTATION

PLAN SHEET			
SCALE:	SHEET NO.	OF SHEETS	STA. TO STA.

F.A.P. RTE. 318	SECTION (72-7)RS-1	COUNTY PEORIA	TOTAL SHEETS 32	SHEET NO. 16
CONTRACT NO. 68673				
ILLINOIS FED. AID PROJECT				



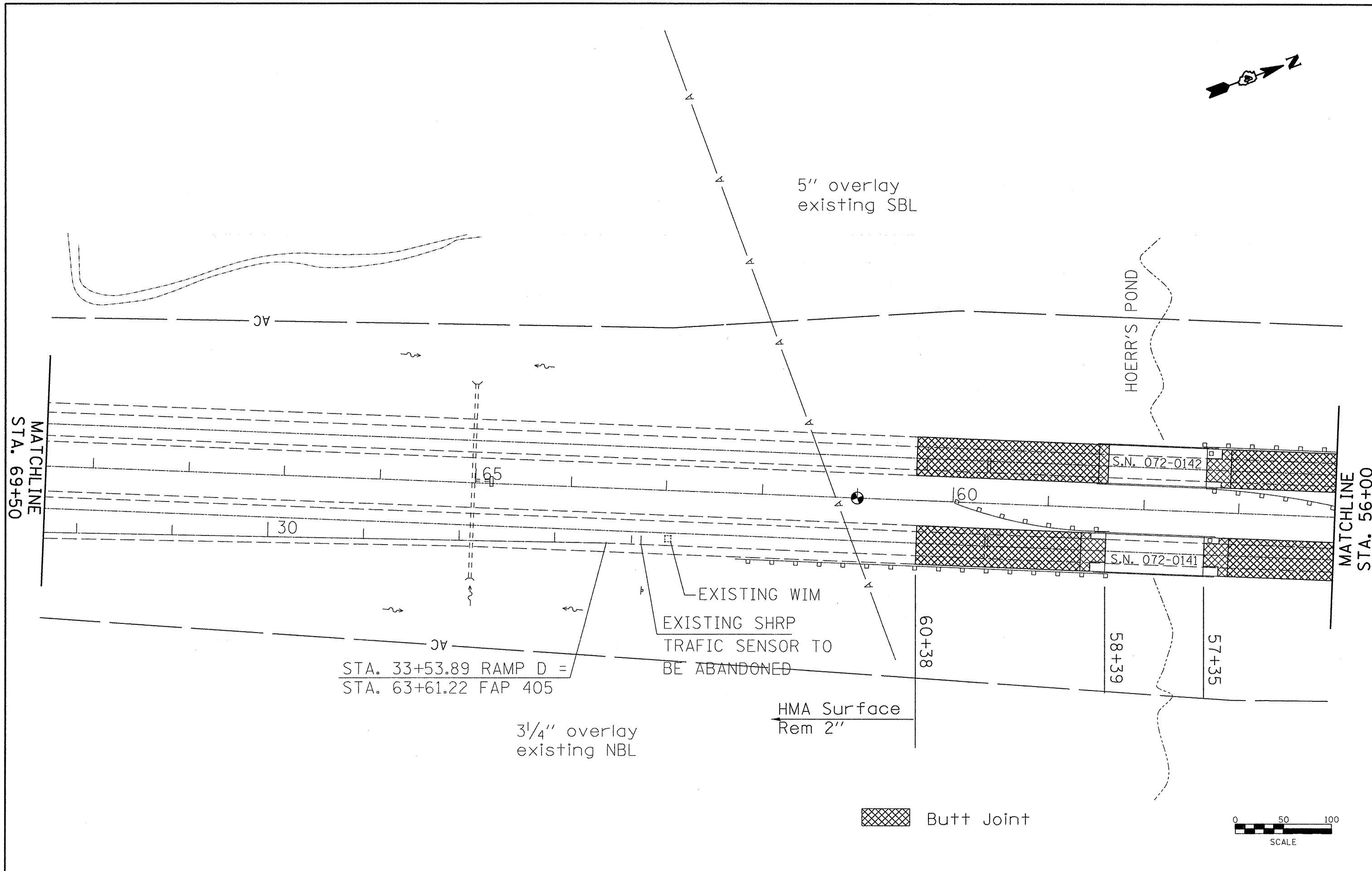
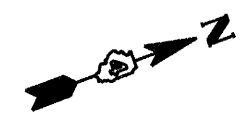

MATCHLINE  
STA. 69+50

MATCHLINE  
STA. 56+00

STA. 33+53.89 RAMP D =  
STA. 63+61.22 FAP 405

EXISTING WIM  
EXISTING SHRP  
TRAFFIC SENSOR TO  
BE ABANDONED

HMA Surface  
Rem 2"

3 1/4" overlay  
existing NBL

5" overlay  
existing SBL

Butt Joint

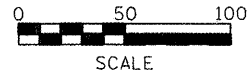

PLOT DATE = 5/11/2011  
FILE NAME = general.dgn  
PLOT SCALE = 90.9091' / in.  
USER NAME = AdadeSA

FILE NAME : general.dgn	USER NAME = AdadeSA	DESIGNED -	REVISED -	<b>STATE OF ILLINOIS DEPARTMENT OF TRANSPORTATION</b>	<b>PLAN SHEET</b>	F.A.P. RTE. 318	SECTION (72-71RS-1)	COUNTY PEORIA	TOTAL SHEETS 32	SHEET NO. 17
	PLOT SCALE = 90.9091' / in.	DRAWN -	REVISED -							
	PLOT DATE = 5/11/2011	CHECKED -	REVISED -		SCALE:	SHEET NO.	OF SHEETS	STA.	TO STA.	<b>CONTRACT NO. 68673</b>
		DATE -	REVISED -							ILLINOIS FED. AID PROJECT

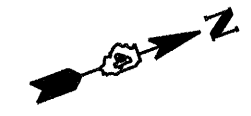

5" overlay  
existing SBL

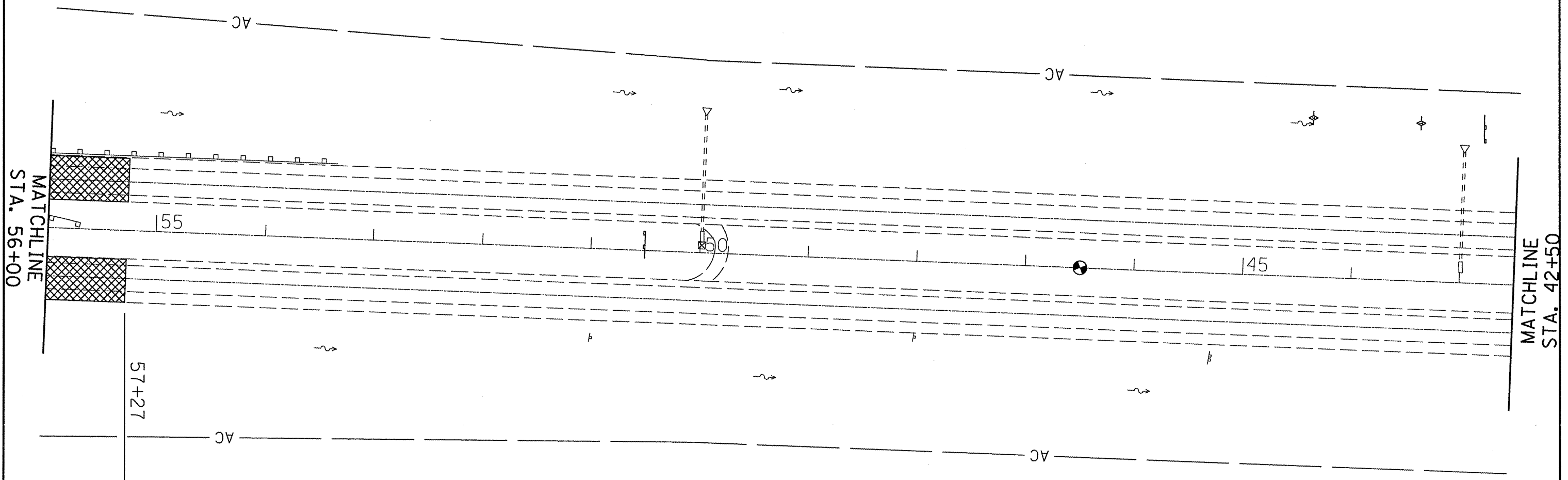

HMA Surface  
Rem 2"

3 1/4" overlay  
existing NBL

 Butt Joint

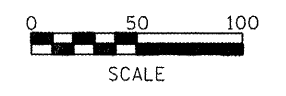



PLOT DATE = 5/11/2011  
FILE NAME = general.dgn  
PLOT SCALE = 90.9091' / in.  
USER NAME = AdadeSA

FILE NAME = general.dgn	USER NAME = AdadeSA	DESIGNED -	REVISED -	<b>STATE OF ILLINOIS DEPARTMENT OF TRANSPORTATION</b>	<b>PLAN SHEET</b>				F.A.P. RTE. 318	SECTION (72-71RS-1)	COUNTY PEORIA	TOTAL SHEETS 32	SHEET NO. 18
	PLOT SCALE = 90.9091' / in.	DRAWN -	REVISED -		SCALE:	SHEET NO.	OF	SHEETS	STA.	TO STA.	<b>CONTRACT NO. 68673</b>		
	PLOT DATE = 5/11/2011	CHECKED -	REVISED -		ILLINOIS FED. AID PROJECT								
		DATE -	REVISED -										

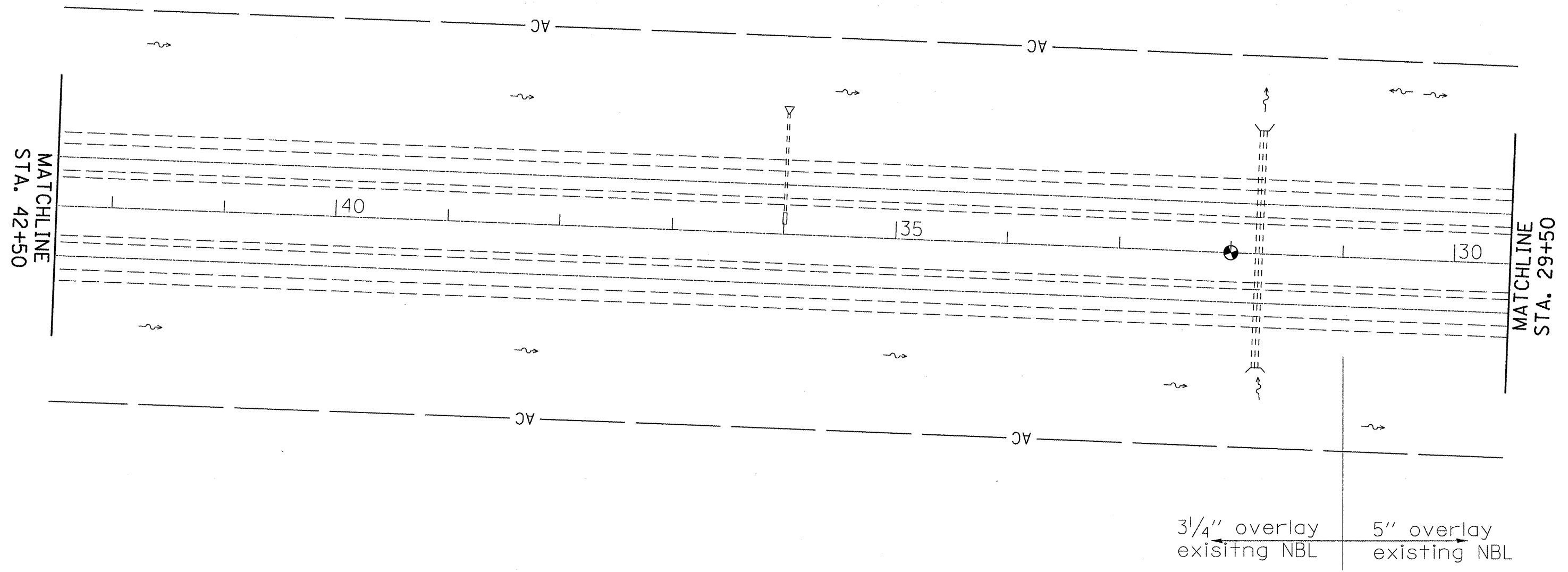

5" overlay  
existing SBL



 GRADING & SHAPING DITCHES

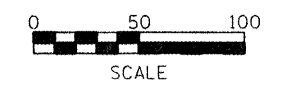

PLOT DATE = 5/11/2011  
 FILE NAME = general.dgn  
 PLOT SCALE = 90.9091' / in.  
 USER NAME = AdadeSA

FILE NAME = general.dgn	USER NAME = AdadeSA	DESIGNED -	REVISED -	<b>STATE OF ILLINOIS DEPARTMENT OF TRANSPORTATION</b>	<b>PLAN SHEET</b>			F.A.P. RTE. 318	SECTION (72-7)RS-1	COUNTY PEORIA	TOTAL SHEETS 32	SHEET NO. 19
	PLOT SCALE = 90.9091' / in.	DRAWN -	REVISED -		SCALE:	SHEET NO.	OF	SHEETS	STA.	TO STA.	<b>CONTRACT NO. 68673</b>	
	PLOT DATE = 5/11/2011	CHECKED -	REVISED -		[ILLINOIS] FED. AID PROJECT							
		DATE -	REVISED -									

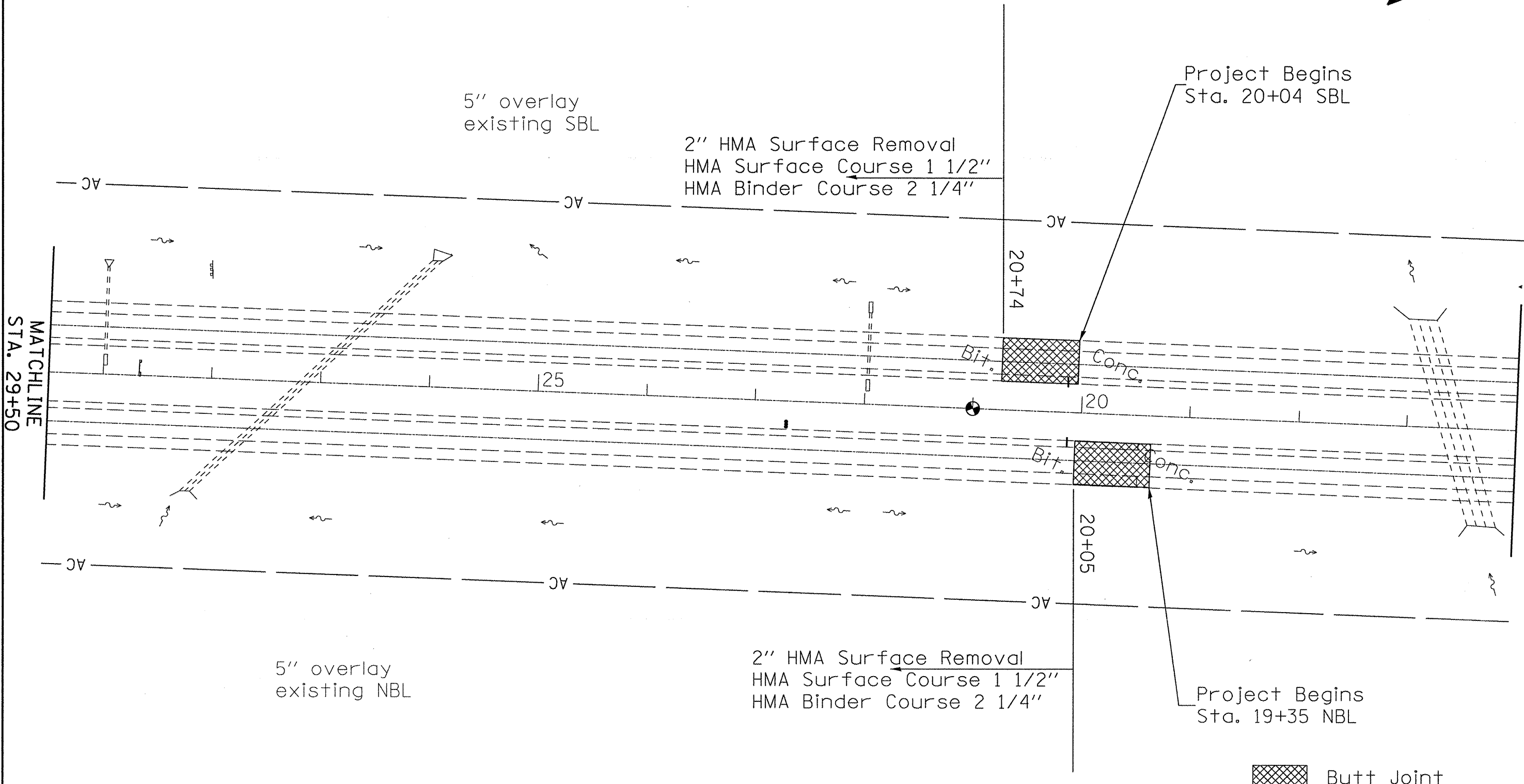

 Buttt Joint

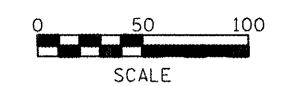

PLOT DATE = 5/11/2011  
 FILE NAME = general.dgn  
 PLOT SCALE = 90.9091' / in.  
 USER NAME = AdadeSA

FILE NAME = general.dgn	USER NAME = AdadeSA	DESIGNED -	REVISED -
		DRAWN -	REVISED -
	PLOT SCALE = 90.9091' / in.	CHECKED -	REVISED -
	PLOT DATE = 5/11/2011	DATE -	REVISED -

**STATE OF ILLINOIS  
 DEPARTMENT OF TRANSPORTATION**

<b>PLAN SHEET</b>				
SCALE:	SHEET NO.	OF SHEETS	STA.	TO STA.

F.A.P. RTE. 318	SECTION (72-7)RS-1	COUNTY PEORIA	TOTAL SHEETS 32	SHEET NO. 20
<b>CONTRACT NO. 68673</b>				
ILLINOIS FED. AID PROJECT				

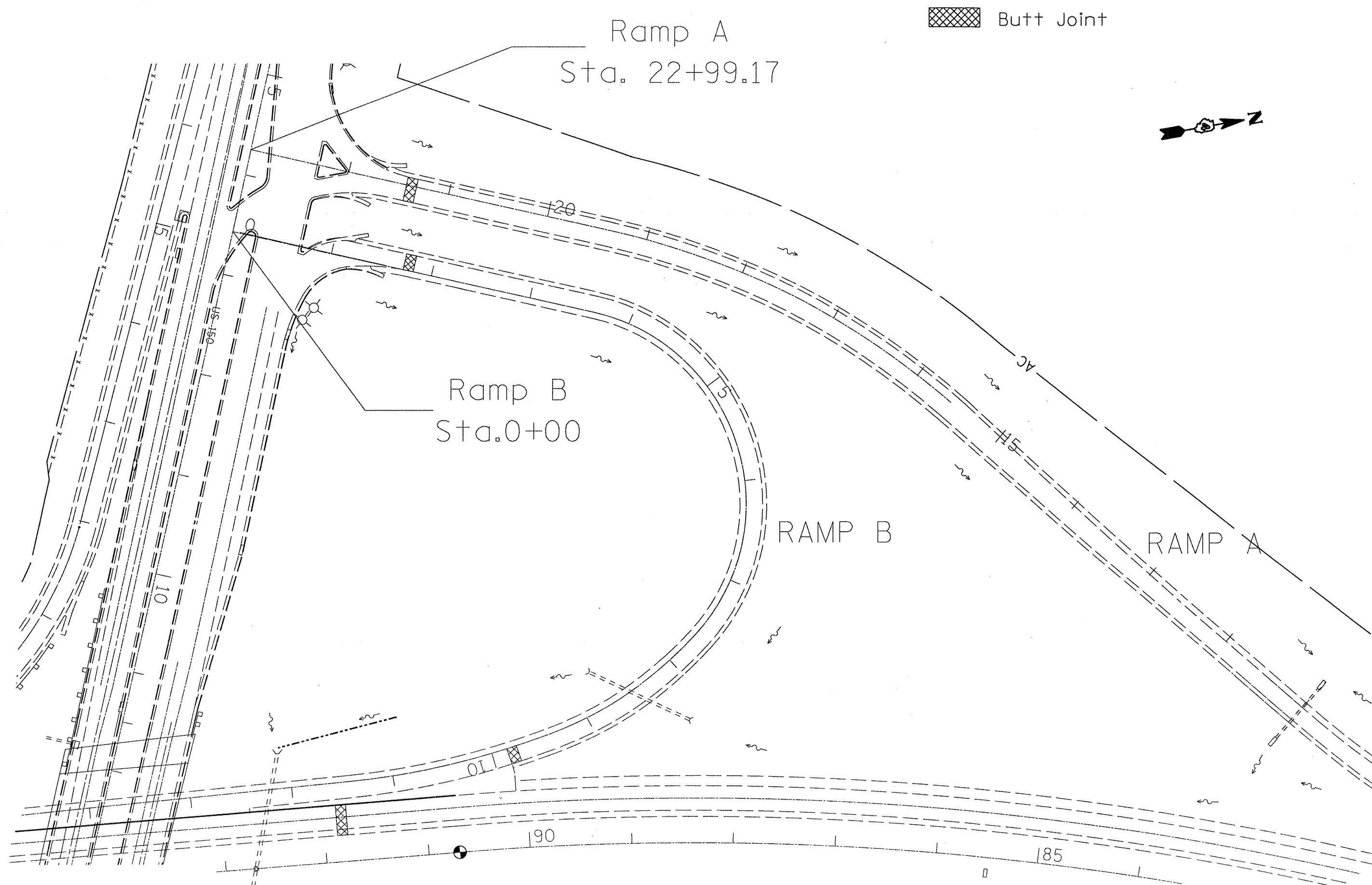

Butt Joint

Ramp A  
Sta. 22+99.17

Ramp B  
Sta. 0+00

RAMP B

RAMP A

FILE NAME = general.dgn	USER NAME = AdadeSA	DESIGNED -	REVISED -	STATE OF ILLINOIS DEPARTMENT OF TRANSPORTATION	US 150 & ILL 6		F.A.P. RTE. 318	SECTION (72-7)RS-1	COUNTY PEORIA	TOTAL SHEETS 32	SHEET NO. 21
	PLOT SCALE = 90.9091' / in.	DRAWN -	REVISED -		SCALE:	SHEET NO.	OF SHEETS	STA.	TO STA.	CONTRACT NO. 68673 ILLINOIS FED. AID PROJECT	
	PLOT DATE = 5/11/2011	CHECKED -	REVISED -								
		DATE -	REVISED -								

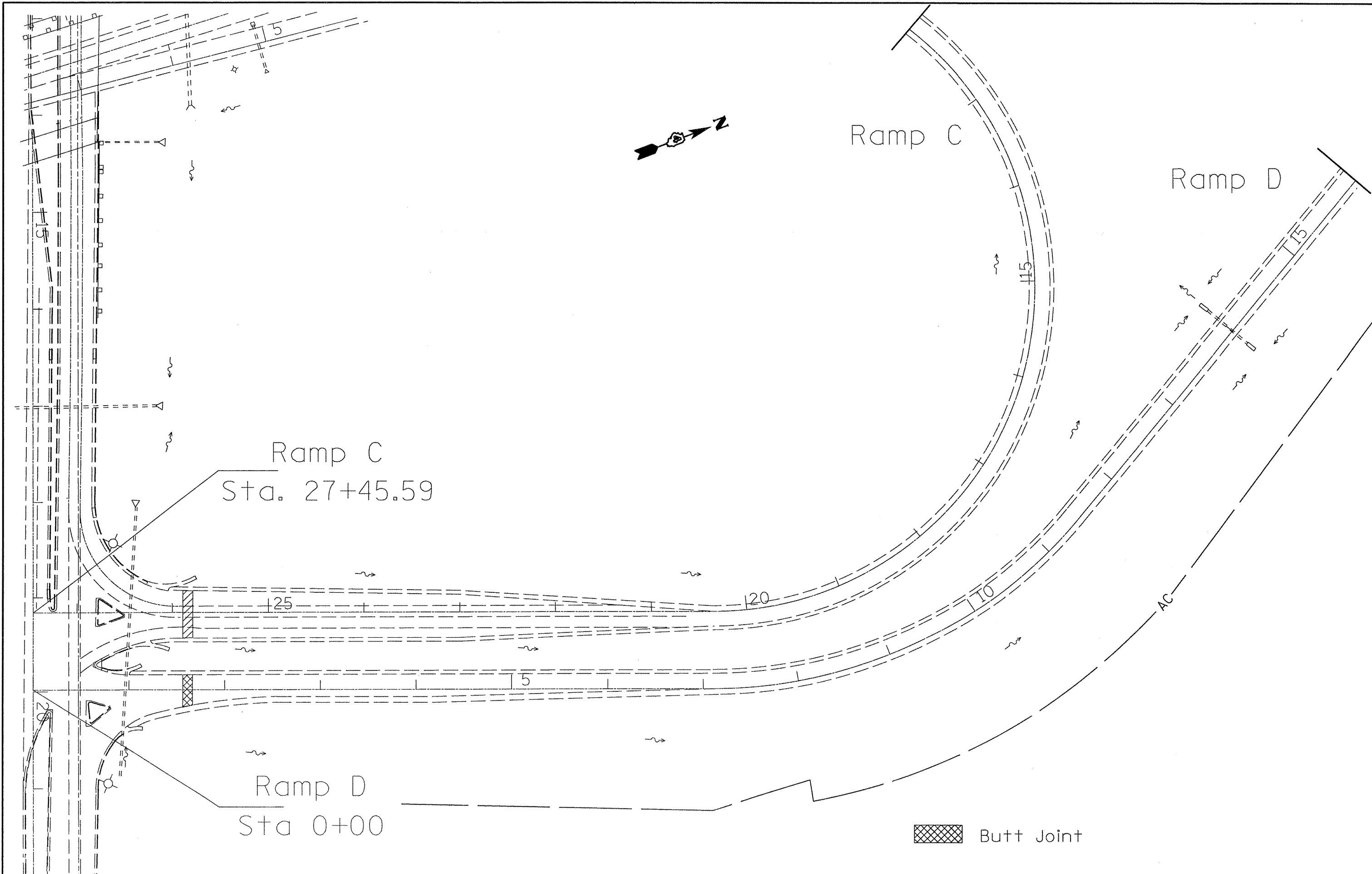

FILE NAME =  
general.dgn

USER NAME = AdadeSA  
PLOT SCALE = 90.9091' / in.  
PLOT DATE = 5/11/2011

DESIGNED -  
DRAWN -  
CHECKED -  
DATE -

REVISED -  
REVISED -  
REVISED -  
REVISED -

**STATE OF ILLINOIS  
DEPARTMENT OF TRANSPORTATION**

**US 150 & ILL 6**

SCALE: SHEET NO. OF SHEETS STA. TO STA.

F.A.P. RTE. 318	SECTION (72-7)RS-1	COUNTY PEORIA	TOTAL SHEETS 32	SHEET NO. 22
CONTRACT NO. 68673				
ILLINOIS FED. AID PROJECT				

## US 150 (RAMP A) TO IL 6 CLOSURE WITH DETOUR.

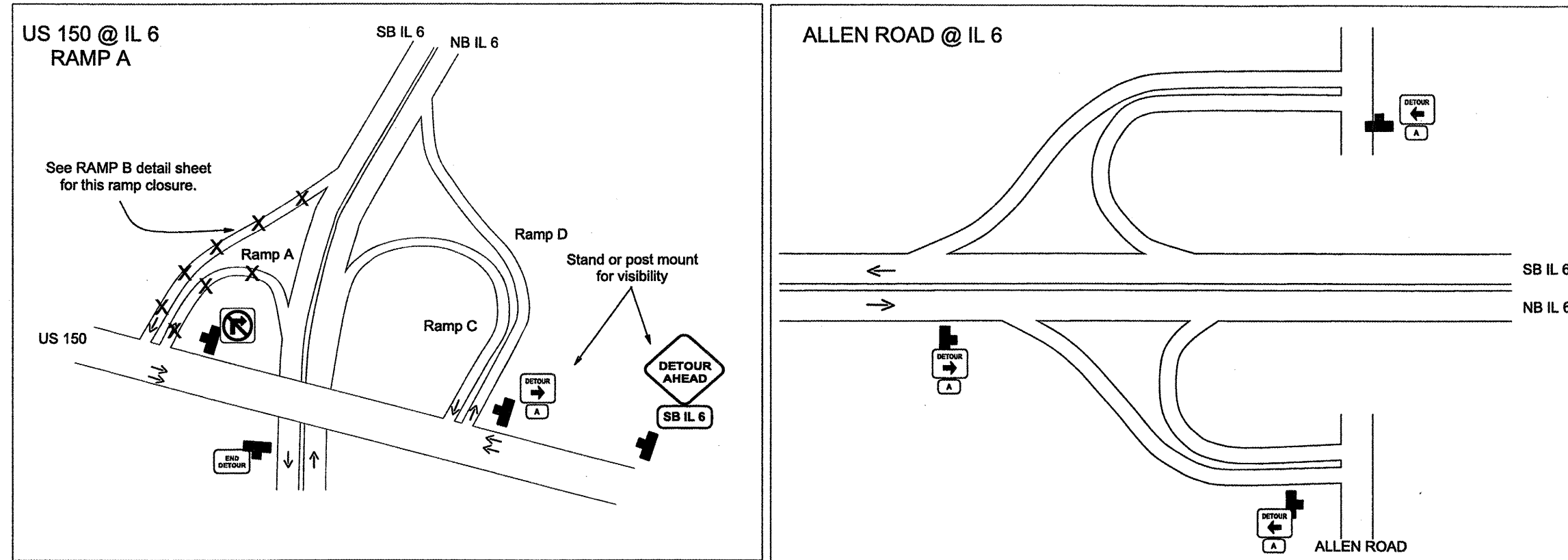

### General Notes

- 1) Ramps A & B shall be closed simultaneously. One Changeable Message Sign shall be utilized 3 days in advance of each ramp closure- one on IL 6 and one on WB US 150. Changeable message signs shall be utilized during the closure.
- 2) TIME RESTRICTIONS: Complete closures are allowed on Thursday night from 6:00 pm to 6:00 am & from Friday 6:00 pm to Monday 6:00 am.
- 3) The advanced signs on WB US 150 shall be post or stand mounted for better visibility.
- 4) Barrels shall be placed on IL 6 at the State u-turn to prevent motorist from doing a u-turn.
- 5) Ramp entrance shall be closed per standard 701901 "ROAD CLOSED TO ALL TRAFFIC."
- 6) Devices a@ 25' cts. to delineate closed turn lanes of affected ramps.

FILE NAME = general.dgn	USER NAME = AdadeSA	DESIGNED -	REVISED -	<b>STATE OF ILLINOIS DEPARTMENT OF TRANSPORTATION</b>	<b>TRAFFIC CONTROL PLAN DETAIL</b>	F.A.P. RTE. 318	SECTION (72-71RS-1)	COUNTY PEORIA	TOTAL SHEETS 32	SHEET NO. 23
	PLOT SCALE = 400.0001' / 1" =	DRAWN -	REVISED -							
	PLOT DATE = 5/12/2011	CHECKED -	REVISED -		SCALE: SHEET NO. OF SHEETS STA. TO STA.					
		DATE -	REVISED -							CONTRACT NO. 68673
<small>ILLINOIS FED. AID PROJECT</small>										

## SB IL 6 (RAMP B) TO US 150 CLOSURE WITH DETOUR.

### General Notes

- 1) All signs shall be black on orange with black border unless shown otherwise.
- 2) Any additional signs required shall be paid according to Article 109.04.
- 3) Lights on devices only required before sunrise or after sunset.
- 4) I-474 State U-turn to be barreled off to prevent public U-turns.

**A** = 15" x 21", 12" Series E Lettering.

**DETOUR** (with arrow) = M4-9 30" x 24"- arrow adjusted per drawing.

**RAMP CLOSED AHEAD** = 48"

**END DETOUR** = 24" x 18", 8" Series E Lettering.

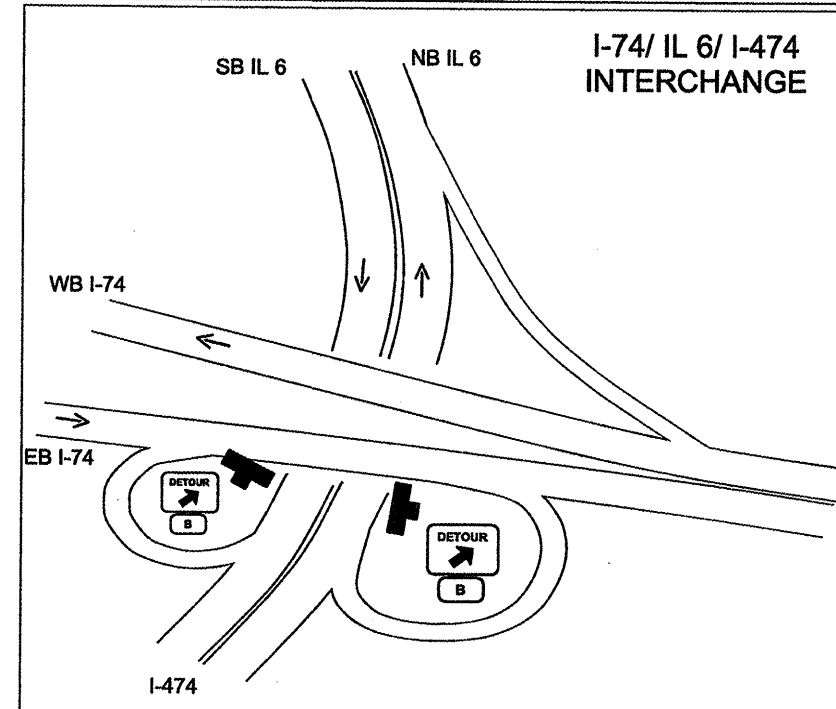
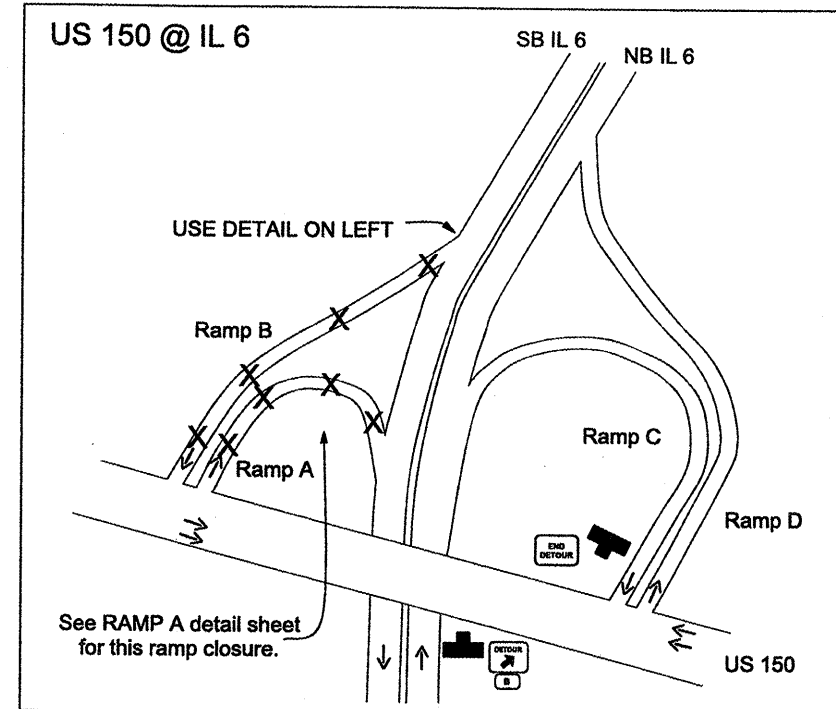
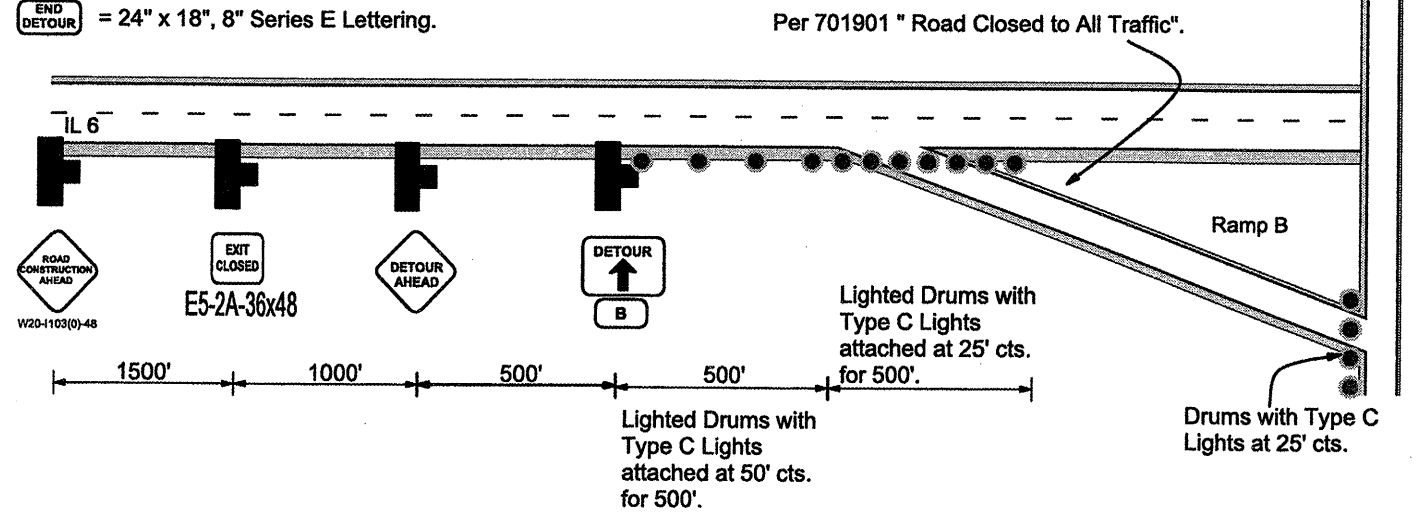

FILE NAME = general.dgn

USER NAME = AdodeSA  
 PLOT SCALE = 400.0001' / in.  
 PLOT DATE = 5/12/2011

DESIGNED -	REVISD -
DRAWN -	REVISD -
CHECKED -	REVISD -
DATE -	REVISD -

**STATE OF ILLINOIS  
 DEPARTMENT OF TRANSPORTATION**

**TRAFFIC CONTROL PLAN DETAIL**

SCALE: SHEET NO. OF SHEETS STA. TO STA.

F.A.P. RTE. 318	SECTION (72-7)RS-1	COUNTY PEORIA	TOTAL SHEETS 32	SHEET NO. 24
CONTRACT NO. 68673				
ILLINOIS FED. AID PROJECT				



## NB IL 6 (RAMP C) TO US 150 CLOSURE WITH DETOUR.

### General Notes

- 1) All signs shall be black on orange with black border unless shown otherwise.
- 2) Any additional signs required shall be paid according to Article 109.04.
- 3) Lights on devices only required before sunrise or after sunset.
- 4) IL 6 State u-turn to be barreled off to prevent public u-turns.

**A** = 15" x 21", 12" Series E Lettering.

**DETOUR** (with arrow) = M4-9 30" x 24" - arrow adjusted per drawing.

**RAMP CLOSED AHEAD** = 48"

**END DETOUR** = 24" x 18", 8" Series E Lettering.

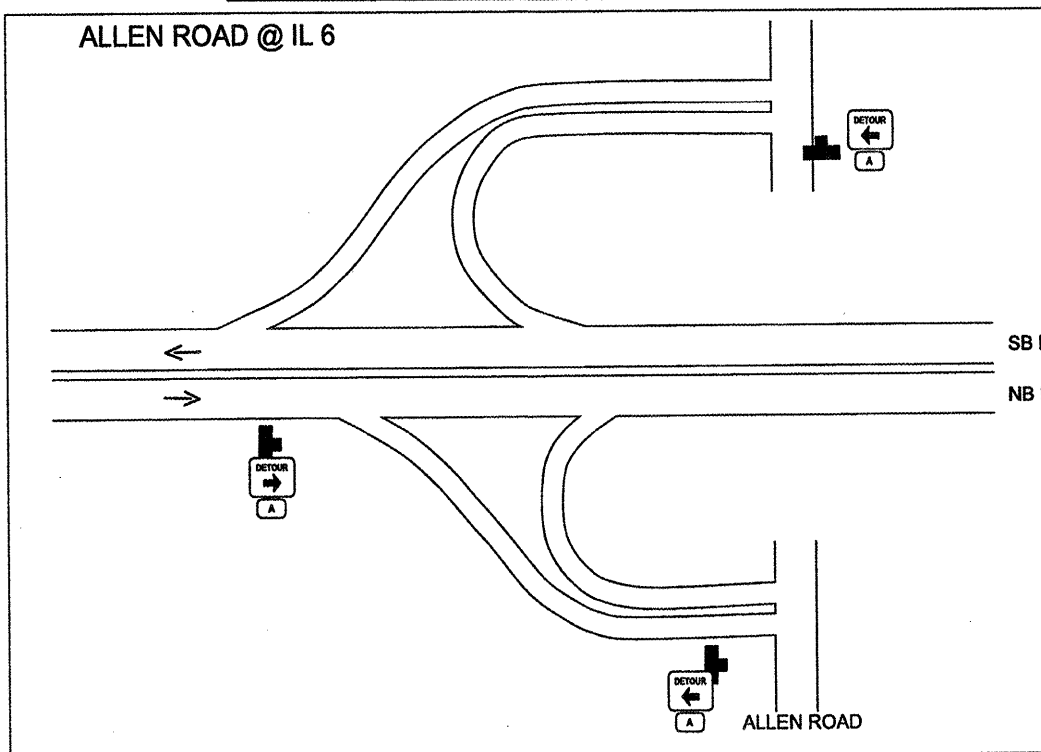
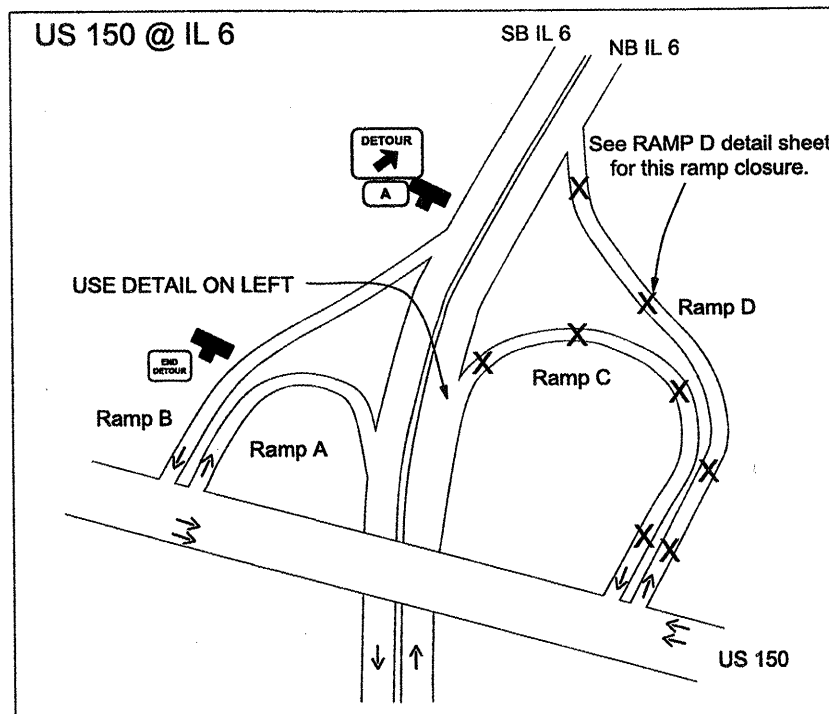
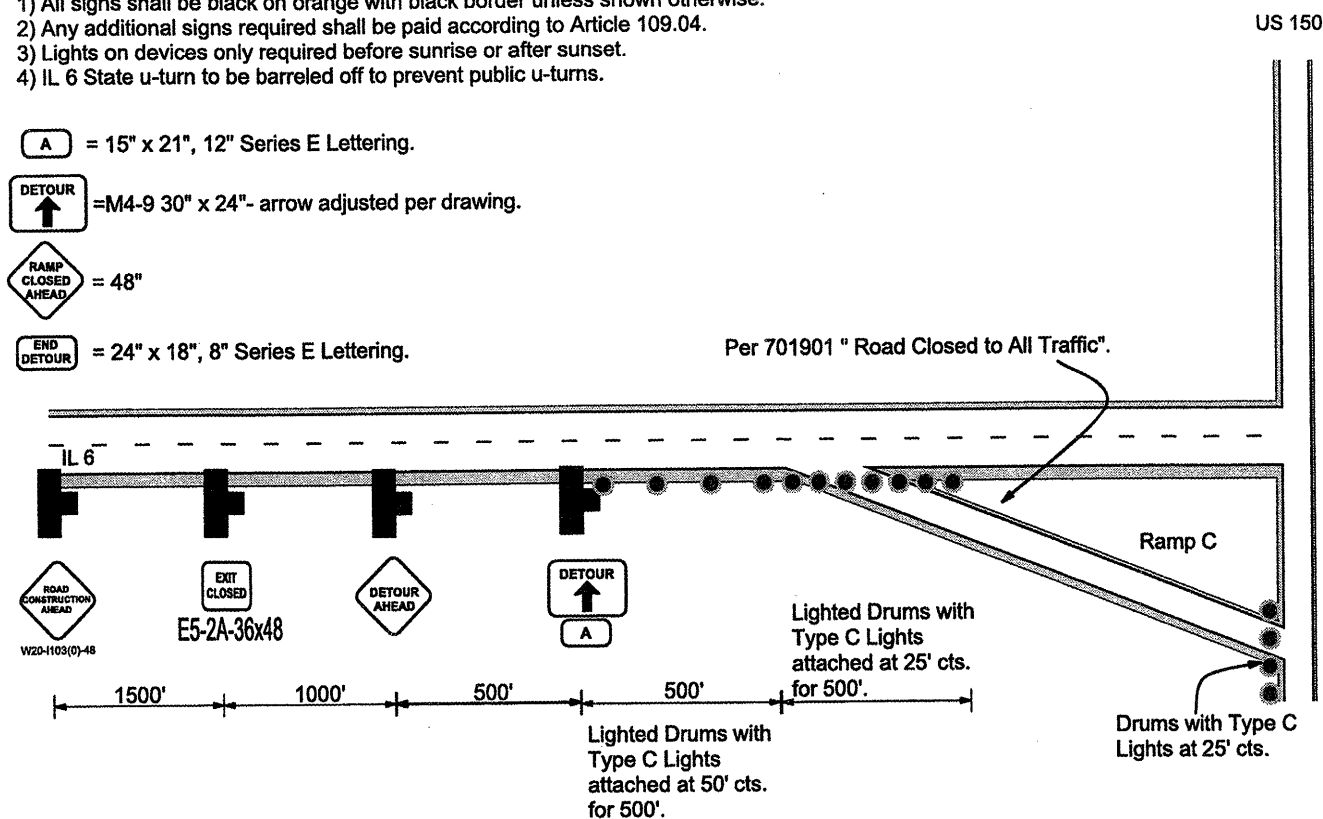

FILE NAME = general.dgn

USER NAME = AdodeSA  
 PLOT SCALE = 400.0001' / in.  
 PLOT DATE = 5/12/2011

DESIGNED -	REVISED -
DRAWN -	REVISED -
CHECKED -	REVISED -
DATE -	REVISED -

**STATE OF ILLINOIS  
 DEPARTMENT OF TRANSPORTATION**

**TRAFFIC CONTROL PLAN DETAIL**

SCALE: SHEET NO. OF SHEETS STA. TO STA.

F.A.P. RTE. 318	SECTION (72-7)RS-1	COUNTY PEORIA	TOTAL SHEETS 32	SHEET NO. 25
CONTRACT NO. 68673				
ILLINOIS FED. AID PROJECT				

**US 150 (RAMP D) TO NB IL 6 CLOSURE WITH DETOUR.**

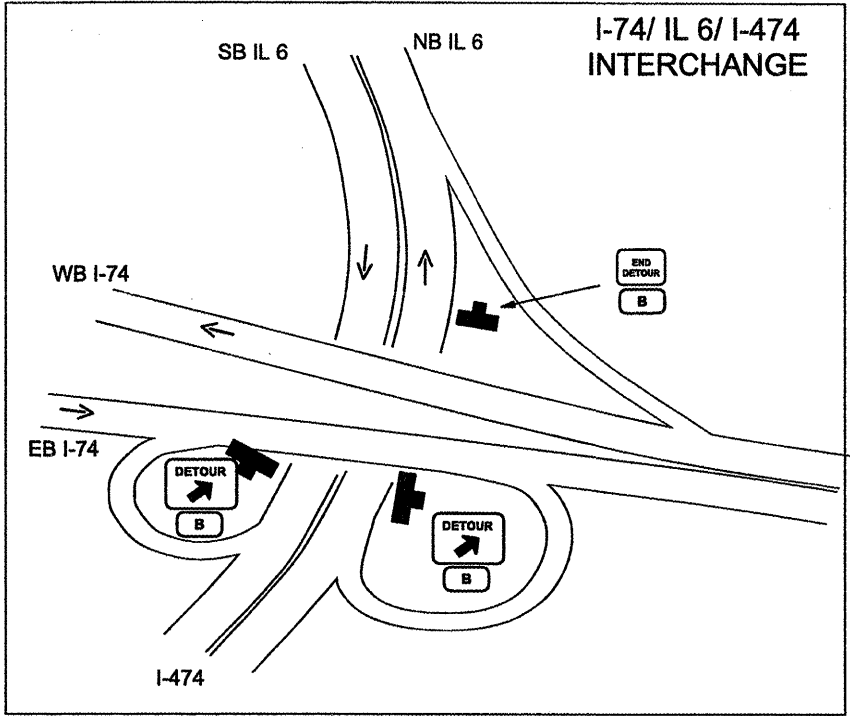
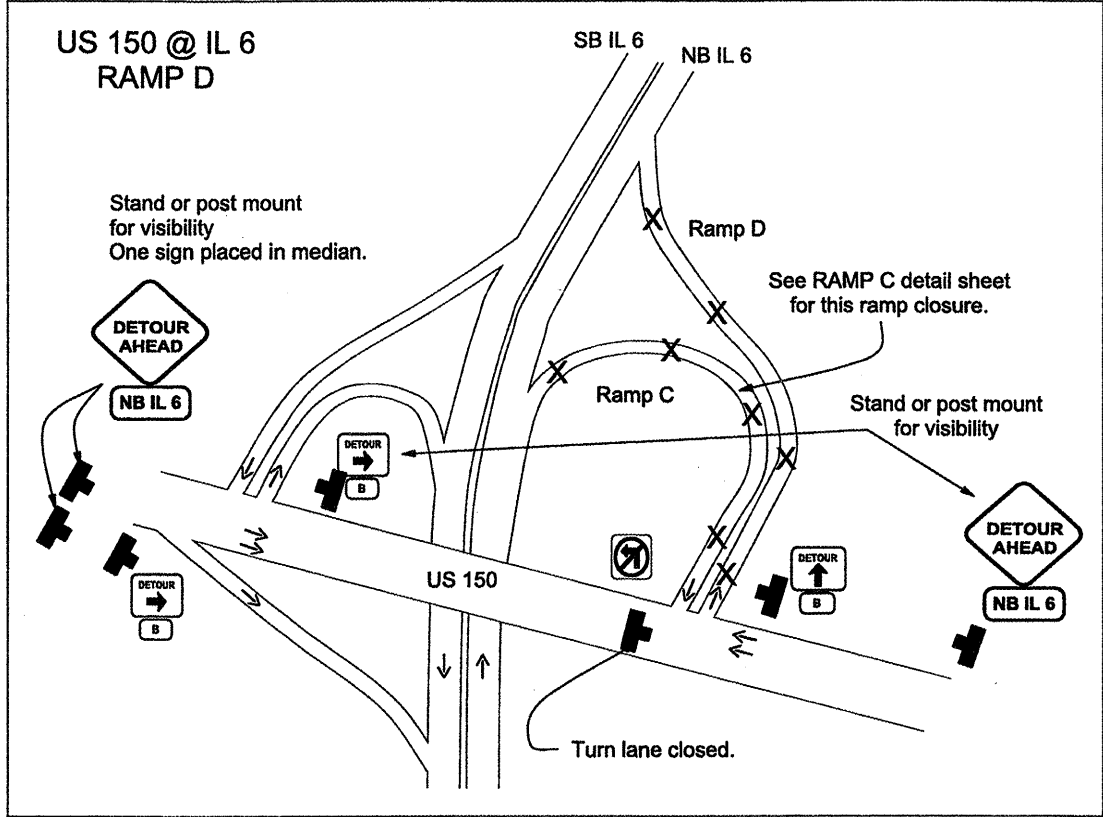

**General Notes**

- 1) Ramps C & D shall be closed simultaneously. One Changeable Message Sign shall be utilized 3 days in advance of each ramp closure- one on IL 6 and one on WB US 150. Changeable message signs shall be utilized during the closure.
- 2) TIME RESTRICTIONS: Complete closures are allowed on Thursday from 6:00 pm to 6:00 am & from Friday 6:00 pm to Monday 6:00 am.
- 3) The advanced signs on WB US 150 shall be post or stand mounted for better visibility.
- 4) Barrels shall be placed on IL 6 at the State u-turn to prevent motorist from doing a u-turn.
- 5) Ramp entrance shall be closed per standard 701901 "ROAD CLOSED TO ALL TRAFFIC."
- 6) Devices @ 25' cts. to delineate closed turn lanes of affected ramps.

Additional Changeable Message Board required on IL 91 to alert motorist of NB 6 Ramp closure.

**LOCATIONS**

SBL Sta. 56+00  
 SBL Sta. 59+65  
 NBL Sta. 56+00  
 NBL Sta. 59+65

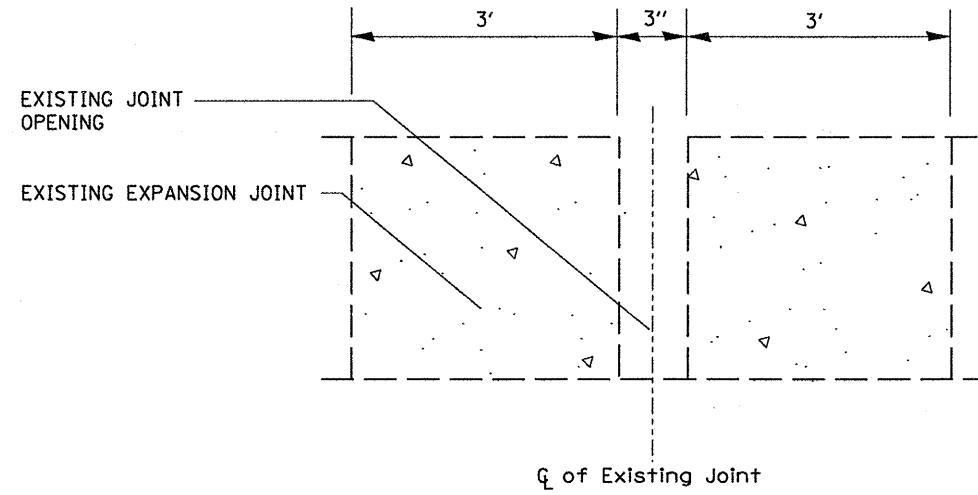

**EXISTING JOINT**

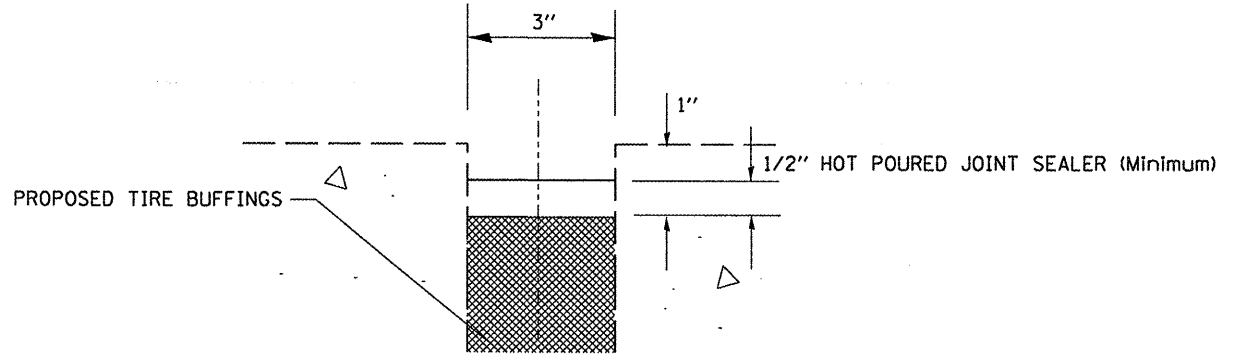

**JOINT DETAIL**

**GENERAL NOTES:**

1. All work shall be done as directed by the Engineer.
2. Use buffings from the tire retreading industry.
3. Ensure tire buffings are clean, dry, and without any contamination.
4. Remove existing material and replace with tire buffings.
5. Place loose buffings and strike off level.
6. Compact buffings by spading with a square -nose shovel.
7. Use hot -poured joint sealer that meets the requirement of Article 1050.02 and according to the applicable section of Article 420.12 of the Standard Specifications.
8. All work and material shall be included in the unit price of EXPANSION JOINT (SPECIAL).

FILE NAME = general.dgn	USER NAME = AdadeSA	DESIGNED -	REVISED -	<b>STATE OF ILLINOIS DEPARTMENT OF TRANSPORTATION</b>	<b>EXPANSION JOINT (SPECIAL) DETAIL</b>	F.A.P. RTE.	SECTION	COUNTY	TOTAL SHEETS	SHEET NO.	
	PLOT SCALE = 400,0001' / 1"	DRAWN -	REVISED -			318	(72-7)RS-1	PEORIA	32	27	
PLOT DATE = 5/12/2011	CHECKED -	REVISED -	<b>CONTRACT NO. 68673</b>			ILLINOIS FED. AID PROJECT					
DATE -	REVISED -	SCALE:	SHEET NO.		OF	SHEETS	STA.	TO STA.			

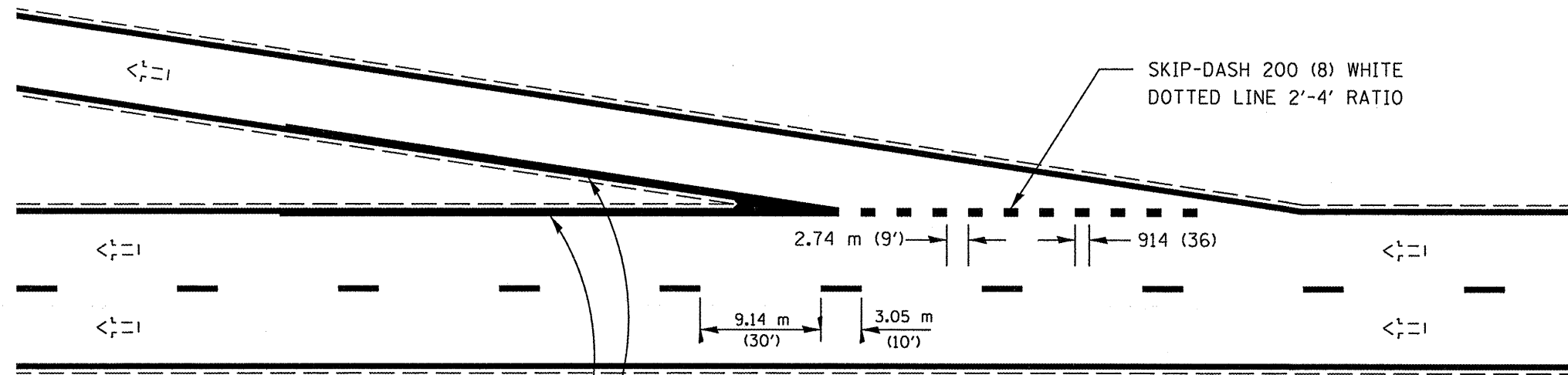

**PAINTED MEDIAN ISLANDS, GORE MARKINGS  
AND  
CHANNELIZING LINES**

SOLID 200 (8) WHITE

All dimensions are in millimeters  
(inches) unless otherwise noted.

TAPERED ACCELERATION LANE

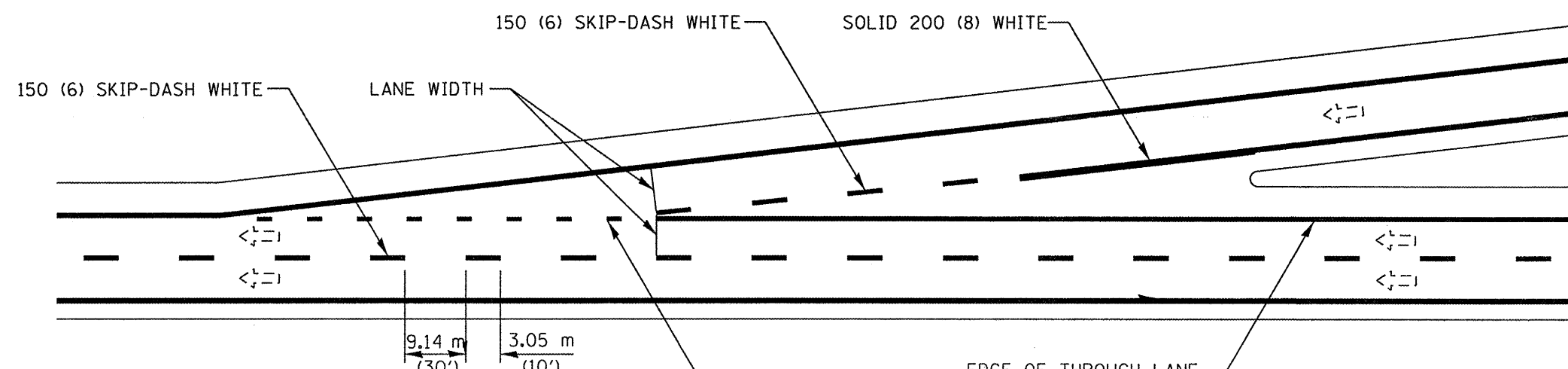
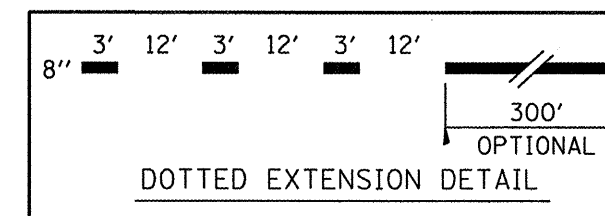

**ENTRANCE RAMP MARKINGS**

FILE NAME = general.dgn	USER NAME = AdodeSA	DESIGNED -	REVISED -	<b>STATE OF ILLINOIS DEPARTMENT OF TRANSPORTATION</b>	<b>PAVEMENT MARKING DETAIL</b>	F.A.P. RTE. 318	SECTION (72-7RS-1)	COUNTY PEORIA	TOTAL SHEETS 32	SHEET NO. 28	
	PLOT SCALE = 400.0001' / in.	CHECKED -	REVISED -			SCALE:      SHEET NO.    OF    SHEETS    STA.            TO STA.		CONTRACT NO. 68673			
	PLOT DATE = 5/11/2011	DATE -	REVISED -			ILLINOIS FED. AID PROJECT					

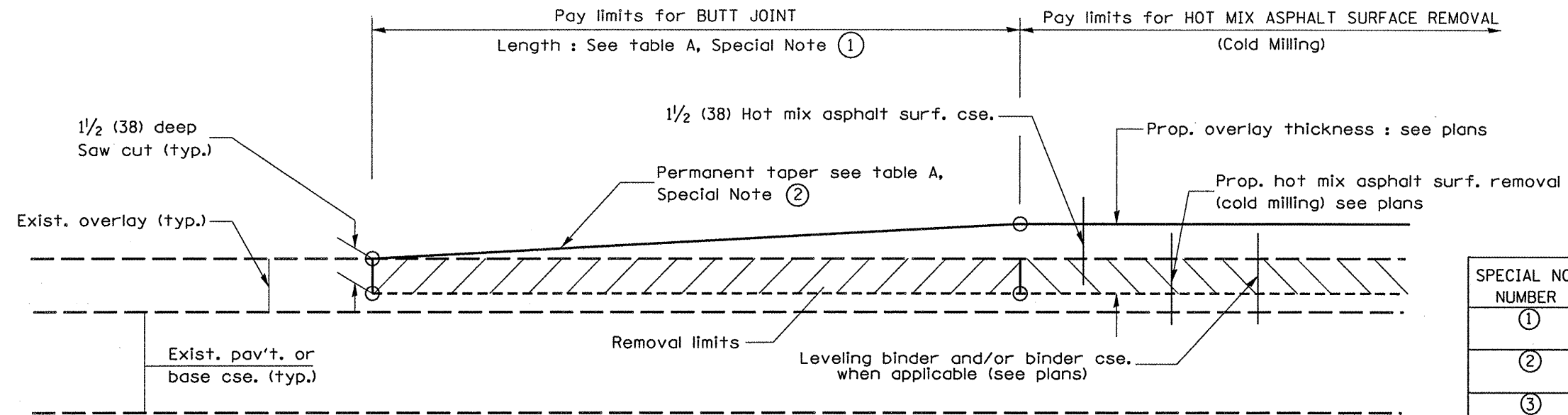

**CASE 1 : WITH HOT MIX ASPHALT SURFACE REMOVAL (COLD MILLING)**

**TABLE A**  
(LENGTHS AND TAPER RATES)

SPECIAL NOTE NUMBER	ELEMENT	MAINLINE INTERSTATES & 4-LANE EXPRESSWAYS	ALL OTHERS
①	LENGTH OF BUTT JOINT	60'(18.0 m)	30'(9.0 m)
②	PERMANENT TAPER RATE	1:480	1:240
③	TEMPORARY RAMP TAPER RATE	1:80	1:40
④	TEMPORARY RAMP LENGTH	10'(3.0 m)	5'(1.5 m)
⑤	LENGTH OF BUTT JOINT	10'(3.0 m)	10'(3.0 m)

**GENERAL NOTES**

1. The work shall be done in accordance with Article 406.08 and the Special Provision for Butt Joints.
2. The pavement surface to be removed may be either bituminous or P.C. concrete. The work shall be performed in accordance with Article 440.04 and the Special Provisions for Butt Joints.
3. The saw cut joints shall be primed just prior to the placing of bituminous material. The work will be in accordance with the applicable portions of Article 406.05.

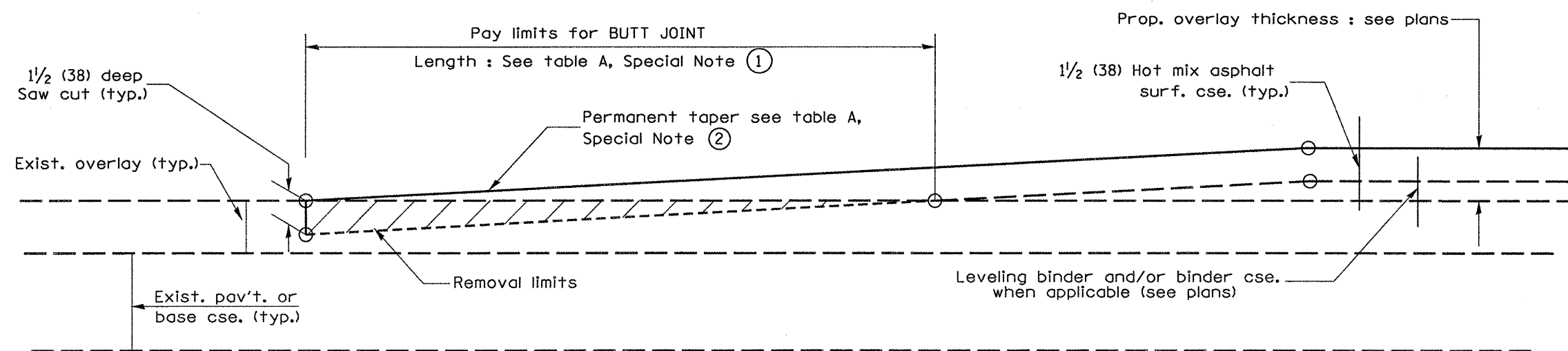

**CASE 2 : NO HOT MIX ASPHALT SURFACE REMOVAL (COLD MILLING)**

All dimensions are in inches (millimeters) unless otherwise noted.

01-01-97	RENUM. C-23.01. NEW REVISION BOX	T.P.
04-01-97	CORRECTION TO DEPTH	J.A.
09-15-05	REVISED DESIGNER NOTE	M.M.A.
10-16-06	REVISED TO 2007 SPEC.	M.A.

STATE OF ILLINOIS  
DEPARTMENT OF TRANSPORTATION

BUTT JOINTS

NOT TO SCALE

SHT. 1 OF 3  
CADD STD. 406101-04

F.A.P. RTE.	SECTION	COUNTY	TOTAL SHEETS	SHEET NO.
318	(72-7RS-1)	PEORIA	32	29
FED. ROAD DIST. NO. ILLINOIS FED. AID PROJECT			CONTRACT NO. 68673	

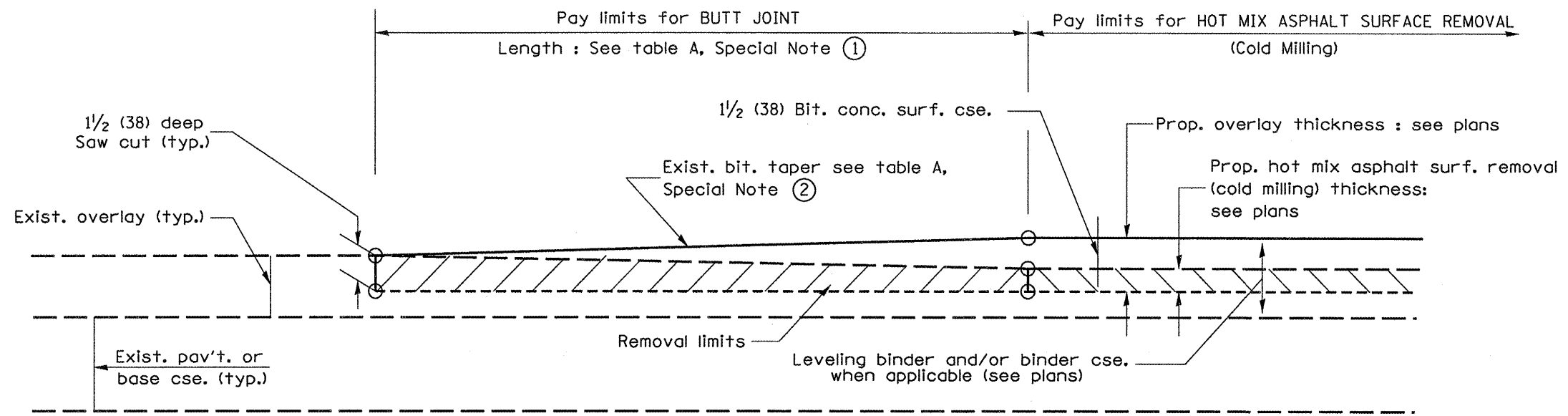

**CASE 3 : WITH HOT MIX ASPHALT SURFACE REMOVAL (COLD MILLING)**  
**TIE-IN TO EXISTING BITUMINOUS TAPER**

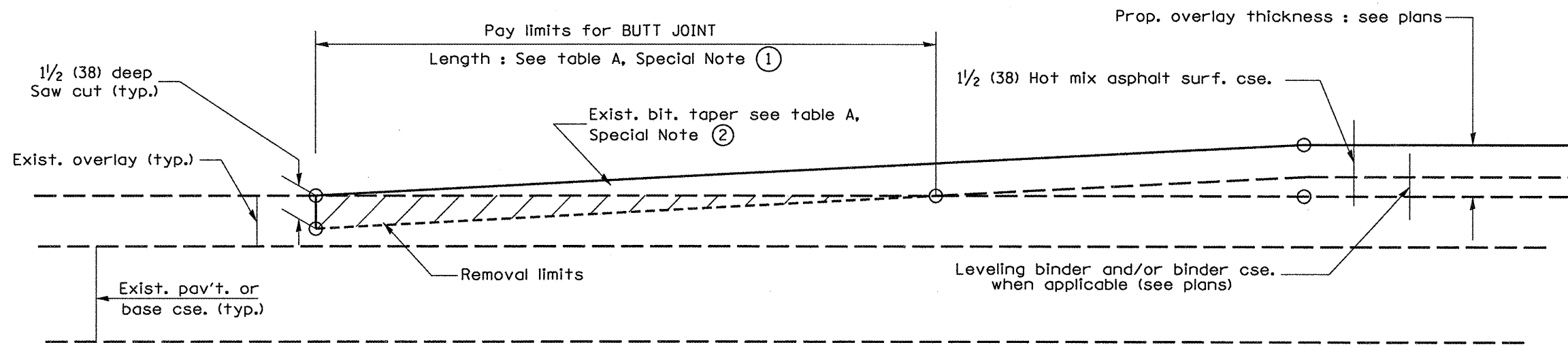

**CASE 4 : NO HOT MIX ASPHALT SURFACE REMOVAL (COLD MILLING)**  
**TIE-IN TO EXISTING BITUMINOUS TAPER**

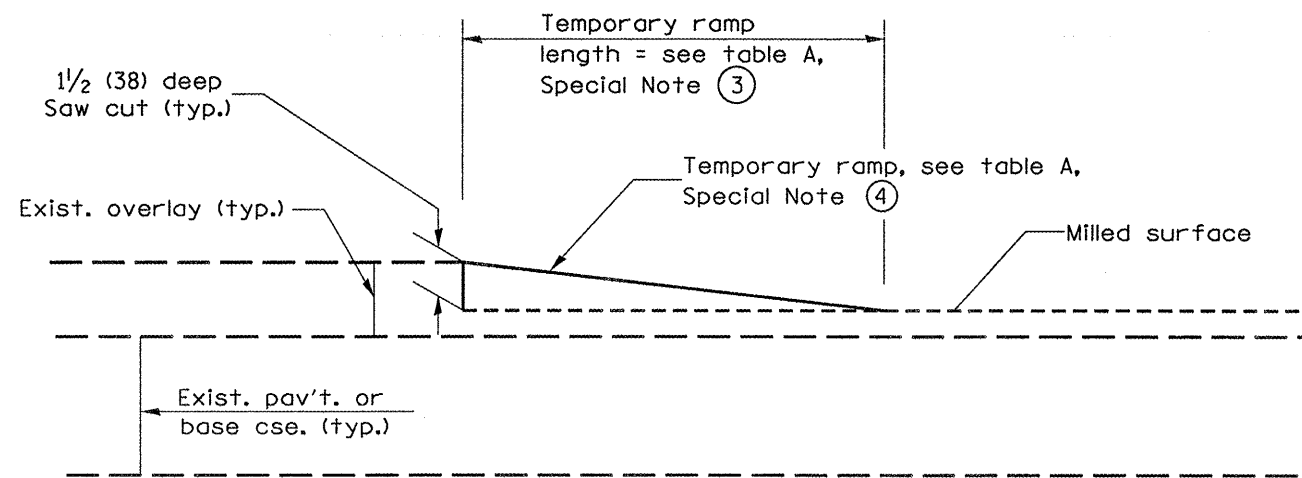

**DETAIL TEMPORARY RAMP**

All dimensions are in inches (millimeters) unless otherwise noted.

STATE OF ILLINOIS DEPARTMENT OF TRANSPORTATION		BUTT JOINTS		SHT. 2 OF 3 CADD STD. 406101-D4	
F.A.P. RTE.	SECTION	COUNTY	TOTAL SHEETS	SHEET NO.	
318	(72-7)RS-1	PEORIA	32	30	
FED. ROAD DIST. NO.			ILLINOIS FED. AID PROJECT		
			CONTRACT NO. 68673		

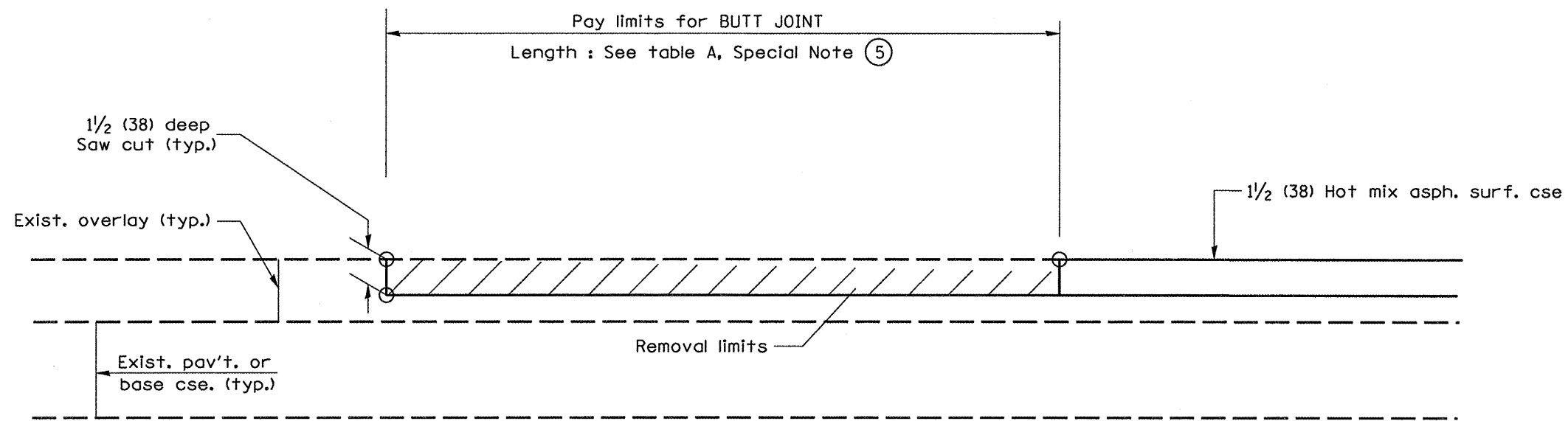

**CASE 5 : WITH HOT MIX ASPHALT SURFACE REMOVAL (COLD MILLING)  
TIE-IN TO EXISTING BITUMINOUS TAPER**

All dimensions are in inches (millimeters) unless otherwise noted.

				<b>STATE OF ILLINOIS DEPARTMENT OF TRANSPORTATION</b>		<b>BUTT JOINTS</b>		SHT. 3 OF 3 CADD STD. 406101-D4		F.A.P. RTE. 318		SECTION (72-7)RS-1		COUNTY PEORIA		TOTAL SHEETS 32		SHEET NO. 31		CONTRACT NO. 68673	
				NOT TO SCALE				FED. ROAD DIST. NO.		ILLINOIS FED. AID PROJECT											

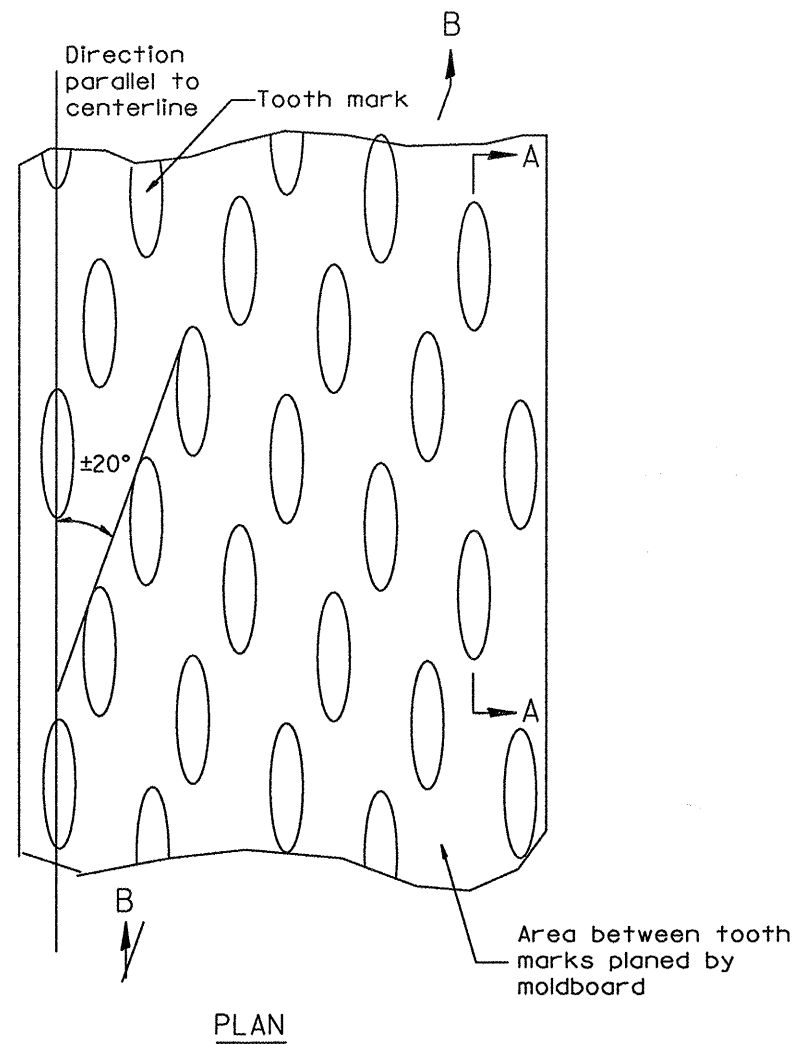

PLAN

General notes:

1. Coldmilling shall consist of two processes: Cutting with carbide teeth mounted on a rotating drum, and planing with a moldboard mounted immediately behind the cutting drum.
2. Other similar patterns will be acceptable if they consist of a smooth, flat, planed surface interspersed with a pattern of discontinuous longitudinal striations.

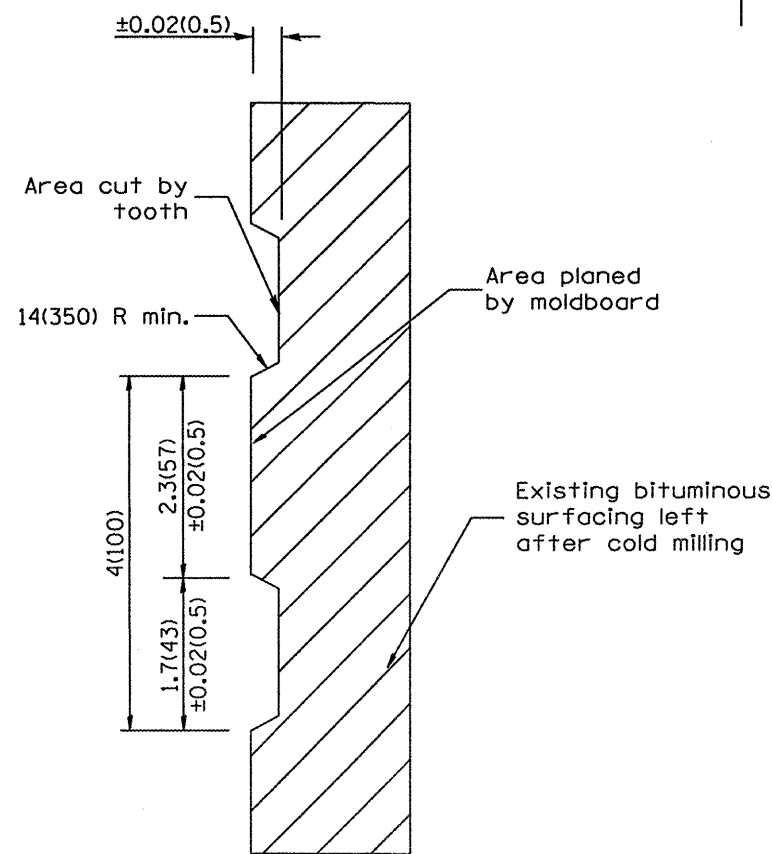

SECTION A-A

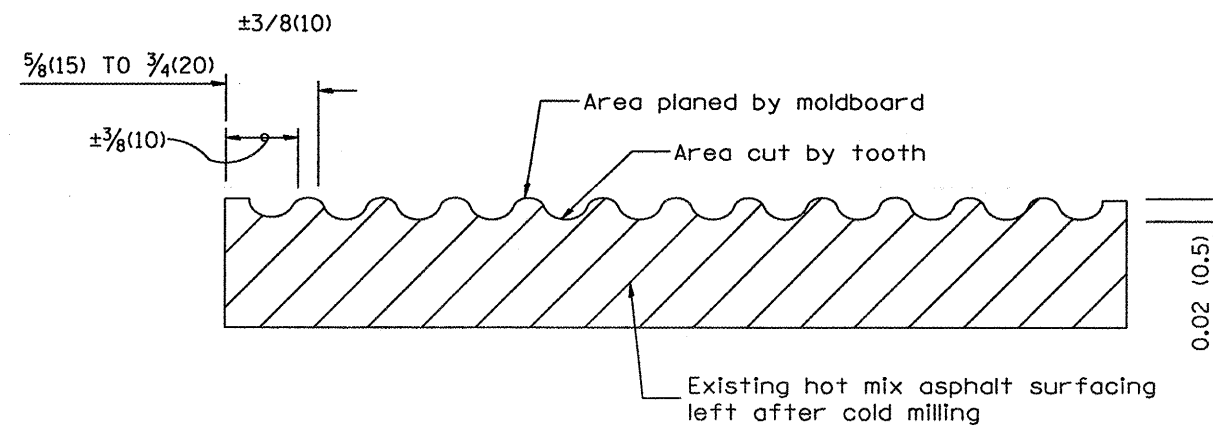

SECTION B-B PROJECTED  
PERPENDICULAR TO CENTERLINE

All dimensions are in inches (millimeters) unless otherwise noted.

01-01-97	RENUM. C-104.01, NEW REVISION BOX	T.P.
04-20-98	REMOVED MILLING DETAIL FROM STANDARD	J.A.
09-08-98	CORRECT NOTE LEADER PLACEMENT	R.W.
10-16-06	REVISED TO 2007 SPEC.	M.A.

STATE OF ILLINOIS  
DEPARTMENT OF TRANSPORTATION

HOT MIX ASPHALT SURFACE REMOVAL (COLD MILLING)

NOT TO SCALE

CADD STD. 440001-04

F.A. RTE.	SECTION	COUNTY	TOTAL SHEETS	SHEET NO.
318	(72-7)RS-1	PEORIA	32	32
FED. ROAD DIST. NO. ILLINOIS FED. AID PROJECT			CONTRACT NO. 68673	