

BENCHMARK: CHISELED "C" SET IN CONCRETE
 TOP OF SE. SIDE OF S. PARAPET
 WALL OF S.N. 090-100
 ELEV. = 100.00 FT. (ASSUMED)

EXISTING STRUCTURE: SN 090-0087 IS 24'-0" WIDE BY 671'-0"
 LONG WITH NINE P.P.C. DECK BEAM SPANS & ONE STEEL THRU
 TRUSS SPAN ON R.C. CLOSED ABUTMENTS AND PIERS.

BILL OF MATERIALS

ITEM	UNIT	TOTAL
STONE RIPRAP, CLASS A5	TONS	1850
FILTER FABRIC	SQ YD	1058
DEWATERING STRUCTURE NO. 3	EACH	1

ROUTE NO.	SECTION	COUNTY	TOTAL SHEETS	SHEET NO.
VAR	*	VAR	38	20
FED. ROAD DIST. NO. 4		ILLINOIS	FED. AID PROJECT	

*** D4 SCOUR MITIGATION 2011**

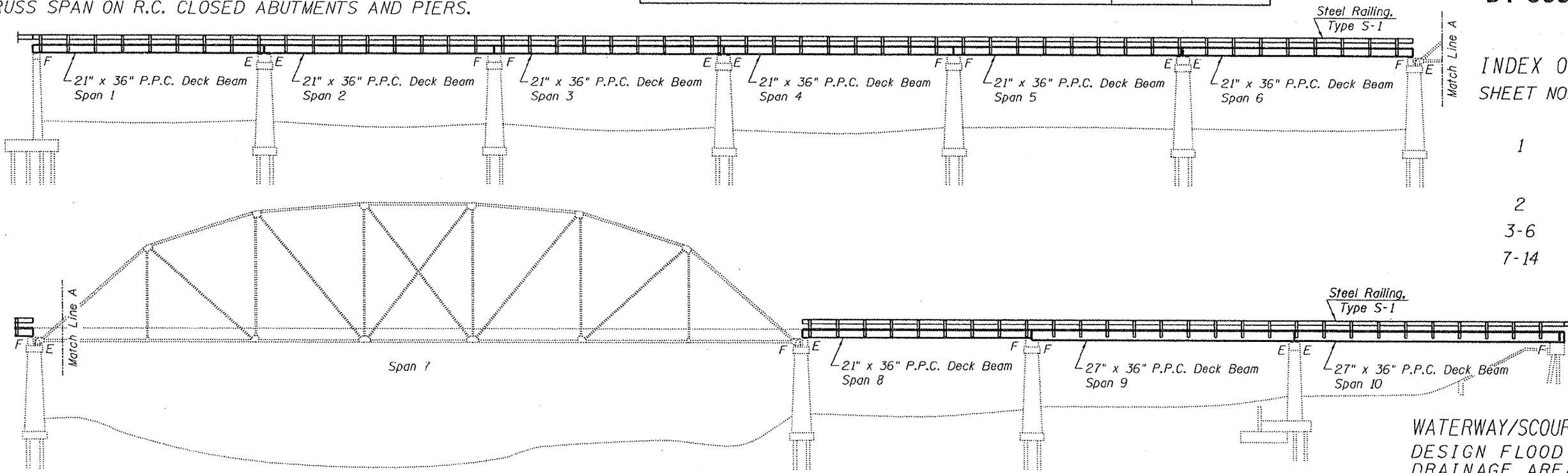

ELEVATION

INDEX OF SHEETS

SHEET NO.	DESCRIPTION
1	GENERAL PLAN & ELEVATION, SUMMARY OF QUANTITIES, LOCATION MAP
2	SITE PLAN
3-6	SITE DETAILS
7-14	SITE CROSS SECTIONS

WATERWAY/SCOUR INFORMATION

DESIGN FLOOD	100 YRS
DRAINAGE AREA	990.1 SQ MI
FLOW	44,350 CFS
FLOW DEPTH	17.6 FT
CONTRACTION SCOUR DEPTH	9 FT

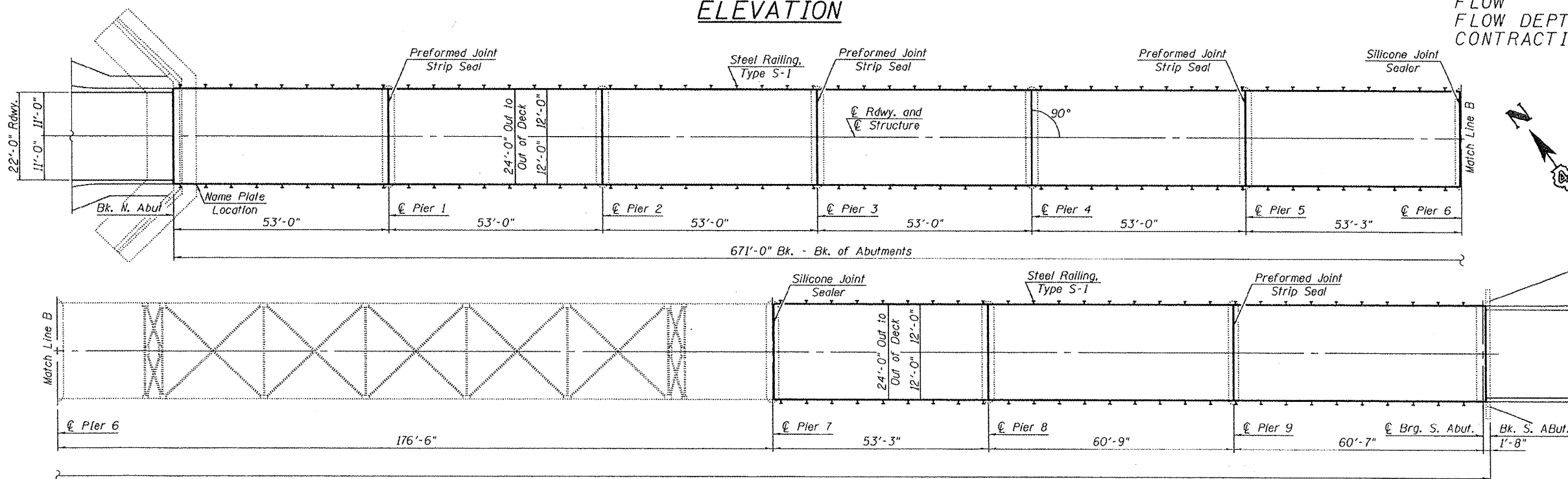

PLAN

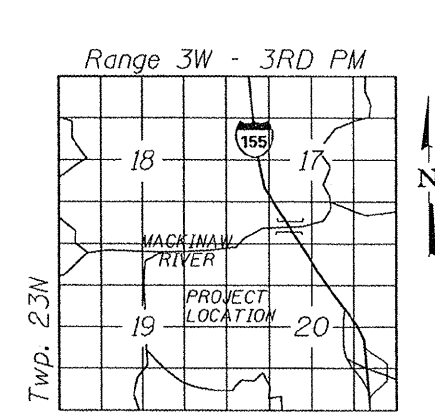

LOCATION SKETCH

ILLINOIS DEPARTMENT OF TRANSPORTATION
 GENERAL PLAN & ELEVATION
 S.N. 090-0087
 OLD IL 121
 OVER MACKINAW RIVER
 TAZEWELL COUNTY
 SHEET 1 OF 9