

PLAN	SURVEYED	DATE
	PLOTTED	
	GRADES CHECKED	
	STRUCTURE NOTATIONS CHECKED	
	NOTE BOOK NO.	
	CARD FILE NAME	

PROFILE	SURVEYED	DATE
	PLOTTED	
	GRADES CHECKED	
	STRUCTURE NOTATIONS CHECKED	
	NOTE BOOK NO.	
	CARD FILE NAME	

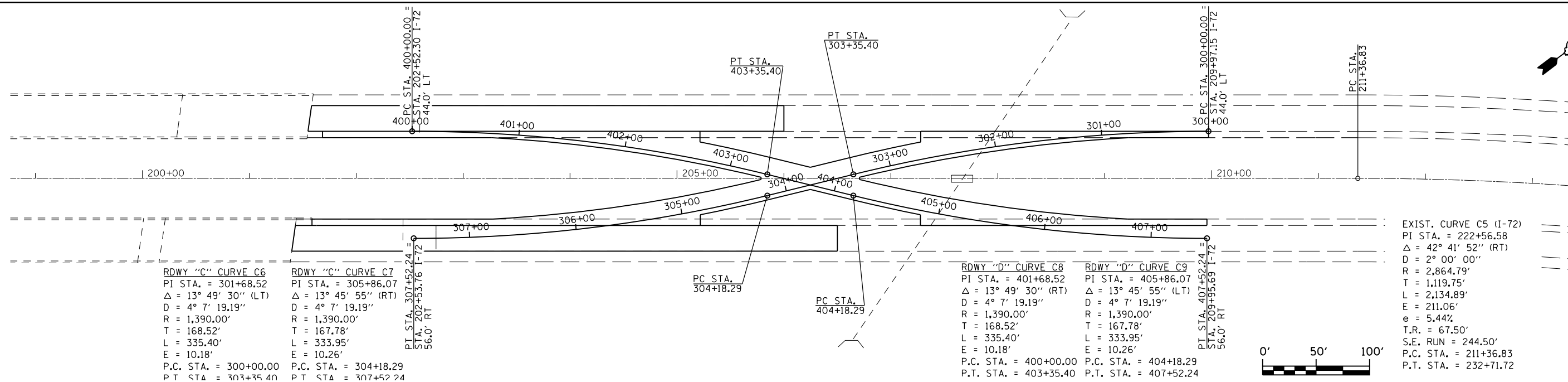

RDWY "C" CURVE C6
 PI STA. = 301+68.52
 $\Delta = 13^\circ 49' 30''$ (LT)
 $D = 4^\circ 7' 19.19''$
 $R = 1,390.00'$
 $T = 168.52'$
 $L = 335.40'$
 $E = 10.18'$
 P.C. STA. = 300+00.00
 P.T. STA. = 303+35.40

RDWY "C" CURVE C7
 PI STA. = 305+86.07
 $\Delta = 13^\circ 45' 55''$ (RT)
 $D = 4^\circ 7' 19.19''$
 $R = 1,390.00'$
 $T = 167.78'$
 $L = 333.95'$
 $E = 10.26'$
 P.C. STA. = 304+18.29
 P.T. STA. = 307+52.24

RDWY "D" CURVE C8
 PI STA. = 401+68.52
 $\Delta = 13^\circ 49' 30''$ (RT)
 $D = 4^\circ 7' 19.19''$
 $R = 1,390.00'$
 $T = 168.52'$
 $L = 335.40'$
 $E = 10.18'$
 P.C. STA. = 400+00.00
 P.T. STA. = 403+35.40

RDWY "D" CURVE C9
 PI STA. = 405+86.07
 $\Delta = 13^\circ 45' 55''$ (LT)
 $D = 4^\circ 7' 19.19''$
 $R = 1,390.00'$
 $T = 167.78'$
 $L = 333.95'$
 $E = 10.26'$
 P.C. STA. = 404+18.29
 P.T. STA. = 407+52.24

EXIST. CURVE C5 (I-72)
 PI STA. = 222+56.58
 $\Delta = 42^\circ 41' 52''$ (RT)
 $D = 2^\circ 00' 00''$
 $R = 2,864.79'$
 $T = 1,119.75'$
 $L = 2,134.89'$
 $E = 211.06'$
 $e = 5.44\%$
 $T.R. = 67.50'$
 S.E. RUN = 244.50'
 P.C. STA. = 211+36.83
 P.T. STA. = 232+71.72

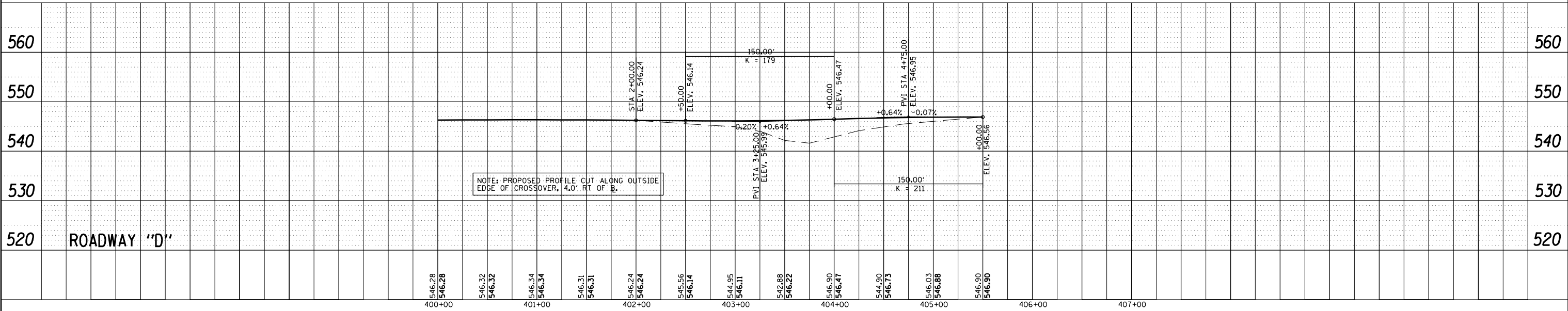
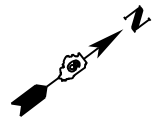
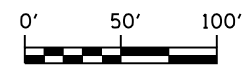

NOTE: PROPOSED PROFILE CUT ALONG OUTSIDE EDGE OF CROSSOVER, 4.0' RT OF B.

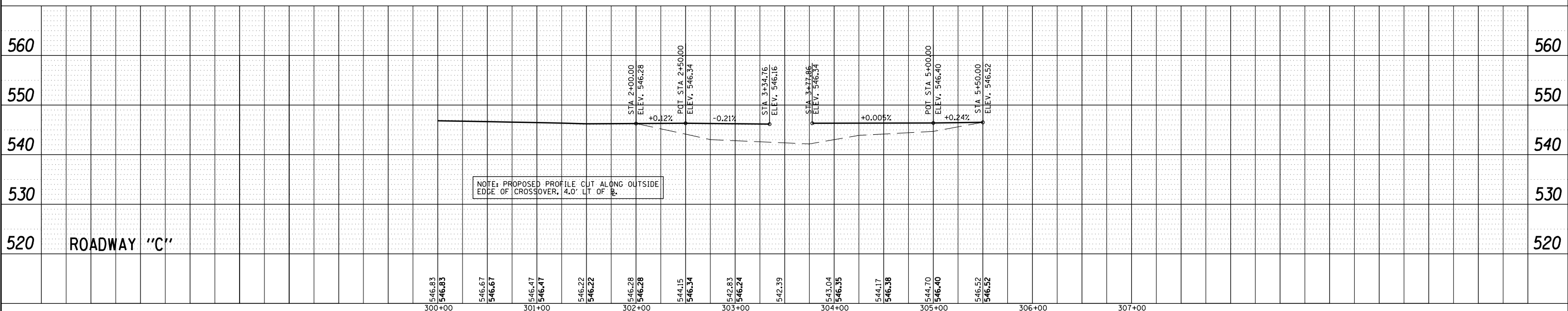

NOTE: PROPOSED PROFILE CUT ALONG OUTSIDE EDGE OF CROSSOVER, 4.0' LT OF B.

USER NAME = sparksgw	DESIGNED -	REVISED -
	DRAWN - BDM	REVISED -
PLOT SCALE = 100.0000' / in.	CHECKED - JSA	REVISED -
PLOT DATE = Jun-08-2011 09:43:52AM	DATE - 7/15/09	REVISED -

**STATE OF ILLINOIS
DEPARTMENT OF TRANSPORTATION**

PLAN AND PROFILE SHEET - EAST CROSSOVER

F.A.I. RTE.	SECTION	COUNTY	TOTAL SHEETS	SHEET NO.
I-72	(84-10-11)-7	SANGAMON	41	13
				CONTRACT NO. 72E51
ILLINOIS FED. AID PROJECT				

SCALE: SHEET NO. OF SHEETS STA. TO STA.