

STATE OF ILLINOIS
DEPARTMENT OF TRANSPORTATION
DIVISION OF HIGHWAYS

**PROPOSED
CONTRACT MAINTENANCE**

FAS 1741/2729 (FR I-55 WEST)
SECTION (112,116)I

MONTGOMERY COUNTY

F.A.S. RTE. 1741/2729	SECTION (112,116)I	COUNTY MONTGOMERY	TOTAL SHEETS 5	SHEET NO. 1
FED. ROAD DIST. NO.	ILLINOIS	CONTRACT NO. 72E58		

FOR INDEX OF SHEETS, SEE SHEET NO. 2

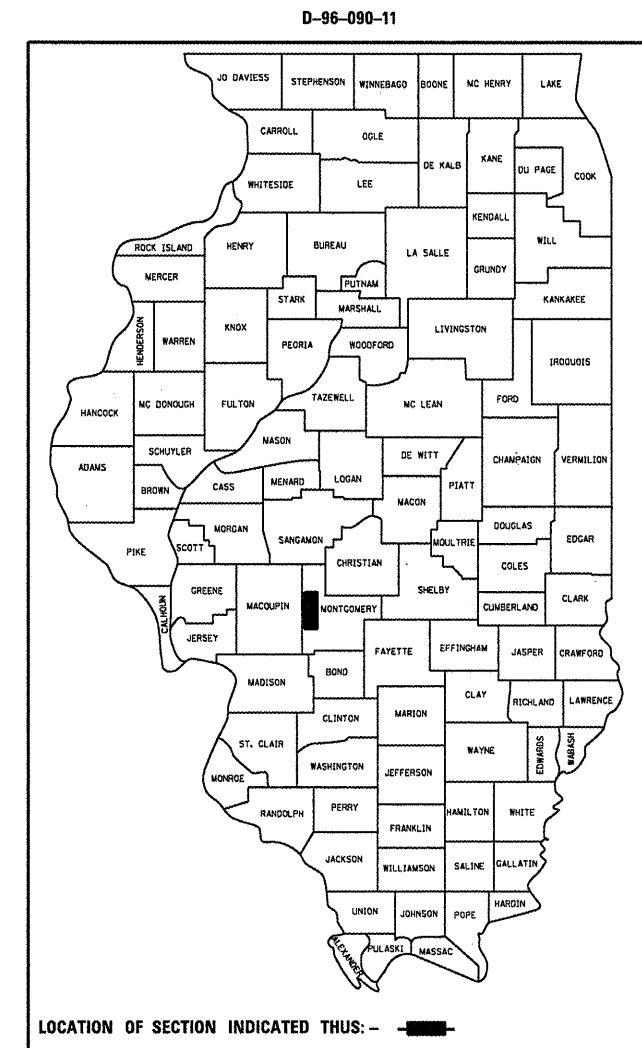

C-96-090-11

R 5 W

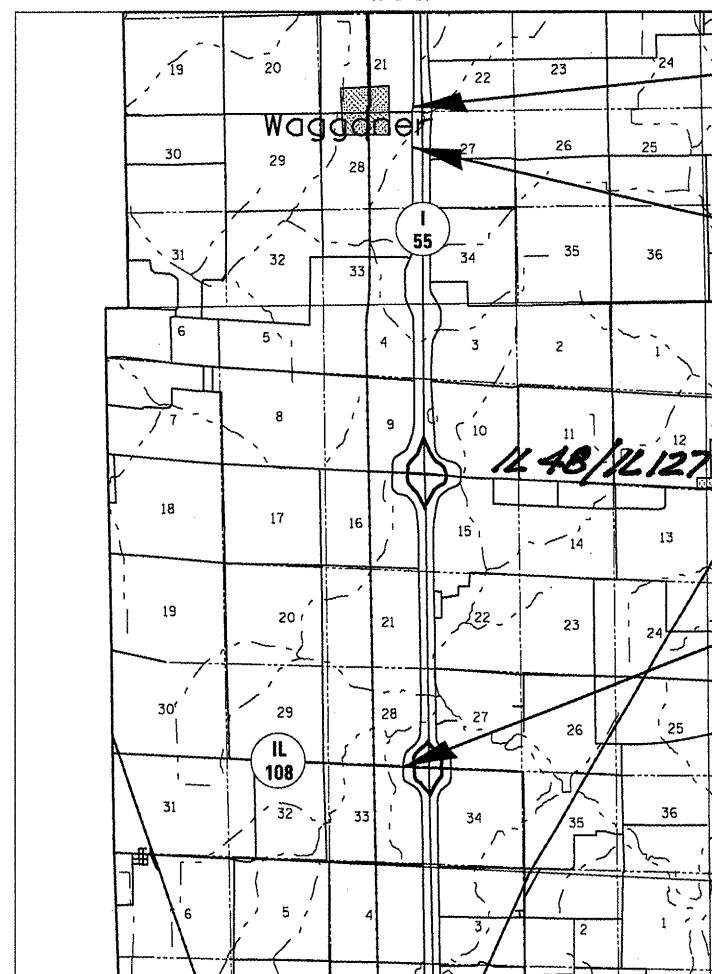

BEGIN PROJECT
STA. 1295 + 00.00

STA. EQ. 1333 + 65.23bk
= 1333 + 60.22ah

END PROJECT
STA. 1651 + 36.53

ADT 350 (UNKNOWN)

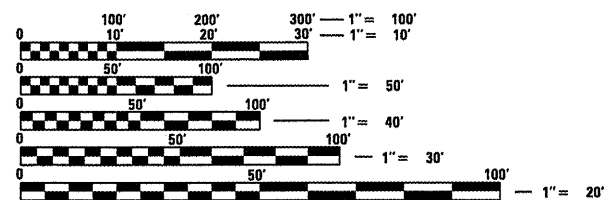

FULL SIZE PLANS HAVE BEEN PREPARED USING STANDARD ENGINEERING SCALES. REDUCED SIZED PLANS WILL NOT CONFORM TO STANDARD SCALES. IN MAKING MEASUREMENTS ON REDUCED PLANS, THE ABOVE SCALES MAY BE USED.

J.U.L.I.E.
JOINT UTILITY LOCATION INFORMATION FOR EXCAVATION
1-800-892-0123
OR 811

PLAN AND CONTRACT TECHNICIAN
TIMOTHY SHARP (217)782-7743

CONTRACT NO. 72E58

GROSS LENGTH = 35,641.54 FT. = 6.750 MILES

STATE OF ILLINOIS
DEPARTMENT OF TRANSPORTATION
DIVISION OF HIGHWAYS

SUBMITTED July 31 20 11

Roy J. Daiky
DEPUTY DIRECTOR OF HIGHWAYS, REGION ENGINEER

July 1 20 11
Scott E. Stitt, PE, Inc.
ENGINEER OF DESIGN AND ENVIRONMENT

July 1 20 11
Christine M. Reed
DIRECTOR OF HIGHWAYS, CHIEF ENGINEER

PRINTED BY THE AUTHORITY
OF THE STATE OF ILLINOIS