

STATE OF ILLINOIS
 DEPARTMENT OF TRANSPORTATION
 DIVISION OF HIGHWAYS

**PROPOSED
 CONTRACT MAINTENANCE**

FAS 1741/2729 (FR I-55 WEST)
 SECTION (112,116)I

MONTGOMERY COUNTY

F.A.S. RTE. 1741/2729	SECTION (112,116)I	COUNTY MONTGOMERY	TOTAL SHEETS 5	SHEET NO. 1
FED. ROAD DIST. NO.	ILLINOIS	CONTRACT NO. 72E58		

FOR INDEX OF SHEETS, SEE SHEET NO. 2

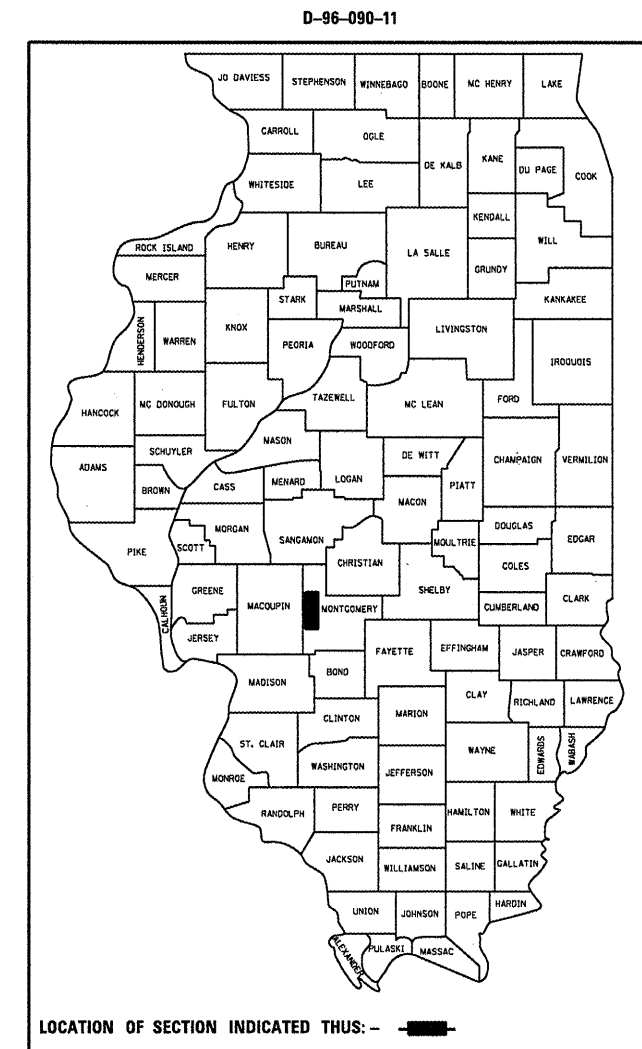

C-96-090-11

R 5 W

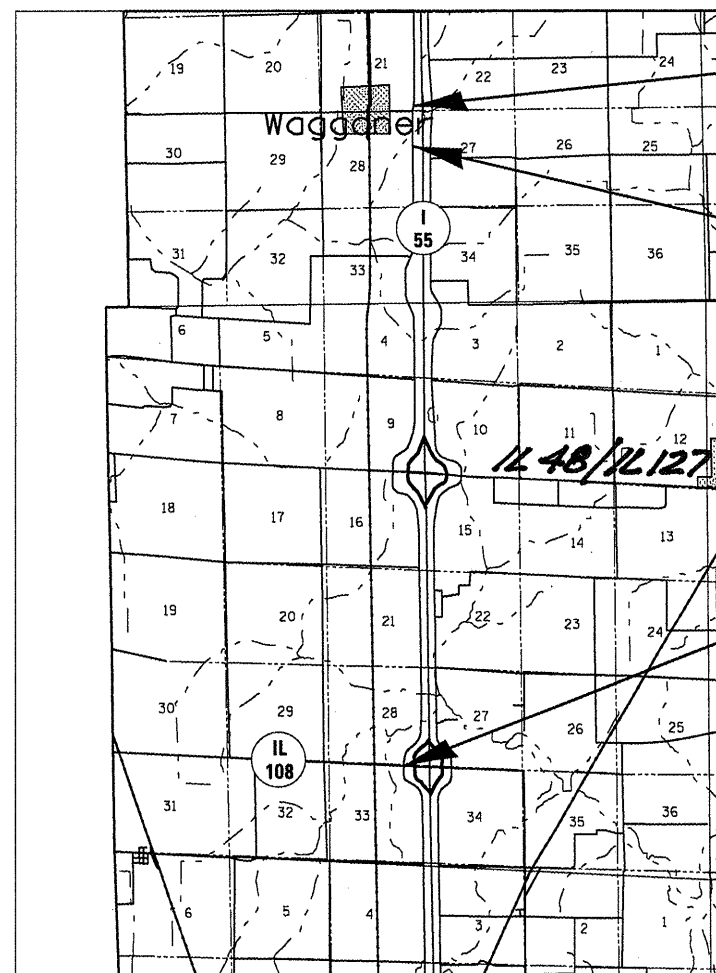

BEGIN PROJECT
 STA. 1295 + 00.00

STA. EQ. 1333 + 65.23bk
 = 1333 + 60.22ah

END PROJECT
 STA. 1651 + 36.53

ADT 350 (UNKNOWN)

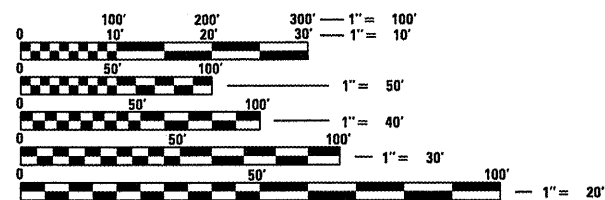

FULL SIZE PLANS HAVE BEEN PREPARED USING STANDARD ENGINEERING SCALES. REDUCED SIZED PLANS WILL NOT CONFORM TO STANDARD SCALES. IN MAKING MEASUREMENTS ON REDUCED PLANS, THE ABOVE SCALES MAY BE USED.

J.U.L.I.E.
 JOINT UTILITY LOCATION INFORMATION FOR EXCAVATION
 1-800-892-0123
 OR 811

PLAN AND CONTRACT TECHNICIAN
 TIMOTHY SHARP (217)782-7743

CONTRACT NO. 72E58

GROSS LENGTH = 35,641.54 FT. = 6.750 MILES

STATE OF ILLINOIS
 DEPARTMENT OF TRANSPORTATION
 DIVISION OF HIGHWAYS

SUBMITTED July 31 2011
Roy J. Dickey
 DEPUTY DIRECTOR OF HIGHWAYS, REGION ENGINEER

July 1 2011
Scott E. Stitt, PE, Inc.
 acting ENGINEER OF DESIGN AND ENVIRONMENT

July 1 2011
Christine M. Reed, Inc.
 DIRECTOR OF HIGHWAYS, CHIEF ENGINEER

PRINTED BY THE AUTHORITY
 OF THE STATE OF ILLINOIS

INDEX

- 1 COVER
- 2 INDEX/STANDARDS/SIGNATURES
- 3 QUANTITIES
- 4 LOCATION MAP
- 5 TYPICAL SECTIONS

STANDARDS

- 442201-03
- 701001-02
- 701006-03
- 701201-04
- 701301-04
- 701901-01
- 780001-02

STATE OF ILLINOIS DEPARTMENT OF TRANSPORTATION DIVISION OF HIGHWAYS DISTRICT 6	
EXAMINED <u>MAY 26</u> 20 <u>11</u>	<u><i>Dick Walsh</i></u> ENGINEER OF OPERATIONS
EXAMINED <u>MAY 20</u> 20 <u>11</u>	<u><i>Tommy J. ...</i></u> ENGINEER OF PROJECT IMPLEMENTATION
EXAMINED <u>May 20</u> 20 <u>11</u>	<u><i>ARMLY</i></u> ENGINEER OF PROGRAM DEVELOPMENT

INDEX/STANDARDS/SIGNATURES
FAS 1741/2729 (FR I-55 WEST)
SECTION (112,116)I
MACOUPIN COUNTY

SUMMARY OF QUANTITIES

CODE NO.	ITEM	UNIT	100% STATE
			0005
			TOTAL QTY
44201690	CLASS D PATCHES, TYPE I, 4 INCH	SQ YD	1,480
44201692	CLASS D PATCHES, TYPE II, 4 INCH	SQ YD	1,120
67100100	MOBILIZATION	L SUM	1
70100450	TRAFFIC CONTROL AND PROTECTION, STANDARD 701201	L SUM	1

QUANTITIES
 FAS 1741/2729 (FR I-55 WEST)
 SECTION (112,116)I
 MONTGOMERY COUNTY



Begin Project
Sta. 1295+00

STA. EQ. 1333+65.23bk
=1333+60.22dh

END PROJECT
STA. 1651+36.53

PLAN
FAS 1741/2729 (FR I-55 WEST)
SECTION (112.116)I
MONTGOMERY COUNTY

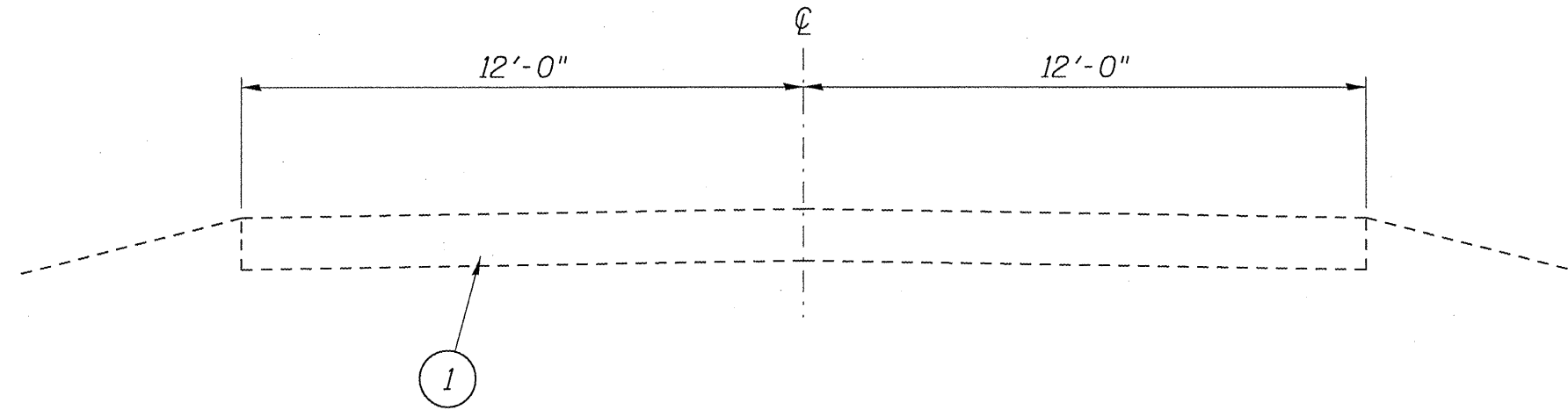

SEE PLAN SHEETS FOR LOCATIONS

L E G E N D

1 - EXIST. P.C.C. PAVEMENT 10"

MIXTURE REQUIREMENTS	
THE FOLLOWING MIXTURE REQUIREMENTS ARE APPLICABLE FOR THIS PROJECT	
MIXTURE USE(S):	PAVEMENT PATCHING
AC/PG	PG 64-22
DESIGN AIR VOIDS:	4.0% @ N DESIGN = 50
MIXTURE COMP:	IL 9.5 or IL 12.5
FRICITION AGG:	N/A

TYPICALS
FAS 1741/2729 (FR I-55 WEST)
SECTION (112,116)I
MONTGOMERY COUNTY