

STATE OF ILLINOIS
 DEPARTMENT OF TRANSPORTATION
 DIVISION OF HIGHWAYS

**PROPOSED
 HIGHWAY PLANS**

F.A.P. ROUTE 781 (IL RTE. 33)
 SECTION D7 BEAM REPAIR 2012-1

BRIDGE BEAM REPLACEMENT
 CRAWFORD COUNTY
 C-97-068-11

FOR INDEX OF SHEETS, SEE SHEET NO. 2

ADT = 1800 (2010)

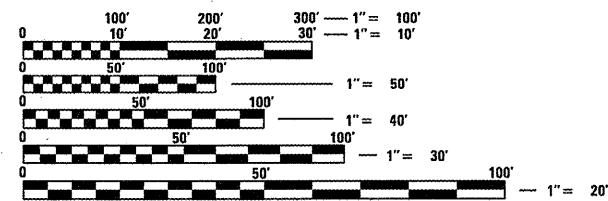

FULL SIZE PLANS HAVE BEEN PREPARED USING STANDARD ENGINEERING SCALES. REDUCED SIZED PLANS WILL NOT CONFORM TO STANDARD SCALES. IN MAKING MEASUREMENTS ON REDUCED PLANS, THE ABOVE SCALES MAY BE USED.

J.U.L.I.E.
 JOINT UTILITY LOCATION INFORMATION FOR EXCAVATION
 1-800-892-0123
 OR 811

PROJECT ENGINEER: TOM RONAN
 PROJECT MANAGER: TOM RONAN
 PHONE: (217)-342-8320
 CONTRACT NO. 74523

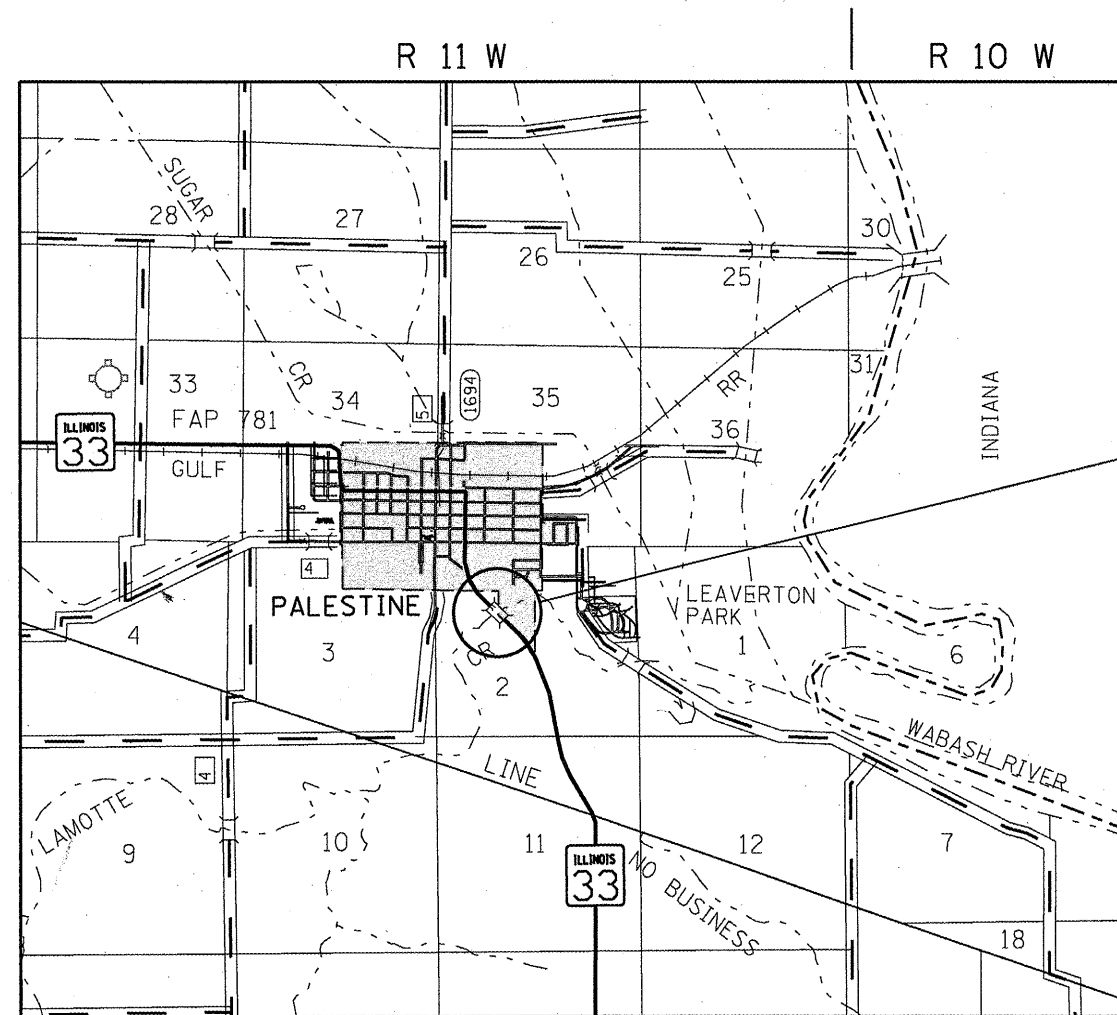

GROSS LENGTH = 104 FT. = 0.02 MILE
 NET LENGTH = 104 FT. = 0.02 MILE



T 7 N
 T 6 N

PROJECT LOCATION:
 S.N. 017-0007

F.A.P. RTE.	SECTION	COUNTY	TOTAL SHEETS	SHEET NO.
781	D7 BEAM REPAIR 2012-1	CRAWFORD	10	1
		ILLINOIS	CONTRACT NO. 74523	

D-97-025-11

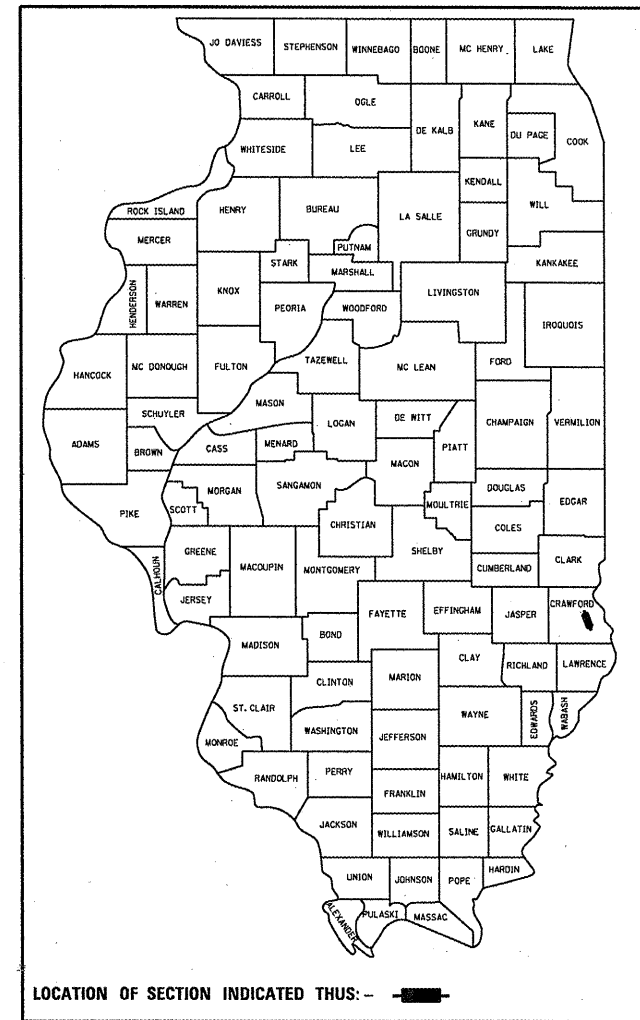

LOCATION OF SECTION INDICATED THIS: —

STATE OF ILLINOIS
 DEPARTMENT OF TRANSPORTATION
 DIVISION OF HIGHWAYS

SUBMITTED 05-24 2011
Roger L. Driskell
 DEPUTY DIRECTOR OF HIGHWAYS, REGION ENGINEER

July 1 2011
Sally E. Stitt
 acting ENGINEER OF DESIGN AND ENVIRONMENT

July 1 2011
Christine M. Reed
 DIRECTOR OF HIGHWAYS, CHIEF ENGINEER

PRINTED BY THE AUTHORITY
 OF THE STATE OF ILLINOIS