

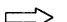

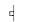

MAINTENANCE OF TRAFFIC LEGEND

-  WORK ZONE
-  TRAFFIC FLOW
-  EXISTING SIGN
-  FLAGGERS
-  PROPOSED SIGN
-  DRUMS
-  TRAFFIC CONTROL SIGN W/ TYPE B MONODIRECTIONAL FLASHING LIGHT

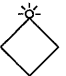
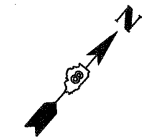

MATCH LINE STA. 53+50
SEE SHEET 48

MATCH LINE STA. 54+00
SEE SHEET 48

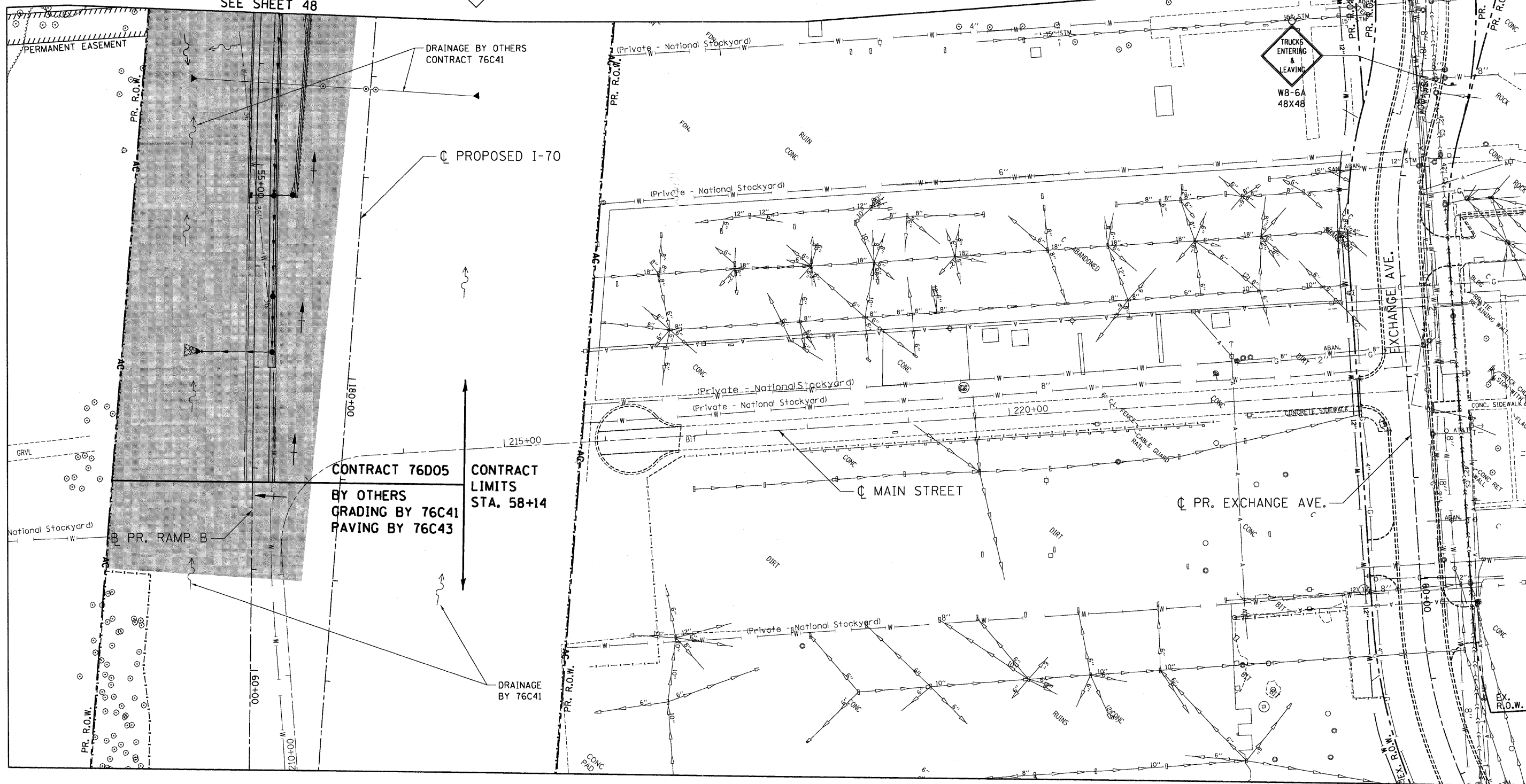

\NORCON-10-MOTIFL.DGN, \NORCON-11-MOTIFL.DGN, \NORCON-12-LEGEND.DGN, \NORCON-13-LAYOUT.DGN, \NORCON-14-MOTIFL.DGN, \NORCON-15-MOTIFL.DGN, \NORCON-16-MOTIFL.DGN, \NORCON-17-MOTIFL.DGN, \NORCON-18-MOTIFL.DGN, \NORCON-19-MOTIFL.DGN, \NORCON-20-MOTIFL.DGN, \NORCON-21-MOTIFL.DGN, \NORCON-22-MOTIFL.DGN, \NORCON-23-MOTIFL.DGN, \NORCON-24-MOTIFL.DGN, \NORCON-25-MOTIFL.DGN, \NORCON-26-MOTIFL.DGN, \NORCON-27-MOTIFL.DGN, \NORCON-28-MOTIFL.DGN, \NORCON-29-MOTIFL.DGN, \NORCON-30-MOTIFL.DGN, \NORCON-31-MOTIFL.DGN, \NORCON-32-MOTIFL.DGN, \NORCON-33-MOTIFL.DGN, \NORCON-34-MOTIFL.DGN, \NORCON-35-MOTIFL.DGN, \NORCON-36-MOTIFL.DGN, \NORCON-37-MOTIFL.DGN, \NORCON-38-MOTIFL.DGN, \NORCON-39-MOTIFL.DGN, \NORCON-40-MOTIFL.DGN, \NORCON-41-MOTIFL.DGN, \NORCON-42-MOTIFL.DGN, \NORCON-43-MOTIFL.DGN, \NORCON-44-MOTIFL.DGN, \NORCON-45-MOTIFL.DGN, \NORCON-46-MOTIFL.DGN, \NORCON-47-MOTIFL.DGN, \NORCON-48-MOTIFL.DGN, \NORCON-49-MOTIFL.DGN, \NORCON-50-MOTIFL.DGN, \NORCON-51-MOTIFL.DGN, \NORCON-52-MOTIFL.DGN, \NORCON-53-MOTIFL.DGN, \NORCON-54-MOTIFL.DGN, \NORCON-55-MOTIFL.DGN, \NORCON-56-MOTIFL.DGN, \NORCON-57-MOTIFL.DGN, \NORCON-58-MOTIFL.DGN, \NORCON-59-MOTIFL.DGN, \NORCON-60-MOTIFL.DGN, \NORCON-61-MOTIFL.DGN, \NORCON-62-MOTIFL.DGN, \NORCON-63-MOTIFL.DGN, \NORCON-64-MOTIFL.DGN, \NORCON-65-MOTIFL.DGN, \NORCON-66-MOTIFL.DGN, \NORCON-67-MOTIFL.DGN, \NORCON-68-MOTIFL.DGN, \NORCON-69-MOTIFL.DGN, \NORCON-70-MOTIFL.DGN, \NORCON-71-MOTIFL.DGN, \NORCON-72-MOTIFL.DGN, \NORCON-73-MOTIFL.DGN, \NORCON-74-MOTIFL.DGN, \NORCON-75-MOTIFL.DGN, \NORCON-76-MOTIFL.DGN, \NORCON-77-MOTIFL.DGN, \NORCON-78-MOTIFL.DGN, \NORCON-79-MOTIFL.DGN, \NORCON-80-MOTIFL.DGN, \NORCON-81-MOTIFL.DGN, \NORCON-82-MOTIFL.DGN, \NORCON-83-MOTIFL.DGN, \NORCON-84-MOTIFL.DGN, \NORCON-85-MOTIFL.DGN, \NORCON-86-MOTIFL.DGN, \NORCON-87-MOTIFL.DGN, \NORCON-88-MOTIFL.DGN, \NORCON-89-MOTIFL.DGN, \NORCON-90-MOTIFL.DGN, \NORCON-91-MOTIFL.DGN, \NORCON-92-MOTIFL.DGN, \NORCON-93-MOTIFL.DGN, \NORCON-94-MOTIFL.DGN, \NORCON-95-MOTIFL.DGN, \NORCON-96-MOTIFL.DGN, \NORCON-97-MOTIFL.DGN, \NORCON-98-MOTIFL.DGN, \NORCON-99-MOTIFL.DGN, \NORCON-100-MOTIFL.DGN

FILE NAME =	USER NAME = *USER*	DESIGNED - JB	REVISED -	STATE OF ILLINOIS DEPARTMENT OF TRANSPORTATION RELOCATED ILLINOIS ROUTE 3	PROPOSED RAMP B SUGGESTED STAGING, MAINTENANCE OF TRAFFIC STA. 53+50 TO STA. 61+00		F.A.P. RTE. 998	SECTION 82-2-1HVB-1	COUNTY ST. CLAIR	TOTAL SHEETS 345	SHEET NO. 50	
#FILE#	PLOT SCALE = *SCALE*	DRAWN - JFS	REVISED -		SCALE: 1"=50'	SHEET NO. 5 OF 5 SHEETS	STA. TO STA.	FED. ROAD DIST. NO.	ILLINOIS FED. AID PROJECT	CONTRACT NO. 76D05		
	PLOT DATE = *DATE*	CHECKED - ACL	REVISED -									
		DATE - 05/13/11	REVISED -									

