

MATCH LINE STA. 20+00  
SEE SHEET 53

MATCH LINE STA. 46+00  
SEE SHEET 53

MATCH LINE STA. 1679+50  
SEE SHEET 51

MATCH LINE STA. 53+50  
SEE SHEET 55

CONTRACT LIMITS  
STA. 1693+28.38  
CONTRACT 76D05

CONTRACT 76D05 CONTRACT 76E06  
BY OTHERS  
PR. REL IL RTE 3  
EMBANKMENT PLATFORM  
LIMITS STA. 1689+00.00

MATCH LINE STA. 54+00  
SEE SHEET 55

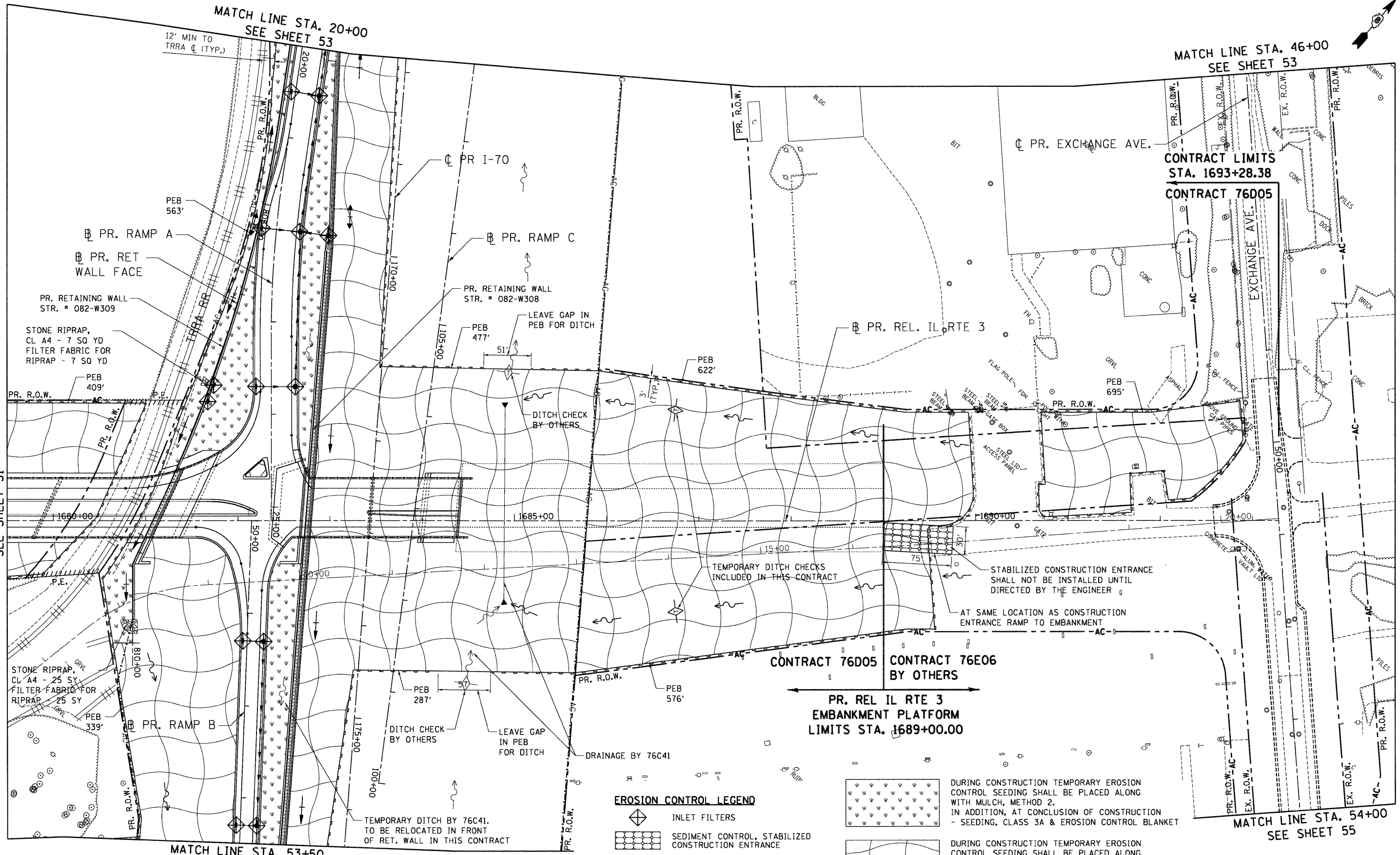

**EROSION CONTROL LEGEND**

- INLET FILTERS
- SEDIMENT CONTROL, STABILIZED CONSTRUCTION ENTRANCE
- PERIMETER EROSION BARRIER (PEB)
- TEMPORARY DITCH CHECKS

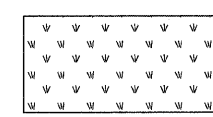

DURING CONSTRUCTION TEMPORARY EROSION CONTROL SEEDING SHALL BE PLACED ALONG WITH MULCH, METHOD 2. IN ADDITION, AT CONCLUSION OF CONSTRUCTION - SEEDING, CLASS 3A & EROSION CONTROL BLANKET



DURING CONSTRUCTION TEMPORARY EROSION CONTROL SEEDING SHALL BE PLACED ALONG WITH MULCH, METHOD 2. IN ADDITION, AT CONCLUSION OF CONSTRUCTION - SEEDING, CLASS 7 (SPECIAL) & EROSION CONTROL BLANKET

\BDCONN-99-MOTIFIELD.DGN, \BDCONN-10-BORDER.DGN, \BDCONN-11-MOTIFIELD.DGN, \BDCONN-12-LEGEND.DGN, \BDCONN-13-LAYOUT.DGN, \BDCONN-14-MOTIFIELD.DGN, \BDCONN-15-CONTRACT.SHEET.DGN, \BDCONN-16-EROSION.DGN, \BDCONN-17-TRAFFIC.DGN, \BDCONN-18-MOTIFIELD.DGN, \BDCONN-19-BORDER.DGN, \BDCONN-20-MOTIFIELD.DGN, \BDCONN-21-TRAFFIC.DGN, \BDCONN-22-TRAFFIC.DGN, \BDCONN-23-TRAFFIC.DGN, \BDCONN-24-TRAFFIC.DGN, \BDCONN-25-TRAFFIC.DGN, \BDCONN-26-TRAFFIC.DGN, \BDCONN-27-TRAFFIC.DGN, \BDCONN-28-TRAFFIC.DGN, \BDCONN-29-TRAFFIC.DGN, \BDCONN-30-TRAFFIC.DGN, \BDCONN-31-TRAFFIC.DGN, \BDCONN-32-TRAFFIC.DGN, \BDCONN-33-TRAFFIC.DGN, \BDCONN-34-TRAFFIC.DGN, \BDCONN-35-TRAFFIC.DGN, \BDCONN-36-TRAFFIC.DGN, \BDCONN-37-TRAFFIC.DGN, \BDCONN-38-TRAFFIC.DGN, \BDCONN-39-TRAFFIC.DGN, \BDCONN-40-TRAFFIC.DGN, \BDCONN-41-TRAFFIC.DGN, \BDCONN-42-TRAFFIC.DGN, \BDCONN-43-TRAFFIC.DGN, \BDCONN-44-TRAFFIC.DGN, \BDCONN-45-TRAFFIC.DGN, \BDCONN-46-TRAFFIC.DGN, \BDCONN-47-TRAFFIC.DGN, \BDCONN-48-TRAFFIC.DGN, \BDCONN-49-TRAFFIC.DGN, \BDCONN-50-TRAFFIC.DGN, \BDCONN-51-TRAFFIC.DGN, \BDCONN-52-TRAFFIC.DGN, \BDCONN-53-TRAFFIC.DGN, \BDCONN-54-TRAFFIC.DGN, \BDCONN-55-TRAFFIC.DGN, \BDCONN-56-TRAFFIC.DGN, \BDCONN-57-TRAFFIC.DGN, \BDCONN-58-TRAFFIC.DGN, \BDCONN-59-TRAFFIC.DGN, \BDCONN-60-TRAFFIC.DGN, \BDCONN-61-TRAFFIC.DGN, \BDCONN-62-TRAFFIC.DGN, \BDCONN-63-TRAFFIC.DGN, \BDCONN-64-TRAFFIC.DGN, \BDCONN-65-TRAFFIC.DGN, \BDCONN-66-TRAFFIC.DGN, \BDCONN-67-TRAFFIC.DGN, \BDCONN-68-TRAFFIC.DGN, \BDCONN-69-TRAFFIC.DGN, \BDCONN-70-TRAFFIC.DGN, \BDCONN-71-TRAFFIC.DGN, \BDCONN-72-TRAFFIC.DGN, \BDCONN-73-TRAFFIC.DGN, \BDCONN-74-TRAFFIC.DGN, \BDCONN-75-TRAFFIC.DGN, \BDCONN-76-TRAFFIC.DGN, \BDCONN-77-TRAFFIC.DGN, \BDCONN-78-TRAFFIC.DGN, \BDCONN-79-TRAFFIC.DGN, \BDCONN-80-TRAFFIC.DGN, \BDCONN-81-TRAFFIC.DGN, \BDCONN-82-TRAFFIC.DGN, \BDCONN-83-TRAFFIC.DGN, \BDCONN-84-TRAFFIC.DGN, \BDCONN-85-TRAFFIC.DGN, \BDCONN-86-TRAFFIC.DGN, \BDCONN-87-TRAFFIC.DGN, \BDCONN-88-TRAFFIC.DGN, \BDCONN-89-TRAFFIC.DGN, \BDCONN-90-TRAFFIC.DGN, \BDCONN-91-TRAFFIC.DGN, \BDCONN-92-TRAFFIC.DGN, \BDCONN-93-TRAFFIC.DGN, \BDCONN-94-TRAFFIC.DGN, \BDCONN-95-TRAFFIC.DGN, \BDCONN-96-TRAFFIC.DGN, \BDCONN-97-TRAFFIC.DGN, \BDCONN-98-TRAFFIC.DGN, \BDCONN-99-TRAFFIC.DGN, \BDCONN-100-TRAFFIC.DGN

FILE NAME =  
 USER NAME = #USER#  
 DESIGNED - JB  
 DRAWN - JFS  
 CHECKED - JB  
 DATE - 05/13/11

PLOT SCALE = #SCALE#  
 PLOT DATE = #DATE#

DESIGNED - JB  
 DRAWN - JFS  
 CHECKED - JB  
 DATE - 05/13/11

**STATE OF ILLINOIS  
 DEPARTMENT OF TRANSPORTATION**  
 RELOCATED ILLINOIS ROUTE 3

**PROPOSED RELOCATED ILLINOIS ROUTE 3  
 EROSION CONTROL PLAN**  
 STA. 1679+50 TO STA. 1693+28.38

SCALE: 1"=50'  
 SHEET NO. 2 OF 6 SHEETS STA. TO STA.

F.A.P. RTE.	SECTION	COUNTY	TOTAL SHEETS	SHEET NO.
998	82-2-1HVB-1	ST. CLAIR	345	52
CONTRACT NO. 76D05				
FED. ROAD DIST. NO. ILLINOIS FED. AID PROJECT				