

**BEARING SEAT ELEVATIONS**

Girder	Elevations
1A	443.86
1	441.09
2	441.35
3	441.53
4	441.71
5	441.88
6	442.06
7	441.96
8	441.80

**PILE DATA**

Type: MS14X0.25 Metal Sheet Piles  
 Nominal Required Bearing: 413 kips/pile  
 Factored Resistance Available: 227 kips/pile  
 Est. Length: 98 ft  
 No. Production Piles: 16  
 No. Test Piles: 1

**NOTES:**

- Hatched area of abutment backwall to be poured after superstructure forms have been removed. Quantity of concrete included with Concrete Superstructure.
- Longitudinal h7(E), h8(E), h9(E), and p8(E) shall be sprung into place to be concentric at the spacing noted.
- For details of piles, see Sht. SA-36
- Space reinforcement in cap to miss anchor bolts.
- Pour steps monolithically with cap.

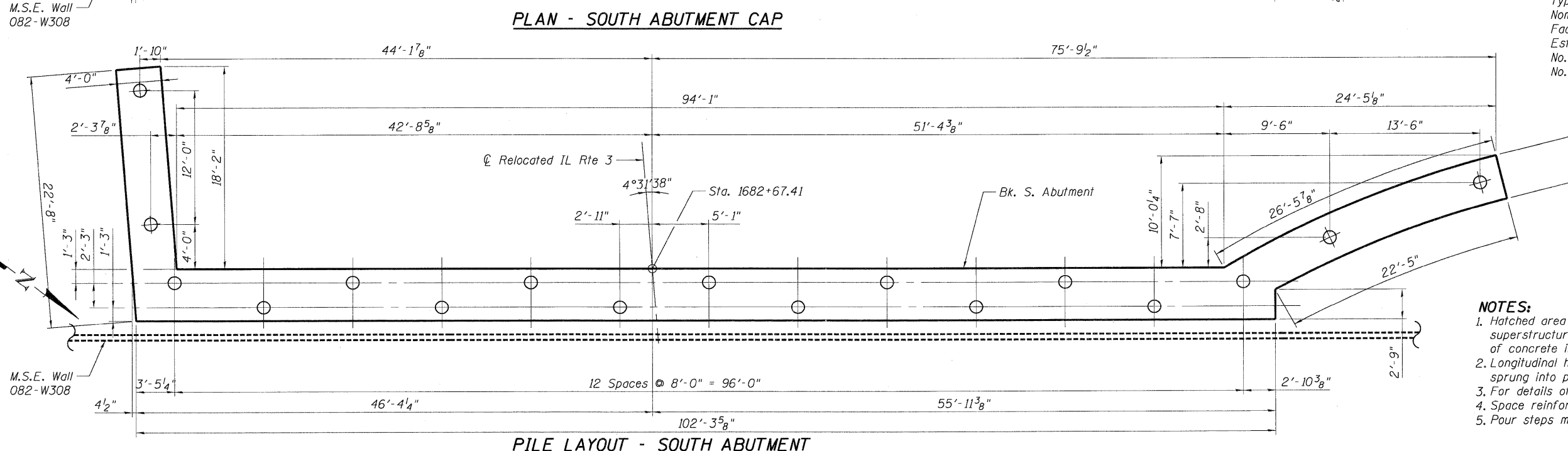
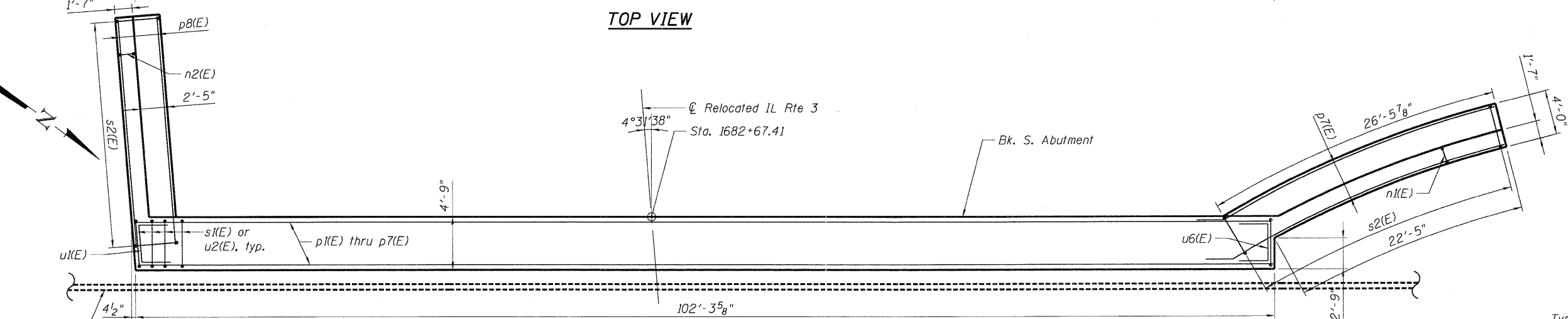
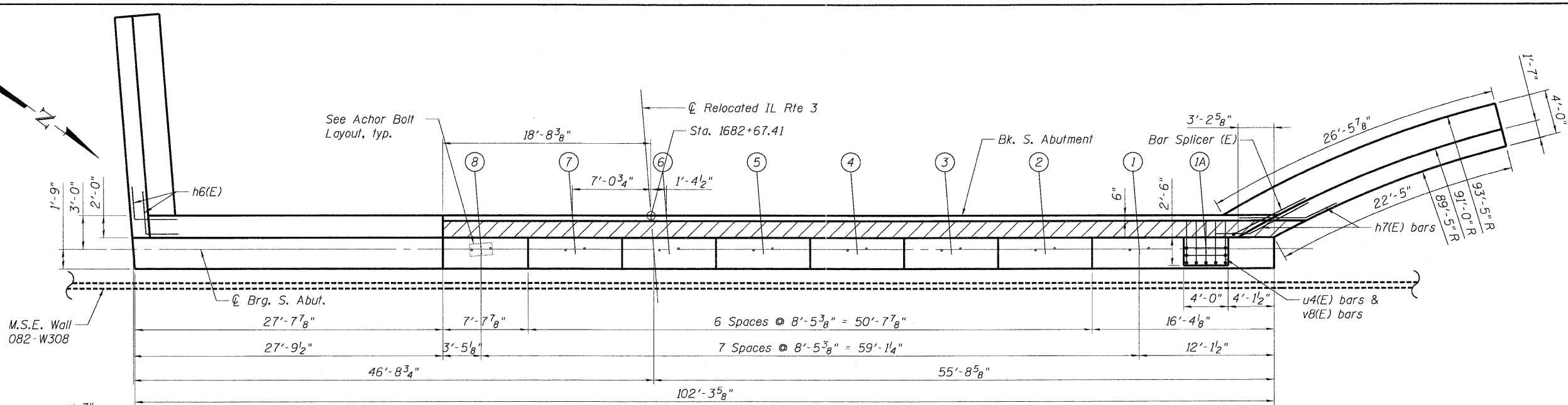

FILE NAME: 082-0328 CONN-10-001-AB.DGN...  
 USER NAME: #USER#  
 DESIGNED: MDJ  
 DRAWN: MDJ  
 CHECKED: JLR  
 DATE: 05/13/11  
 REVISED: -  
 REVISED: -  
 REVISED: -  
 REVISED: -  
 REVISED: -  
 PLOT SCALE: #SCALE#  
 PLOT DATE: #DATE#