

BENCHMARK: Monument No. 8: Aluminum disk set in the south end of a headwall to a box culvert under Illinois Route 3, 0.7 miles south of Canal Street, 0.1 miles south of Industrial Drive and north of single railroad track. El. 401.95

EXISTING STRUCTURE:

None

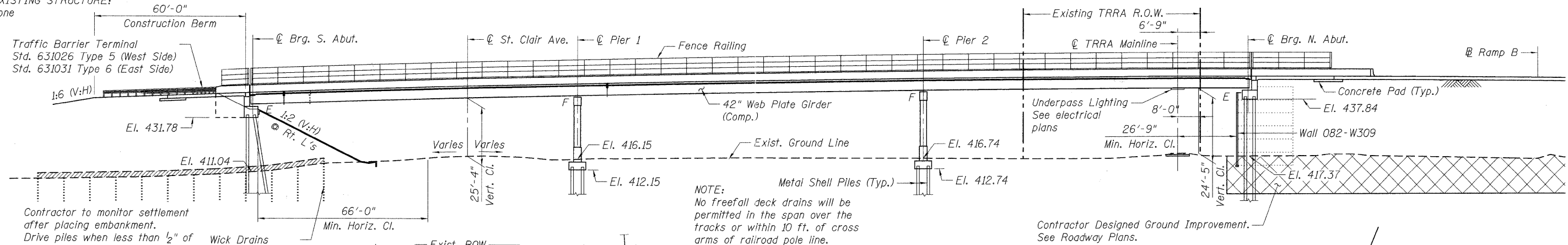

ELEVATION

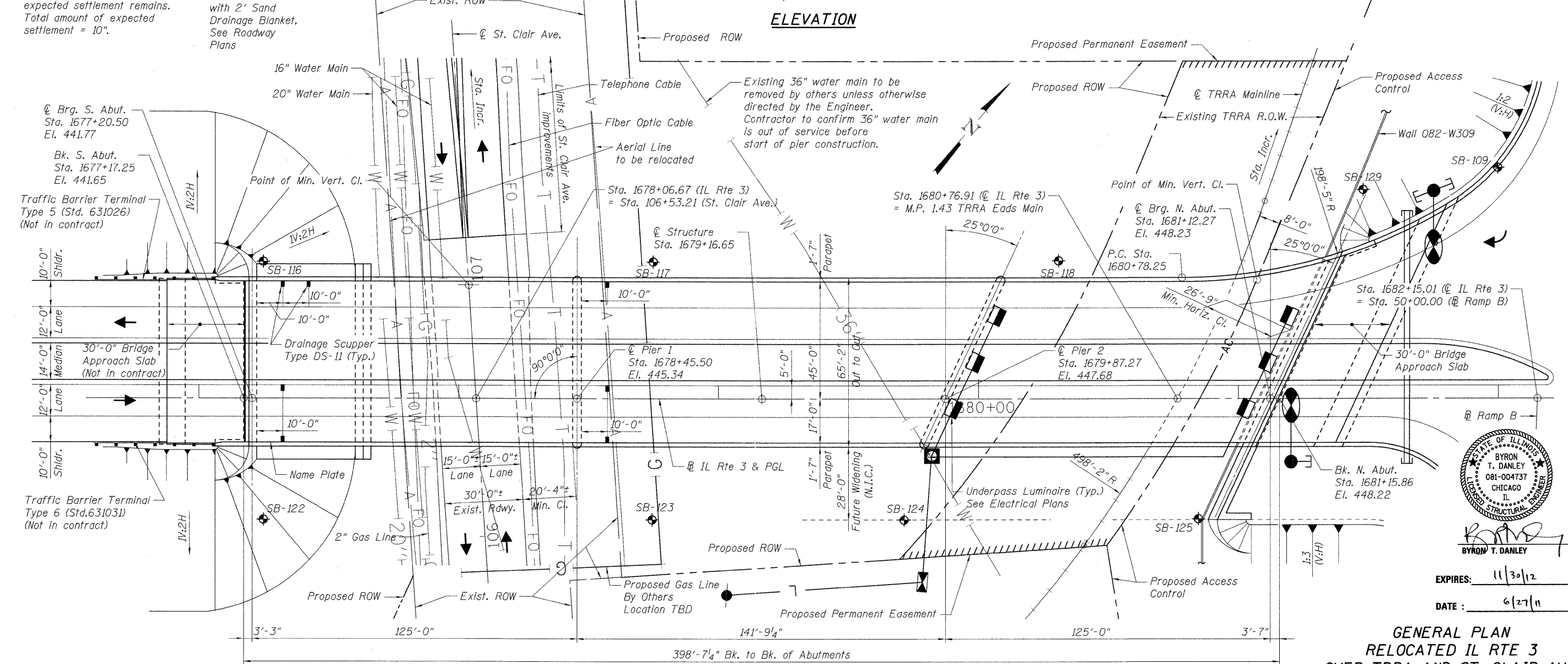

PLAN



BYRON T. DANLEY
 CHICAGO, ILL.

EXPIRES: 11/30/12
 DATE: 6/27/11

**GENERAL PLAN
 RELOCATED IL RTE 3
 OVER TRRA AND ST. CLAIR AVE.
 F.A.P. RTE. 14 SEC. 82-2-IHVB-1
 ST. CLAIR COUNTY
 STA. 1679+16.65
 STRUCTURE NO. 082-0329**

FILE NAME = \$FILEL\$	USER NAME = \$USER\$	DESIGNED - TCG	REVISED -	STATE OF ILLINOIS DEPARTMENT OF TRANSPORTATION	GENERAL PLAN		F.A.P. RTE. 998	SECTION 82-2-IHVB-1	COUNTY ST. CLAIR	TOTAL SHEETS 345	SHEET NO. 193
	PLOT SCALE = \$SCALE\$	DRAWN - HBJ	REVISED -		IL 3 OVER TRRA & ST. CLAIR AVENUE		SCALE:	SN 082-0329	CONTRACT NO. 76D05		
	PLOT DATE = \$DATE\$	CHECKED - JLR	REVISED -				SHEET NO. SB-1 OF SB-63	STA. 1679+16.65 TO STA.			
		DATE - 05/13/11	REVISED -								

0820329-CON-10-001-PG.DGN, 0820329-CON-09-001-BD.DGN, 0820329-CON-09-002-LIGHT.DGN, 0820329-CON-09-003-UTL.DGN, 0820329-CON-09-004-TRANS.DGN, 0820329-CON-09-005-STRUCT.DGN, 0820329-CON-09-006-ROAD.DGN, 0820329-CON-09-007-RAIL.DGN, 0820329-CON-09-008-RAIL.DGN, 0820329-CON-09-009-RAIL.DGN, 0820329-CON-09-010-RAIL.DGN, 0820329-CON-09-011-RAIL.DGN, 0820329-CON-09-012-RAIL.DGN, 0820329-CON-09-013-RAIL.DGN, 0820329-CON-09-014-RAIL.DGN, 0820329-CON-09-015-RAIL.DGN, 0820329-CON-09-016-RAIL.DGN, 0820329-CON-09-017-RAIL.DGN, 0820329-CON-09-018-RAIL.DGN, 0820329-CON-09-019-RAIL.DGN, 0820329-CON-09-020-RAIL.DGN, 0820329-CON-09-021-RAIL.DGN, 0820329-CON-09-022-RAIL.DGN, 0820329-CON-09-023-RAIL.DGN, 0820329-CON-09-024-RAIL.DGN, 0820329-CON-09-025-RAIL.DGN, 0820329-CON-09-026-RAIL.DGN, 0820329-CON-09-027-RAIL.DGN, 0820329-CON-09-028-RAIL.DGN, 0820329-CON-09-029-RAIL.DGN, 0820329-CON-09-030-RAIL.DGN, 0820329-CON-09-031-RAIL.DGN, 0820329-CON-09-032-RAIL.DGN, 0820329-CON-09-033-RAIL.DGN, 0820329-CON-09-034-RAIL.DGN, 0820329-CON-09-035-RAIL.DGN, 0820329-CON-09-036-RAIL.DGN, 0820329-CON-09-037-RAIL.DGN, 0820329-CON-09-038-RAIL.DGN, 0820329-CON-09-039-RAIL.DGN, 0820329-CON-09-040-RAIL.DGN, 0820329-CON-09-041-RAIL.DGN, 0820329-CON-09-042-RAIL.DGN, 0820329-CON-09-043-RAIL.DGN, 0820329-CON-09-044-RAIL.DGN, 0820329-CON-09-045-RAIL.DGN, 0820329-CON-09-046-RAIL.DGN, 0820329-CON-09-047-RAIL.DGN, 0820329-CON-09-048-RAIL.DGN, 0820329-CON-09-049-RAIL.DGN, 0820329-CON-09-050-RAIL.DGN, 0820329-CON-09-051-RAIL.DGN, 0820329-CON-09-052-RAIL.DGN, 0820329-CON-09-053-RAIL.DGN, 0820329-CON-09-054-RAIL.DGN, 0820329-CON-09-055-RAIL.DGN, 0820329-CON-09-056-RAIL.DGN, 0820329-CON-09-057-RAIL.DGN, 0820329-CON-09-058-RAIL.DGN, 0820329-CON-09-059-RAIL.DGN, 0820329-CON-09-060-RAIL.DGN, 0820329-CON-09-061-RAIL.DGN, 0820329-CON-09-062-RAIL.DGN, 0820329-CON-09-063-RAIL.DGN, 0820329-CON-09-064-RAIL.DGN, 0820329-CON-09-065-RAIL.DGN, 0820329-CON-09-066-RAIL.DGN, 0820329-CON-09-067-RAIL.DGN, 0820329-CON-09-068-RAIL.DGN, 0820329-CON-09-069-RAIL.DGN, 0820329-CON-09-070-RAIL.DGN, 0820329-CON-09-071-RAIL.DGN, 0820329-CON-09-072-RAIL.DGN, 0820329-CON-09-073-RAIL.DGN, 0820329-CON-09-074-RAIL.DGN, 0820329-CON-09-075-RAIL.DGN, 0820329-CON-09-076-RAIL.DGN, 0820329-CON-09-077-RAIL.DGN, 0820329-CON-09-078-RAIL.DGN, 0820329-CON-09-079-RAIL.DGN, 0820329-CON-09-080-RAIL.DGN, 0820329-CON-09-081-RAIL.DGN, 0820329-CON-09-082-RAIL.DGN, 0820329-CON-09-083-RAIL.DGN, 0820329-CON-09-084-RAIL.DGN, 0820329-CON-09-085-RAIL.DGN, 0820329-CON-09-086-RAIL.DGN, 0820329-CON-09-087-RAIL.DGN, 0820329-CON-09-088-RAIL.DGN, 0820329-CON-09-089-RAIL.DGN, 0820329-CON-09-090-RAIL.DGN, 0820329-CON-09-091-RAIL.DGN, 0820329-CON-09-092-RAIL.DGN, 0820329-CON-09-093-RAIL.DGN, 0820329-CON-09-094-RAIL.DGN, 0820329-CON-09-095-RAIL.DGN, 0820329-CON-09-096-RAIL.DGN, 0820329-CON-09-097-RAIL.DGN, 0820329-CON-09-098-RAIL.DGN, 0820329-CON-09-099-RAIL.DGN, 0820329-CON-09-100-RAIL.DGN