

Bench Mark:
 Monument No. 8: Aluminum disk set in the south end of a headwall to a box culvert under Illinois Route 3, 0.7 miles south of Canal Street, 0.1 miles south of Industrial Drive and north of single railroad track. El. 401.95

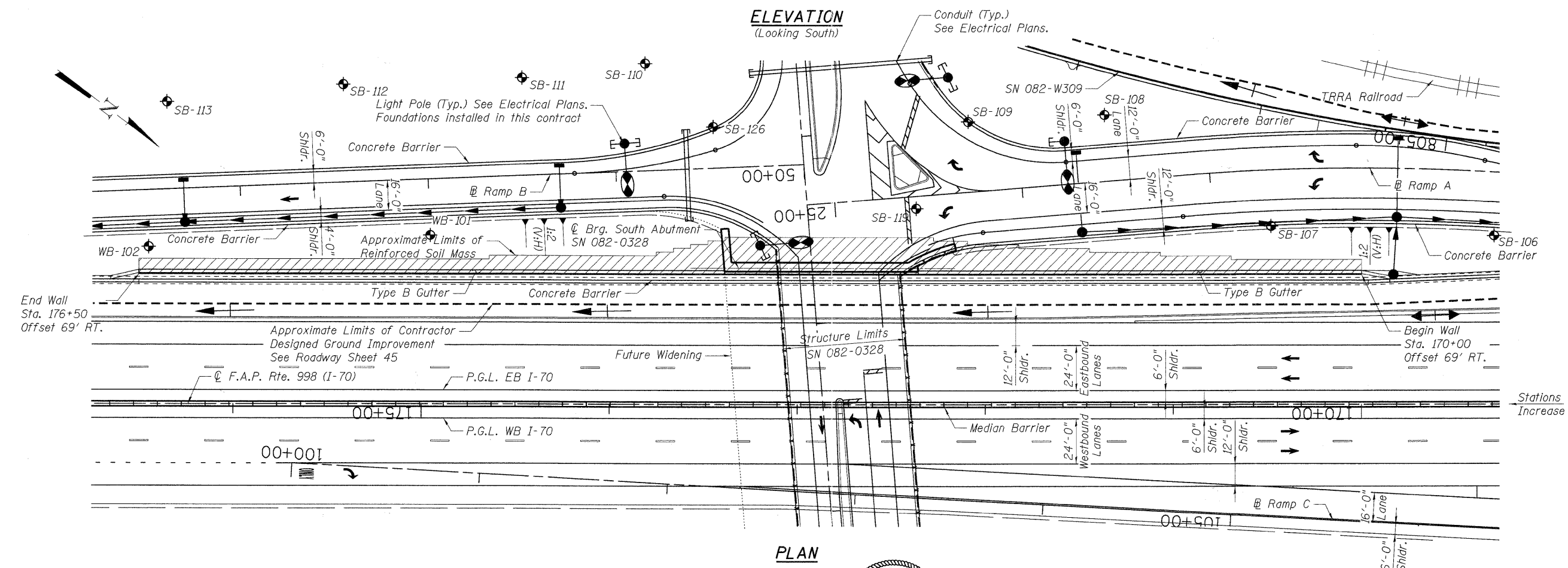
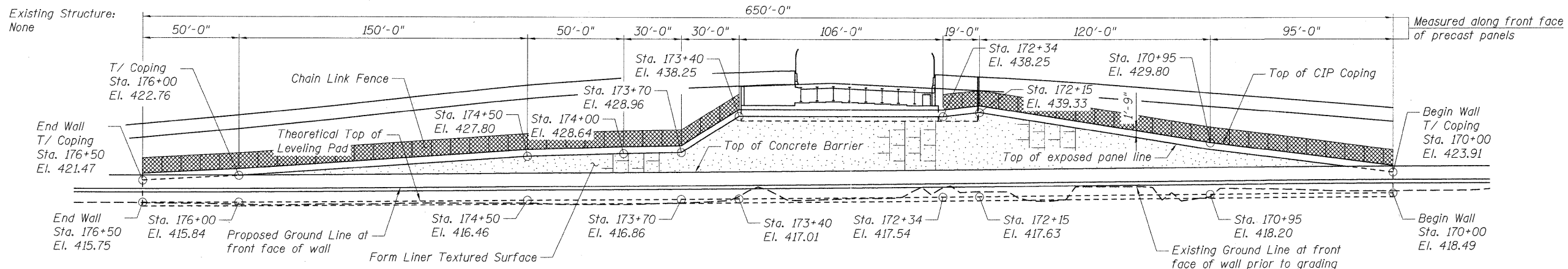

ELEVATION
 (Looking South)

PLAN

DESIGN SPECIFICATIONS

2002 AASHTO Standard Specifications for Highway Bridges, 17th Edition

DESIGN STRESSES

FIELD UNITS
 $f'_c = 3,500$ psi
 $f_y = 60,000$ psi (Reinforcement)

PRECAST UNITS
 $f'_c = 4,500$ psi (Precast Panels)



BYRON T. DANLEY

EXPIRES: 11/30/12
 DATE: 6/27/11

LEGEND

- Soil Boring Location
- Reinforced Soil Mass

NOTE:

Stations and offsets are measured from the ϕ Relocated I-70 to the front face of the MSE wall panels.

GENERAL PLAN
 RELOCATED IL RTE 3 OVER I-70
 F.A.P. RTE. 14 SEC. 82-2-IHVB-1
 ST. CLAIR COUNTY
 STA. 170+00.00 TO STA. 176+50.00
 STRUCTURE NO. 082-W308

FILE NAME = #FILEL#	USER NAME = #USER#	DESIGNED - TCG	REVISED -	STATE OF ILLINOIS DEPARTMENT OF TRANSPORTATION I-70 CONNECTION RETAINING WALL	GENERAL PLAN & ELEVATION		F.A.P. RTE. 998	SECTION 82-2-IHVB-1	COUNTY ST. CLAIR	TOTAL SHEETS 345	SHEET NO. 256	
	PLOT SCALE = #SCALE#	CHECKED - JLR	REVISED -		SCALE:	SHEET NO. RA-1 OF RA-25	STA. 170+00.00 TO STA. 176+50.00	SN 082-W308		CONTRACT NO. T6D05		
	PLOT DATE = #DATE#	DATE - 05/13/11	REVISED -		FED. ROAD DIST. NO. [ILLINOIS] FED. AID PROJECT							
TENG TENG & ASSOCIATES, INC. ENGINEERS/ARCHITECTS/PLANNERS CHICAGO, ILLINOIS												