

DATE	
BY	
SURVEYED	
PLOTTED	
TEMPLATE	
AREAS	
CHECKED	
NO.	

DATE	
BY	
SURVEYED	
PLOTTED	
TEMPLATE	
AREAS	
CHECKED	
NO.	

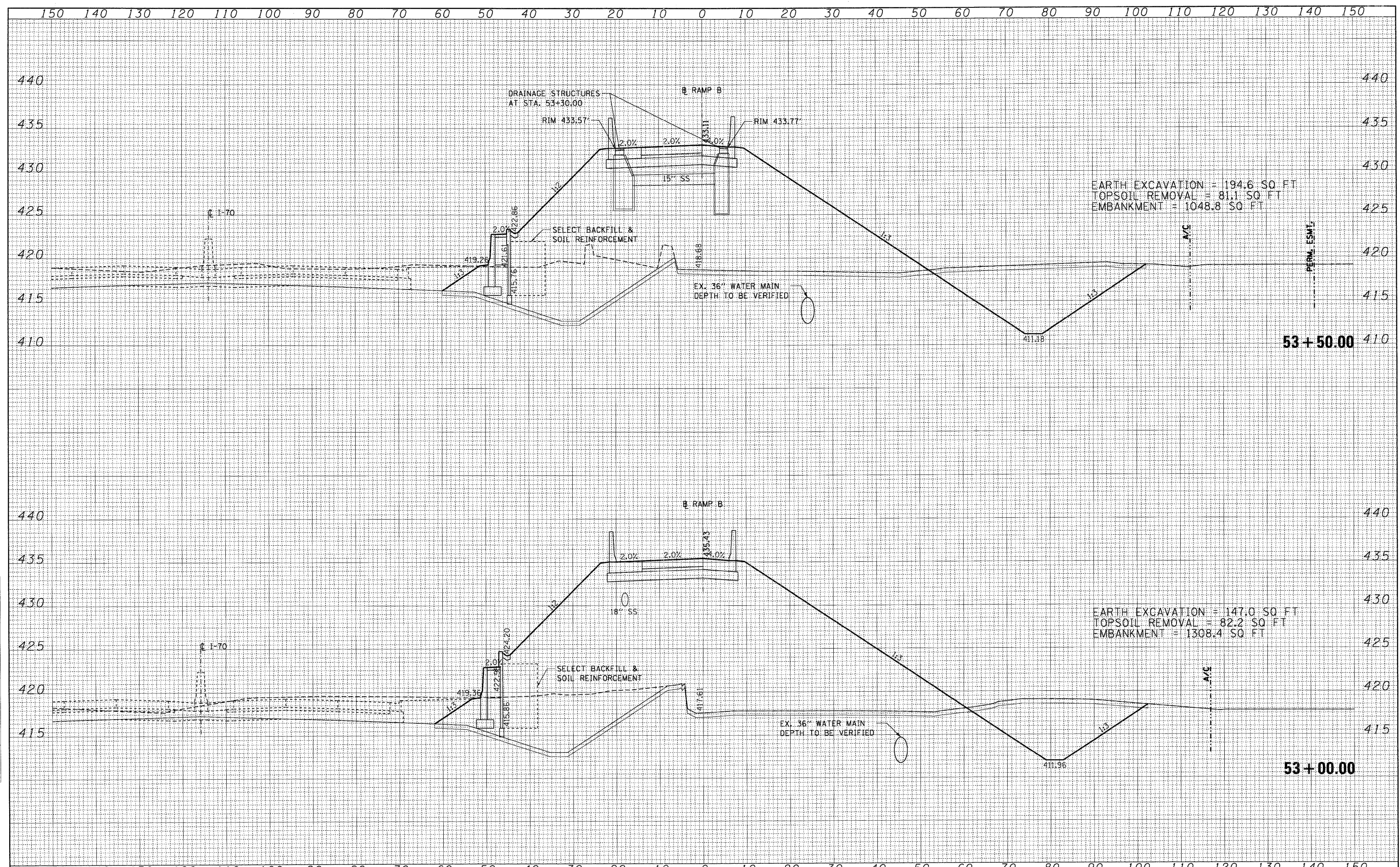

EARTH EXCAVATION = 194.6 SQ FT
 TOPSOIL REMOVAL = 81.1 SQ FT
 EMBANKMENT = 1048.8 SQ FT

EARTH EXCAVATION = 147.0 SQ FT
 TOPSOIL REMOVAL = 82.2 SQ FT
 EMBANKMENT = 1308.4 SQ FT

FILE NAME =	USER NAME = *USER*	DESIGNED - JB	REVISED -	STATE OF ILLINOIS DEPARTMENT OF TRANSPORTATION	CROSS SECTIONS RAMP B				F.A. RTE. 998	SECTION 82-2-1HVB-1	COUNTY ST. CLAIR	TOTAL SHEETS 345	SHEET NO. 340
#FILE#		DRAWN - AG	REVISED -		SCALE:	SHEET NO.	OF	SHEETS	STA. 53+00.00	TO STA. 53+50.00	ILLINOIS FED. AID PROJECT		
		CHECKED - ACL	REVISED -								CONTRACT NO. 76D05		
		DATE - 05/13/11	REVISED -										