

NOTE: FOR PAVEMENT STRIPING QUANTITIES,
SEE SCHEDULE ON SHT. 10

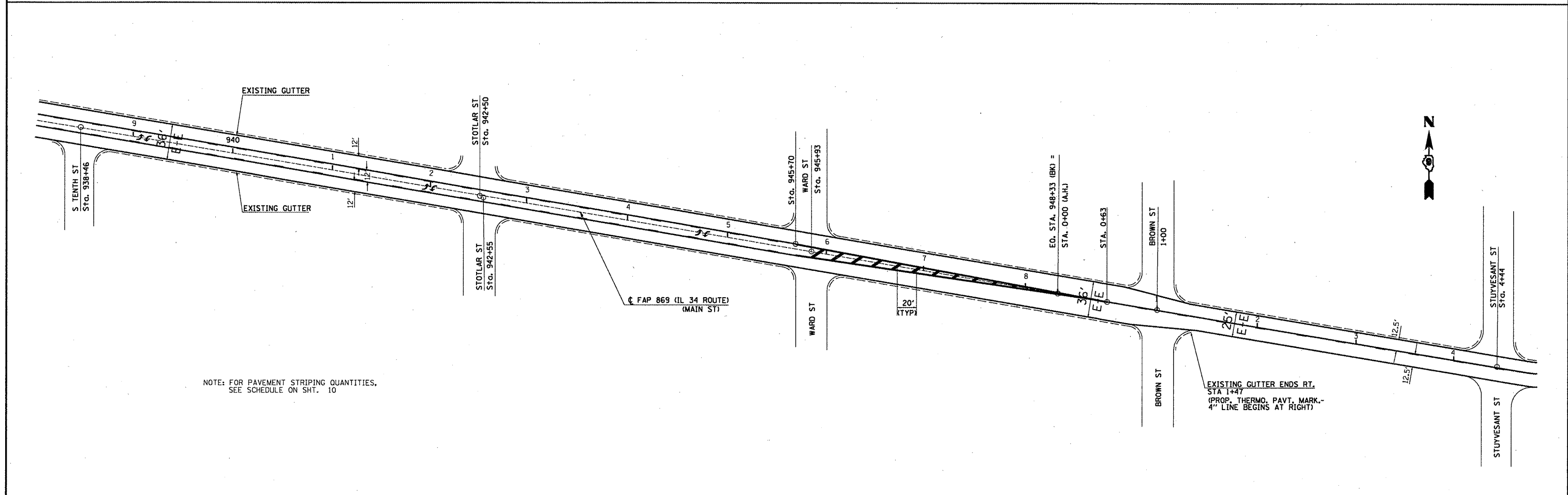

NOTE: FOR PAVEMENT STRIPING QUANTITIES,
SEE SCHEDULE ON SHT. 10

FILE NAME =	USER NAME = aybar.js	DESIGNED -	REVISD -	STATE OF ILLINOIS DEPARTMENT OF TRANSPORTATION	PLAN LAYOUT		F.A.P. RTE. 863	SECTION 10IRS-5	COUNTY FRANKLIN	TOTAL SHEETS 16	SHEET NO. 12
ca:\pwwork\pwwork\aybar.js\d0255677\shd1.dgn		DRAWN -	REVISD -		SCALE: -----	SHEET NO. -- OF -- SHEETS	STA. 923+28 TO STA. 4+44	CONTRACT NO. 78247		ILLINOIS FED. AID PROJECT	
PLOT SCALE = 180.2693' / IN.		CHECKED -	REVISD -								
PLOT DATE = 4/26/2011		DATE -	REVISD -								