

- ① STA. 18+69.5  
 PIPE CULVERT, PRECOATED GALVANIZED CORRUGATED STEEL, TYPE 1, 18"x6" W/ END SECTION, 1-EACH (STD. 542401) U.S.F.L. 594.68, STA. 18+70.3, 22.4' LT. D.S.F.L. 594.63, STA. 18+70.5, 28.4' LT.
- ② STA. 18+69.5  
 PIPE CULVERT, PRECOATED GALVANIZED CORRUGATED STEEL, TYPE 1, 18"x8" W/ END SECTION, 1-EACH (STD. 542401) U.S.F.L. 595.00, STA. 18+68.2, 23.8' RT. D.S.F.L. 594.94, STA. 18+69.7, 15.8' RT.

PLAN	DATE
BY	
DATE	
BY	
DATE	
BY	
DATE	
BY	
DATE	

PROFILE	DATE
BY	
DATE	
BY	
DATE	
BY	
DATE	
BY	
DATE	

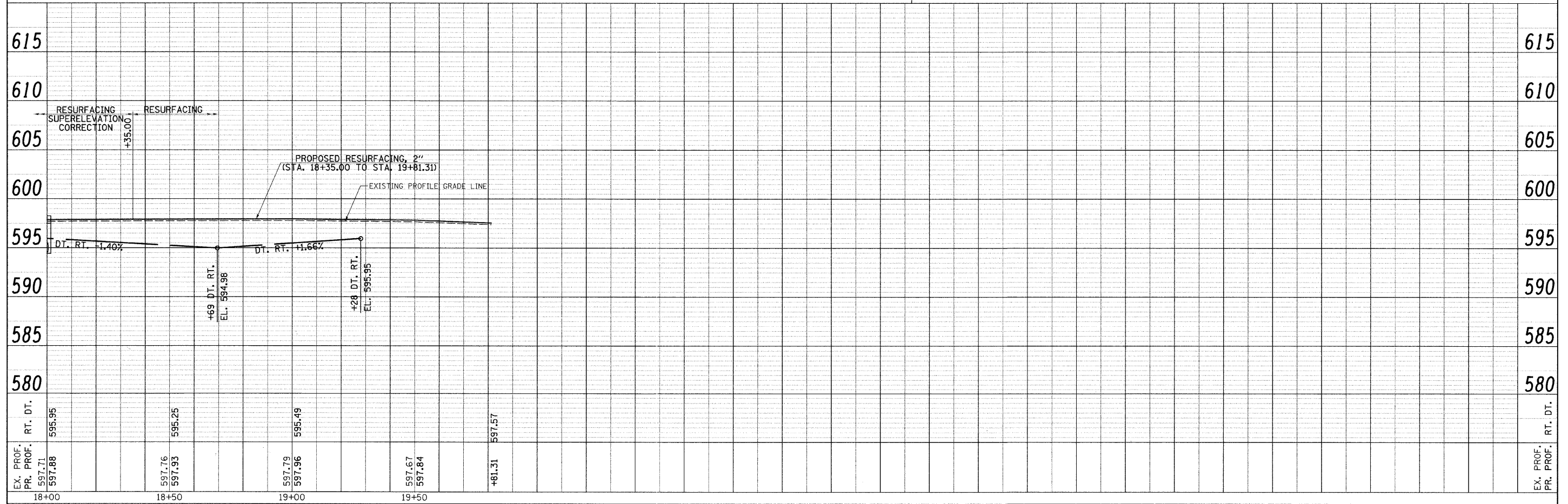

FILE NAME = V:\2545\2545p010.dgn	USER NAME = bdeoraene	DESIGNED -	REVISED -	<b>STATE OF ILLINOIS</b> <b>DEPARTMENT OF TRANSPORTATION</b>	<b>RIVER RD., PLAN &amp; PROFILE</b> SCALE: H=20 V=5 SHEET NO. 3 OF 3 SHEETS STA. 18+00 TO STA. 19+81.31	F.A. RTE.	SECTION	COUNTY	TOTAL SHEETS	SHEET NO.	
		DRAWN -	REVISED -			TR 55	90-16103-01-BR	WILL	255	36	
		CHECKED -	REVISED -			CONTRACT NO. 83126					
		DATE -	REVISED -			ILLINOIS FED. AID PROJECT					