

**T.R. 55 (RENNICK RD.)**

**STAGE 1A**

STA. 127+00 TO STA. 135+36

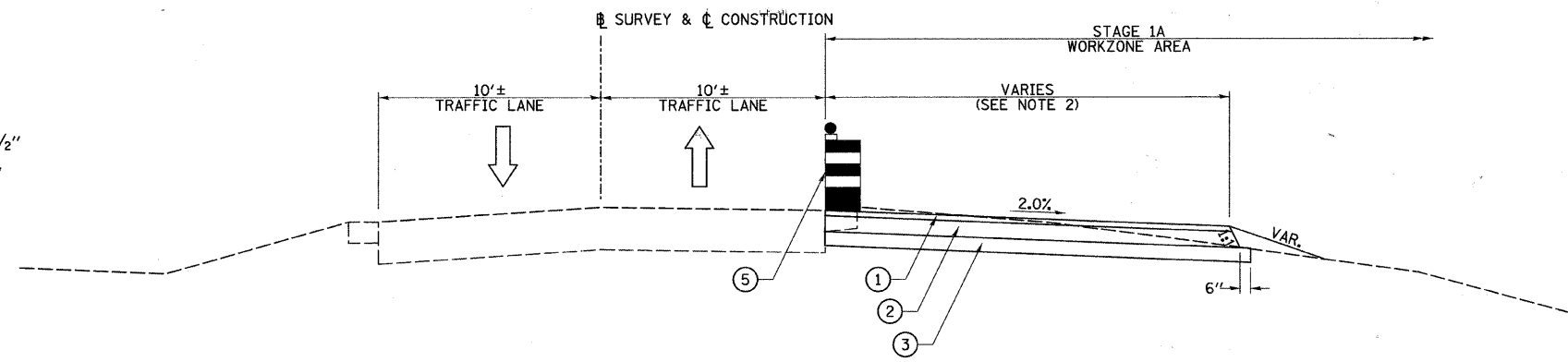

**RIVER RD.**

**STAGE 1A**

STA. 8+40 TO STA. 13+25

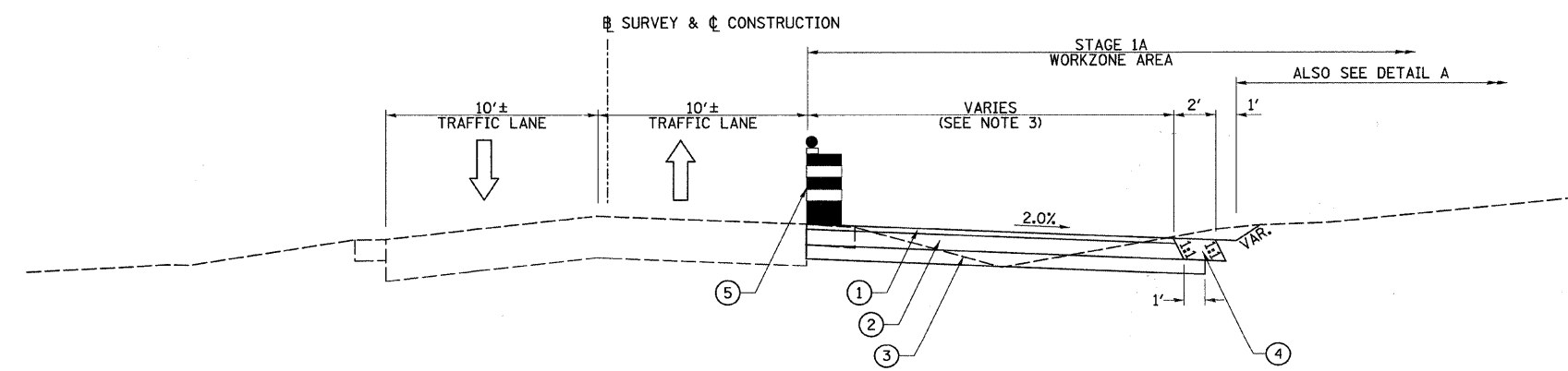

**RIVER RD.**

**STAGE 1A**

STA. 13+55 TO STA. 18+11

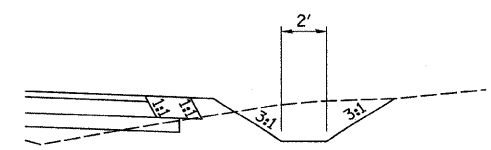

**DETAIL A**

STA. 15+00 TO STA. 18+00

- ① HOT-MIX ASPHALT SURFACE COURSE, MIX "D", N70, 1 1/2"
- ② HOT-MIX ASPHALT BINDER COURSE, IL-19.0, N70, 4 1/2"
- ③ SUB-BASE GRANULAR MATERIAL, TYPE B, 4"
- ④ AGGREGATE SHOULDER, TYPE B, 6"
- ⑤ TYPE II BARRICADE OR DRUM

**NOTES:**

- 1. VARIES FROM 14.8'± @ STA. 133+44 TO 0' @ STA. 135+36
- 2. VARIES FROM 0' @ STA. 8+40 TO 18.9'± @ STA. 10+00
- 3. VARIES FROM 17.1'± @ STA. 16+44 TO 0' @ STA. 18+11

FILE NAME = v:\2545\2545f\1A01.dgn	USER NAME = bdeoraene	DESIGNED -	REVISED -	<b>STATE OF ILLINOIS DEPARTMENT OF TRANSPORTATION</b>	<b>T.R. 55 (RENNICK RD.) &amp; RIVER RD. STAGE 1A TYPICAL SECTIONS</b>			F.A. RTE.	SECTION	COUNTY	TOTAL SHEETS	SHEET NO.
	PLOT SCALE = 4,000' / IN.	DRAWN -	REVISED -					TR 55	90-16103-01-BR	WILL	255	44
	PLOT DATE = 5/27/2011	CHECKED -	REVISED -					SCALE: 1"=4'			SHEET NO. 2 OF 5 SHEETS	
	DATE -	REVISED -					FED. ROAD DIST. NO.		ILLINOIS FED. AID PROJECT			