

WOOD CREEK FARM, L.P.

WOOD CREEK FARM, L.P.

EXISTING S.N. 084-3043

STA. 15+00 - THREE-SPAN CONTINUOUS R.C. SLAB BRIDGE ON PILE BENT PIERS AND ABUTMENTS. SPANS = 24'-6", 30'-0", 24'-6"; 79'-0" BK.-BK. ABUTS.; 24'-0" ROADWAY; 28'-4" O.-O. DECK; NO SKEW.

REMOVAL OF EXISTING STRUCTURES = 1 EACH

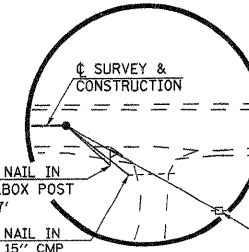
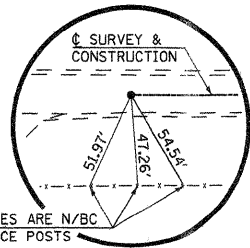

P.O.T. STA. 10+00
I. PIN (FLUSH)

SW. COR., SE. 1/4, SEC. 13,
T. 17 N., R. 4 W., 3RD P.M.
I. PIN (FOUND)

P.O.T. STA. 20+00
I. PIN (FLUSH)

CENTER OF SEC. 13,
T. 17 N., R. 4 W., 3RD P.M.
P.K. NAIL (FOUND)

PROPOSED S.N. 084-3443
STA. 14+97.00 - PRECAST PRESTRESSED
CONCRETE DECK BEAM BRIDGE, 3 SPANS
@ 30'-0", 91'-9" BK.-BK. ABUTMENTS,
30'-0" ROADWAY; SKEW = 0°

PIPE CULVERT TO
REMAIN IN PLACE

IMPROVEMENT ENDS
STA. 17+50.00

IMPROVEMENT BEGINS
STA. 12+00.00

EXISTING OIL & CHIP SURF.

PROP. H.M.A. SURF.

EXISTING R.O.W.

EXISTING R.O.W.

EXISTING R.O.W.

ENTRANCES TO BE BUILT

LT. STA. 15+85.50, P.E. -9.8%, 28' ROADBED
QUANTITIES INCLUDED IN THOSE LISTED

UTILITIES

- AMEREN CILCO - (NORTH) 309-693-4839
- KENT KOWALSKIE
- GREENE COUNTY CABLE TV 217-371-3605 EX. 21745
- LANCE ALLEN
- FRONTIER COMMUNICATIONS 309-454-1470
- MARY RUTH WILLIS

LARRY E. WISE &
POLLY A. WISE

BRUCE R. GILLMAN
AND CATHY J. GILLMAN

BRUCE R. GILLMAN
AND CATHY J. GILLMAN

CHANNEL EXCAVATION

THE CHANNEL SHALL BE EXCAVATED AS SHOWN WITHIN THE LIMITS OF THE PROPOSED STRUCTURE THEN TAPER TO THE EXISTING CHANNEL AT THE R.O.W. LINES. SUITABLE EXCAVATED MATERIAL TO BE USED IN THE EMBANKMENT AS DIRECTED BY THE ENGINEER.

CHANNEL EXCAVATION = 358 CU. YD.

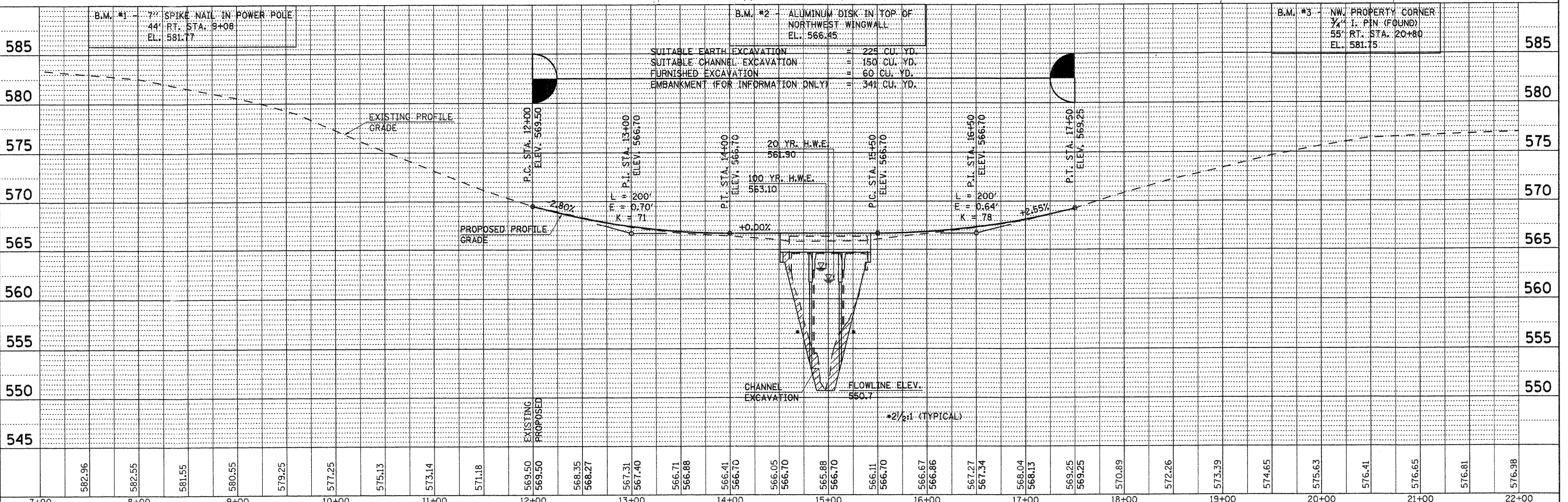

DATE	
BY	
DESIGNED	
DRAWN	
CHECKED	
DATE	

DATE	
BY	
DESIGNED	
DRAWN	
CHECKED	
DATE	

FILE NAME = 10-273-P&P.DGN	DESIGNED - G.J.C.	REVISED -	4440 ASH GROVE SPRINGFIELD, IL. 62711 (217) 793-8600 www.fehr-graham.com	FEHR-GRAHAM & ASSOCIATES, LLC ENGINEERING AND SCIENCE CONSULTANTS FREEPORT, IL ROCKFORD, IL ROCHELLE, IL MONROE, WI SPRINGFIELD, IL	PLAN & PROFILE - C.H. 48 OVER WOLF CREEK				C.H.	SECTION	COUNTY	TOTAL SHEETS	SHEET NO.
PLOTTED BY = S.A.P.	DRAWN - S.A.P.	REVISED -			48	08-00095-00-BR	SANGAMON	18	3				
CHECKED BY = G.J.C.	CHECKED - G.J.C.	REVISED -			SHEET NO. OF SHEETS STA. 10+00.00 TO STA. 20+00.00				ILLINOIS	CONTRACT NO. 93503			
DATE = 06/11/18	DATE - 04/19/11	REVISED -											