

DRAINAGE STRUCTURES

- ① 15.45' LT., STA. 3+30 INLETS, TY. A, TY. 15 F. & L. T.C. = 430.24 12" S.W. F.L. = 426.32
- ② 2.32' LT., STA. 3+00 MH, TY. A, 4" DIA., TY. 1 F., C.L. TOP OF IJD = 429.97 12" N.E. F.L. = 426.00 12" S.F.L. = 426.00 12" E.F.L. = 422.21 12" W.F.L. = 422.21
- ③ 25.04' RT., STA. 3+00 INLETS, TY. A, TY. 3 F. & G. T.C. = 429.87 12" N.F.L. = 426.27

STORM SEWERS

- ④ 25.04' RT., STA. 5+50 INLETS, TY. A, TY. 3 F. & G. T.C. = 430.14 12" E.F.L. = 426.94
- ⑤ 15.7' RT., STA. 6+26.5 EXIST. INLET 12" N.F.L. = 426.55 12" W.F.L. = 426.55 INLETS TO BE ADJUSTED WITH NEW TY. 1 F., C.L. - 1 EACH REMOVE EXIST. STEEL PLATE FROM TOP OF INLET

- ① ① TO ② S.S., CL. A, TY. 1 12" - 32 FT. ① 1.00% TRENCH BACK FILL 7.6 CU. YDS.
- ② ② TO ③ S.S., CL. A, TY. 1 12" - 27 FT. ① 1.00% TRENCH BACK FILL 4.9 CU. YDS.
- ③ ④ TO ⑤ S.S., CL. A, TY. 1 12" - 77 FT. ① 0.50% TRENCH BACK FILL 3.0 CU. YDS.

- ⑩ 22' LT., STA. 6+37 EXISTING GRATE INLET INLETS TO BE ADJUSTED - 1 EACH
- ⑪ STA. 6+37 THERMOPLASTIC PAVT. MARK. - LINE 24" - 12 FT. WHITE STOP BAR
- ⑫ STA. 6+35 TO STA. 6+47 THERMOPLASTIC PAVT. MARK. - LINE 24" - 18 FT. WHITE STOP BAR

- ⑬ 27' RT., STA. 6+58 VALVE BOXES TO BE ADJUSTED - 1 EACH
- ⑭ 29' RT., STA. 3+15 AND 29' RT., STA. 4+75 SIGN PANEL TY. 2, 42"x36" - 10.5 SQ. FT. EACH SIGN, TOTAL = 21 SQ. FT. TEL. STEEL SIGN SUP. - 16 FT. EACH SIGN, TOTAL = 32 FT.
- ⑮ 29' RT., STA. 3+65 AND 29' RT., STA. 5+25 SIGN PANEL TY. 1, 36"x36" - 9 SQ. FT. EACH SIGN, TOTAL = 18 SQ. FT. TEL. STEEL SIGN SUP. - 15.5 FT. EACH SIGN, TOTAL = 31 FT.

- ⑯ 25.04' RT., STA. 3+00 AND 25.04' RT., STA. 5+50 INLET AND PIPE PROTECTION - 1 EACH, TOTAL = 2 EACH
- ⑰ 17' RT., STA. 2+80 EXIST. "STOP" SIGN AND "STOP AT ROADWAY" SIGN ON A 4"x6" TREATED POST. REMOVE SIGNS AND POST. RELOCATE SIGNS TO ⑱ RELOCATE SIGN PANEL - TYPE 1 - 2.25 SQ. FT. EACH SIGN, TOTAL = 4.5 SQ. FT. COST OF REMOVAL OF THE POST IS INCLUDED IN THE COST OF RELOCATING THE SIGN PANELS.

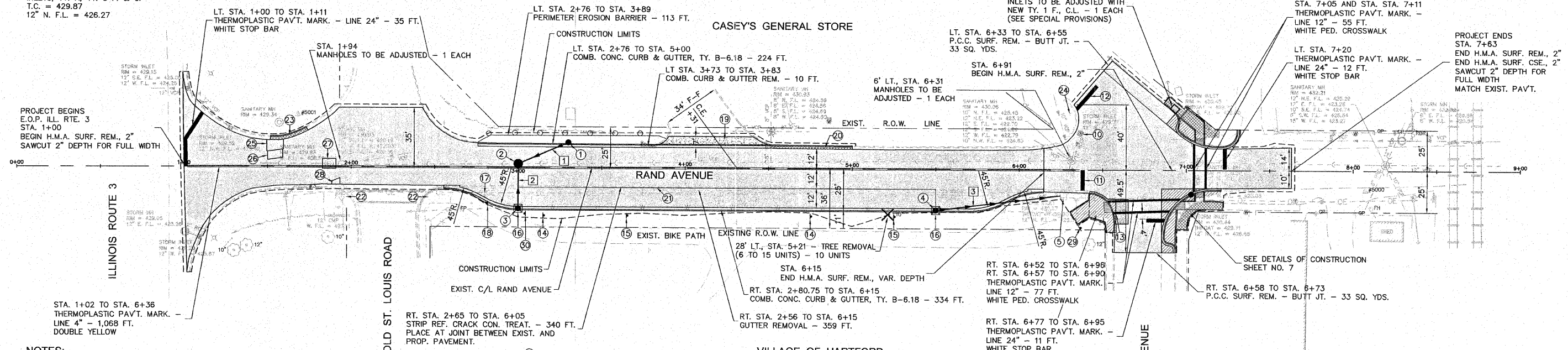

NOTES:

- 1. FOR TRANSITION OF RESURFACING EXIST. P.C.C. PAVT. STA. 6+15 TO STA. 6+91, SEE SHEET 6.
- 2. FOR LIMITS OF COMB. CONC. CURB & GUTTER, TY. B-6.18 (SPECIAL) AND TRANSITION SEE SHEET 6.
- 3. END H.M.A. SURF. REM., 2" AT STA. 2+50± AND BEGIN H.M.A. SURF. REM., VAR. DEPTH.
- 4. FOR PATCHES AT THE INTERSECTION OF RAND AVE. AND DELMAR AVE. SEE SHEET NO. 6.

- ⑱ 22' RT., STA. 2+81 TEL. STEEL SIGN SUP. - 15.5 FT. ATTACH RELOCATED SIGNS FROM ⑰
- ⑲ LT. STA. 3+83 TO STA. 4+52 DRIVE. PAVT. REM. - 47 SQ. YDS. P.C.C. DRIVE. PAVT., 8 INCH - 31 SQ. YDS.
- ⑳ LT. STA. 4+48 TO STA. 5+00 COMB. CURB & GUTTER REM. - 52 FT.
- ㉑ 12' RT. STA. 3+00 TO STA. 5+50 THERMOPLASTIC PAVT. MARK. - LINE 4" - 274 FT. WHITE LINE/PARKING LANE. QUANTITY INCLUDES PERPENDICULAR LINES FROM THE EDGE OF THE THRU LANE TO THE GUTTER FLAG - RT. STA. 3+00 AND STA. 5+50.
- ㉒ EXIST. DETECTABLE WARNINGS TO BE REPLACED UNDER THE CONTRACT FOR THE OLD ALTON-ST. LOUIS ROAD PROJECT, SECTION 09-00029-00-PV
- ㉓ LT. STA. 1+83 TO STA. 1+91 COMB. CURB & GUTTER REM. - 22 FT. TY. B-6.18 - 22 FT.
- ㉔ 34' LT., STA. 6+30 REMOVE EXIST. WOOD POST REMOVE EXIST. "STOP", "ALL" AND "NO RIGHT TURN" SYMBOL SIGN TEL. STEEL SIGN SUP. - 17.75 FT. SIGN PANEL TY. 1, 24"x24", "NO RIGHT TURN" SYMBOL, R3-1 - 4 SQ. FT. COST TO REMOVE POST AND SIGNS AND REATTACH EXIST. SIGNS TO POST SHALL BE INCLUDED IN THE COST OF THE TEL. STEEL SIGN SUP.
- ㉕ CL. C PATCH, TY. II, 10", 7.2 SQ. YDS.
- ㉖ CL. C PATCH, TY. II, 10", 5 SQ. YDS.
- ㉗ CL. C PATCH, TY. II, 10", 5 SQ. YDS.
- ㉘ CL. C PATCH, TY. I, 10", 1.7 SQ. YDS.
- ㉙ 35' RT., STA. 6+37 SIGN PANEL TY. 1, "BIKERS DISMOUNT AND WALK ACROSS INTERSECTION", BLACK LTRS ON YELLOW, 18"x18" - 2.25 SQ. FT. SIGN PANEL TY. 1, D-11, "BIKE ROUTE", 24"x18" - 3 SQ. FT. SIGN PANEL TY. 1, M4-6, "END", 12"x6" - 0.5 SQ. FT. TEL. STEEL SIGN SUP. - 14.5 FT.
- ㉚ 28' RT., STA. 3+04 SIGN PANEL TY. 1, "BIKERS DISMOUNT AND WALK ACROSS INTERSECTION", BLACK LTRS ON YELLOW, 18"x18" - 2.25 SQ. FT. SIGN PANEL TY. 1, D-11, "BIKE ROUTE", 24"x18" - 3 SQ. FT. SIGN PANEL TY. 1, M4-6, "END", 12"x6" - 0.5 SQ. FT. TEL. STEEL SIGN SUP. - 14.5 FT.

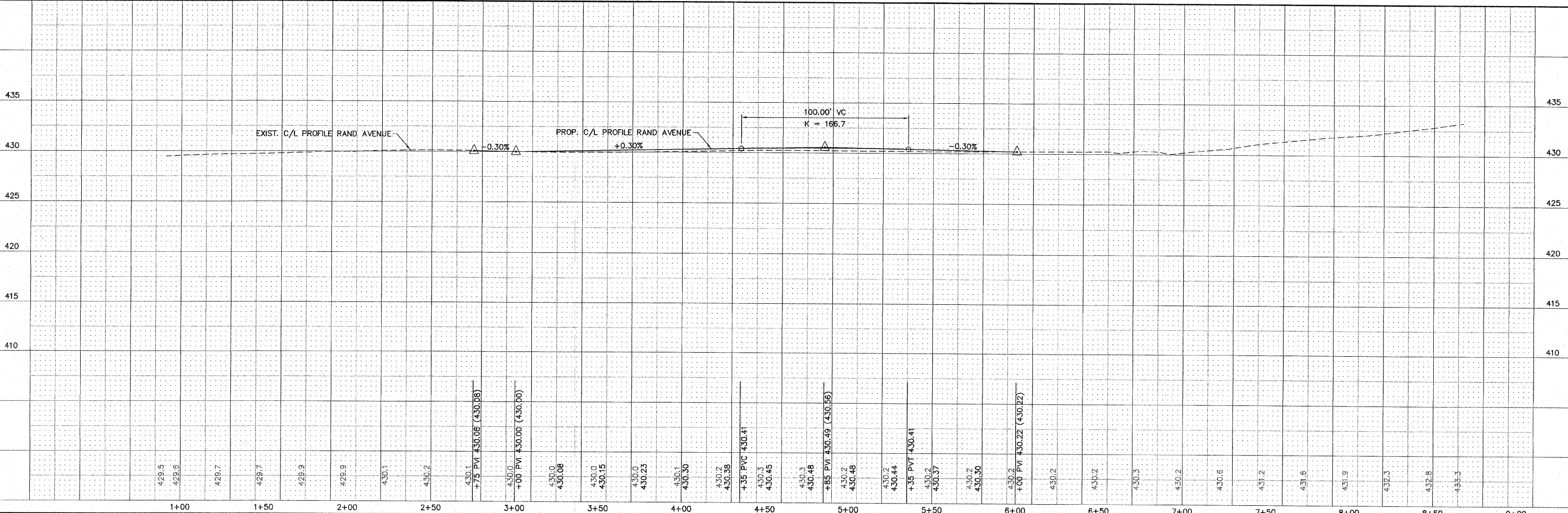

REVISIONS

SMS ENGINEERS
 Sheppard, Morgan & Schwaab, Inc.
 CONSULTING ENGINEERS AND LAND SURVEYORS
 210 Market Street, P.O. Box E, Alton, IL 62002, 618462-9755, E-mail: mail@smsengineers.com
 10 Cameron Industrial Drive, Suite 3, Granite City, IL 62040, 618977-5100, E-mail: mail@smsengineers.com
 DESIGN FIRM # 184-000992

VILLAGE OF HARTFORD
 F.A.U. 8974 (RAND AVENUE)
 SECTION 10-00030-00-WR
 PLAN / PROFILE

DWG. NO. 10A/HARTFORD (447888.0)
 RAND AVE P-P DWG
 REF. BK. 1500 PG. 21-22
 JOB NO. 447888
 DSN. BY: LDA
 DWN. BY: CAD
 CHK. BY: LDA
 DATE: JUNE, 2011
 SCALE: 1" = 30' H.
 1" = 5' V.
 SHEET 5 OF 9