

COMBINATION CONCRETE CURB AND GUTTER, TY. B-6.18 (SPECIAL) DETAIL

SCALE: 1" = 10'

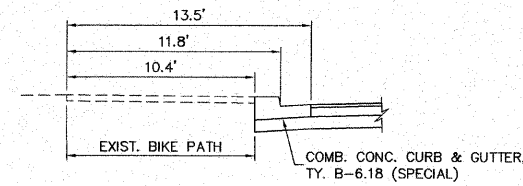

SECTION A-A

SCALE: 1" = 5'

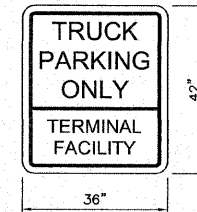

TO BE USED:  
29' RT. STA. 3+15  
29' RT. STA. 4+75

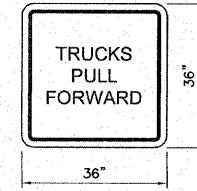

TO BE USED:  
29' RT. STA. 3+65  
29' RT. STA. 5+25

SIGN DETAIL

NOT TO SCALE

NOTE: ALL SIGNS SHALL BE BLACK LETTER ON A WHITE BACKGROUND WITH A BLACK BORDER

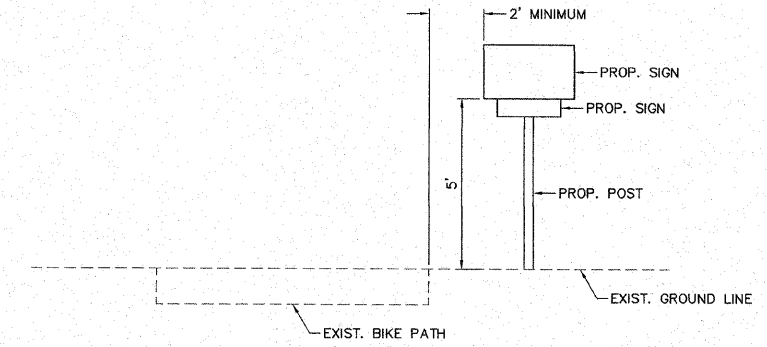

BIKE PATH SIGN PLACEMENT DETAIL

NOT TO SCALE

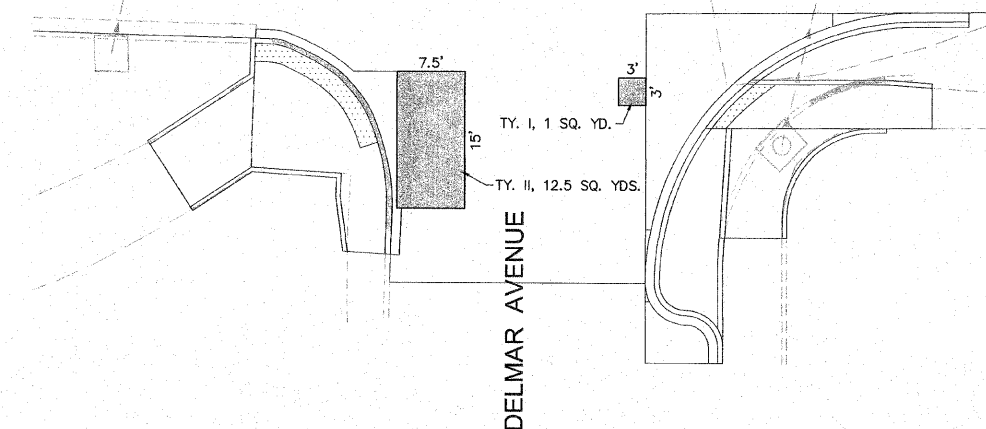
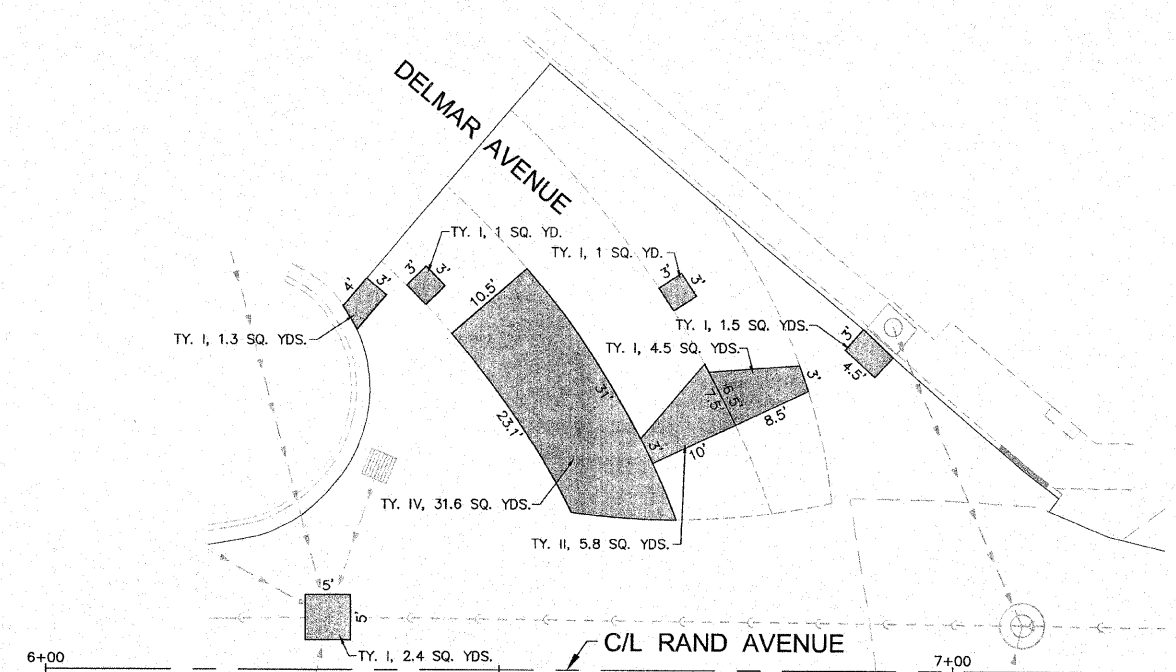

NOTE: ALL PATCHES AT THE INTERSECTION SHALL BE CLASS C PATCHES, 8 INCH, OF THE TYPE (TY.) AND AREA SHOWN.

INTERSECTION / PATCHING DETAIL

SCALE: 1" = 10'

REVISIONS

**SMS** Sheppard, Morgan & Schwaab, Inc.  
CONSULTING ENGINEERS AND LAND SURVEYORS  
315 Market Street, P.O. Box E, Alton, IL 62002, 618/462-9755 E-mail: msl@smsengr.com  
410 Central Business Drive, Suite 3, Granite City, IL 62040 618/977-0100 E-mail: msl@smsengr.com  
DESIGN FIRM # 184-000992

VILLAGE OF HARTFORD  
F.A.U. 8974 (RAND AVENUE)  
SECTION 10-00030-00-WR  
DETAILS OF CONSTRUCTION

DWG. NO.	LP\HARTFORD (447888.0)\DETAILS.DWG
REF. BK.	1500 PG. 21-22
JOB NO.	447888
DSN. BY:	LDA
DWN. BY:	CAD
CHK. BY:	LDA
DATE:	JUNE, 2011
SCALE:	AS SHOWN
SHEET	6 OF 9