

STATE OF ILLINOIS
DEPARTMENT OF TRANSPORTATION
DIVISION OF HIGHWAYS
PROPOSED
HIGHWAY PLANS

F.A. RTE.	SECTION	COUNTY	TOTAL SHEETS	SHEET NO.
NA	D4 PARKING LOT RESURF 2022-1	PEORIA	9	1
		ILLINOIS	CONTRACT NO. 68H09	

INDEX OF SHEETS

1. COVER SHEET
2. LINE DIAGRAM, MIX REQUIREMENT & JOB SPECIFIC NOTES
- 3-4. SUMMARY OF QUANTITIES
5. SCHEDULE OF QUANTITIES
6. TYPICAL SECTIONS
7. REMOVAL PLAN
8. PROPOSED PLAN
9. PROPOSED PAVEMENT MARKING PLAN

HIGHWAY STANDARDS

- 424016-05
- 606001-08
- 701901-08
- 780001-05

SECTION D4 PARKING LOT RESURF 2022-1
PEORIA WEST MAINTENANCE YARD
CAPITAL IMPROVEMENT
PEORIA COUNTY
C-94-043-22

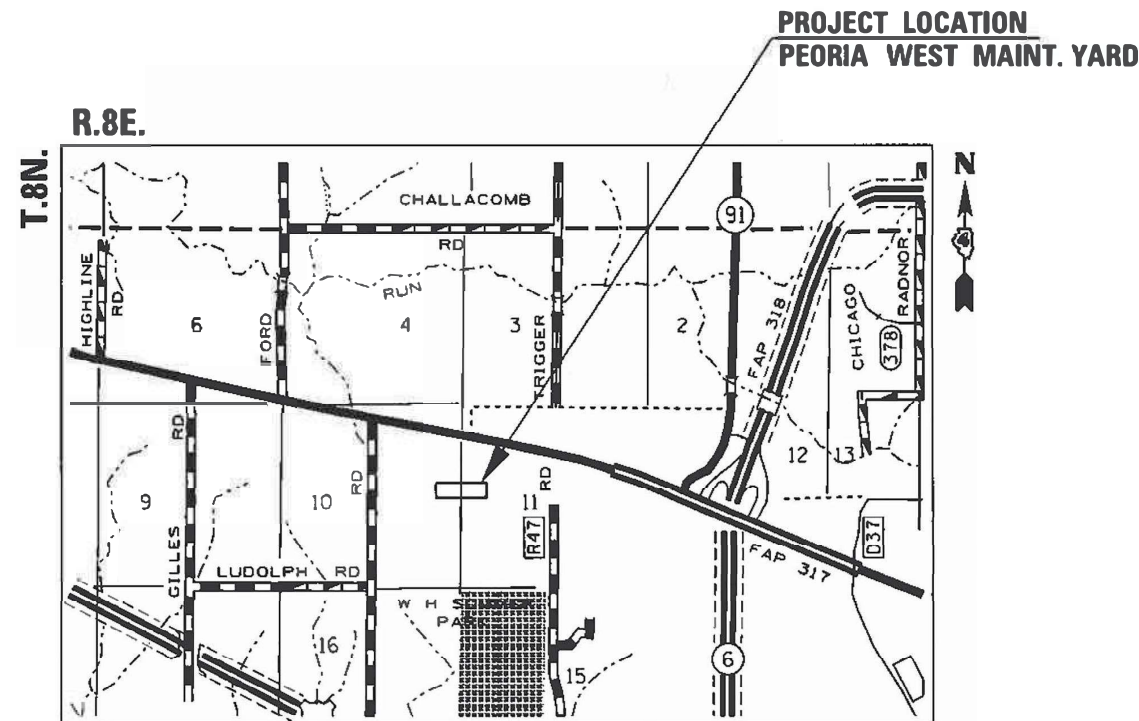

DESCRIPTION

THIS PROJECT CONSISTS OF MILLING AND RESURFACING THE PARKING AREA AND INSTALLING PARKING STRIPING AT THE PEORIA WEST STORAGE YARD, 2.5 MILES WEST OF PEORIA ON US 150.

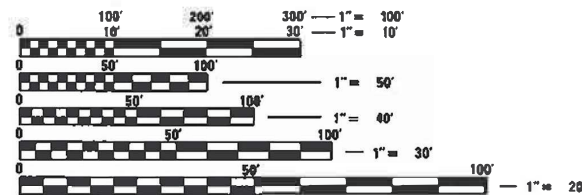

FULL SIZE PLANS HAVE BEEN PREPARED USING STANDARD ENGINEERING SCALES. REDUCED SIZED PLANS WILL NOT CONFORM TO STANDARD SCALES. IN MAKING MEASUREMENTS ON REDUCED PLANS THE ABOVE SCALES MAY BE USED.

J.U.L.I.E.
 JOINT UTILITY LOCATION INFORMATION FOR EXCAVATION
 1-800-892-0123
 OR 811

GROSS LENGTH = 133 FEET
 NET LENGTH = 0.025 MILE

PROJECT ENGINEER: RICHARD DOTSON 309-671-3455
 PROJECT MANAGER: ANNA DEVINE 309-671-3475

CATALOG NO. 036319-00D
 CONTRACT NO. 68H09

STATE OF ILLINOIS
 DEPARTMENT OF TRANSPORTATION

SUBMITTED May 19 20 22
Kenneth A. Garnett RSD
 REGION THREE ENGINEER

July 1, 2022 [Signature]
 ENGINEER OF DESIGN AND ENVIRONMENT

July 1, 2022 [Signature]
 DIRECTOR OF HIGHWAYS PROJECT IMPLEMENTATION

PRINTED BY THE AUTHORITY
OF THE STATE OF ILLINOIS

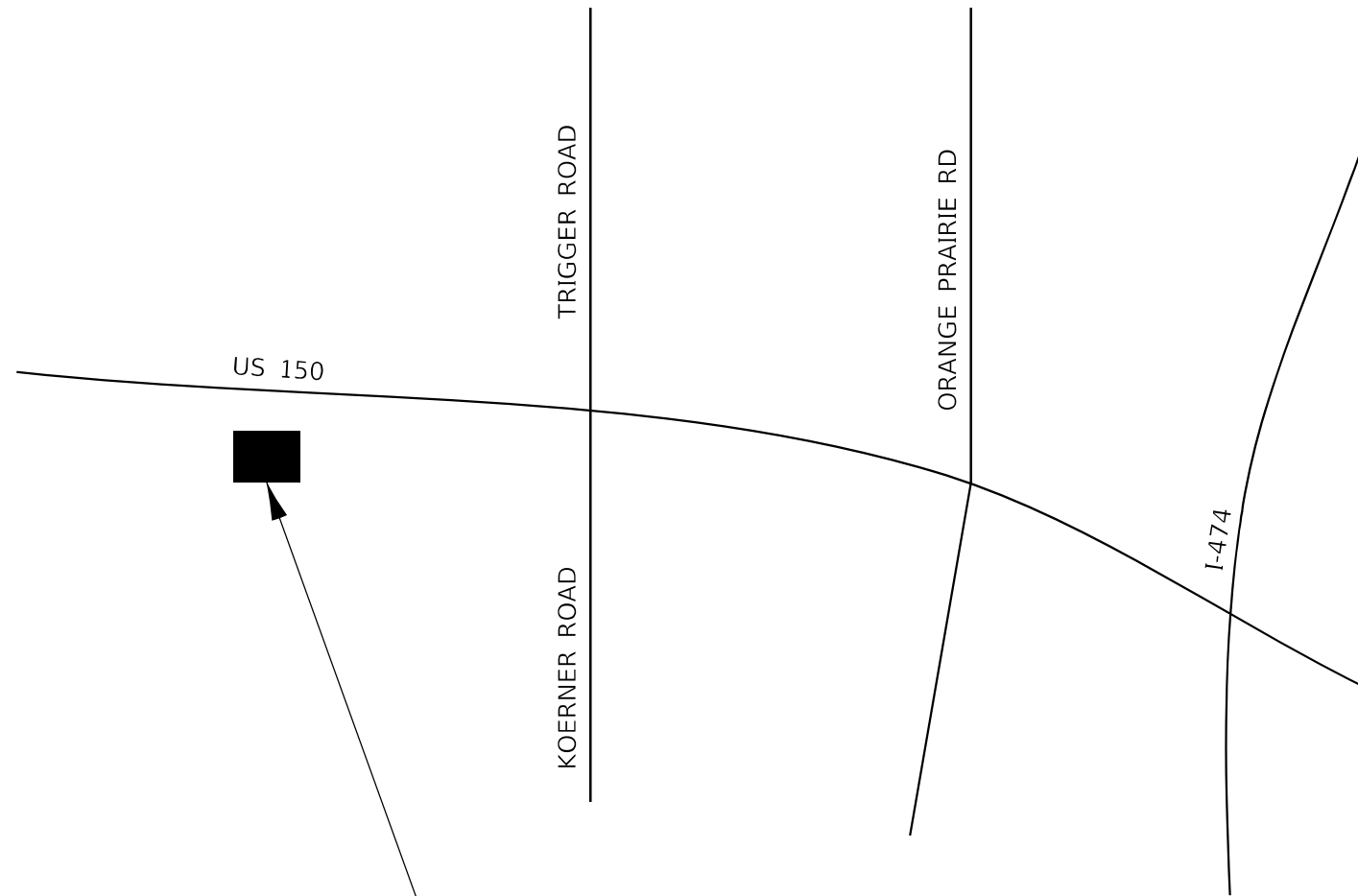

PROJECT LOCATION
 IDOT PEORIA WEST MAINTENANCE YARD
 6500 W. HIGHWAY 150
 EDWARDS, IL

JOB SPECIFIC NOTES:

1. THE CONTRACTOR SHALL NOTIFY JESSE STALEY, OPERATIONS SUPERVISOR AT THE PEORIA WEST MAINTENANCE FACILITY (309-691-7812), 7 DAYS PRIOR TO WORK BEGINNING.
2. SURVEY WAS NOT OBTAINED FOR THIS CONTRACT. FINAL HMA SURFACE SHALL BE PLACED PRIOR TO ANY CONCRETE WORK. FINAL HMA SURFACE WILL BE CONTROL FOR PCC ITEMS. POSITIVE DRAINAGE SHALL BE MAINTAINED THROUGH ALL STAGES.

The following mixture requirements are applicable for this project:			
Location(s):	Parking Surface		
Mixture Use(s):	Surface Lift		
AC/PG:	PG 58-28		
Design Air Voids:	4.0% @ N=50		
Mixture Composition: (Mixture Gradation)	IL 9.5		
Friction Aggregate:	Mix C		
Quality Management Program:	QCQA		
MTD:	No		

Note:

- 1) Individual lift thickness of each mix type will be no less than 3 times nominal maximum aggregate size and no more than 6 times nominal
- 2) For design purposes, mixture weight for all mixes is determined to be 112.0 lb/s.y./in., unless otherwise noted.
- 3) Sublot sizes for PFP and QCP mixes will be 600 tons, unless otherwise agreed to by the Engineer and the paving contractor.

MODEL: Default
 FILE NAME: p:\project\68H09\CADD\Drawings\DOT\Drawings\Drawings\68H09-ht-cover.dgn

USER NAME = \$USERS	DESIGNED -	REVISED -
	DRAWN -	REVISED -
PLOT SCALE = 1:100	CHECKED -	REVISED -
PLOT DATE = 5/20/2022	DATE -	REVISED -

**STATE OF ILLINOIS
 DEPARTMENT OF TRANSPORTATION**

**LINE DIAGRAM, MIX REQUIREMENT
 JOB SPECIFIC NOTES**

SCALE: SHEET 1 OF 1 SHEETS STA. TO STA.

F.A. RTE.	SECTION	COUNTY	TOTAL SHEETS	SHEET NO.
NA	D4 PARKING LOT RESURF	PEORIA	9	2
			CONTRACT NO. 68H09	
		ILLINOIS	FED. AID PROJECT	

CONSTR. CODE
0005
PARKING LOT
PEORIA
100% STATE
RURAL

CODE NO.	ITEM	UNIT	TOTAL QUANTITY	
20200100	EARTH EXCAVATION	CU YD	69	69
31101000	SUBBASE GRANULAR MATERIAL, TYPE B	TON	19	19
40600275	BITUMINOUS MATERIALS (PRIME COAT)	POUND	554	554
40600290	BITUMINOUS MATERIALS (TACK COAT)	POUND	2289	2289
40604050	HOT-MIX ASPHALT SURFACE COURSE, 1L-9.5, MIX "C", N50	TON	329	329
* 42400800	DETECTABLE WARNINGS	SQ FT	10	10
44000300	CURB REMOVAL	FOOT	41	41
60260100	INLETS TO BE ADJUSTED	EACH	1	1
60600605	CONCRETE CURB, TYPE B	FOOT	36	36
67100100	MOBILIZATION	L SUM	1	1
* 78001100	PAINT PAVEMENT MARKING - LETTERS AND SYMBOLS	SQ FT	45	45
* 78001110	PAINT PAVEMENT MARKING - LINE 4"	FOOT	1474	1474
X0301430	PRECAST CONCRETE PARKING BLOCK	EACH	13	13
X0800006	PREPARATION OF BASE (SPECIAL)	SQ YD	1467	1467

*= SPECIALTY ITEM

MODEL: Default
FILE: M:\GIS\p1111000\Documents\DOT_Offices\District_68\GIS\CADD\GIS\CADD\Sheet\68H09-shr-500.dgn

USER NAME = \$USERS	DESIGNED -	REVISED -	STATE OF ILLINOIS DEPARTMENT OF TRANSPORTATION	SUMMARY OF QUANTITIES				F.A. RTE.	SECTION	COUNTY	TOTAL SHEETS	SHEET NO.
PLOT SCALE = 1:100	DRAWN -	REVISED -						NA	D4 PARKING LOT RESURF	PEORIA	9	3
PLOT DATE = 5/20/2022	CHECKED -	REVISED -		SCALE:	SHEET 1	OF 2 SHEETS	STA.	TO STA.	CONTRACT NO. 68H09			
DATE -	REVISED -	REVISED -		ILLINOIS FED. AID PROJECT								

CONSTR. CODE
0005
PARKING LOT
PEORIA
100% STATE
RURAL

CODE NO.	ITEM	UNIT	TOTAL QUANTITY	
X1200251	CONCRETE APRON FOR INLET	EACH	1	1
X1800002	RIVER ROCK	TON	30	30
X4240420	PORTLAND CEMENT CONCRETE SIDEWALK 4 INCH, SPECIAL	SQ FT	106	106
X4401198	HOT-MIX ASPHALT SURFACE REMOVAL, VARIABLE DEPTH	SQ YD	192	192
X4404700	SIDEWALK REMOVAL (SPECIAL)	SQ FT	177	177

MODEL: Default
 FILE: M:\mhc\pww\dot\documents\DOT_offices\Dirctr. f\Project\104_68H09\CAD\Drawings\CADsheets\10468H09-sh-500.dwg

USER NAME = \$USERS	DESIGNED -	REVISED -
	DRAWN -	REVISED -
PLOT SCALE = 1:100	CHECKED -	REVISED -
PLOT DATE = 5/20/2022	DATE -	REVISED -

**STATE OF ILLINOIS
DEPARTMENT OF TRANSPORTATION**

SUMMARY OF QUANTITIES

SCALE: SHEET 2 OF 2 SHEETS STA. TO STA.

F.A. RTE.	SECTION	COUNTY	TOTAL SHEETS	SHEET NO.
NA	D4 PARKING LOT RESURF	PEORIA	9	4
			CONTRACT NO. 68H09	
ILLINOIS FED. AID PROJECT				

PARKING LOT MATERIALS TABLE								
LOCATION	AREA	HOT-MIX ASPHALT SURFACE REMOVAL, VARIABLE DEPTH	BITUMINOUS MATERIALS (TACK COAT)	BITUMINOUS MATERIALS (PRIME COAT)	HOT-MIX ASPHALT SURFACE COURSE, IL-9.5, MIX "C", N50	PREPARATION OF BASE (SPECIAL)	EARTH EXCAVATION	SUBBASE GRANULAR MATERIAL, TYPE B
		SQ YD	SQ YD	POUND	POUND	TON	SQ YD	CU YD
Parking Area 1	1466.7	192.0	2112.0		328.5	1466.7	1.3	
Parking Area 2	246.0		177.1	553.5			67.4	18.7
TOTALS		192	2289	554	329	1467	69	19

LOCATION	SIDEWALK REMOVAL (SPECIAL)	PORTLAND CEMENT CONCRETE SIDEWALK 4 INCH, SPECIAL	DETECTABLE WARNINGS	CURB REMOVAL	CONCRETE CURB, TYPE B	CONCRETE APRON FOR INLET	INLETS TO BE ADJUSTED	RIVER ROCK	PRECAST CONCRETE PARKING BLOCK
	SQ FT	SQ FT	SQ FT	FOOT	FOOT	EACH	EACH	TON	EACH
West Sidewalk	177	106	10	29	35.5			4	
Southeast Inlet				12		1	1		
Parking Area 2								26	13
TOTALS	177	106	10	41	36	1	1	30	13

PAINT PAVEMENT MARKING				
LOCATION	No.	4" LINE	LETTERS & SYMBOLS	
		YELLOW FOOT	WHITE SQ FT	YELLOW SQ FT
18' Parking Lines	31	558		
16' Parking Lines	11	176		
Access Aisle/Handicap Spots		105.7	6.2	
NW Hashed Area		37.4		
NC Hashed Area		47.2		
SW Hashed Area		104.5		
SC Hashed Area		162.2		
SE Hashed Area		199.5		
Parking Area 2 Hashed Area		83.1		
Arrows (Small)	6			39
TOTALS		1474		45

MOBILIZATION	
LOCATION	L SUM
Jobsite	1
TOTAL	1

MODEL: Default
 FILE: \\nafe-pw-bentley.com\PW\DOT\Documents\DOT_offices\Dir\drt_4\Project\ID_68H09\CADD\DATA\CAD\Sheet\68H09-nc-sched.xls.dgn

USER NAME = \$USERS	DESIGNED -	REVISED -
	DRAWN -	REVISED -
PLOT SCALE = 1:100	CHECKED -	REVISED -
PLOT DATE = 5/20/2022	DATE -	REVISED -

STATE OF ILLINOIS
DEPARTMENT OF TRANSPORTATION

SCHEDULE OF QUANTITIES			
SCALE:	SHEET 1	OF 1	SHEETS
		STA.	TO STA.

F.A. RTE.	SECTION	COUNTY	TOTAL SHEETS	SHEET NO.
NA	D4 PARKING LOT RESURF	PEORIA	9	5
			CONTRACT NO. 68H09	
			ILLINOIS FED. AID PROJECT	

OFFICE BUILDING

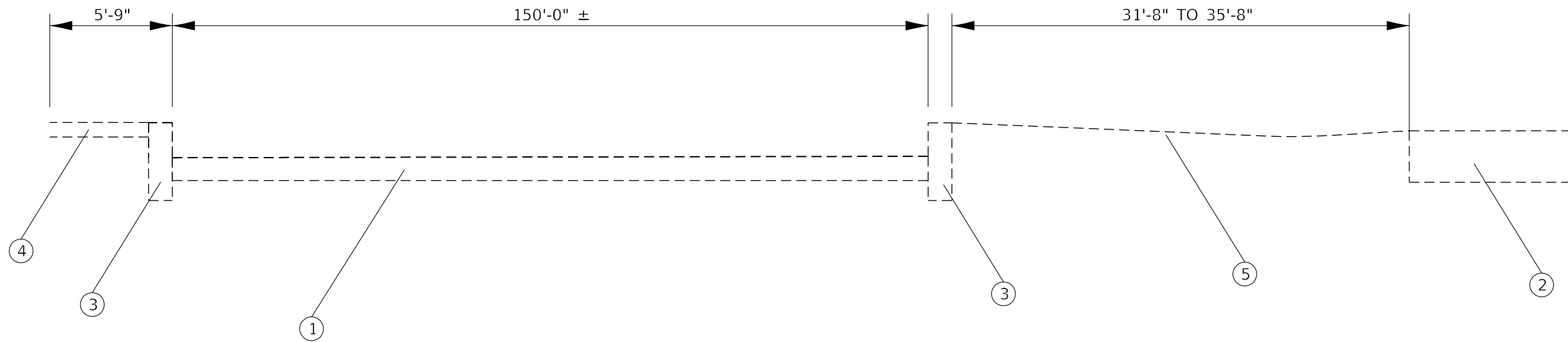



EXISTING TYPICAL

EXISTING ITEMS

- ① BITUMINOUS PAVEMENT
- ② CONCRETE PAVEMENT
- ③ CONCRETE CURB
- ④ CONCRETE SIDEWALK
- ⑤ TURF

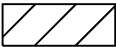
PROPOSED ITEMS

- ⑬ PREPARATION OF BASE, SPECIAL
- ⑭ EARTH EXCAVATION (8" MAX.) 
- ⑮ SUBBASE GRANULAR MATERIAL (4") 
- ⑯ HMA SURFACE COURSE, IL-9.5, MIX "C" N50 (4")
- ⑰ RIVER ROCK (8" ±)
- ⑱ CONCRETE CURB, TYPE B
- ⑳ PCC SIDEWALK 4", SPECIAL

OFFICE BUILDING

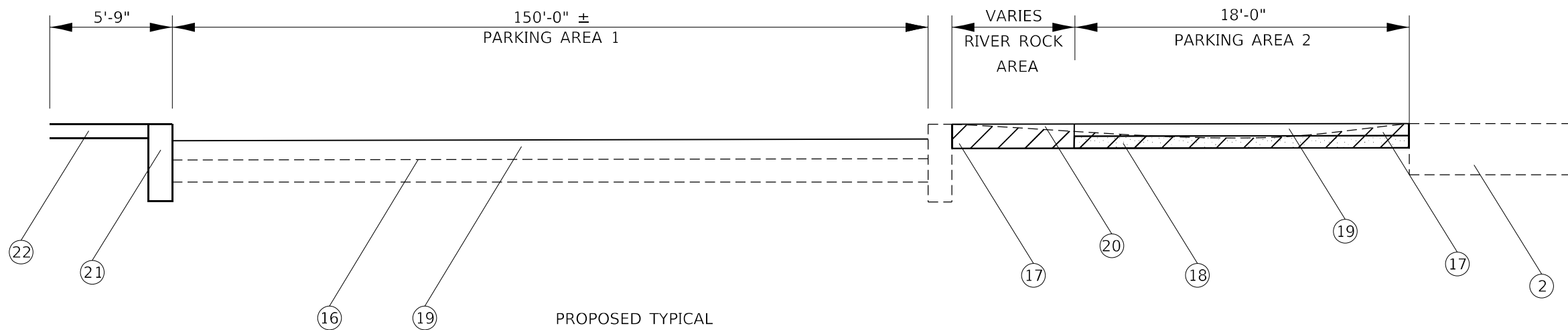

PROPOSED TYPICAL

MODEL: Default
 FILE NAME: \\s:\projects\68H09\CADD\Drawings\68H09-INT-CYCLICAL.dwg
 PROJECT: 68H09-INT-CYCLICAL
 USER: jrb
 DATE: 5/20/2022

USER NAME = \$USERS	DESIGNED -	REVISED -
	DRAWN -	REVISED -
PLOT SCALE = 1:40	CHECKED -	REVISED -
PLOT DATE = 5/20/2022	DATE -	REVISED -

STATE OF ILLINOIS
DEPARTMENT OF TRANSPORTATION

TYPICAL SECTIONS

SCALE: SHEET 1 OF 1 SHEETS STA. TO STA.

F.A. RTE.	SECTION	COUNTY	TOTAL SHEETS	SHEET NO.
NA	D4 PARKING LOT RESURF	PEORIA	9	6
CONTRACT NO. 68H09			ILLINOIS FED. AID PROJECT	

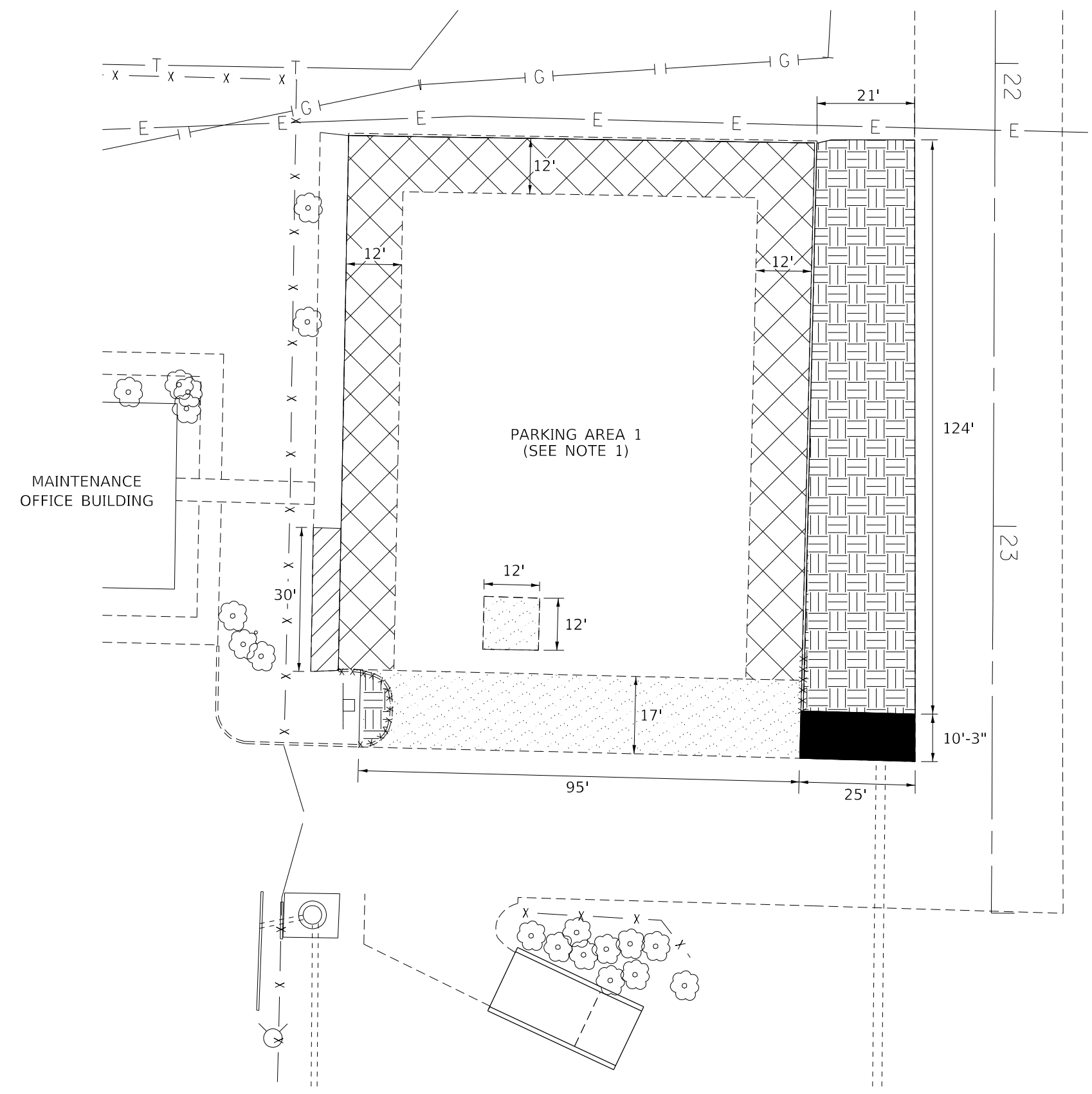

NOTES:

1. SEE SPECIAL PROVISION FOR PREPARATION OF BASE (SPECIAL)
2. SURFACE SHALL BE GRADED TO MAINTAIN UNIFORM SLOPE ALLOWING POSITIVE FLOW AND NOT IMPOUND WATER.

LEGEND:

- EARTH EXCAVATION
- HMA SURFACE REMOVAL, VARIABLE DEPTH (VARIES 0"- 4")
- GRADE AND COMPACT 3 SIDES OF PARKING LOT, PRIOR TO BASE PREPARATION. (WORK TO BE PERFORMED BY OTHERS)
- SIDEWALK REMOVAL (SPECIAL)- REMOVAL LIMITS SHALL END AT AN EXISTING SIDEWALK JOINT (SEE SPECIAL PROVISION)
- CURB REMOVAL
- REMOVAL OF EXISTING CONCRETE SHALL BE INCLUDED IN THE COST OF: CONCRETE APRON FOR INLET (SEE SPECIAL PROVISION)

MODEL: Default
 FILE NAME: p:\project\aw_bentley.com\p\illinois\documents\DOT_offices\Director_d\project\ID4_68H09\CADD\DATA\CAD\sheet\68H09-1r.tbl.dgn

USER NAME = \$USERS	DESIGNED -	REVISED -
	DRAWN -	REVISED -
PLOT SCALE = 1:40	CHECKED -	REVISED -
PLOT DATE = 5/20/2022	DATE -	REVISED -

**STATE OF ILLINOIS
DEPARTMENT OF TRANSPORTATION**

REMOVAL PLAN

SCALE: SHEET 1 OF 1 SHEETS STA. TO STA.

F.A. RTE.	SECTION	COUNTY	TOTAL SHEETS	SHEET NO.
NA	D4 PARKING LOT RESURF	PEORIA	9	7
CONTRACT NO. 68H09				
ILLINOIS FED. AID PROJECT				

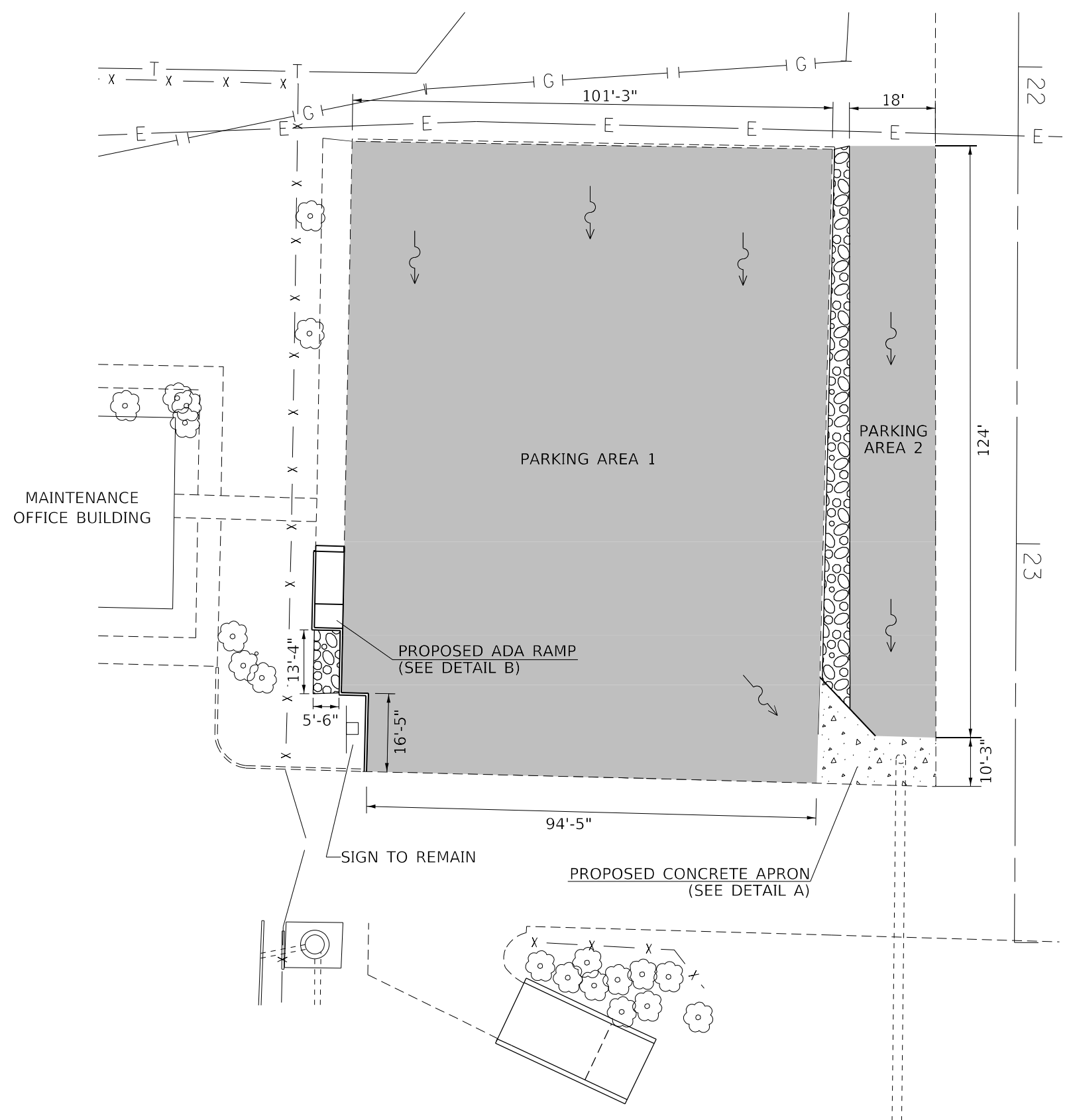

LEGEND:

- HMA SURFACE COURSE, IL-9.5, MIX "C", N50
- RIVER ROCK (DEPTH = 8")
- CONCRETE APRON FOR INLET = 1 EACH (APPROX. CONCRETE QUANTITY = 8.1 CU. YD.)

DETAIL A **OUTLET DETAIL**

NOTE:

THE PROPOSED APRON (8") SHALL BE CONSTRUCTED AFTER THE PARKING AREAS ARE COMPLETED. CONTROL WILL BE THE PROPOSED HMA AND EXISTING CONCRETE PAVEMENT EDGES. THE ENGINEER SHALL VERIFY POSITIVE FLOW IS MAINTAINED. CONSTRUCTION SHALL BE IN ACCORDANCE WITH D4 STANDARD 602001-D4, SECTION 602 OF THE STANDARD SPECIFICATION, AND THE SPECIAL PROVISION "CONCRETE APRON FOR INLET." THIS WORK SHALL BE PAID AS CONCRETE APRON FOR INLET.

DETAIL B **ADA RAMP DETAIL**

NOTES:

- CONSTRUCTION SHALL BE IN ACCORDANCE WITH HIGHWAY STANDARD 424016-05 AND SPECIAL PROVISION FOR PCC SIDEWALK 4", SPECIAL
- EXCAVATION OR AGGREGATE SUBBASE NECESSARY FOR THE PROPOSED SIDEWALK SHALL BE INCLUDED IN THE COST OF PCC SIDEWALK, 4" SPECIAL.

LEGEND:

- EXISTING SIDEWALK/CURB
- PROPOSED SIDEWALK
- PROPOSED SIDE CURB
- DETECTABLE WARNINGS

MODEL: Default
FILE: \\nafe-pw-bentley.com\P\W\DOT\Documents\DOT Office\District 4\Project\104_68H09\CADD\31-CAD\Sheets\31-68H09-1tr-plb1a.dgn

USER NAME = \$USERS	DESIGNED -	REVISED -
PLOT SCALE = 1:40	DRAWN -	REVISED -
PLOT DATE = 5/31/2022	CHECKED -	REVISED -
	DATE -	REVISED -

**STATE OF ILLINOIS
DEPARTMENT OF TRANSPORTATION**

PROPOSED PLAN

SCALE: SHEET 1 OF 1 SHEETS STA. TO STA.

F.A. RTE.	SECTION	COUNTY	TOTAL SHEETS	SHEET NO.
NA	D4 PARKING LOT RESURF	PEORIA	9	8
CONTRACT NO. 68H09				
ILLINOIS FED. AID PROJECT				

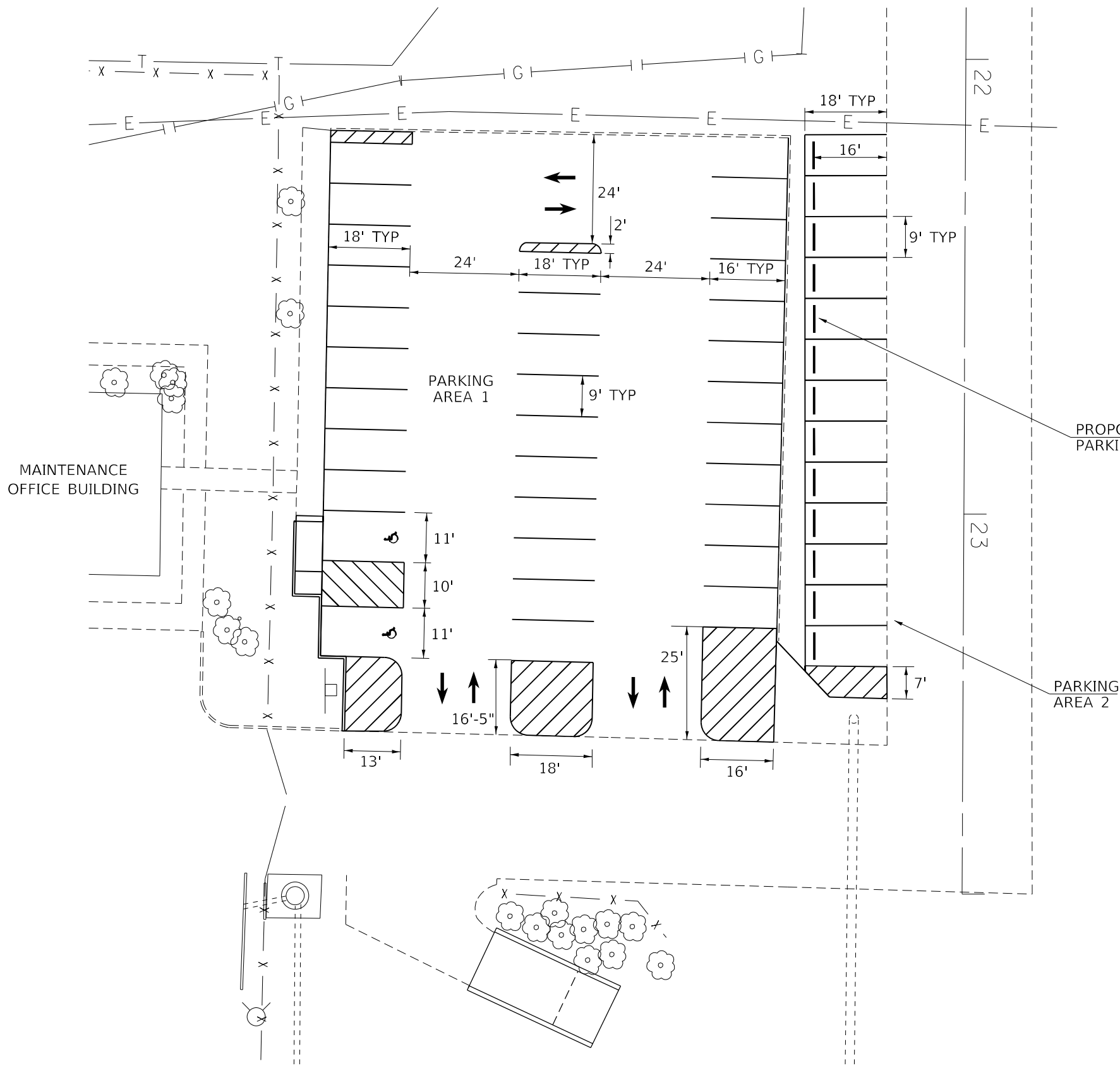

NOTES:

1. SEE SPECIAL PROVISION FOR PRECAST CONCRETE PARKING BLOCK
2. SEE SCHEDULE OF QUANTITIES FOR PAVEMENT MARKINGS

PROPOSED PRECAST CONCRETE PARKING BLOCK (TYP)

PARKING AREA 2

MODEL: Default
 FILE: \\na11c01.pw.bea.fwy.com\PW\DOT\Documents\DOT Offices\District 4\Project\ID4_68H09\CADD\Drawings\CAD\Sheets\68H09-11r-cabls.dgn

USER NAME = \$USERS	DESIGNED -	REVISED -
PLOT SCALE = 1:40	DRAWN -	REVISED -
PLOT DATE = 5/20/2022	CHECKED -	REVISED -
	DATE -	REVISED -

**STATE OF ILLINOIS
DEPARTMENT OF TRANSPORTATION**

PROPOSED PAVEMENT MARKING PLAN

SCALE: SHEET 1 OF 1 SHEETS STA. TO STA.

F.A. RTE.	SECTION	COUNTY	TOTAL SHEETS	SHEET NO.
NA	D4 PARKING LOT RESURF	PEORIA	9	9
			CONTRACT NO. 68H09	
		ILLINOIS	FED. AID PROJECT	