

08/05/2022 LETTING ITEM 041

STATE OF ILLINOIS
DEPARTMENT OF TRANSPORTATION
DIVISION OF HIGHWAYS
PLANS FOR PROPOSED
LOCAL AGENCY IMPROVEMENT-STR, REBUILD ILLINOIS,
AND STATE MATCH FUNDS
FEDERAL-AID SECONDARY PROJECT
SECTION 21-00128-00-FP RICHLAND COUNTY

ROUTE	SECTION	COUNTY	TOTAL SHEETS	SHEET NO.
F.A.S. 801	21-00128-00-FP	RICHLAND	11	1
CONTRACT 95925		ILLINOIS	PROJECT SDE2(930)	

INDEX OF SHEETS	
SHEET	ITEM
1	COVER SHEET
2	SUMMARY OF QUANTITIES AND GENERAL NOTES
3	EXISTING ROADWAY TYPICAL SECTIONS
4	PROPOSED ROADWAY TYPICAL SECTIONS
5	SCHEDULES OF PROPOSED QUANTITIES AND EXISTING STORM SEWERS
6-8	PLAN AND PROFILE
9	ENTRANCE DETAILS
10	MISCELLANEOUS DETAILS
11	TRAFFIC CONTROL PLAN

PROJECT SDE2(930)
JOB NO. C-97-070-22
F.A.S. 801

CONTRACT 95925

Joint Utility Locating Information for Excavators

JULIE 1-800-892-0123

PLAN 0 50' 100'
PROFILE HOR. 0 50' 100'
PROFILE VERT. 0 5' 10'

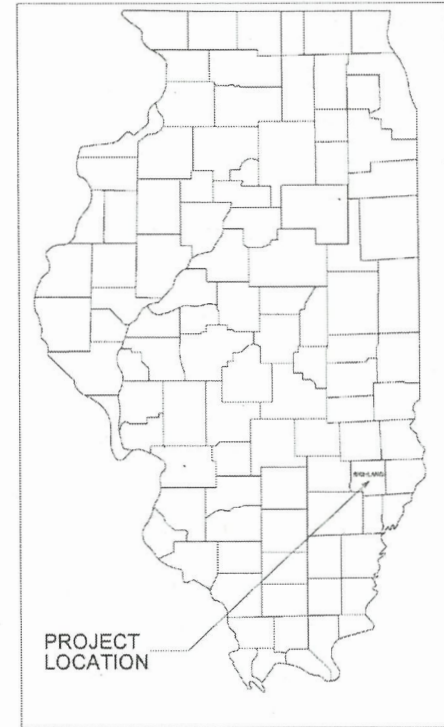

- STANDARD DRAWINGS
- STANDARD 000001-08
 - STANDARD 408201-01
 - STANDARD 701001-02
 - STANDARD 701006-05
 - STANDARD 701011-04
 - STANDARD 701201-05
 - STANDARD 701301-04
 - STANDARD 701306-04
 - STANDARD 701901-08
 - STANDARD BLR 21-9
 - STANDARD BLR 22-7

NOTE: SCALES VALID FOR 22" X 34" SHEETS

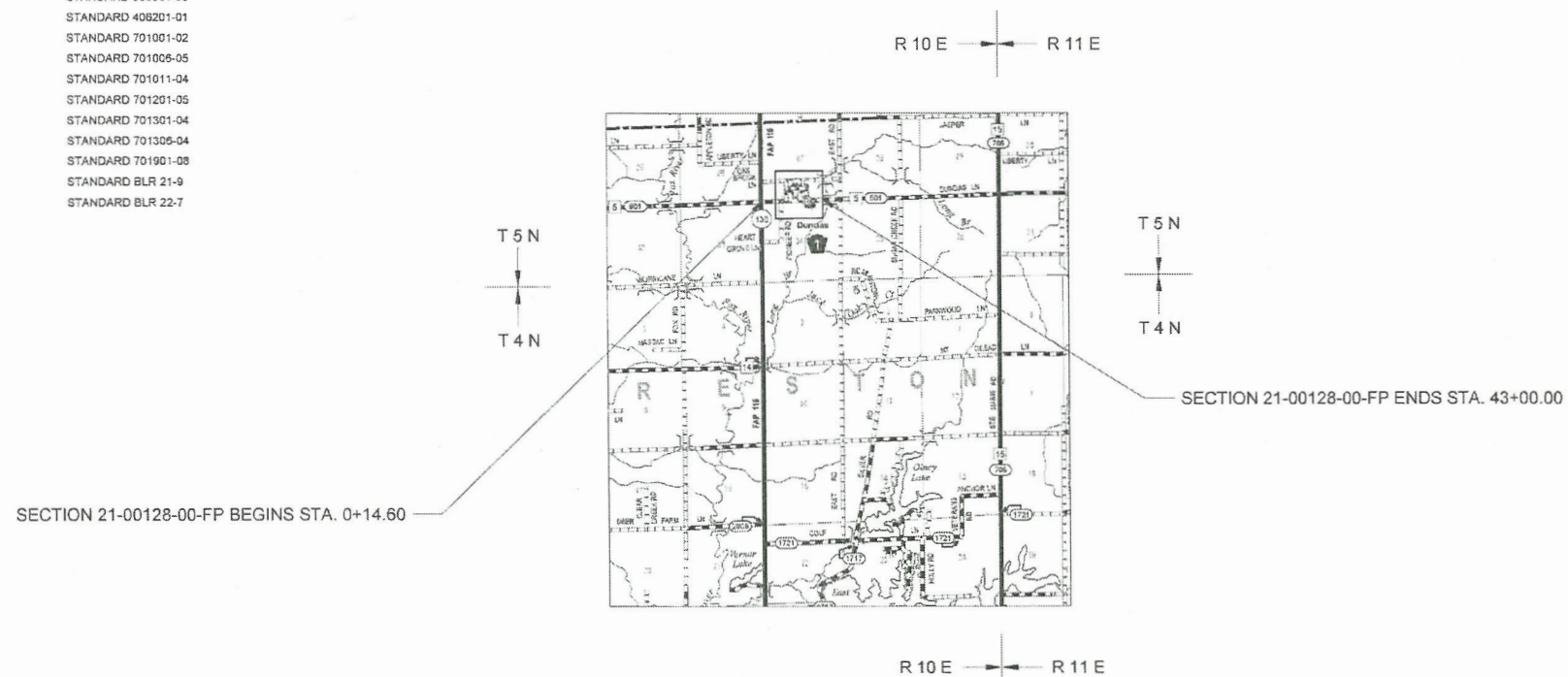

LICENSE EXPIRES 11/30/2023

CHARLESTON ENGINEERING, INC.
CONSULTING ENGINEERS
105 NORTH KITCHELL
P.O. BOX 397
CLNEY, ILLINOIS 62450
(618) 392-0736
ILLINOIS DEPARTMENT OF PROFESSIONAL REGULATION REGISTRATION #184.003513

APPROVED June 17, 2022
Danny A. Colwell, P.E.
COUNTY ENGINEER

STATE OF ILLINOIS
DEPARTMENT OF TRANSPORTATION

PASSED 06/21/22
Forthall
DISTRICT SEVEN ENGINEER OF
LOCAL ROADS AND STREETS

Releasing For
Bid Based on
Limited Review

06/21/22
Jeffrey Myers, P.E.
REGION FOUR ENGINEER

FUNCTIONAL CLASSIFICATION - MAJOR COLLECTOR
ADT = 950
DESIGN SPEED = 50 MPH

GENERAL NOTES

THE CONTRACTOR SHALL CONTACT JULIE (1-800-892-0123) BEFORE COMMENCING WORK. UNDERGROUND AND VISIBLE OVERHEAD UTILITIES SHOWN ON THE PLAN SHEETS WERE OBTAINED FROM LOCAL UTILITY COMPANIES AND OTHER AVAILABLE SOURCES. LOCATIONS, SIZE, MATERIAL, DESCRIPTION, OR TYPE OF EXISTING UTILITIES INDICATED ON THE PLANS ARE NOT REPRESENTED AS BEING ACCURATE, SUFFICIENT, OR COMPLETE AND SHALL BE CONSIDERED APPROXIMATE. ABOVE GROUND UTILITY LOCATIONS ARE SHOWN AS FOUND DURING THE INITIAL SURVEY FIELD WORK AND MAY NOT REFLECT CURRENT CONDITIONS. THE CONTRACTOR IS RESPONSIBLE FOR MAKING HIS OR HER OWN DETERMINATION AS TO THE TYPE, LOCATION, AND DEPTH OF UNDERGROUND AND OTHER UTILITIES AS MAY BE NECESSARY TO AVOID DAMAGE THERETO. THE CONTRACTOR SHALL BE RESPONSIBLE FOR LOCATING ALL UNDERGROUND UTILITIES AND COORDINATION WITH UTILITY COMPANIES.

THE CONTRACTOR SHALL COORDINATE ALL CONSTRUCTION ACTIVITIES WITH UTILITY COMPANIES AND THE RICHLAND COUNTY HIGHWAY DEPARTMENT.

THE FOLLOWING RATES HAVE BEEN USED TO CALCULATE PLAN QUANTITIES:
 BITUMINOUS MATERIALS (HFRS-2P) 2.92 LB/SY=(0.35 GAL/SY)*(8.35 LB/GAL)
 SEAL COAT AGGREGATE 25 POUNDS/SQ YD
 AGGREGATE SURFACE COURSE, TYPE-B 2.0 TONS/CU YD
 BITUMINOUS MATERIALS (PRIME COAT) 0.25 POUNDS/SQ FT
 BITUMINOUS MATERIALS (TACK COAT ON SOIL-CEMENT) 0.05 POUNDS/SQ FT
 BITUMINOUS MATERIALS (TACK COAT ON NEW H.M.A.) 0.025 POUNDS/SQ FT
 HOT-MIX ASPHALT 112.0 POUNDS/SQ YD/INCH THICKNESS
 AGGREGATE WEDGE SHOULDER, TYPE-B 2.0 TONS/CU YD

SCHEDULE OF KNOWN UTILITIES

DESIGN STAGE JULIE NO. A2793974
 JULIE NO. A220701181

UTILITY COMPANY	TYPE	CONTACT NAME	PHONE NUMBER	E-MAIL ADDRESS	MAILING ADDRESS
AMEREN ILLINOIS	ELECTRIC	NATE HILL	618-301-5327	nhill2@ameren.com	#6 EXECUTIVE DRIVE, COLLINSVILLE, IL 62234
NORRIS ELECTRIC CO-OP	ELECTRIC	TIM HUBER	618-783-8765	thuber@norriselectric.com	8543 N. IL. 130, NEWTON, IL 62448
FRONTIER COMMUNICATIONS	COMMUNICATIONS	BRIAN VANGUNDY	618-395-6189	brian.vangundy@ftr.com	225 E. CHESTNUT ST, OLNEY, IL 62450
ILLINOIS GAS COMPANY	GAS	JORDAN KOCHER, P.E.	618-395-8588	jkocher@ilgas.com	1927 MILLER DRIVE, OLNEY, IL 62450
SPARKLIGHT	COMMUNICATIONS	JOEL HARRELSON	618-383-2650	joel.harrelson@sparklight.biz	113 W 9TH ST, MT. CARMEL, IL 62863
WEST LIBERTY-DUNDAS WATER DISTRICT	WATER LINE	ERIC MAY	618-754-3576	eric@ericsaccounting.com	
WEST LIBERTY-DUNDAS WATER DISTRICT	SEWER LINE	ERIC MAY	618-754-3576	eric@ericsaccounting.com	

SUMMARY OF QUANTITIES			
CODE NO.	ITEM	UNIT	TOTAL QUANTITY
* LR403400	BITUMINOUS MATERIALS (COVER AND SEAL COATS)	TON	24.5
* LR403600	SEAL COAT AGGREGATE	TON	211
* X7010216	TRAFFIC CONTROL AND PROTECTION, (SPECIAL)	L SUM	1
* Z0055300	RUMBLE STRIP	EACH	2
35200410	PROCESSING SOIL-CEMENT BASE COURSE 10"	SQ YD	16,468
35200500	CEMENT	100 WT	13,030
* 40200800	AGGREGATE SURFACE COURSE, TYPE B	TON	64.5
40600275	BITUMINOUS MATERIALS (PRIME COAT)	POUND	20
* 40600290	BITUMINOUS MATERIALS (TACK COAT)	POUND	10,050
* 40600990	TEMPORARY RAMP	SQ YD	1,241
* 40604152	POLYMERIZED HOT-MIX ASPHALT SURFACE COURSE, IL-9.5, MIX "C", N70	TON	2,252
* 48102100	AGGREGATE WEDGE SHOULDER, TYPE B	TON	125
67100100	MOBILIZATION	L SUM	1

*SPECIAL PROVISION

SUMMARY OF BITUMINOUS MATERIALS (TACK COAT)	
LOCATION	QUANTITY (POUNDS)
MAINLINE	8,685
SIDE ROADS	1,365
TOTAL BITUMINOUS MATERIAL (TACK COAT) =	10,050

SUMMARY OF TEMPORARY RAMPS	
LOCATION	QUANTITY (SQ YD)
MAINLINE BUTT JOINT, STA. 0+14.60	150
MAINLINE TRANSITION, STA. 16+00.00	42
MAINLINE TRANSITION, STA. 40+00.00	27
MAINLINE, STA. 43+00.00	70
SIDE ROADS	952
TOTAL TEMPORARY RAMP =	1,241

SUMMARY OF HOT-MIX ASPHALT	
OPERATION	QUANTITY (TONS)
MAINLINE PAVING	2,170
SIDEROADS AND PRIVATE ENTRANCES	76
MAILBOX TURNOUTS	6
TOTAL HMA SURFACE COURSE =	2,252

HOT-MIX ASPHALT MIXTURE REQUIREMENTS						
APPLICATION	PERFORMANCE GRADE	DESIGN AIR VOIDS	MIXTURE COMPOSITION	FRICTION AGGREGATE	MIXTURE UNIT WEIGHT	QUALITY MANAGEMENT PROGRAM
POLYMERIZED HOT-MIX ASPHALT SURFACE COURSE, IL-9.5, MIX "C", N70	PG 70-22	4% @ N=70 Gyration	IL - 9.5	MIXTURE "C"	112 LB/SQ YD/IN	QC/QA

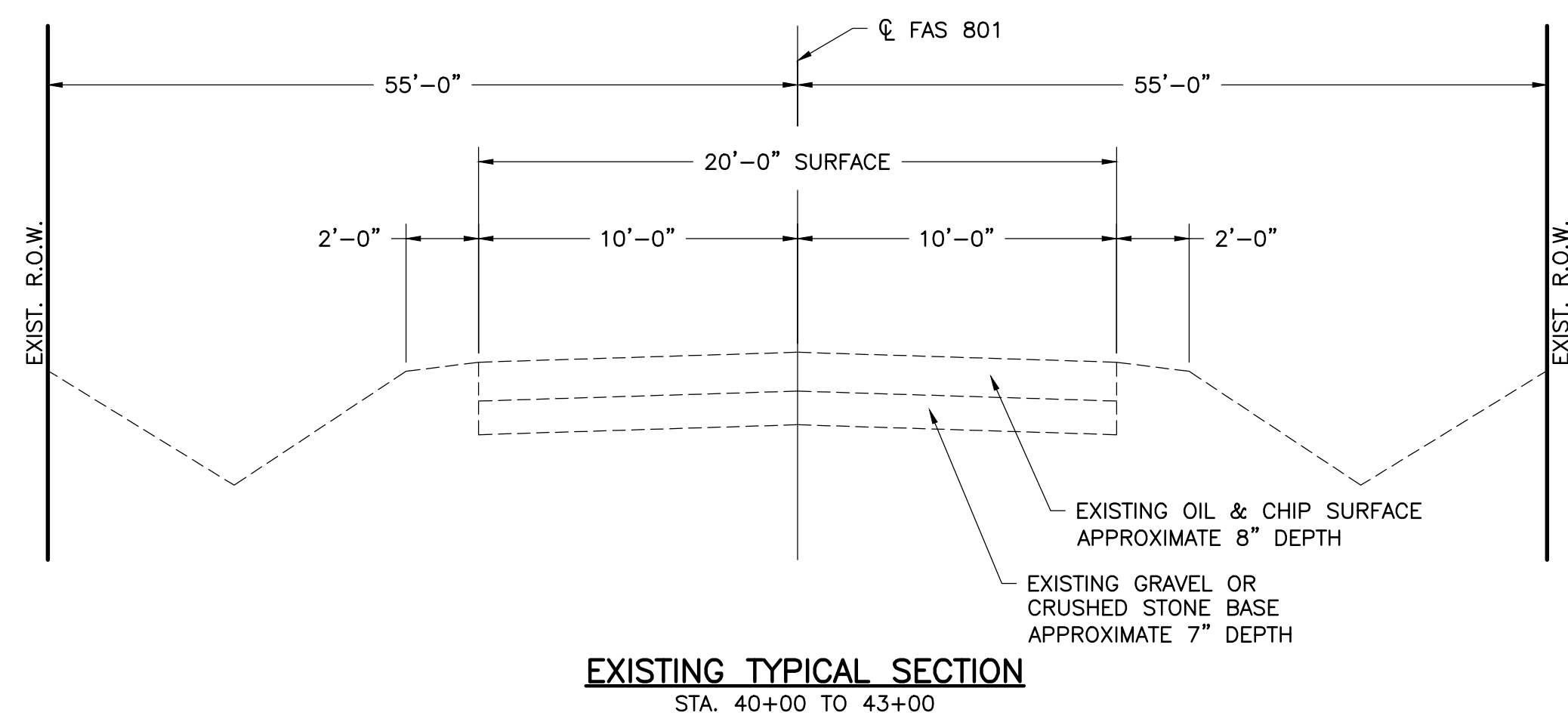
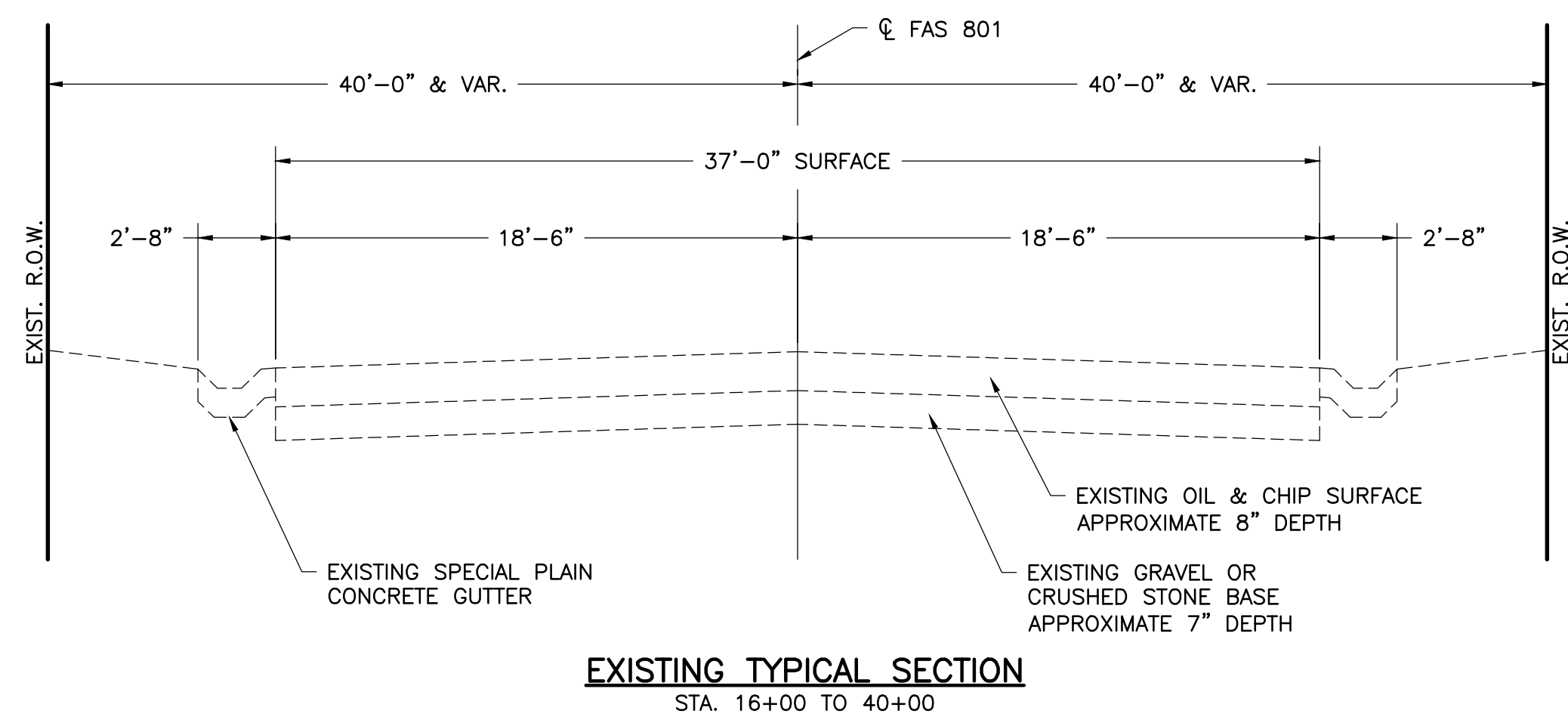
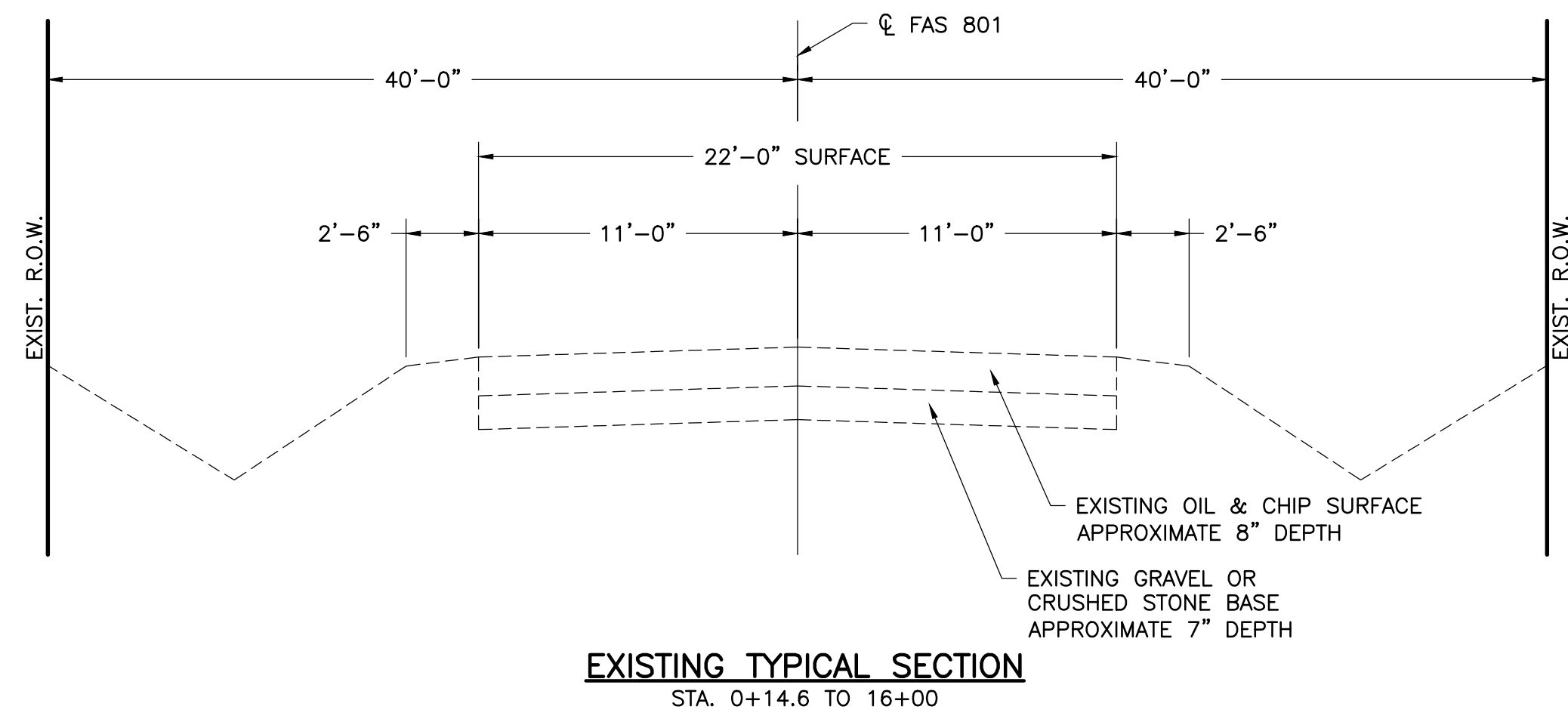

CHARLESTON ENGINEERING, INC.
CONSULTING ENGINEERS - LAND SURVEYORS
105 NORTH KITCHELL AVENUE
P.O. BOX 397
OLNEY, ILLINOIS 62450
(618) 392-0736
ILLINOIS DEPARTMENT OF PROFESSIONAL REGULATION REGISTRATION #184.003513

DESIGNED - BMB	REVISED -
DRAWN - BMB	REVISED -
CHECKED - BMB	REVISED -
DATE - 1-2022	REVISED -

STATE OF ILLINOIS
DEPARTMENT OF TRANSPORTATION

EXISTING ROADWAY TYPICAL SECTIONS

ROUTE	SECTION	COUNTY	TOTAL SHEETS	SHEET NO.
FAS 801	21-00128-00-FP	RICHLAND	11	3
CONTRACT 95925		ILLINOIS	PROJECT SDE2(930)	

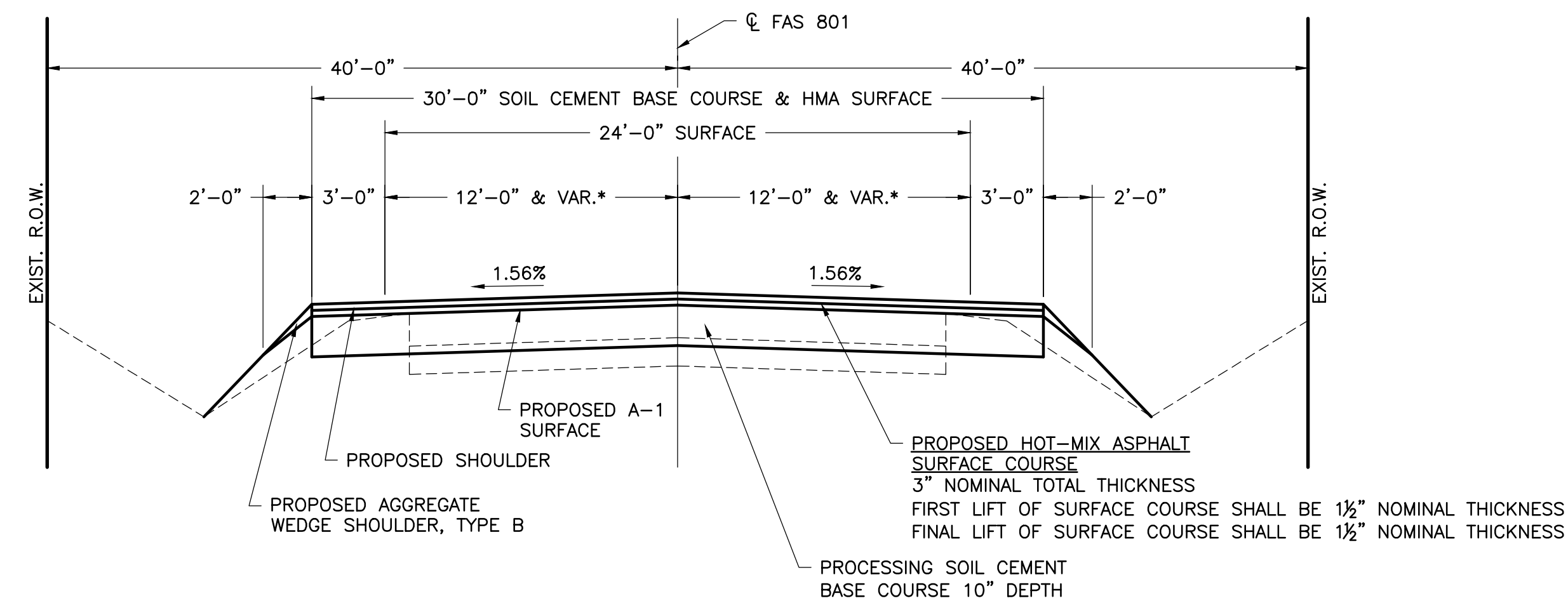

PROPOSED TYPICAL SECTION
STA. 0+14.6 TO 2+88

*VARIABLE LANE WIDTH AT INTERSECTION OF FAS 801 AND ILLINOIS ROUTE 130 - STA. 0+14.6 TO STA. 0+40.

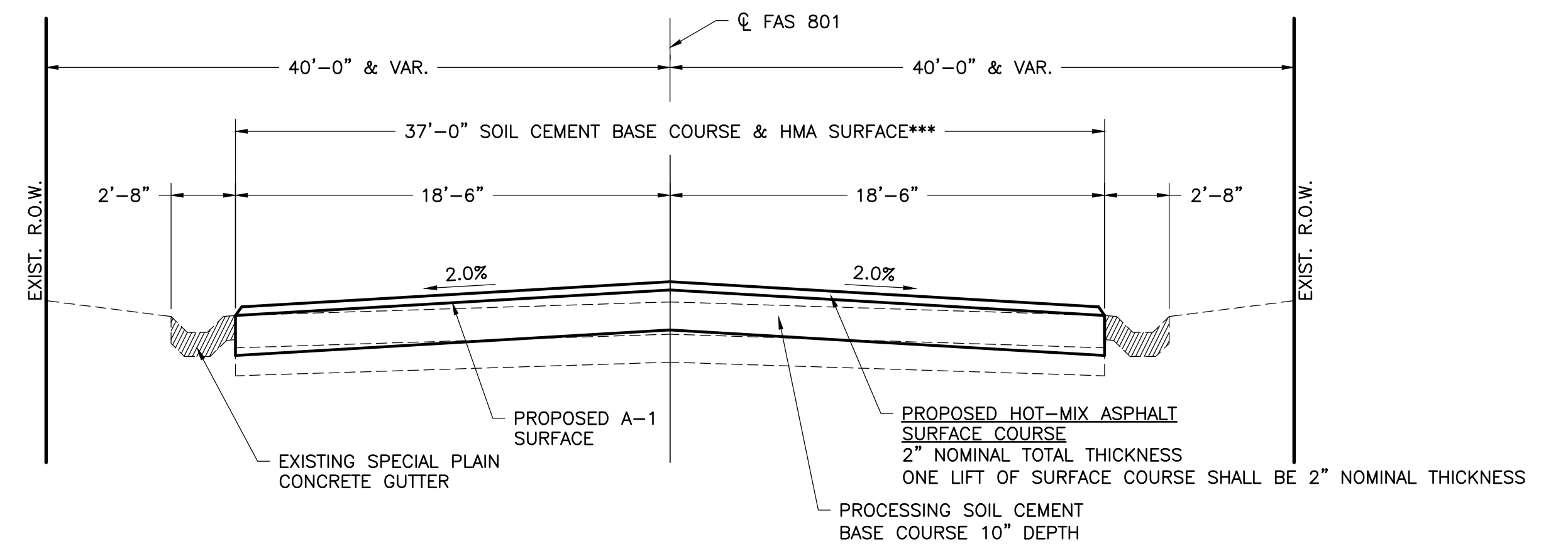

PROPOSED TYPICAL SECTION
STA. 16+00 TO 40+00

***PROPOSED TOP OF SOIL CEMENT BASE COURSE AT EDGE OF PAVEMENT SHALL MATCH TOP EDGE OF EXISTING SPECIAL PLAIN CONCRETE GUTTER FOR ENTIRE WIDTH OF ROADWAY

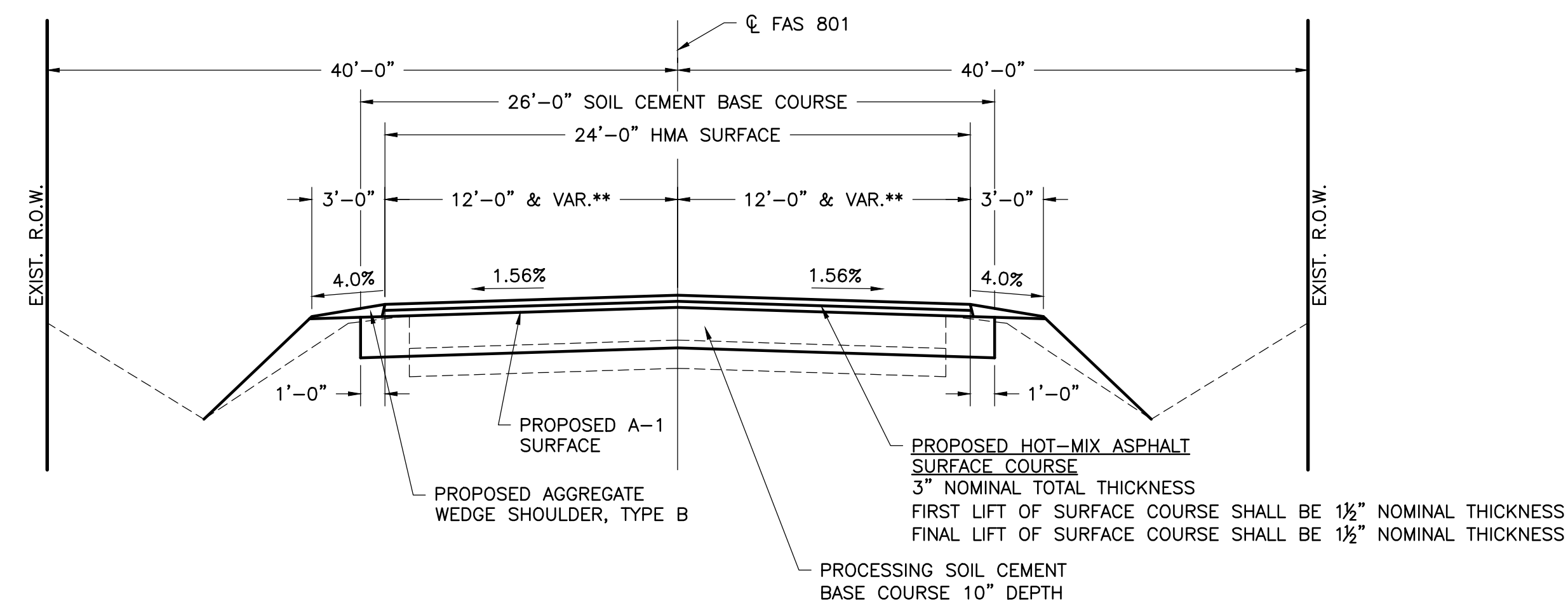

PROPOSED TYPICAL SECTION
STA. 2+88 TO 16+00

**VARIABLE LANE WIDTH AT TRANSITION TO URBAN SECTION - TRANSITION FROM 24' WIDE HMA SURFACE AT STA. 15+75 TO 37' WIDE HMA SURFACE AT STA. 16+00. SEE SHEET 10 FOR "H.M.A. TRANSITION DETAIL" FOR THICKNESS TRANSITION.

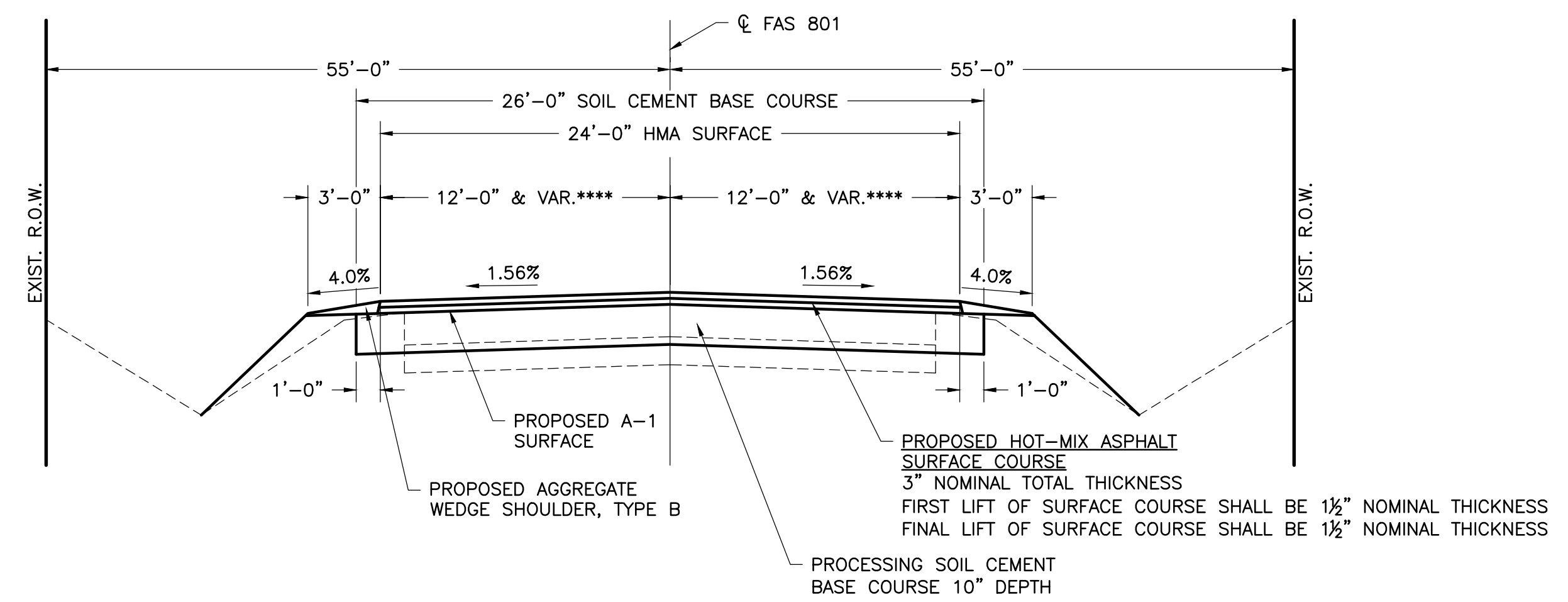

PROPOSED TYPICAL SECTION
STA. 40+00 TO 43+00

****VARIABLE LANE WIDTH AT TRANSITION TO RURAL SECTION - TRANSITION FROM 37' WIDE HMA SURFACE AT STA. 40+00 TO 24' WIDE HMA SURFACE AT STA. 40+50. SEE SHEET 10 FOR "H.M.A. TRANSITION DETAIL" FOR THICKNESS TRANSITION.

ROADWAY BASE COURSE AND PAVING SCHEDULE (MAINLINE)																				
PAVEMENT STRUCTURE		BASE COURSE						A-1 SURFACE		PAVING										
CODE NUMBER		35200410		35200500		LR403400		LR403600		40600990			40600290		40604152		Z0055300	48102100		
STATION TO STATION		LENGTH	SOIL-CEMENT BASE COURSE WIDTH	PROCESSING SOIL-CEMENT BASE COURSE 10"	MAX. LAB DRY SOIL UNIT WEIGHT	CEMENT	BITUMINOUS MATERIALS (COVER AND SEAL COATS)	SEAL COAT AGGREGATE	HMA PAVEMENT WIDTH	HMA PAVEMENT AREA	HMA SURFACE REMOVAL, BUTT JOINT - FOR INFORMATION ONLY	TEMPORARY RAMP (MAINLINE, AFTER HMA SURF REM., BUTT JT.)	TEMPORARY RAMP (MAINLINE, AFTER FIRST HMA LIFT)	TOTAL TEMPORARY RAMP (MAINLINE)	BITUMINOUS MATERIALS (TACK COAT)	TOTAL HMA SURFACE COURSE DEPTH	POLYMERIZED HOT-MIX ASPHALT SURFACE COURSE, IL-9.5, MIX "C", N70	RUMBLE STRIP	AGGREGATE WEDGE SHOULDER, TYPE B	
		(FEET)	(FEET)	(SQ YD)	(PCF)	(% MASS)	(HWT)	(TON)	(TON)	(FEET)	(SQ YD)	(SQ YD)	(SQ YD)	(SQ YD)	(POUND)	(IN)	(TON)	(EACH)	(TON)	
14.6	to	40	25	30 & VAR.	1,070		850	1.6	14	30 & VAR.	1,070	179	90	60	150	725	3	180	0	3
40	to	288	248	30	827		660	1.3	11	30	827	0	0	0	0	560	3	140	0	10
288	to	1575	1,287	26	3,718		2,940	5.5	47	24	3,432	0	0	0	0	2,320	3	580	2	86
1575	to	1600	25	26 TO 37	88	132	70	0.2	2	24 TO 37	85	41	0	42	42	60	3	15	0	3
1600	to	4000	2,400	37	9,867		7,790	14.5	124	37	9,867	0	0	0	0	4,445	2	1110	0	0
4000	to	4050	50	37 TO 26	175		140	0.3	3	37 TO 24	170	27	0	27	27	120	3	30	0	5
4050	to	4300	250	26	723		580	1.1	10	24	667	122	40	30	70	455	3	115	0	18
TOTALS =				16,468			13,030	24.5	211			369	130	159	289	8,685		2170	2	125

SCHEDULE OF EXISTING STORM SEWER DRAINAGE STRUCTURES						
NO.	STA.	SIDE	ITEM	GRATE	INVERT	TOP ELEV.
1	25+86	LT	SPECIAL CATCH BASINS, TYPE 1 WITH TYPE 3 GRATE	475.79	473.34	-
2	25+84	RT	SPECIAL CATCH BASINS, TYPE 1 WITH TYPE 3 GRATE	475.99	473.41	-
3	26+95	LT	SPECIAL CATCH BASINS, TYPE 1 WITH TYPE 3 GRATE	475.51	473.99	-
4	27+73	LT	SPECIAL CATCH BASINS, TYPE 1 WITH TYPE 3 GRATE	474.58	472.53	-
5	27+91	RT	MANHOLES, TYPE A-1-C, 3' DIAMETER	-	471.71	474.92
6	30+16	RT	MANHOLES, TYPE A-1-C, 3' DIAMETER	-	469.42	472.57
7	30+03	RT	SPECIAL CATCH BASINS, TYPE 1 WITH TYPE 3 GRATE	472.00	470.28	-
8	30+03	LT	SPECIAL CATCH BASINS, TYPE 1 WITH TYPE 3 GRATE	471.94	470.14	-
9	30+87	RT	MANHOLES, TYPE A-1-C, 3' DIAMETER	-	468.77	472.28
10	30+79	RT	SPECIAL CATCH BASINS, TYPE 1 WITH TYPE 3 GRATE	471.01	469.18	-
11	30+79	LT	SPECIAL CATCH BASINS, TYPE 1 WITH TYPE 3 GRATE	471.50	470.04	-
12	34+47	LT	SPECIAL CATCH BASINS, TYPE 2	466.04	463.14	-
13	34+69	RT	SPECIAL CATCH BASINS, TYPE 2	466.04	462.99	-
14	34+72	RT	MANHOLES, TYPE A-1-C, 3' DIAMETER	-	462.91	466.56

ENTRANCES AND SIDE ROADS SCHEDULE																			
CODE NUMBER			40600290	40600275	40604152	40600990							40200800						
STATION	LOCATION	TYPE	PROPOSED SURFACE MATERIAL	BITUMINOUS MATERIALS (TACK COAT)	BITUMINOUS MATERIALS (PRIME COAT)	POLYMERIZED HOT-MIX ASPHALT SURFACE COURSE, IL-9.5, MIX "C", N70	TEMPORARY RAMP (AFTER HMA SURFACE REMOVAL, VAR. DEPTH)	TAPER LENGTH (AFTER HMA SURFACE REMOVAL, VAR. DEPTH)	TEMPORARY RAMP (AFTER FIRST HMA LIFT)	TAPER LENGTH (AFTER FIRST HMA LIFT)	TEMPORARY RAMP (AFTER FINAL HMA LIFT)	TAPER LENGTH (AFTER FINAL HMA LIFT)	TOTAL TEMPORARY RAMP, SIDE ROADS	HMA SURFACE REMOVAL, VARIABLE DEPTH (SPECIAL) - FOR INFORMATION ONLY	AGGREGATE SURFACE COURSE, TYPE-B	WIDTH AT EP	WIDTH AT BACK	FINAL DISTANCE BACK FROM EP	RADIUS / FLARE
			(POUND)	(POUND)	(TONS)	(SQ YD)	(FT)	(SQ YD)	(FT)	(SQ YD)	(FT)	(SQ YD)	(SQ YD)	(TONS)	(FEET)	(FEET)	(FEET)	(FEET)	
1+72	RT	PE	AGG.	-	-	-	-	-	-	-	-	-	-	1.5	20	12	8	4' FLARE	
2+45	RT	PE	AGG.	-	-	-	-	-	-	-	-	-	-	1.5	24	16	8	4' FLARE	
3+20	RT	FE	AGG.	-	-	-	-	-	-	-	-	-	-	1.5	20	12	8	4' FLARE	
9+24	LT	PE	AGG.	-	-	-	-	-	-	-	-	-	-	3.5	48	40	8	4' FLARE	
12+73	RT	PE	AGG.	-	-	-	-	-	-	-	-	-	-	2.5	32	24	8	4' FLARE	
13+34	RT	SIDE ROAD	HMA	155	20	12	0	0	43	7	80	13	123	67.9	-	55	15	30	20/20
13+63	LT	PE	AGG.	-	-	-	-	-	-	-	-	-	-	2.5	40	24	8	8' FLARE	
15+61	LT	PE	AGG.	-	-	-	-	-	-	-	-	-	-	1.5	20	12	8	4' FLARE	
16+93	LT	SIDE ROAD	HMA	65	0	4	90	9	45	9	0	0	135	28.4	-	45	16	11	15/15
16+96	RT	PE	AGG.	-	-	-	-	-	-	-	-	-	-	1.0	20	12	8	4' FLARE	
17+37	RT	PE	AGG.	-	-	-	-	-	-	-	-	-	-	1.0	22	14	8	4' FLARE	
17+70	LT	PE	AGG.	-	-	-	-	-	-	-	-	-	-	1.0	20	12	8	4' FLARE	
18+41	LT	PE	AGG.	-	-	-	-	-	-	-	-	-	-	1.5	33	25	8	4' FLARE	
18+83	LT	PE	AGG.	-	-	-	-	-	-	-	-	-	-	1.5	28	20	8	4' FLARE	
19+89	LT	SIDE ROAD	HMA	90	0	5	45	9	45	9	0	0	90	39.6	-	45	15	17	15/15
21+00	LT	PE	AGG.	-	-	-	-	-	-	-	-	-	-	1.0	20	12	8	4' FLARE	
22+31	LT	PE	AGG.	-	-	-	-	-	-	-	-	-	-	1.0	22	14	8	4' FLARE	
22+83	LT	SIDE ROAD	HMA	95	0	5	37	9	37	9	0	0	74	41.2	-	37	18	19	10/10
23+53	RT	PE	HMA & AGG.	15	-	1	-	-	-	-	-	-	-	1.0	20	12	8	4' FLARE	
23+80	LT	PE	AGG.	-	-	-	-	-	-	-	-	-	-	1.0	18	14	8	2' FLARE	
23+90	RT	PE	AGG.	-	-	-	-	-	-	-	-	-	-	2.0	42	34	8	4' FLARE	
24+68	RT	PE	AGG.	-	-	-	-	-	-	-	-	-	-	1.0	23	15	8	4' FLARE	
25+70	RT	PE	HMA & AGG.	5	-	1	-	-	-	-	-	-	-	1.6	15	15	8	0' FLARE	
25+95	LT	SIDE ROAD	HMA	35	0	2	20	9	20	9	0	0	40	15.6	-	20	10	13	5/5
26+57	RT	PE	AGG.	-	-	-	-	-	-	-	-	-	-	1.0	12	12	8	0' FLARE	
27+35	LT	SIDE ROAD	HMA	320	0	16	81	9	81	9	0	0	162	141.2	-	81	32	29	20/20
27+62	RT	PE	AGG.	-	-	-	-	-	-	-	-	-	-	1.0	14	14	8	0' FLARE	
28+22	LT	PE	AGG.	-	-	-	-	-	-	-	-	-	-	2.5	52	44	8	4' FLARE	
30+40	LT	SIDE ROAD	HMA	240	0	12	70	9	70	9	0	0	140	106.7	-	70	18	28	20/20
30+40	RT	SIDE ROAD	HMA	225	0	12	70	9	70	9	0	0	140	98.9	-	70	30	20	20/20
31+60	RT	PE	AGG.	-	-	-	-	-	-	-	-	-	-	1.0	14	14	8	0' FLARE	
31+85	RT	PE	AGG.	-	-	-	-	-	-	-	-	-	-	1.0	16	16	8	0' FLARE	
35+01	RT	SIDE ROAD	HMA	120	0	6	24	9	24	9	0	0	48	53.4	-	24	20	24	4' FLARE
36+69	LT	PE	AGG.	-	-	-	-	-	-	-	-	-	-	1.5	28	20	8	4' FLARE	
37+28	RT	PE	AGG.	-	-	-	-	-	-	-	-	-	-	1.5	34	26	8	4' FLARE	
38+20	LT	PE	AGG.	-	-	-	-	-	-	-	-	-	-	1.0	20	12	8	4' FLARE	
38+94	LT	PE	AGG.	-	-	-	-	-	-	-	-	-	-	1.0	22	14	8	4' FLARE	
39+26	RT	PE	AGG.	-	-	-	-	-	-	-	-	-	-	1.5	29	21	8	4' FLARE	
39+80	LT	PE	AGG.	-	-	-	-	-	-	-	-	-	-	1.0	18	10	8	4' FLARE	
40+25	LT	PE	AGG.	-	-	-	-	-	-	-	-	-	-	2.0	19	11	12	4' FLARE	
40+69	LT	PE	AGG.	-	-	-	-	-	-	-	-	-	-	2.0	27	19	8	4' FLARE	
40+69	RT	PE	AGG.	-	-	-	-	-	-	-	-	-	-	18.0	142	134	14	4' FLARE	
TOTALS =			1365	20	76	437	435	80	952	594.5	64.5								

SCHEDULE OF EXISTING STORM SEWER PIPES									
LOCATION		SIDE	MATERIAL	TY-1, 12"	TY-1, 15"	TY-1, 18"	TY-1, 24"	TY-1, 30"	
1	TO	2	A.R.	RCCP				X	
3	TO	5	A.R.	RCCP	X				
4	TO	5	A.R.	RCCP	X				
5	TO	6	RT	RCCP		X			
7	TO	6	RT	RCCP	X				
8	TO	6	A.R.	RCCP	X				
6	TO	9	RT	RCCP			X		
10	TO	9	RT	RCCP	X				
11	TO	9	A.R.	RCCP	X				
9	TO	14	RT	RCCP			X		
12	TO	13	A.R.	RCCP				X	
13	TO	14	RT	RCCP				X	
14	TO	15	RT	RCCP					X

NOTES

LOCATIONS, SIZE, MATERIAL, DESCRIPTION, OR TYPE OF EXISTING STORM SEWERS INDICATED ON THE PLANS ARE NOT REPRESENTED AS BEING ACCURATE, SUFFICIENT, OR COMPLETE AND SHALL BE CONSIDERED APPROXIMATE. EXISTING STORM SEWER INFORMATION WAS OBTAINED FROM ORIGINAL CONSTRUCTION PLANS FOR SEC. 100G AND SEC 100B - F.A.S. PROJECT 562B, AND ELEVATIONS OF DRAINAGE STRUCTURES SHOWN WERE FIELD MEASURED, BUT SHALL STILL BE CONSIDERED APPROXIMATE. DEPTHS OF EXISTING STORM SEWER PIPES BETWEEN DRAINAGE STRUCTURES WERE NOT OBTAINED AND SHALL BE VERIFIED BY THE CONTRACTOR. THE CONTRACTOR IS STILL RESPONSIBLE FOR MAKING HIS OR HER OWN DETERMINATION AS TO THE TYPE, LOCATION, AND DEPTH OF UNDERGROUND AND OTHER UTILITIES AS MAY BE NECESSARY TO AVOID DAMAGE THERETO. THE CONTRACTOR SHALL BE RESPONSIBLE TO REPAIR OR REPLACE AT HIS OR HER OWN EXPENSE, OR BEAR THE COST, TO REPAIR OR REPLACE ALL STORM SEWERS WHICH HAVE BEEN DAMAGED THROUGH HIS OR HER OWN NEGLIGENCE.

MAILBOX TURNOUT SCHEDULE		
STATION	LOCATION	TONS H.M.A.
9+78	LT	3.0
40+45	LT	3.0
TOTAL		6.0

NOTE

HOT-MIX ASPHALT AT MAILBOX TURNOUT LOCATIONS PAID FOR AS POLYMERIZED HOT-MIX ASPHALT SURFACE COURSE, IL-9.5, MIX "C", N70

CHARLESTON ENGINEERING, INC.
 CONSULTING ENGINEERS - LAND SURVEYORS
 105 NORTH KITCHELL AVENUE OLNEY, ILLINOIS 62450
 P.O. BOX 397 (618) 392-0736
 ILLINOIS DEPARTMENT OF PROFESSIONAL REGULATION REGISTRATION #184.003513

DESIGNED -- BMB
 DRAWN -- BMB
 CHECKED -- BMB
 DATE -- 1-2022

REVISED --
 REVISED --
 REVISED --
 REVISED --

STATE OF ILLINOIS
 DEPARTMENT OF TRANSPORTATION

SCHEDULES OF PROPOSED QUANTITIES AND
 EXISTING STORM SEWERS

ROUTE	SECTION	COUNTY	TOTAL SHEETS	SHEET NO.
FAS 801	21-00128-00-FP	RICHLAND	11	5
CONTRACT 95925		ILLINOIS	PROJECT SDE2(930)	

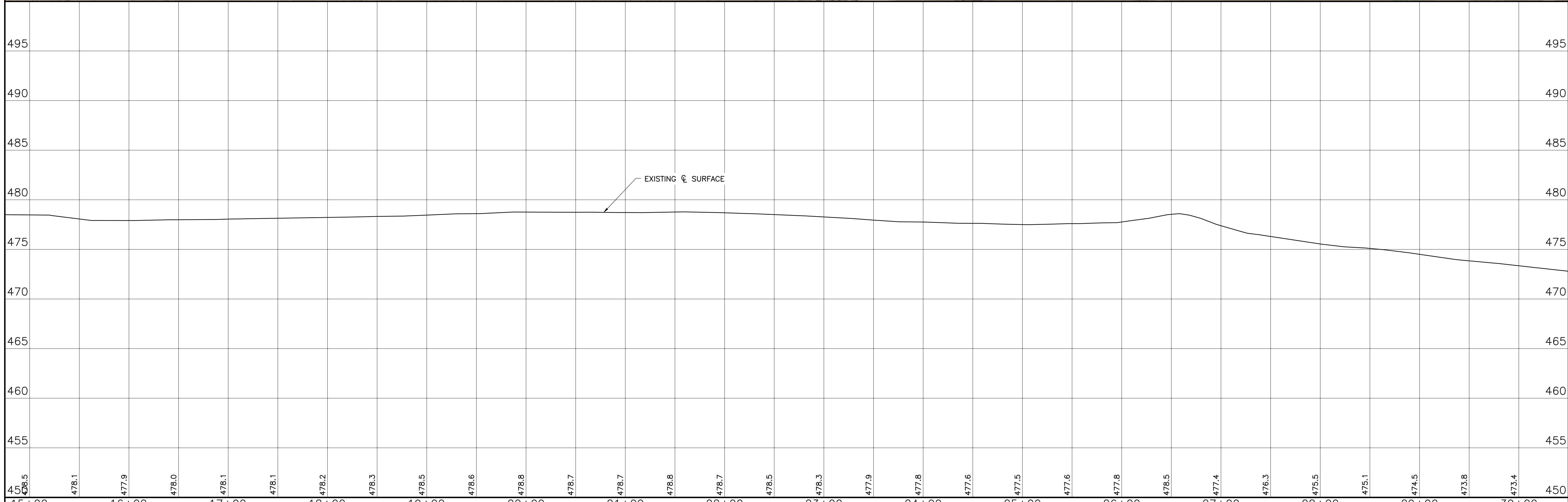
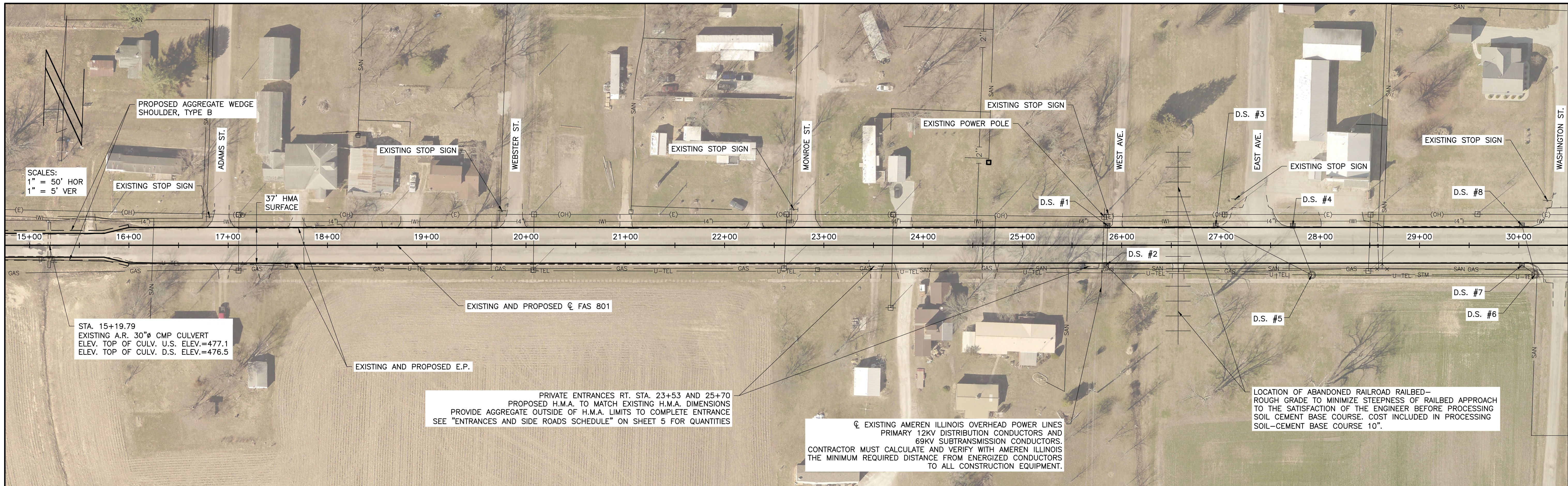

15+00	16+00	17+00	18+00	19+00	20+00	21+00	22+00	23+00	24+00	25+00	26+00	27+00	28+00	29+00	30+00
478.5	478.1	477.9	478.0	478.1	478.2	478.3	478.5	478.6	478.8	478.7	478.7	478.8	478.7	478.5	478.3
477.9	477.6	477.5	477.6	477.8	477.5	477.4	476.3	475.5	475.1	474.5	473.8	473.4			

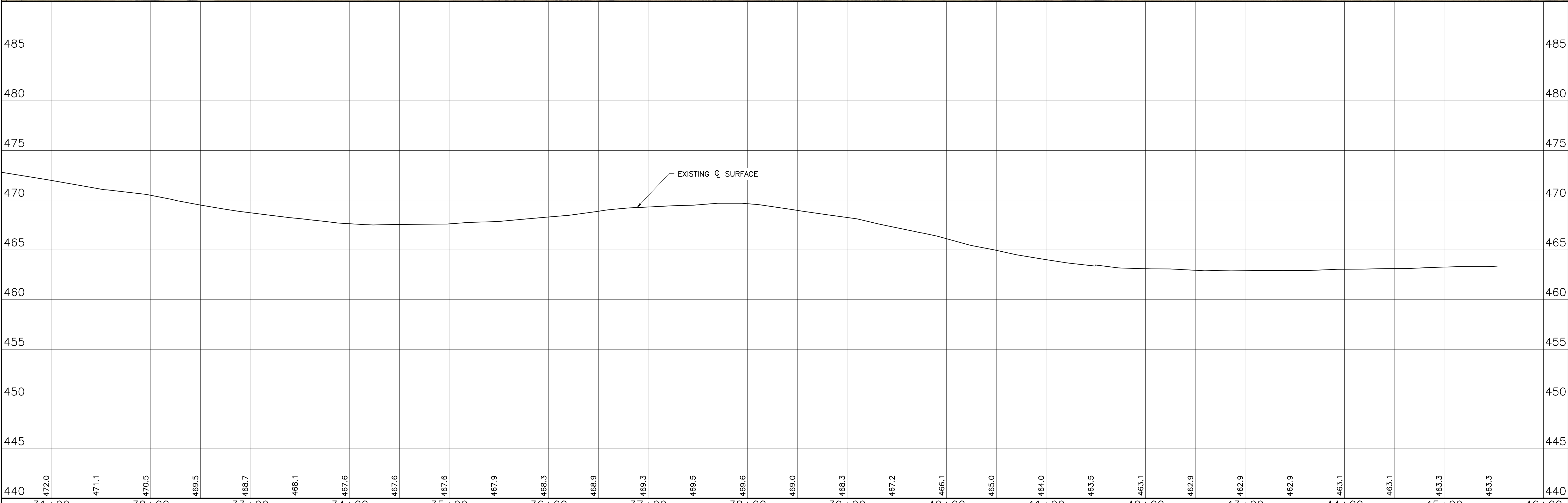
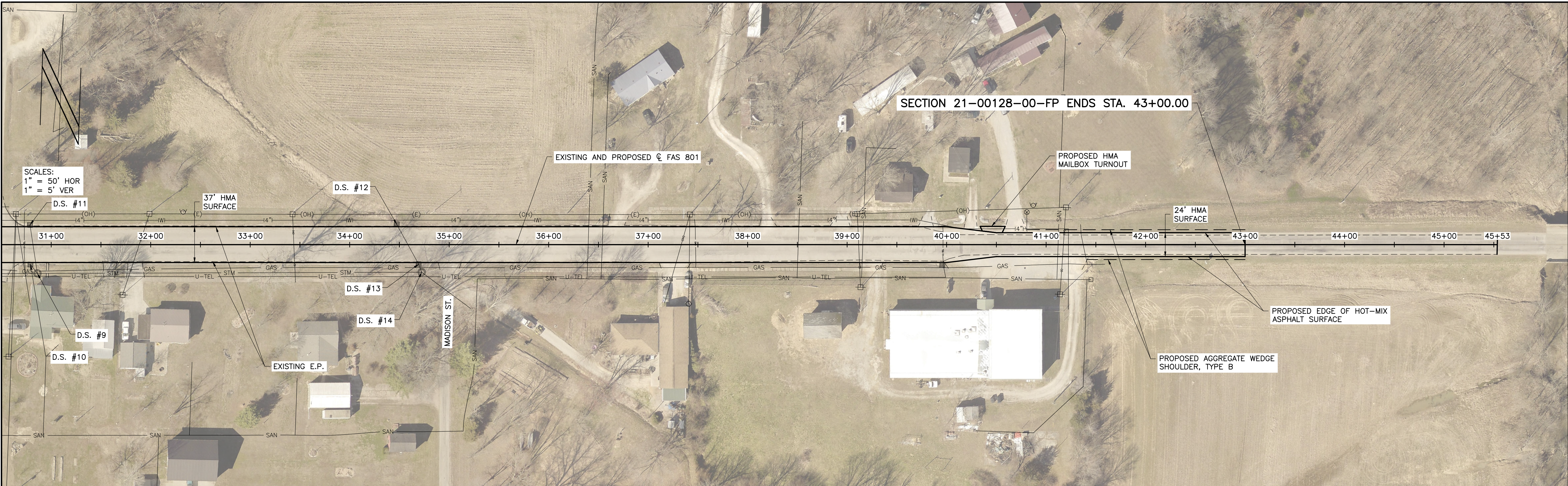

31+00	32+00	33+00	34+00	35+00	36+00	37+00	38+00	39+00	40+00	41+00	42+00	43+00	44+00	45+00	46+00
472.0	471.1	470.5	469.5	468.7	468.1	467.6	467.6	467.6	467.9	468.3	468.9	469.3	469.5	469.6	469.0
468.3	467.2	466.1	465.0	464.0	463.5	463.1	462.9	462.9	462.9	463.1	463.1	463.3	463.3	463.3	440

CHARLESTON ENGINEERING, INC.
 CONSULTING ENGINEERS - LAND SURVEYORS
 105 NORTH KITCHELL AVENUE OLNEY, ILLINOIS 62450
 P.O. BOX 397 (618) 392-0736
 ILLINOIS DEPARTMENT OF PROFESSIONAL REGULATION REGISTRATION #184.003513

DESIGNED - BMB	REVISED -
DRAWN - BMB	REVISED -
CHECKED - BMB	REVISED -
DATE - 1-2022	REVISED -

STATE OF ILLINOIS
 DEPARTMENT OF TRANSPORTATION

PLAN AND PROFILE

ROUTE	SECTION	COUNTY	TOTAL SHEETS	SHEET NO.
FAS 801	21-00128-00-FP	RICHLAND	11	8
CONTRACT 95925		ILLINOIS	PROJECT SDE2(930)	

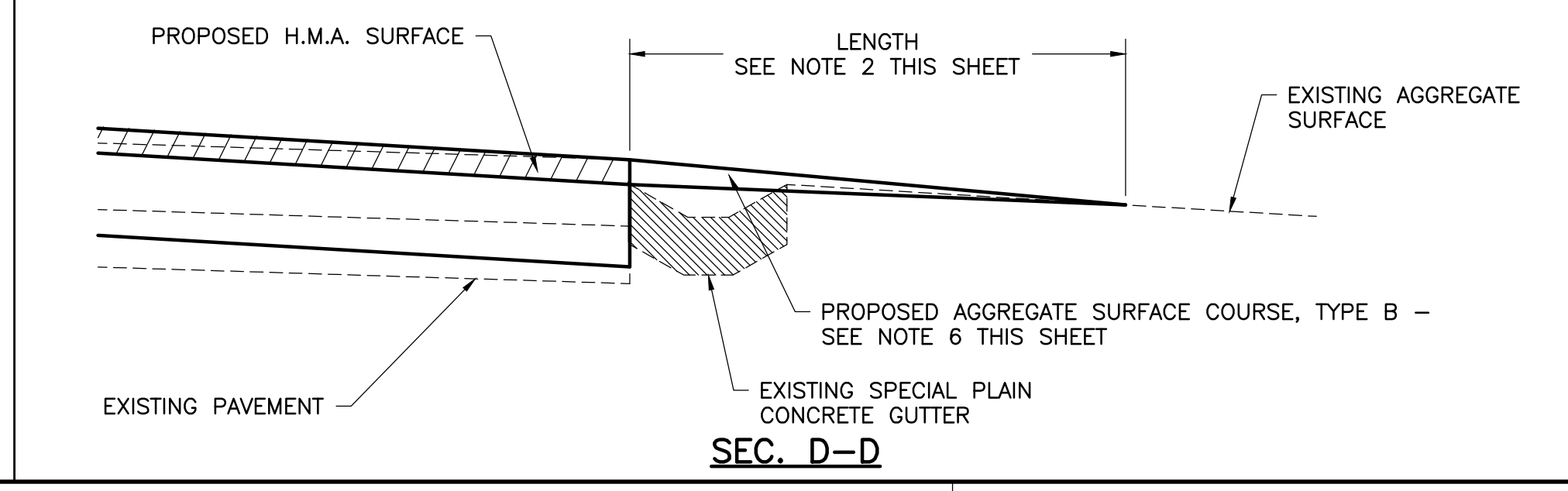
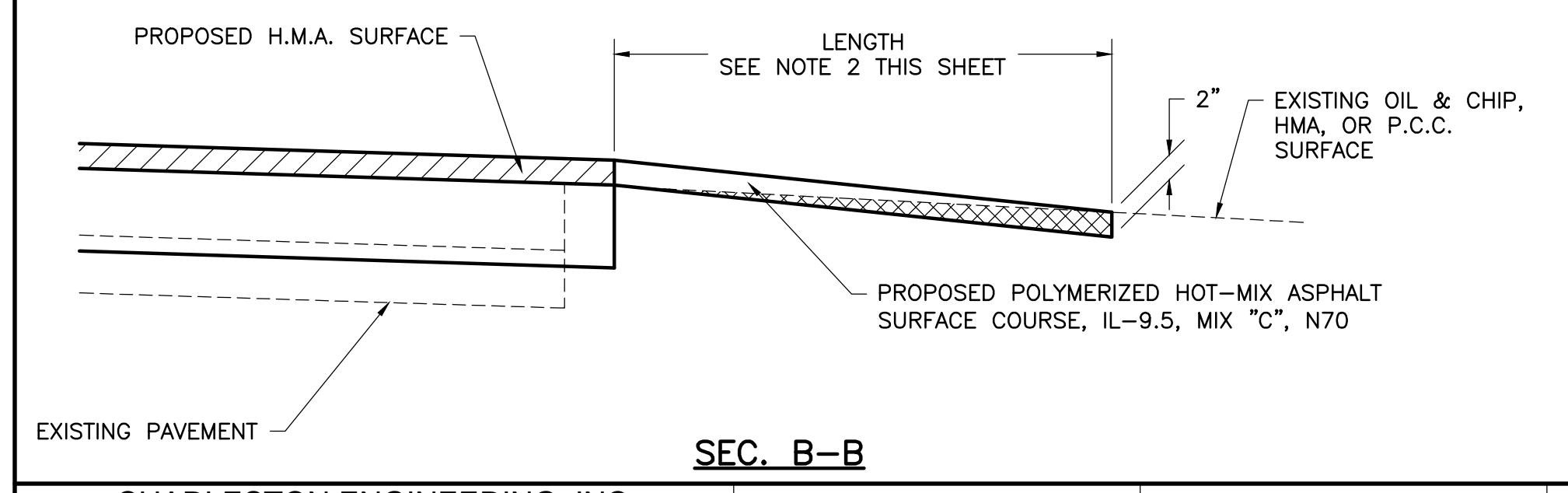
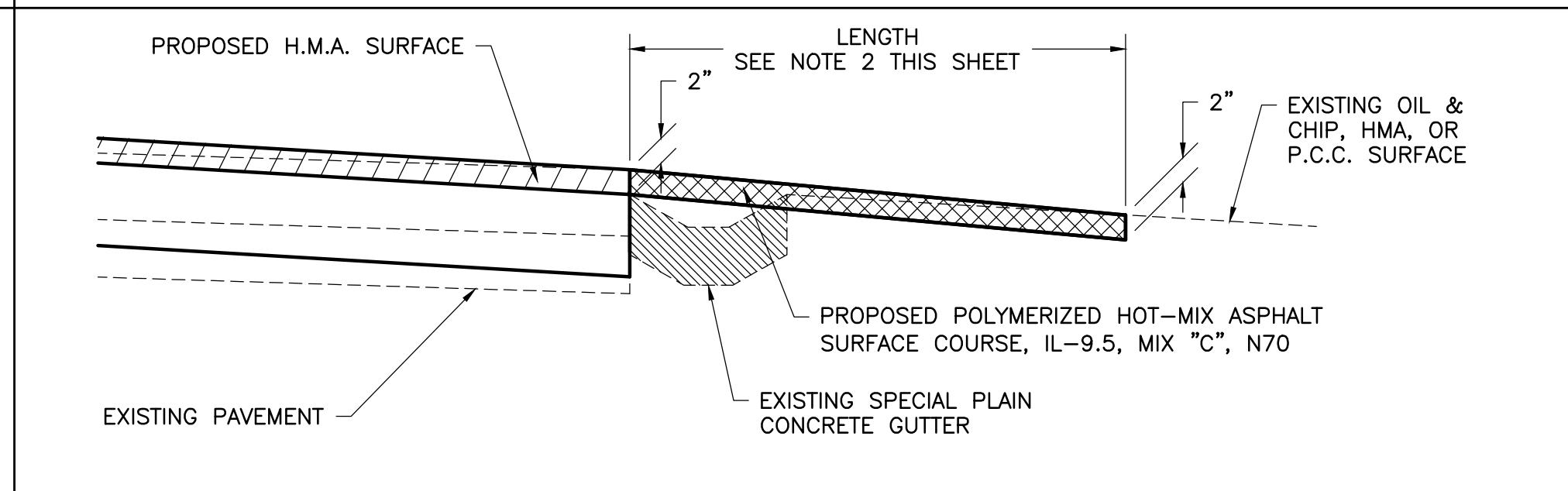
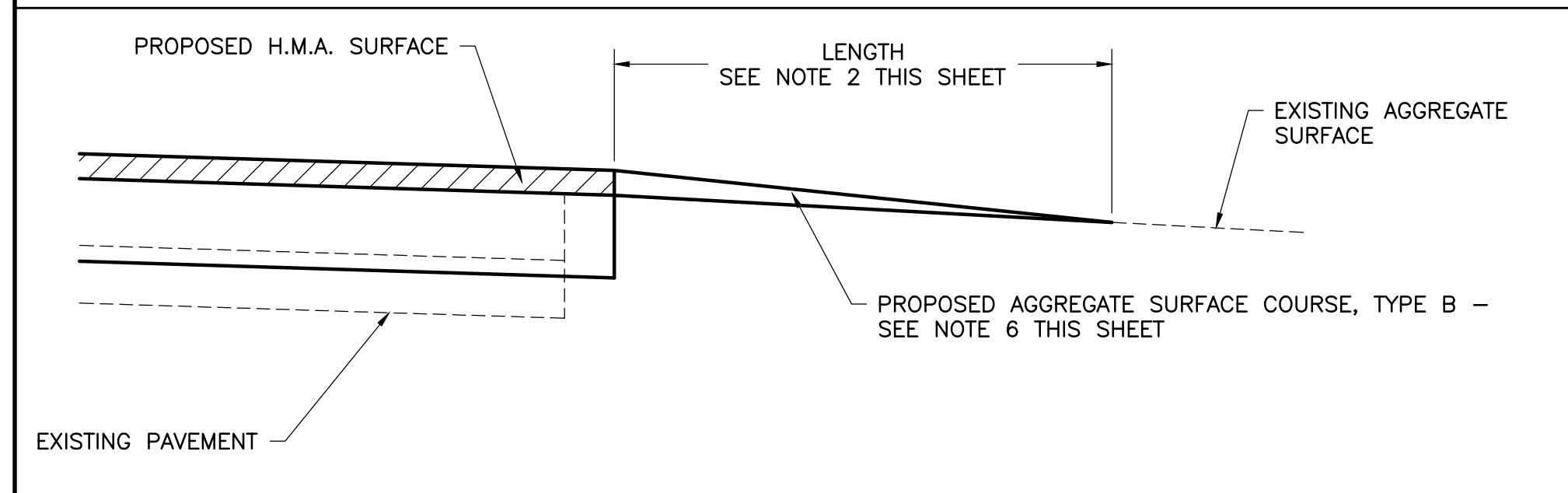
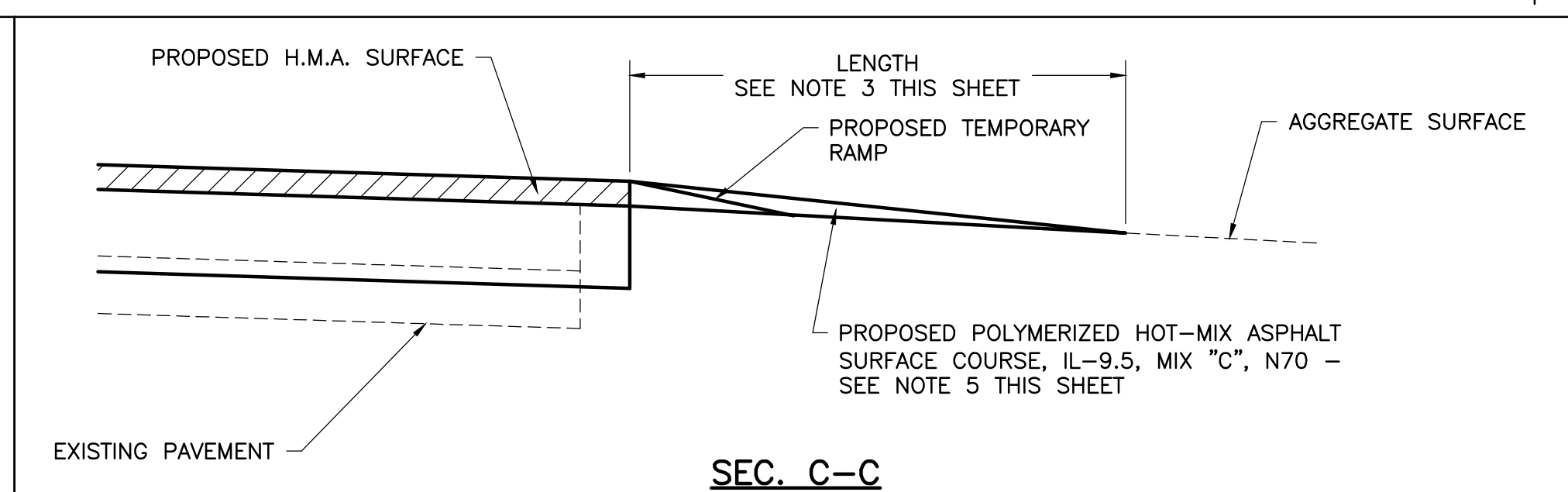
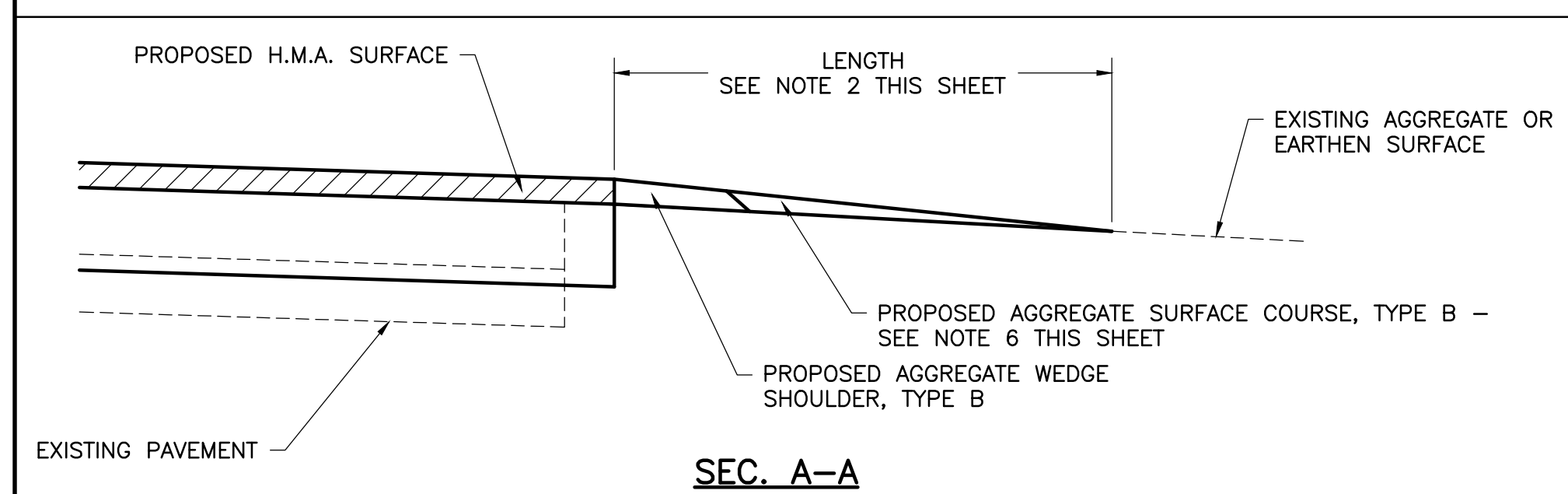
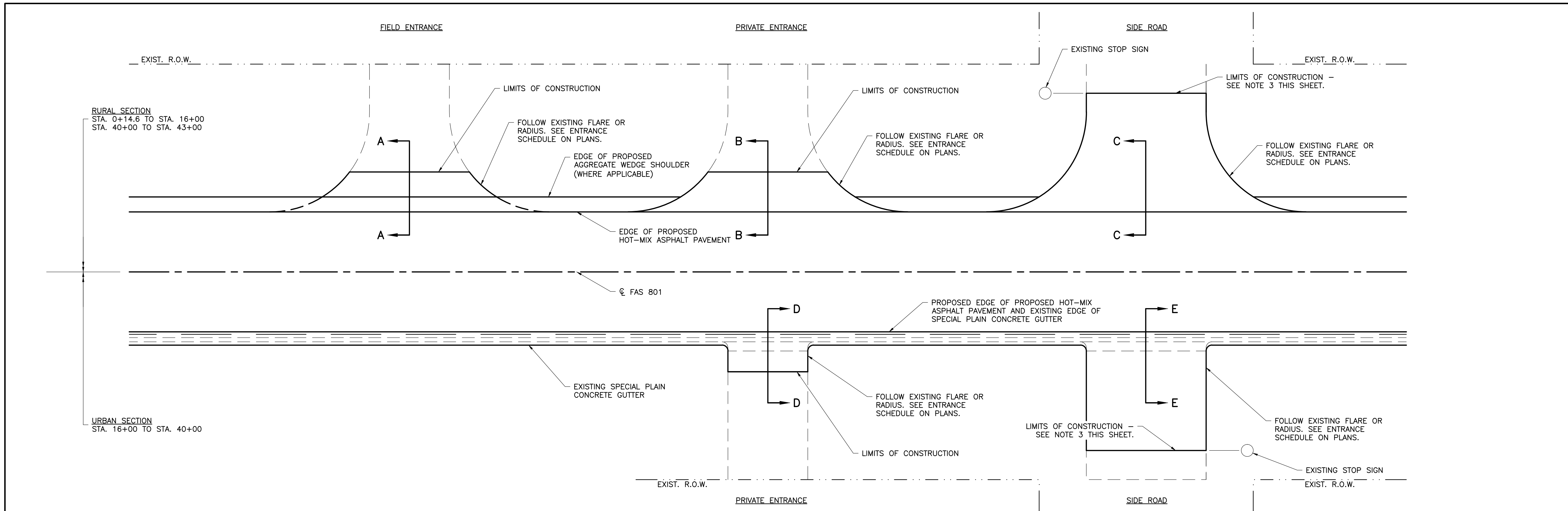

- NOTES**
- MATCH EXISTING DIMENSIONS OF ALL FIELD ENTRANCES, PRIVATE ENTRANCES, AND SIDE ROADS. WIDTHS AND RADII SHOWN ON ENTRANCES AND SIDE ROADS SCHEDULE ON THE PLAN SHEET 5 SHOWN AS A BASIS FOR ESTIMATING QUANTITIES.
 - FINAL LENGTH = 8 FEET UNLESS OTHERWISE NOTED ON PLANS. SEE ENTRANCE AND SIDE ROADS SCHEDULE ON PLAN SHEET 5 FOR DISTANCES.
 - LENGTH TO EXTEND PERPENDICULAR WITH EXISTING STOP SIGN LOCATION. SEE ENTRANCE AND SIDE ROADS SCHEDULE ON PLAN SHEET 5 FOR FINAL DISTANCES AND TEMPORARY RAMP QUANTITIES AND DIMENSIONS.
 - ALL SURFACE REMOVAL, VARIABLE DEPTH (SPECIAL) OF EXISTING OIL & CHIP, HOT-MIX ASPHALT, OR PORTLAND CEMENT CONCRETE SURFACES SHALL BE INCIDENTAL TO ITEM POLYMERIZED HOT-MIX ASPHALT SURFACE COURSE, IL 9.5, MIX "C", N70. SEE "POLYMERIZED HOT-MIX ASPHALT SURFACE COURSE, IL-9.5, MIX "C", N70 SPECIAL PROVISIONS.
 - BITUMINOUS MATERIALS (PRIME COAT) SHALL BE APPLIED ON ALL EXISTING AGGREGATE SURFACES THAT WILL HAVE HOT-MIX ASPHALT OVERLAY. BITUMINOUS MATERIALS (TACK COAT) SHALL BE APPLIED ON ALL MILLED OIL & CHIP, HMA, OR CONCRETE SURFACES THAT WILL HAVE HOT-MIX ASPHALT OVERLAY.
 - PLACE PROPOSED AGGREGATE SURFACE COURSE, TYPE B IMMEDIATELY AFTER EACH LIFT OF H.M.A. TO PROVIDE PERMANENT AGGREGATE RAMP FOR ENTRANCES. THE DEPTH SHALL BE THE H.M.A. THICKNESS OF THE RESPECTIVE LIFT FEATHERED TO ZERO DEPTH AT A MAXIMUM RATE OF 1V:40H. THE LENGTH "L" OF AGGREGATE RAMPS SHALL BE AS FOLLOWS:

	STA. 0+14.60 TO 16+00	STA. 16+00 TO 40+00
AGGREGATE PLACEMENT AFTER:		
FIRST LIFT OF SURFACE COURSE	5 FT	8 FT
FINAL LIFT OF SURFACE COURSE	8 FT	8 FT

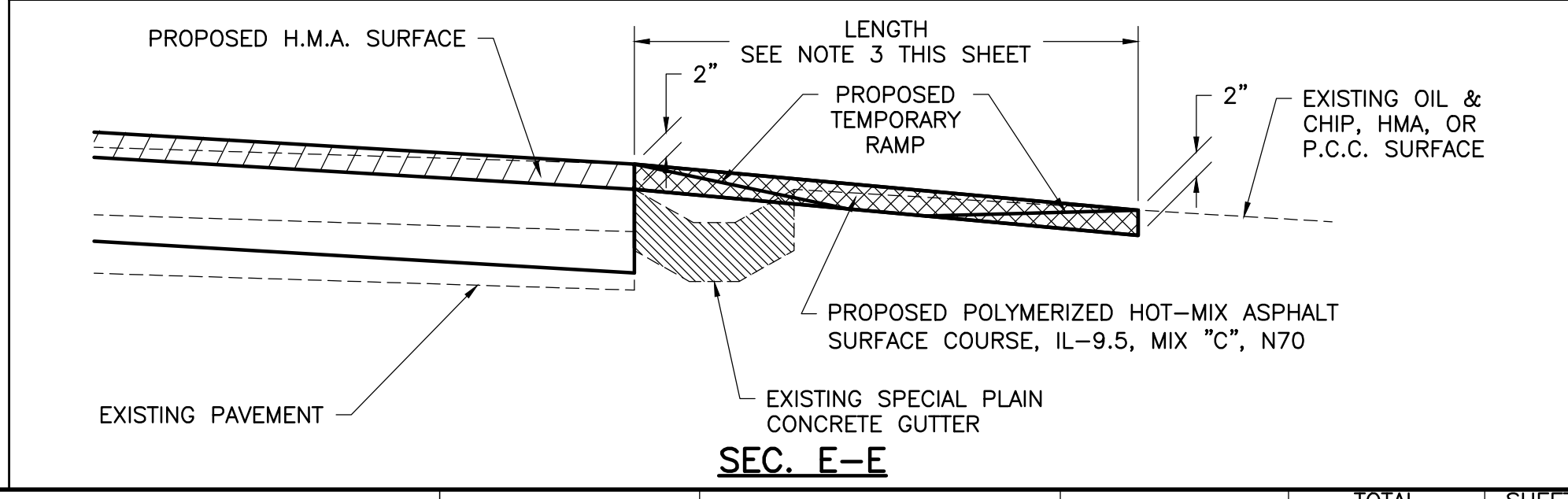
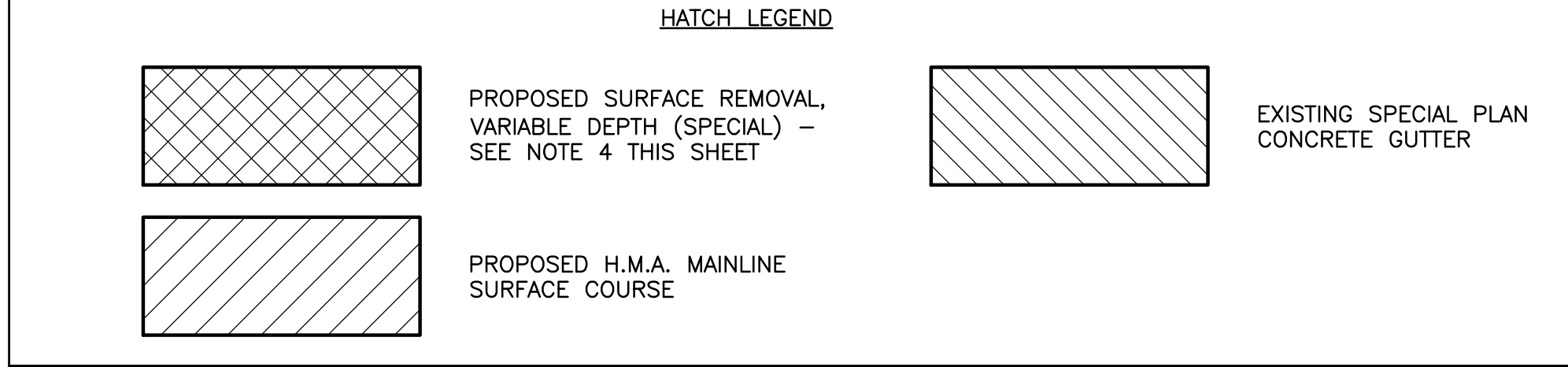

CHARLESTON ENGINEERING, INC.
 CONSULTING ENGINEERS - LAND SURVEYORS
 105 NORTH KITCHELL AVENUE OLNEY, ILLINOIS 62450
 P.O. BOX 397 (618) 392-0736
 ILLINOIS DEPARTMENT OF PROFESSIONAL REGULATION REGISTRATION #184.003513

DESIGNED - BMB	REVISED -
DRAWN - BMB	REVISED -
CHECKED - BMB	REVISED -
DATE - 1-2022	REVISED -

STATE OF ILLINOIS
 DEPARTMENT OF TRANSPORTATION

ENTRANCE DETAILS

ROUTE	SECTION	COUNTY	TOTAL SHEETS	SHEET NO.
FAS 801	21-00128-00-FP	RICHLAND	11	9
CONTRACT 95925		ILLINOIS	PROJECT SDE2(930)	

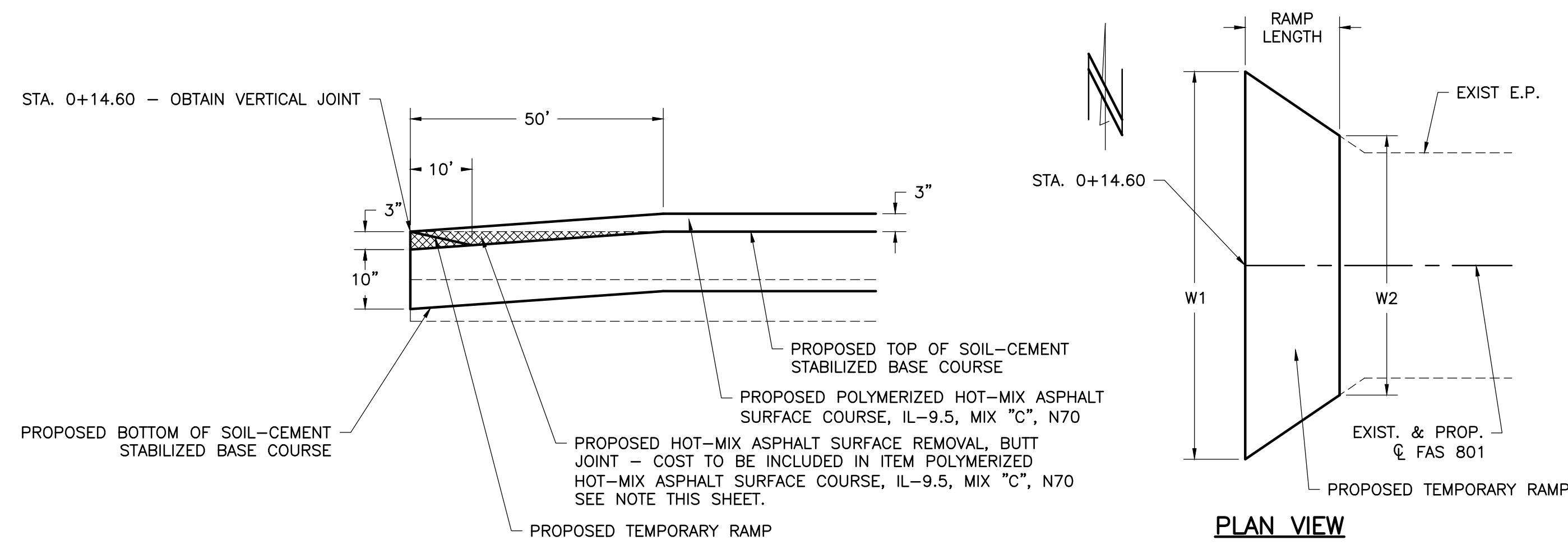

SECTION VIEW

PLAN VIEW

HATCH LEGEND

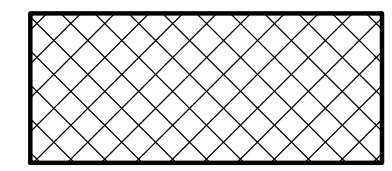

PROPOSED HMA SURFACE REMOVAL, BUTT JOINT - SEE NOTE THIS SHEET

TEMPORARY RAMP
AFTER 3" BUTT JOINT REMOVAL
AFTER FIRST 1 1/2" S.C. LIFT

RAMP LENGTH(FT)	W1(FT)	W2(FT)	SQ_YD
15	68	35	90
10	68	40	60
			TOTAL 150 SQ YD

NOTE

ALL PROPOSED HOT-MIX ASPHALT SURFACE, BUTT JOINT SHALL BE INCIDENTAL TO ITEM POLYMERIZED HOT-MIX ASPHALT SURFACE COURSE, IL 9.5, MIX "C", N70. SEE "POLYMERIZED HOT-MIX ASPHALT SURFACE COURSE, IL-9.5, MIX "C", N70 SPECIAL PROVISIONS.

BUTT JOINT DETAIL

STA. 0+14.60
NOT TO SCALE

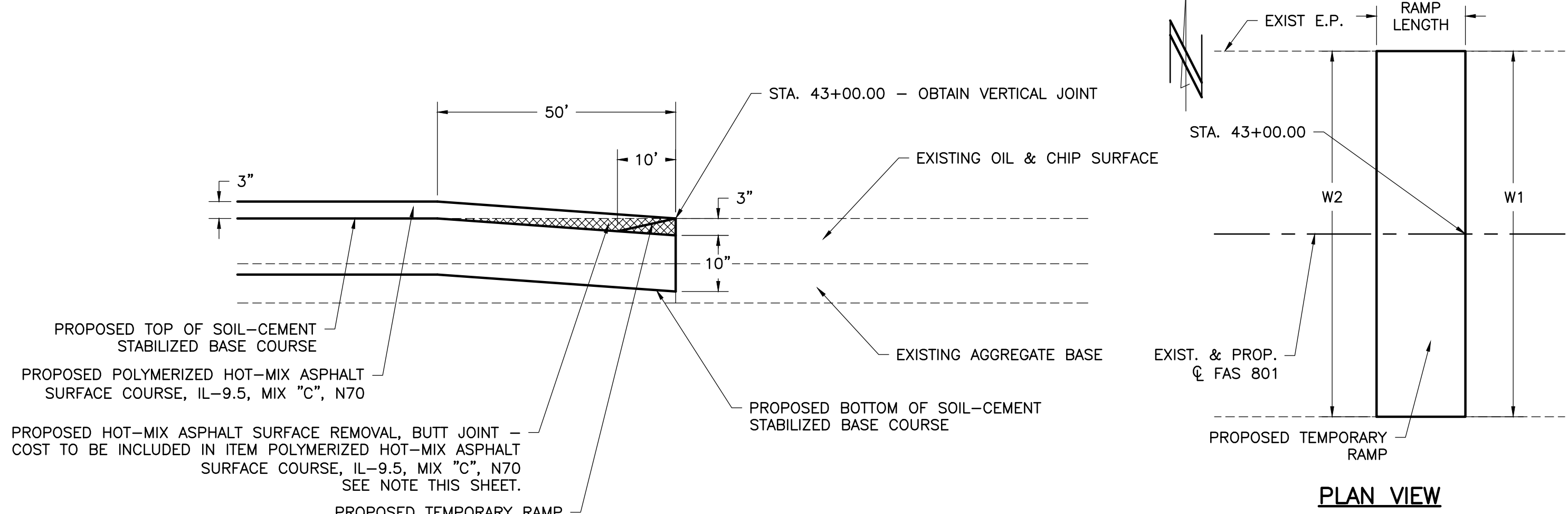

SECTION VIEW

PLAN VIEW

HATCH LEGEND

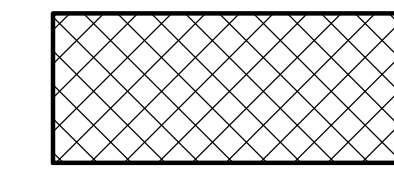

PROPOSED HMA SURFACE REMOVAL, BUTT JOINT - SEE NOTE THIS SHEET

TEMPORARY RAMP
AFTER 3" BUTT JOINT REMOVAL
AFTER FIRST 1 1/2" S.C. LIFT

RAMP LENGTH(FT)	W1(FT)	W2(FT)	SQ_YD
15	24	24	40
10	24	24	30
			TOTAL 70 SQ YD

NOTE

ALL PROPOSED HOT-MIX ASPHALT SURFACE, BUTT JOINT SHALL BE INCIDENTAL TO ITEM POLYMERIZED HOT-MIX ASPHALT SURFACE COURSE, IL 9.5, MIX "C", N70. SEE "POLYMERIZED HOT-MIX ASPHALT SURFACE COURSE, IL-9.5, MIX "C", N70 SPECIAL PROVISIONS.

BUTT JOINT DETAIL

STA. 43+00.00
NOT TO SCALE

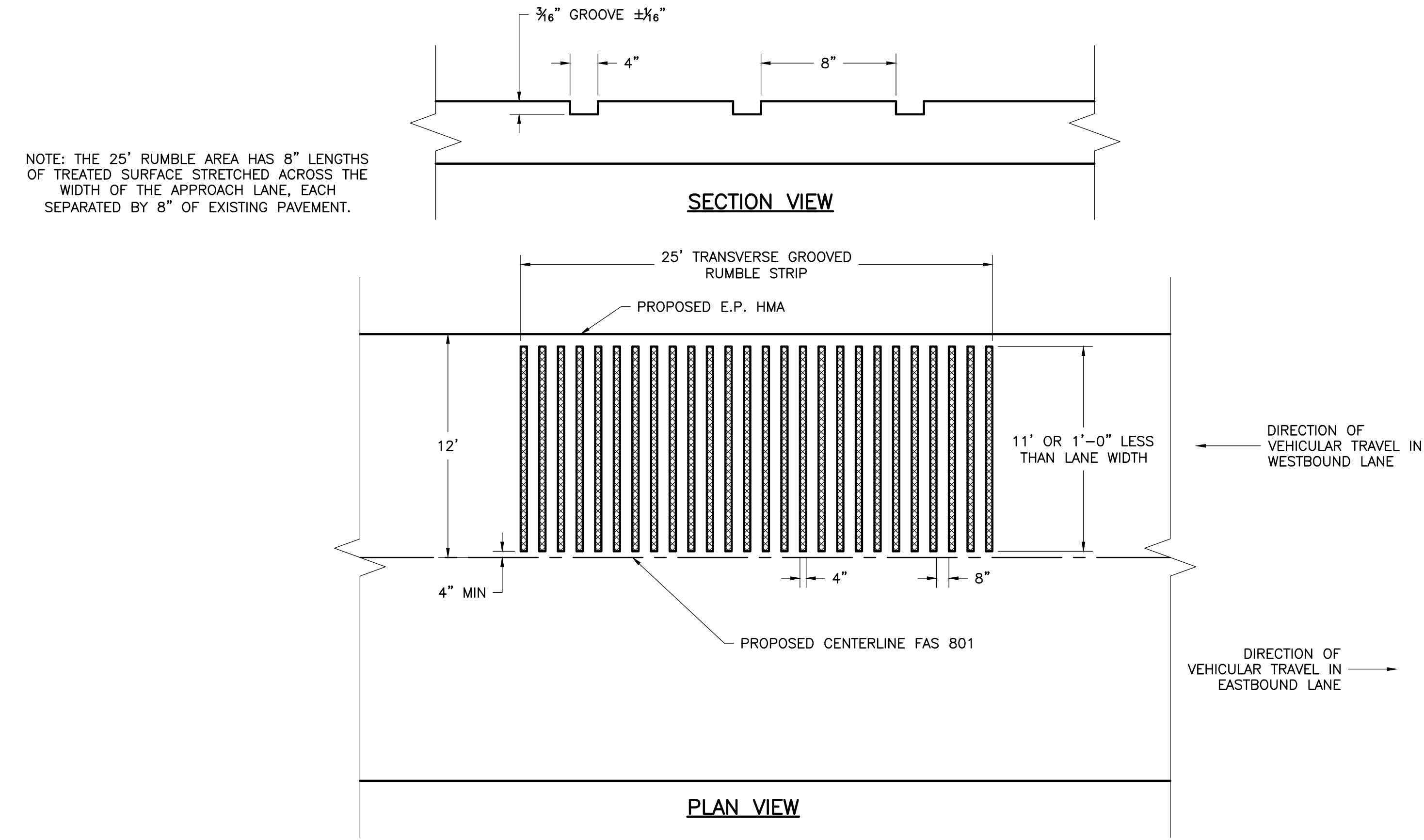

SECTION VIEW

PLAN VIEW

NOTE: THE 25' RUMBLE AREA HAS 8" LENGTHS OF TREATED SURFACE STRETCHED ACROSS THE WIDTH OF THE APPROACH LANE, EACH SEPARATED BY 8" OF EXISTING PAVEMENT.

RUMBLE STRIP DETAIL (GROOVED)
NOT TO SCALE

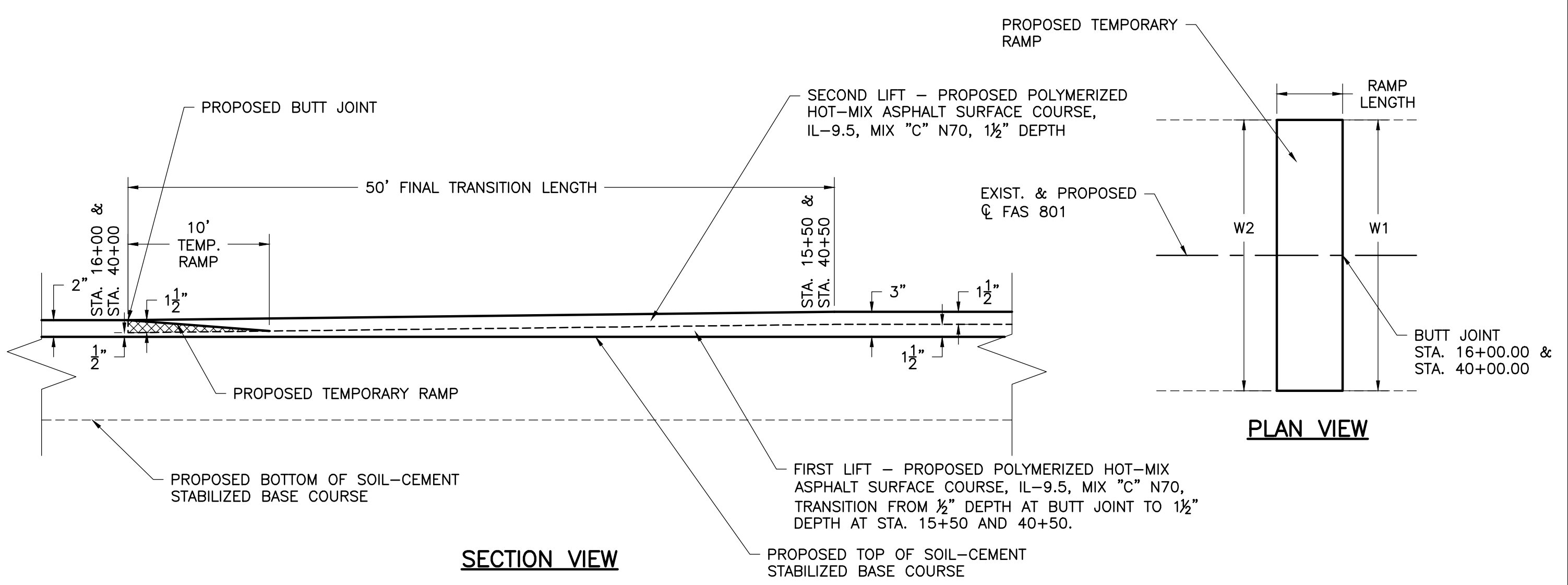

SECTION VIEW

PLAN VIEW

TEMPORARY RAMP

STA. 16+00
STA. 40+00

RAMP LENGTH(FT)	W1(FT)	W2(FT)	SQ_YD
10	37	37	42
10	24	24	27
			TOTAL 69 SQ YD

NOTE

ALL PROPOSED HOT-MIX ASPHALT SURFACE, BUTT JOINT SHALL BE INCIDENTAL TO ITEM POLYMERIZED HOT-MIX ASPHALT SURFACE COURSE, IL 9.5, MIX "C", N70. SEE "POLYMERIZED HOT-MIX ASPHALT SURFACE COURSE, IL-9.5, MIX "C", N70 SPECIAL PROVISIONS.

H.M.A. TRANSITION DETAIL

NOT TO SCALE

HATCH LEGEND

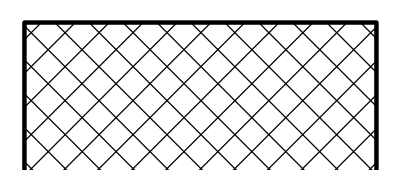

PROPOSED HMA SURFACE REMOVAL, BUTT JOINT - SEE NOTE THIS SHEET

CHARLESTON ENGINEERING, INC.
CONSULTING ENGINEERS - LAND SURVEYORS
105 NORTH KITCHELL AVENUE
P.O. BOX 397
OLNEY, ILLINOIS 62450
(618) 392-0736
ILLINOIS DEPARTMENT OF PROFESSIONAL REGULATION REGISTRATION #184.003513

DESIGNED - BMB	REVISED -
DRAWN - BMB	REVISED -
CHECKED - BMB	REVISED -
DATE - 1-2022	REVISED -

STATE OF ILLINOIS
DEPARTMENT OF TRANSPORTATION

MISCELLANEOUS DETAILS

ROUTE	SECTION	COUNTY	TOTAL SHEETS	SHEET NO.
FAS 801	21-00128-00-FP	RICHLAND	11	10
CONTRACT 95925		ILLINOIS	PROJECT SDE2(930)	

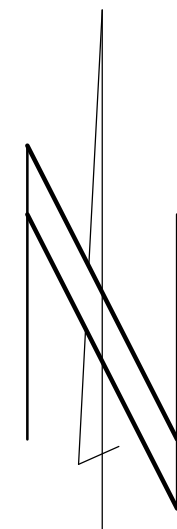

SCALE:
N.T.S.

LEGEND

- ROAD CLOSED TO ALL TRAFFIC DURING CONSTRUCTION HOURS (BLR 21)
- ROAD CLOSED TO THRU TRAFFIC OUTSIDE CONSTRUCTION HOURS (BLR 22)
- () MULTIPLE TRAFFIC CONTROL SIGNS - NUMBER DENOTES TYPE
- () SEE TRAFFIC CONTROL SIGN LEGEND THIS SHEET
- () SINGLE TRAFFIC CONTROL SIGN, NUMBER DENOTES TYPE
- TYPE III BARRICADE W/ AMBER FLASHING LIGHTS
- TRAFFIC CONTROL SIGN - SINGLE POST MOUNTED

TRAFFIC CONTROL SIGN LEGEND					
SIGN NUMBER	SIGN DESCRIPTION	SIGN DESIGNATION	SIGN SIZE	AMBER FLASHER	18" X 18" ORANGE FLAG
1	ROAD CLOSED	R11-2	48" X 30"	2	0
2	8 MILES AHEAD	W12-1101	24" X 18"	0	0
3	3 MILES AHEAD	W12-1101	24" X 18"	0	0
4	ROAD CLOSED AHEAD	W20-3	36" X 36"	1	1
5	ADVANCE TURN ARROW (RIGHT)	M5-1 R	21" X 15"	0	0
6	DIRECTIONAL ARROW (RIGHT)	M6-1	21" X 15"	0	0
7	ADVANCE TURN ARROW (LEFT)	M5-1 L	21" X 15"	0	0
8	DIRECTIONAL ARROW (LEFT)	M6-1	21" X 15"	0	0

NOTES:

1. SEE SPECIAL PROVISIONS FOR ADDITIONAL TRAFFIC CONTROL SIGNING DETAILS.
2. SEE SPECIAL PROVISIONS AND STANDARD BLR 21 AND BLR 22 FOR ADDITIONAL SIGNS REQUIRED BY THE TRAFFIC CONTROL PLAN. BLR 21 AND BLR 22 TRAFFIC CONTROL DEVICES NOT SHOWN ON THIS SHEET FOR CLARITY PURPOSES.
3. THE ENGINEER WILL FIELD STAKE THE LOCATIONS OF ANY SIGNS IF REQUESTED BY THE CONTRACTOR IN WRITING AT LEAST THREE WEEKS PRIOR TO THE INSTALLATION OF TRAFFIC CONTROL SIGNING.
4. LONGITUDINAL DIMENSIONS SHOWN MAY BE ADJUSTED IN THE FIELD TO FIT EXISTING CONDITIONS.
5. THE FOLLOWING ILLINOIS DEPARTMENT OF TRANSPORTATION STANDARDS ARE APPLICABLE FOR THIS WORK:
 - 5.A. STANDARD 701001
 - 5.B. STANDARD 701006
 - 5.C. STANDARD 701011
 - 5.D. STANDARD 701201
 - 5.E. STANDARD 701301
 - 5.F. STANDARD 701306
 - 5.G. STANDARD 701901
 - 5.H. BLR 21
 - 5.I. BLR 22

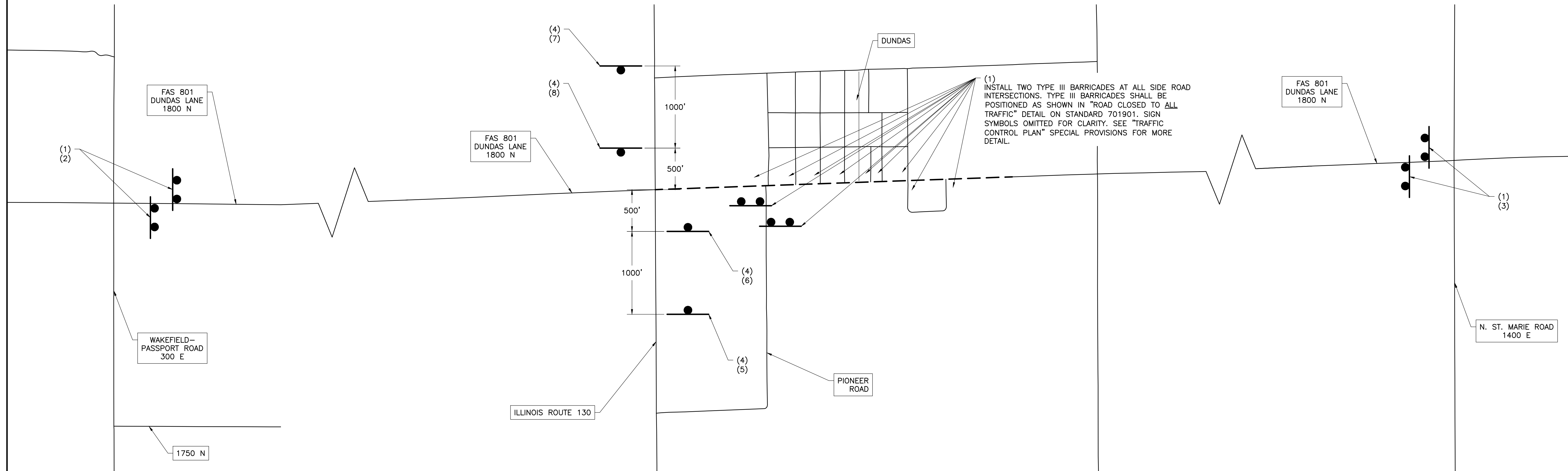

CHARLESTON ENGINEERING, INC.
CONSULTING ENGINEERS - LAND SURVEYORS
105 NORTH KITCHELL AVENUE
P.O. BOX 397
OLNEY, ILLINOIS 62450
(618) 392-0736
ILLINOIS DEPARTMENT OF PROFESSIONAL REGULATION REGISTRATION #184.003513

DESIGNED - BMB	REVISED -
DRAWN - BMB	REVISED -
CHECKED - BMB	REVISED -
DATE - 1-2022	REVISED -

STATE OF ILLINOIS
DEPARTMENT OF TRANSPORTATION

TRAFFIC CONTROL PLAN

ROUTE	SECTION	COUNTY	TOTAL SHEETS	SHEET NO.
FAS 801	21-00128-00-FP	RICHLAND	11	11
CONTRACT 95925		ILLINOIS	PROJECT SDE2(930)	