

STATE OF ILLINOIS  
DEPARTMENT OF TRANSPORTATION

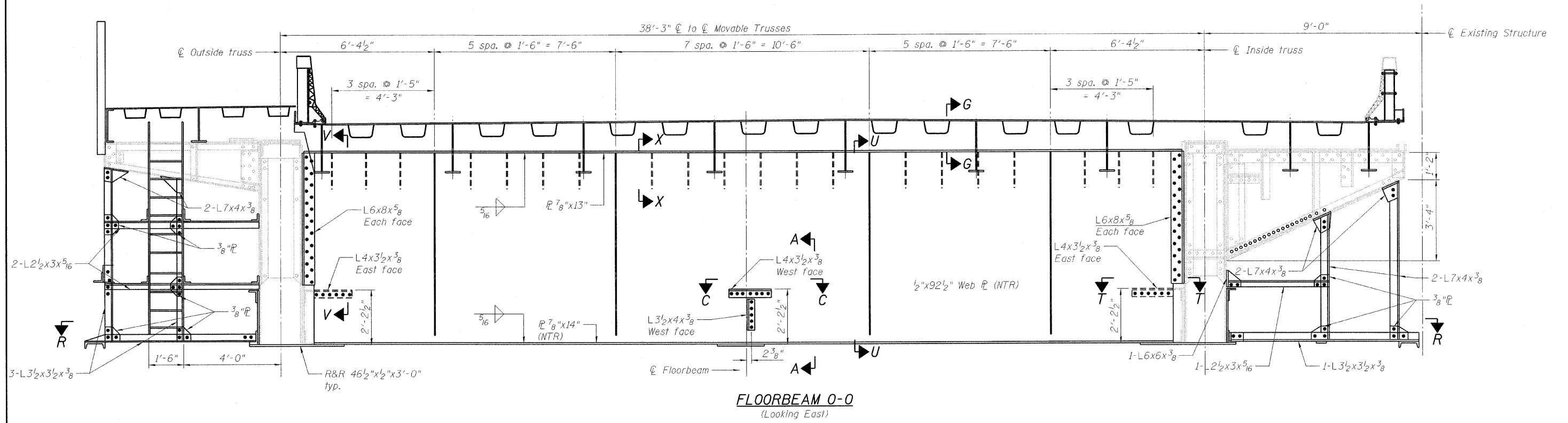

Notes:  
 For Section G-G, see sheet 58 of 163.  
 For Section U-U, V-V and X-X, see sheet 61 of 163.  
 For Sections A-A, C-C and T-T, see sheet 88 of 163.  
 For Section R-R, see sheet 61 of 163.  
 Load carrying components designated "NTR" shall conform to the supplemental requirements for Notch Toughness, Zone 2.

**LEGEND**

R&R	Remove & replace
○	Existing fastener to remain
○	Hole to match existing location
●	New hole
---	Existing member to remain
—	New member

**FLOORBEAM DETAILS**  
**NORTHWEST LEAF**  
**STRUCTURE NO. 016-2445**

DESIGNED	B. GILHOUSEN
CHECKED	J. GRAINAWI
DRAWN	D. C. PATEL
CHECKED	A. HAMMAD

T:\16843A\Structural\Cadd\Pre-final\EB\_Plans\0162445-60D61-079-FBE.dgn 17-JUN-2008 17:53

**PB Americas, Inc.**  
230 WEST MONROE STREET,  
SUITE 900  
CHICAGO, IL. 60606

SHEET NO. 79 163 SHEETS	F.A.P RTE.	SECTION	COUNTY	TOTAL SHEETS	SHEET NO.
	389	2424.2B-R	COOK	398	160
FED. ROAD DIST. NO. 7 ILLINOIS			CONTRACT NO. 60D61		
FED. AID PROJECT					