

STATE OF ILLINOIS
DEPARTMENT OF TRANSPORTATION
38'-3" ϕ to ϕ Trusses

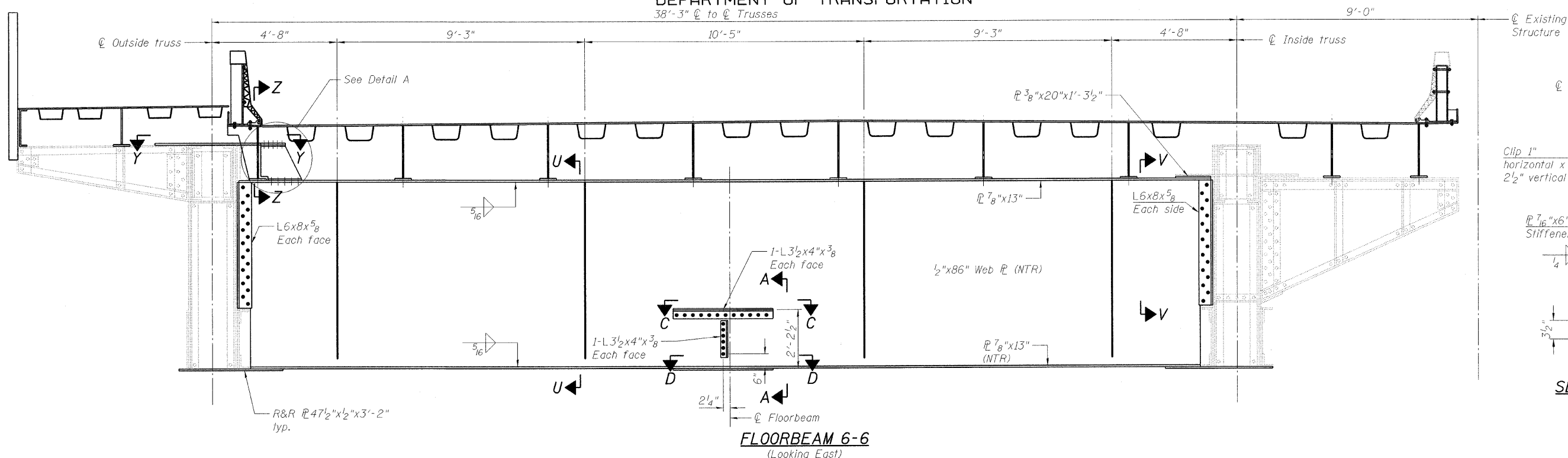

FLOORBEAM 6-6
(Looking East)

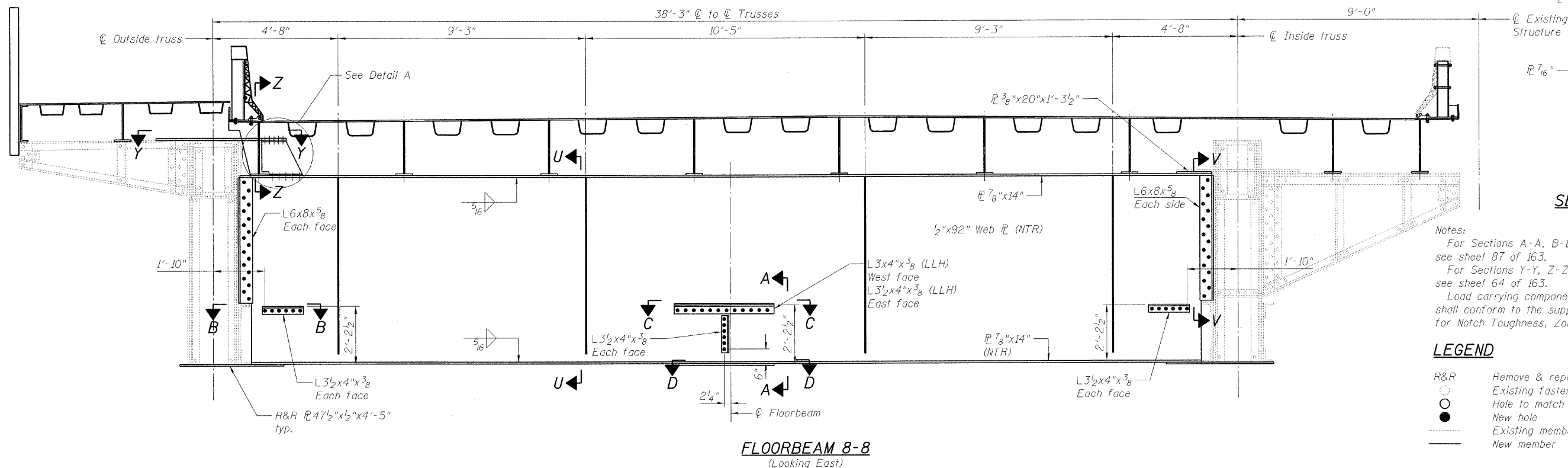

FLOORBEAM 8-8
(Looking East)

Notes:
For Sections A-A, B-B, C-C and D-D, see sheet 87 of 163.
For Sections Y-Y, Z-Z and Detail A, see sheet 64 of 163.
Load carrying components designated "NTR" shall conform to the supplemental requirements for Notch Toughness, Zone 2.

LEGEND
R&R Remove & replace
○ Existing fastener to remain
○ Hole to match existing location
● New hole
— Existing member to remain
— New member

**FLOORBEAM DETAILS
NORTHWEST LEAF
STRUCTURE NO. 016-2445**

DESIGNED	B. GILHOUSEN
CHECKED	J. GRAINAWI
DRAWN	D. C. PATEL
CHECKED	A. HAMMAD

SHEET NO. 81 163 SHEETS	F.A.P RTE.	SECTION	COUNTY	TOTAL SHEETS	SHEET NO.
	389	2424.2B-R	COOK	398	162
PB Americas, Inc. 230 WEST MONROE STREET, SUITE 900 CHICAGO, IL. 60606			CONTRACT NO. 60D61		
FED. ROAD DIST. NO. 7 ILLINOIS FED. AID PROJECT					

T:\1684\SA\Structural\Cadd\Pre-final\EB_Plans\0162445-60D61-FBE-078.dgn
07-MAY-2009