

SECTION A-A
SCALE: 1"=1'-0"

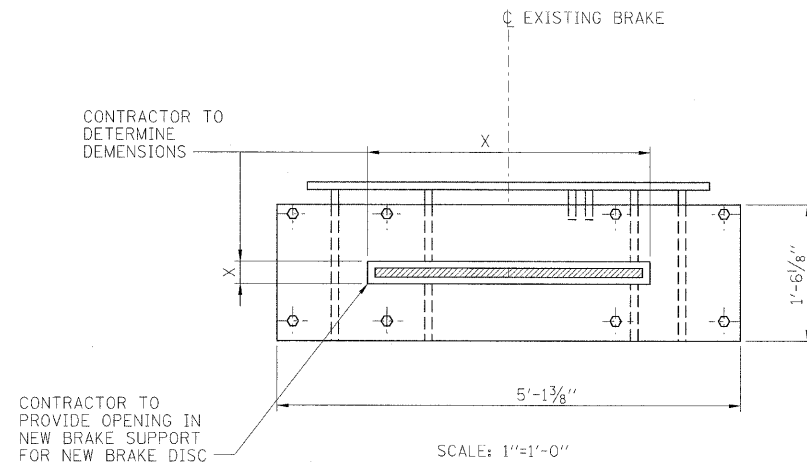

MACHINERY BRAKE SUPPORT ASSEMBLY
8 ASSEMBLIES REQUIRED

LEGEND:

- NEW MEMBER
- EXISTING MEMBER TO REMAIN

NOTES:

1. FOR GENERAL NOTES, SEE SHEET M-01.
2. WORK THIS DWG WITH SHEET M-08.
3. CONTRACTOR SHALL VERIFY ALL DIMENSIONS.
4. CONTRACTOR TO REMOVE EXISTING CAM LIMIT SWITCH GEARS ON THE EXISTING BRAKE SHAFT, BEFORE BRAKE INSTALLATION. EXISTING GEARS AND NEW KEYS SHALL BE INSTALLED AFTER BRAKE INSTALLATION.
5. C/C BOLTS SHALL BE 3/2" O/C TO EDGE DISTANCES SHALL BE PER AASHTO STANDARD SPECIFICATIONS.
6. NEW BRAKE DISC MATERIAL SHALL BE ASTM A874 LOW TEMPERATURE DUCTILE IRON AT 25 FT.LBS AT 40°F.
7. ALL STEEL FOR MACHINERY SUPPORT SHALL CONFORM TO ASTM A709, GRADE 50.
8. NEW BRAKE DISC SHALL BE BORE FINISHED. THE BORE DIAMETER SHALL BE DETERMINED BY CONTRACTOR.

PB Americas, Inc.
230 WEST MONROE STREET,
SUITE 900
CHICAGO, IL. 60606

USER NAME = sharma	DESIGNED - V. LEVIT	REVISED -
FILE NAME = D160d61-sh1-mec-09.dgn	DRAWN - V. LEVIT	REVISED -
PLOT SCALE = NONE	CHECKED - D. NYARKO	REVISED -
PLOT DATE = 5/7/2009	DATE - MAY 8, 2009	REVISED -

**STATE OF ILLINOIS
DEPARTMENT OF TRANSPORTATION**

MACHINERY BRAKE SUPPORT DETAILS

SCALE: AS SHOWN SHEET NO. M-09 OF M-27 SHEETS STA. 379+06.09 TO STA. 382+45.28

F.A.P. RTE.	SECTION	COUNTY	TOTAL SHEETS	SHEET NO.
389	2424-2B-R	COOK	398	253
CONTRACT NO. 60D61			FED. ROAD DIST. NO. 1 ILLINOIS FED. AID PROJECT	