

EXISTING LIGHTING
SCALE: 1" = 50'-0"

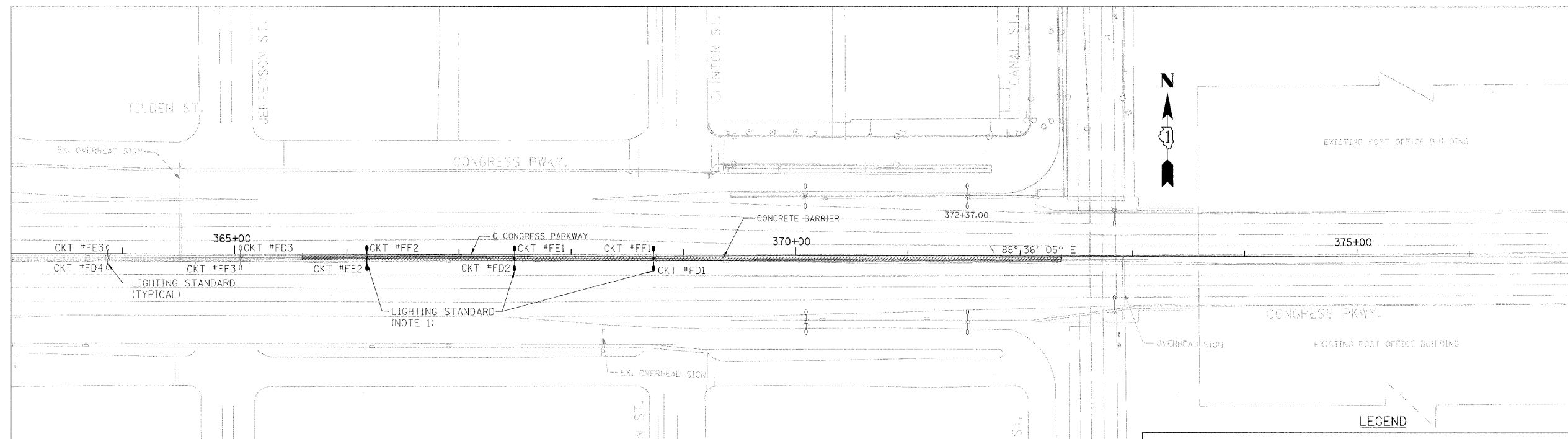

NEW LIGHTING
SCALE: 1" = 50'-0"

CIRCUIT DESIGNATION:

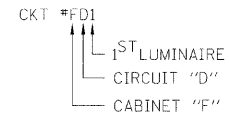

NOTES:

1. REPLACE EXISTING LIGHTING STANDARD WITH NEW LIGHTING STANDARD FOR PERMANENT INSTALLATION. EXISTING LIGHTING STANDARD SHALL BE TURNED OVER TO IDOT. NEW LIGHTING STANDARD SHALL BE POWERED FROM EXISTING CIRCUIT AS SHOWN ON THIS DRAWING WITH NEW PERMANENT WIRING. REFER TO STRUCTURAL DRAWINGS FOR PERMANENT LIGHTING STANDARD MOUNTING DETAILS.

- LEGEND**
- NEW TWIN ARM LIGHTING STANDARD
 - EXISTING TWIN ARM LIGHTING STANDARD
 - EXISTING SINGLE ARM LIGHTING STANDARD

MATCH LINE STA. 377+00.00

MATCH LINE STA. 377+00.00

PB Americas, Inc.
230 WEST MONROE STREET,
SUITE 900
CHICAGO, IL. 60606

USER NAME = sharma	DESIGNED - D. RAFFINGTON	REVISED -
FILE NAME = D:\60D61-ehf-elo-63.dgn	DRAWN - S. SHARMA	REVISED -
PLOT SCALE = NONE	CHECKED - M. INTATANO	REVISED -
PLOT DATE = 5/7/2009	DATE - MAY 8, 2009	REVISED -

STATE OF ILLINOIS
DEPARTMENT OF TRANSPORTATION

CONSTRUCTION STAGING
EXISTING AND NEW ROADWAY LIGHTING
SCALE: AS SHOWN SHEET NO. E-63 OF E-125 SHEETS STA. 379+06.09 TO STA. 382+45.28

F.A.P. RTE.	SECTION	COUNTY	TOTAL SHEETS	SHEET NO.
389	2424-2B-R	COOK	398	334
CONTRACT NO. 60D61			FED. ROAD DIST. NO. 1 [ILLINOIS] FED. AID PROJECT	