

NOTES

1. ALL FINAL PAVEMENT MARKINGS SHALL BE PLACED IN ACCORDANCE WITH DISTRICT ONE TYPICAL PAVEMENT MARKINGS (TC-13) DETAIL.
2. ALL FINAL RAISED REFLECTIVE PAVEMENT MARKERS SHALL BE PLACED IN ACCORDANCE WITH THE DISTRICT ONE RAISED REFLECTIVE PAVEMENT MARKERS (TC-11) DETAIL.
3. ALL FINAL PATCHING LOCATIONS SHALL BE DETERMINED IN THE FIELD BY THE RESIDENT ENGINEER.
4. BETWEEN THE STATION 11+97 AND STATION 110+73, ALL PATCHES SHALL BE CLASS B, WITH THE EXCEPTION OF LANE 2 (MIDDLE LANE) AND INTERSECTIONS WHICH SHALL USE PRECAST CONCRETE PAVEMENT SLABS. BETWEEN STATION 110+73 AND 181+86, ALL PATCHES SHALL BE CLASS D.

PAVEMENT MARKINGS LEGEND

- | | |
|---|--|
| ① POLYUREA PAVT MK, 4" DOUBLE YELLOW LINE (TYP.) | ⑥ POLYUREA PAVT MK, 8" WHITE LINE (TYP.) |
| ② POLYUREA PAVT MK, 4" YELLOW EDGE LINE (TYP.) | ⑦ POLYUREA PAVT MK, 12" WHITE DIAGONALS @45° (TYP.) |
| ③ POLYUREA PAVT MK, 4" WHITE LANE LINE (10'-30' SKIP DASH) (TYP.) | ⑧ POLYUREA PAVT MK, 12" YELLOW DIAGONALS (TYP.) @ 75 C-C |
| ④ POLYUREA PAVT MK, 6" WHITE LINE (TYP.) | ⑨ POLYUREA PAVT MK, 24" WHITE STOP BAR (TYP.) |
| ⑤ POLYUREA PAVT MK, 6" DOTTED LINES (2'-6' SKIP DASH) (TYP.) | ⑩ POLYUREA PAVT MK, LETTERS AND SYMBOLS (TYP.) |

LEGEND

- | | |
|--|--|
| | PROP. HMA SURFACE REMOVAL - BUTT JOINT
SEE BUTT JOINT AND HMA TAPER DETAILS (BD-29) |
| | PROP. PCC SURFACE REMOVAL - BUTT JOINT
SEE BUTT JOINT AND HMA TAPER DETAILS (BD-32) |
| | PROP. PROFILE DIAMOND GRINDING OF CONCRETE PAVEMENT LIMITS |

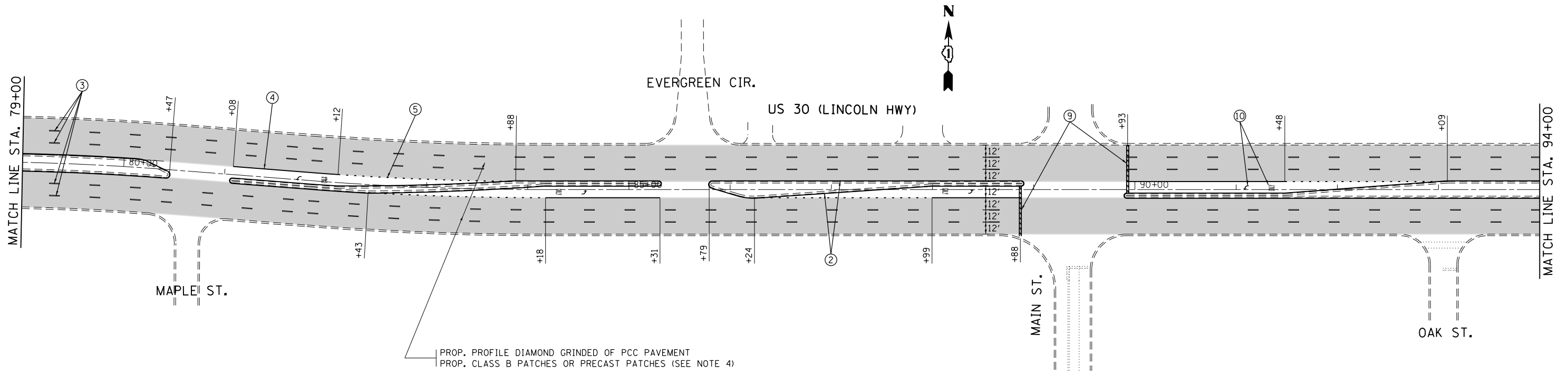

PROP. PROFILE DIAMOND GRINDING OF PCC PAVEMENT
PROP. CLASS B PATCHES OR PRECAST PATCHES (SEE NOTE 4)

FILE NAME =	USER NAME = dettmanna	DESIGNED -	REVISED -
c:\pwork\pwork\dettmanna\d0230696\0006111-sh1-plan.dgn		DRAWN -	REVISED -
		CHECKED -	REVISED -
		DATE -	REVISED -

**STATE OF ILLINOIS
DEPARTMENT OF TRANSPORTATION**

**US RTE. 30 (LINCOLN HWY.) (CICERO AVE. TO WESTERN AVE.)
ROADWAY AND PAVEMENT MARKING PLAN**

SCALE: 1"=50' SHEET NO. 3 OF 8 SHEETS STA. 64+00 TO STA. 94+00

F.A.P. RTE.	SECTION	COUNTY	TOTAL SHEETS	SHEET NO.
353	23R-R5	COOK	66	17
CONTRACT NO. 60L94				
ILLINOIS FED. AID PROJECT				