

EXISTING TYPICAL SECTION  
IL 137  
STATION:  
4+74 TO 45+80

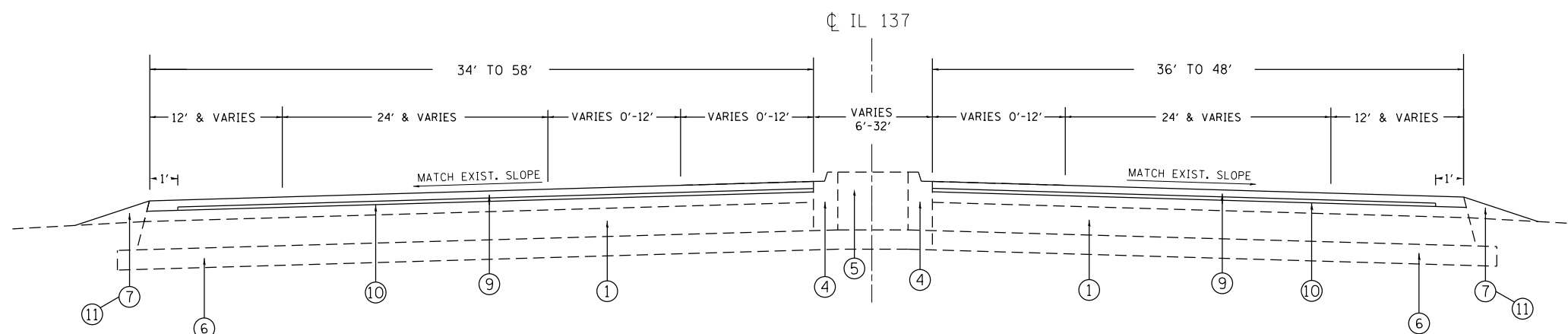

PROPOSED TYPICAL SECTION  
IL 137  
STATION:  
4+74 TO 45+80

**NOTES:**

1. SEE ROADWAY AND PAVEMENT MARKING PLAN SHEETS FOR LOCATIONS OF LEFT TURN LANES AND PAINTED MEDIANS.
2. MILLING TO BE DONE PRIOR TO PATCHING.  
(SEE 'PAVEMENT PATCHING FOR HMA SURFACED PAVEMENT' DETAIL).
3. COMBINATION CONCRETE CURB AND GUTTER REMOVAL AND REPLACEMENT WILL BE DONE BETWEEN STATIONS: 5+35 TO 8+60, 13+49 TO 14+22, 15+16 TO 19+62 & 26+60 TO 28+85 (RIGHT SIDE ONLY)

**LEGEND**

- ① EXIST. PCC BASE COURSE, 8''(±)
- ② EXIST. HOT-MIX ASPHALT SURFACE (BEFORE MILLING), 6''(±)
- ③ EXIST. AGGREGATE SHOULDER TYPE B
- ④ EXIST. CONCRETE CURB AND GUTTER TYPE M-6.06
- ⑤ EXIST. STABILIZED MEDIAN 12''(±)
- ⑥ EXIST. HOT-MIX ASPHALT SUBBASE MATERIAL 4''(±)
- ⑦ PROP. AGGREGATE WEDGE SHOULDER, TYPE B
- ⑧ PROP. HOT-MIX ASPHALT SURFACE REMOVAL - 2 1/2''
- ⑨ PROP. POLYMERIZED HOT-MIX ASPHALT SURFACE COURSE, MIX "F", N90, 1 3/4''
- ⑩ PROP. POLYMERIZED LEVELING BINDER (MM), IL-4.75, N50, 3/4''
- ⑪ PROP. GRADING AND SHAPING SHOULDERS

**HOT-MIX ASPHALT MIXTURE REQUIREMENTS**

	MIXTURE TYPE	AIR VOIDS (%) @ NDES	QMP
ROADWAY	POLYMERIZED HOT-MIX ASPHALT SURFACE COURSE, MIX "F", N90, (IL-9.5MM), 1 3/4''	4% @ 90 GYR	QCP
	POLYMERIZED LEVELING BINDER (MM), IL-4.75, N50, 3/4''	3.5% @ 50 GYR	QCP
PATCHES	CLASS D PATCHES (HMA BINDER IL-19 mm)	4% @ 70 GYR	QC/QA
QMP DESIGNATION: QUALITY CONTROL/ QUALITY ASSURANCE (QC/QA); QUALITY CONTROL FOR PERFORMANCE (QCP)			

THE UNIT WEIGHT USED TO CALCULATE ALL HMA SURFACE MIXTURE QUANTITIES IS 112 LBS/SQ YD/IN.

THE "AC TYPE" FOR ALL POLYMERIZED HMA MIXES SHALL BE "SBS/SBR PG 76-22 AND FOR NON-POLYMERIZED HMA THE "AC TYPE" SHALL BE PG 64-22" UNLESS MODIFIED BY DISTRICT ONE SPECIAL PROVISIONS. FOR USE OF RECYCLED MATERIALS SEE DISTRICT ONE SPECIAL PROVISIONS.

QUALITY MANAGEMENT PROGRAM (QMP) COLUMN IDENTIFIES THE TYPE OF SPECIFICATION THAT APPLIES TO THE HMA MIXTURE