

WORK SHALL MEET THE REQUIREMENTS OF THE SPECIAL PROVISION, "TRAFFIC SIGNAL SIGNAL SPECIFICATIONS FOR DETECTOR LOOP REPLACEMENT AND/OR INSTALLATION ON ROADWAY GRINDING, RESURFACING AND PATCHING OPERATIONS". SPECIAL ATTENTION MUST BE MADE TO THE SECTIONS "INSPECTION OF CONSTRUCTION" AND "DETECTOR LOOP REPLACEMENT" FOR INSTALLATION AND INSPECTION REQUIREMENTS. LOOP REPLACEMENT WORK THAT DOES NOT MEET THE CONTRACT REQUIREMENTS SHALL NOT BE PAID. WORK NECESSARY TO COMPLETE THE LOOP REPLACEMENT WORK MAY BE ASSIGNED BY THE ENGINEER TO IDOT'S ELECTRICAL MAINTENANCE CONTRACTOR (EMC); ALL RELATED COSTS WILL BE THE RESPONSIBILITY OF THE CONTRACTOR.

TRAFFIC SIGNAL LEGEND

	PROPOSED	EXISTING
SIGNAL HEAD WITH BACKPLATE	⬆	⬆
SIGNAL HEAD	⬆	⬆
GALVANIZED STEEL CONDUIT IN TRENCH OR PUSHED	---	---
DETECTOR LOOP	□	□
VEHICLE DETECTOR, NON COMPENSATED MAGNETIC TYPE	⊥	⊥
RACEWAY FOR MAGNETIC DETECTOR, TYPE I OR TYPE II	⊥	⊥

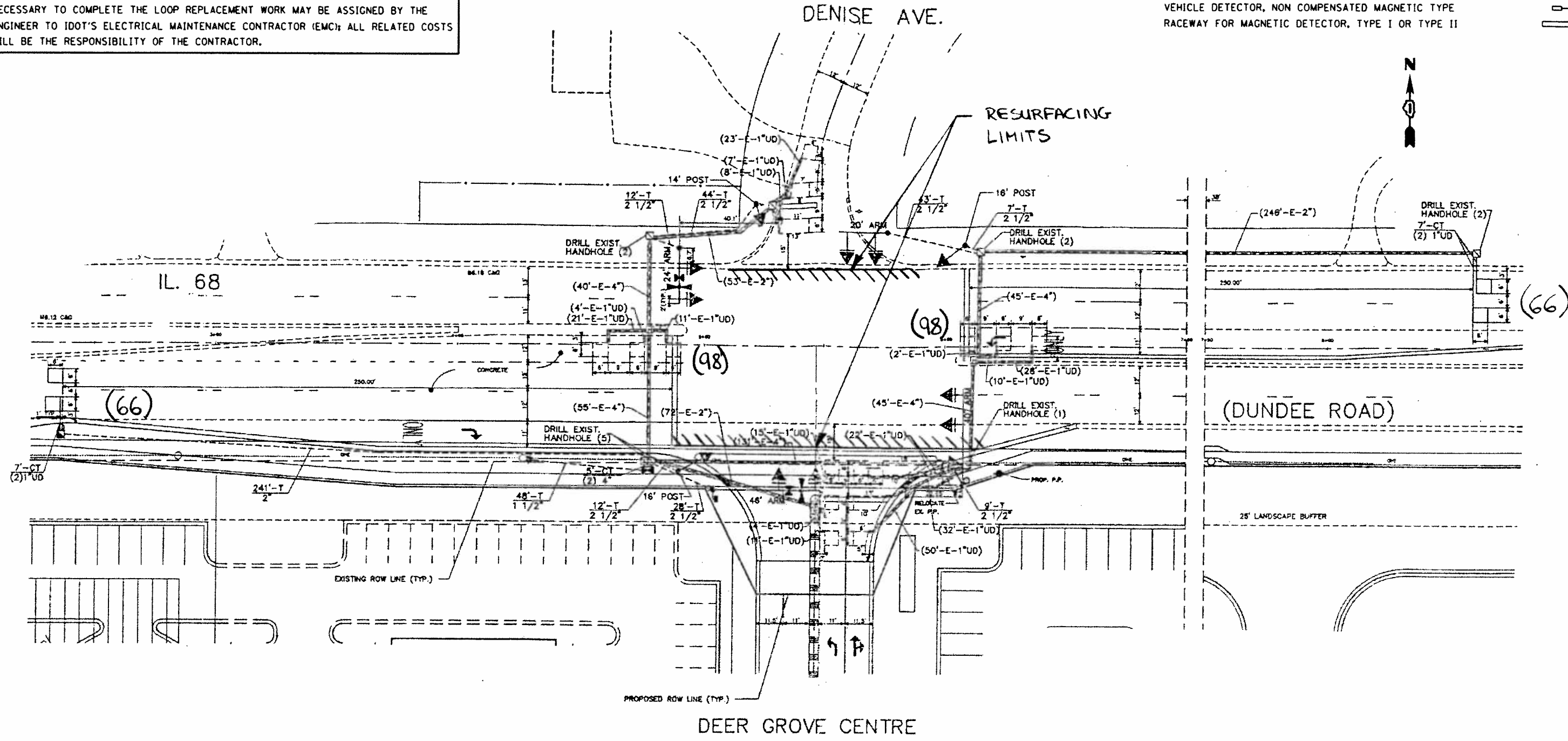

THIS PLAN IS FOR THE SOLE PURPOSE OF DETECTOR LOOP REPLACEMENTS ONLY

REPLACE ALL DETECTOR LOOPS AS SHOWN (WITHIN THE RESURFACING LIMITS)

CODE	QUANTITY	UNIT	ITEM
88600600	328	FOOT	DETECTOR LOOP REPLACEMENT

FILE NAME: DetectorLoop.dgn	USER NAME: jpooschul	DESIGNED: []	REVISED: []	STATE OF ILLINOIS DEPARTMENT OF TRANSPORTATION	DISTRICT ONE - DETECTOR LOOP REPLACEMENT IL RTE 68 (DUNDEE RD) AT DENISE AVE	F.A.P. RTE: 303	SECTION: (70 23045) A3-2	COUNTY: COOK	TOTAL SHEETS: 57	SHEET NO.: 38	
PLOT SCALE: 48.0000' / 1"	CHECKED: []	REVISED: []	REVISED: []			SCALE: NTS	SHEET NO. OF SHEETS: []	STA. TO STA.:	CONTRACT NO. 60T02		
PLOT DATE: 1/23/2012	DATE: []	REVISED: []	REVISED: []			FED. ROAD DIST. NO. [] ILLINOIS FED. AID PROJECT					