

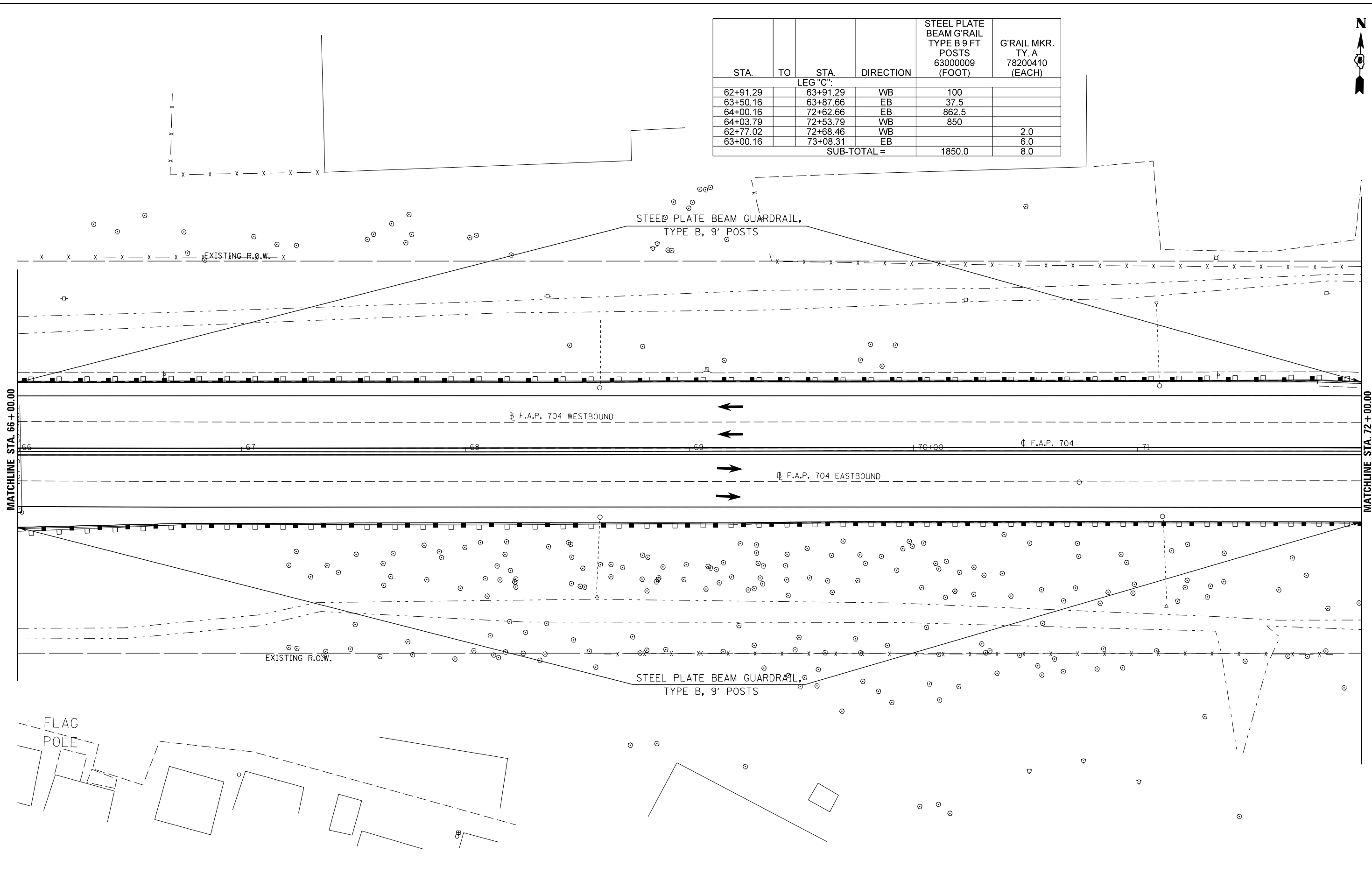

STA.	TO	STA.	DIRECTION	STEEL PLATE BEAM G'RAIL TYPE B 9 FT POSTS 63000009 (FOOT)	G'RAIL MKR. TY. A 78200410 (EACH)
LEG "C":					
62+91.29		63+91.29	WB	100	
63+50.16		63+87.66	EB	37.5	
64+00.16		72+62.66	EB	862.5	
64+03.79		72+53.79	WB	850	
62+77.02		72+68.46	WB		2.0
63+00.16		73+08.31	EB		6.0
SUB-TOTAL =				1850.0	8.0



FILE NAME =	USER NAME = dodgems	DESIGNED -	REVISED -
et:\pw\work\p\dot\dodgems\d0267571\0570838-sht\plan_BUS55.dgn		DRAWN -	REVISED -
	PLOT SCALE = 40.0000' / in.	CHECKED -	REVISED -
	PLOT DATE = 6/11/2014	DATE -	REVISED -

**STATE OF ILLINOIS
DEPARTMENT OF TRANSPORTATION**

GUARDRAIL PLAN SHEET

SCALE: 1" = 20' SHEET 4 OF 7 SHEETS STA. 66+00.00 TO STA. 72+00.00

F.A.P. RTE.	SECTION	COUNTY	TOTAL SHEETS	SHEET NO.
704	(57-7)RS-1&1RS-3	McLean	273	82
CONTRACT NO. 70838			ILLINOIS FED. AID PROJECT	