

F.A.P. RTE.	SECTION	COUNTY	TOTAL SHEETS	SHEET NO.
332	(12-B2)B-1	WABASH	68	1
		ILLINOIS	CONTRACT NO. 74219	

X68+1=69

D-97-006-07

STATE OF ILLINOIS  
DEPARTMENT OF TRANSPORTATION  
DIVISION OF HIGHWAYS

**PROPOSED  
HIGHWAY PLANS**

F.A.P. ROUTE 332 (IL 1)  
SECTION (12,B2)B-1

**BRIDGE REPLACEMENT  
WABASH COUNTY**

C-97-007-07

IL 1 OVER CRAWFISH CREEK

SHEET NO.	INDEX OF SHEETS
1	COVER SHEET
2	GENERAL NOTES AND STANDARDS
3-8A	SUMMARY OF QUANTITIES
9	ROADWAY TYPICAL SECTIONS & BUTT JOINT DETAIL
10-11	SCHEDULE OF QUANTITIES
12	ALIGNMENT, TIES, & BENCHMARKS
13-14	PLAN & PROFILE SHEETS
15-16	STAGE CONSTRUCTION PLANS
17	STAGE CONSTRUCTION DETAILS
18	EROSION CONTROL PLAN
19-20	DETAILS
21-51	BRIDGE PLANS
52-57	EXISTING STRUCTURE PLANS
58-68	CROSS-SECTIONS

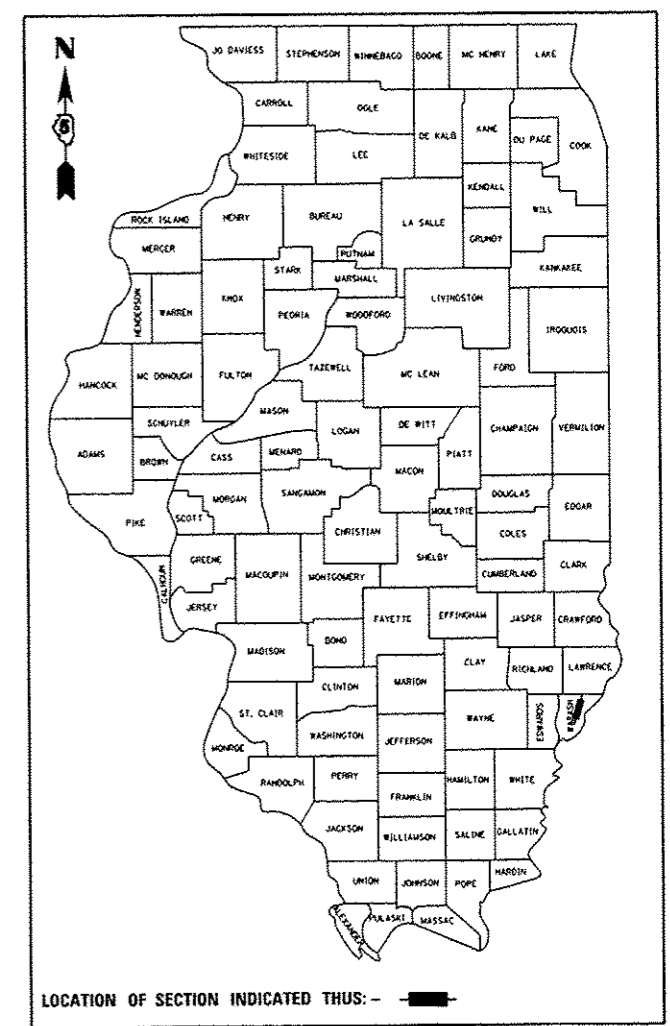

FUNCTIONAL CLASSIFICATION: OTHER PRINCIPAL ARTERIAL

DESIGN SPEED:	60 MPH
POSTED SPEED:	55 MPH
ADT:	3450 (2010)
PV:	89.5%
SU:	5.5%
MU:	5.0%

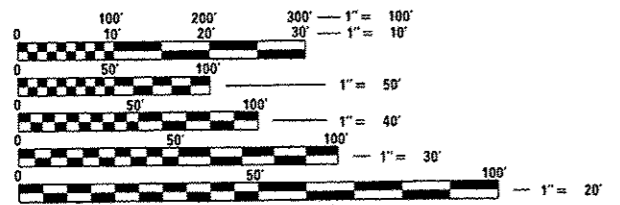

FULL SIZE PLANS HAVE BEEN PREPARED USING STANDARD ENGINEERING SCALES. REDUCED SIZED PLANS WILL NOT CONFORM TO STANDARD SCALES. IN MAKING MEASUREMENTS ON REDUCED PLANS, THE ABOVE SCALES MAY BE USED.

J.U.L.I.E.  
JOINT UTILITY LOCATION INFORMATION FOR EXCAVATION  
1-800-892-0123  
OR 811

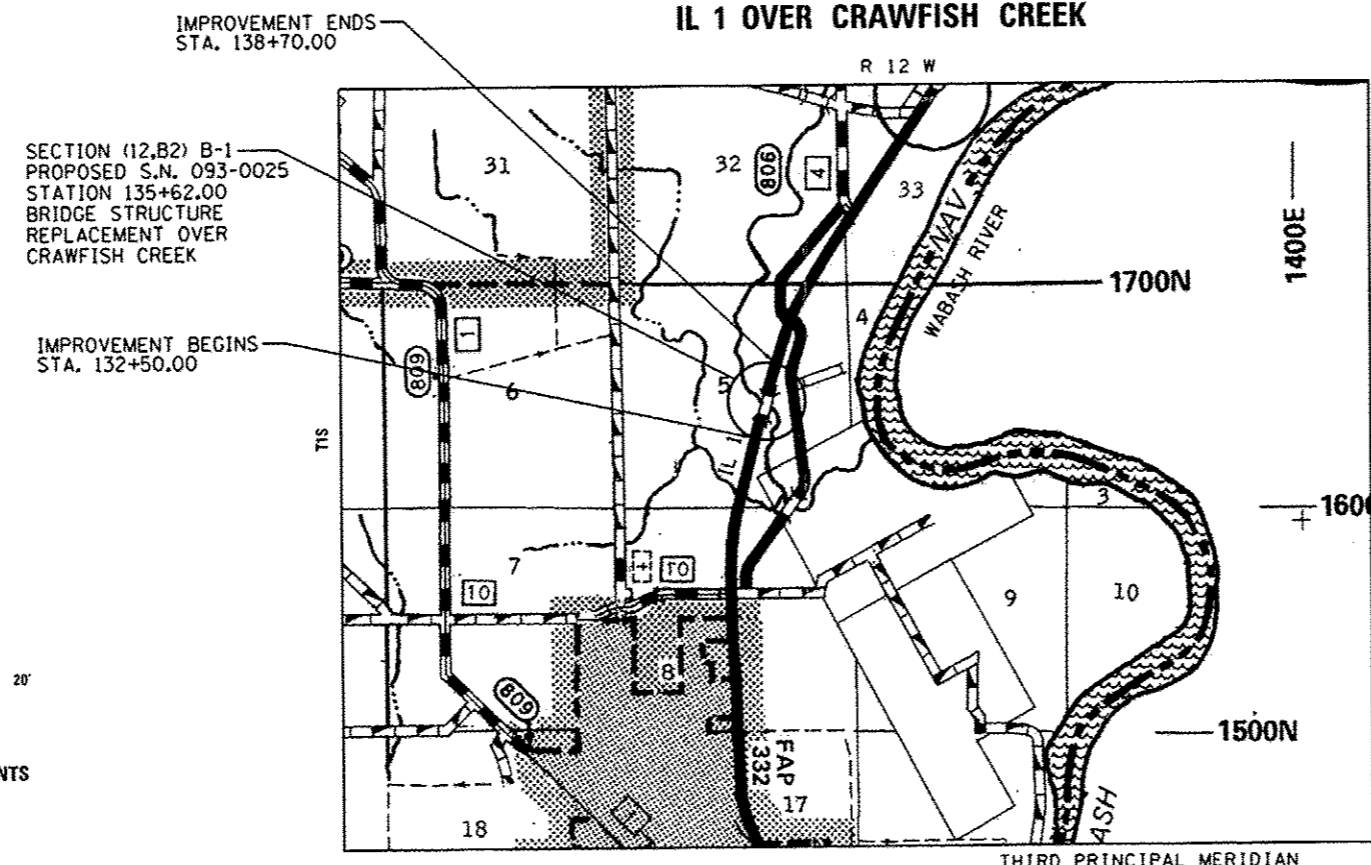

LOCATION MAP

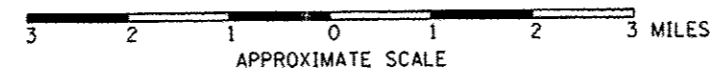

GROSS LENGTH = 620.00 FT. = 0.117 MI.  
NET LENGTH = 620.00 FT. = 0.117 MI.

PROJECT ENGINEER: TOM RONAN  
(217) 342-8320  
TOWNSHIP: MOUNT CARMEL  
CONTRACT NO. 74219

DESIGN DESIGNATION  
N.A.



*Michael T. Matzke*  
SIGNATURE  
June 5, 2014  
DATE

LIC. EXP. DATE: Nov. 30, 2015  
QUIGG ENGINEERING, INC.

STATE OF ILLINOIS  
DEPARTMENT OF TRANSPORTATION  
DIVISION OF HIGHWAYS

SUBMITTED JUNE 12 20 14  
*Roger L. Drishell*  
DEPUTY DIRECTOR OF HIGHWAYS, REGION ENGINEER

July 18 20 14  
*John D. Baranzelli* P.E.  
ENGINEER OF DESIGN AND ENVIRONMENT

July 18 20 14  
*Orner Osman* P.E.  
DIRECTOR OF HIGHWAYS, CHIEF ENGINEER

**PRINTED BY THE AUTHORITY  
OF THE STATE OF ILLINOIS**