

STATE OF ILLINOIS  
DEPARTMENT OF PUBLIC WORKS & BUILDINGS  
DIVISION OF HIGHWAYS

SECTION	COUNTY	SHEET NO.	TOTAL SHEETS
12-B-2	Wabash	11	6

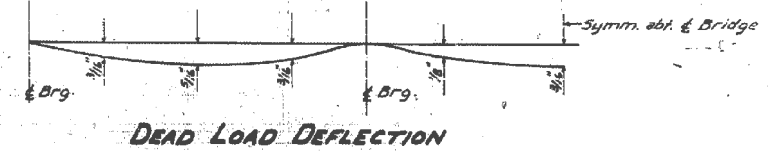

Note:  
Order 4 bars full length.  
Cut to fit skew and use remainder  
of bars in opposite end.

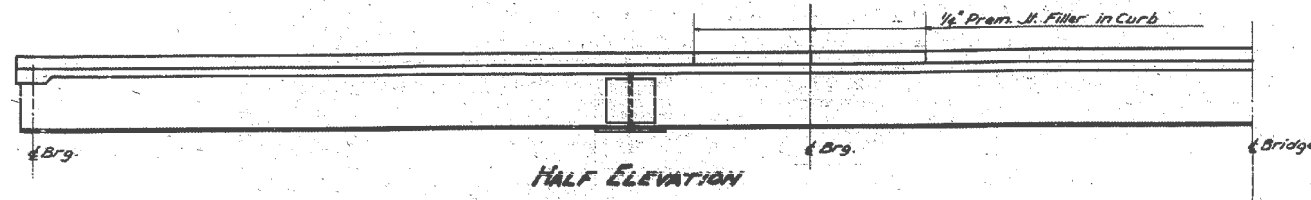
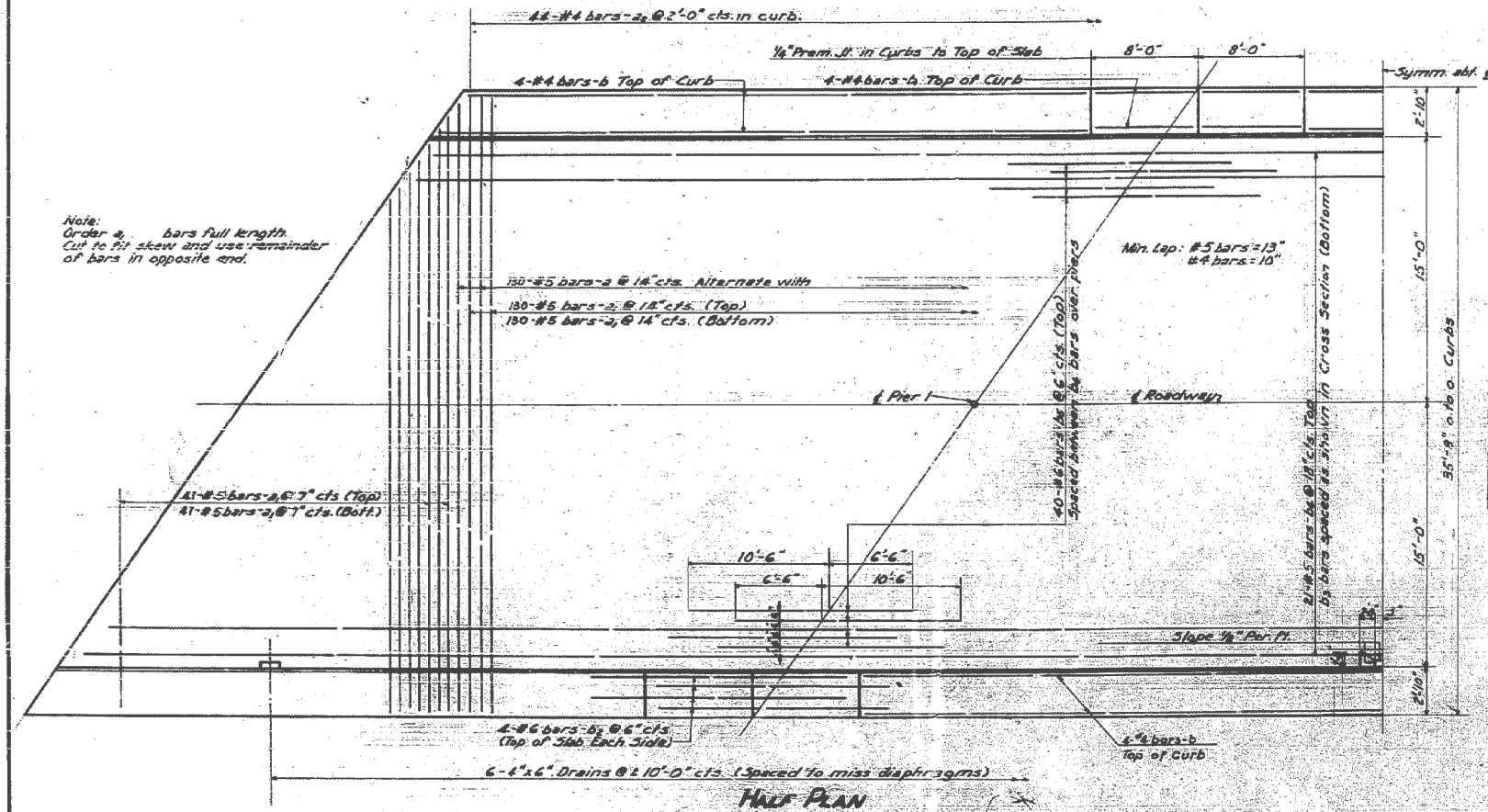

METHOD OF DETERMINING FILLET HEIGHTS -  
After all Structural Steel has been erected,  
elevations of the top flanges of the beams shall  
be taken at intervals not to exceed 10 ft. From  
these elevations subtract the increment of  
deflection for these points, determined from  
the D.L. Deflection Diagram. The elevations  
so obtained subtracted from the theoretical  
grade elevations, minus floor thickness,  
equals the fillet heights above top of beam.

FILLET AND FLOOR DRAIN DETAILS

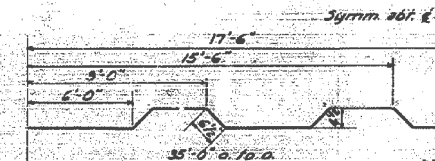

BAR 1

BAR 2

BAR 3

BILL OF MATERIAL

BAR	NO	SIZE	LENGTH	SHAPE
a	130	#5	36'-4"	U
b	32	#4	35'-0"	U
c	176	#4	5'-0"	U
b	48	#4	23'-6"	U
b <sub>1</sub>	32	#4	7'-9"	U
b <sub>2</sub>	16	#6	17'-0"	U
b <sub>3</sub>	222	#4	25'-0"	U
b <sub>4</sub>	138	#5	25'-0"	U
b <sub>5</sub>	30	#6	17'-0"	U
Class A Concrete		Cu. Yds.	163.0	
Reinforcement Bars		Lbs.	39844	
Structural Steel		Lbs.	118774	

DESIGNED Frank D. Cucinelli  
CHECKED Albert A. Kowal  
DRAWN J. Garcia  
CHECKED FDC

JUNE 2 1955  
EXAMINED V.M. Brennan  
PASSED [Signature]  
APPROVED R.R. Bartelmy

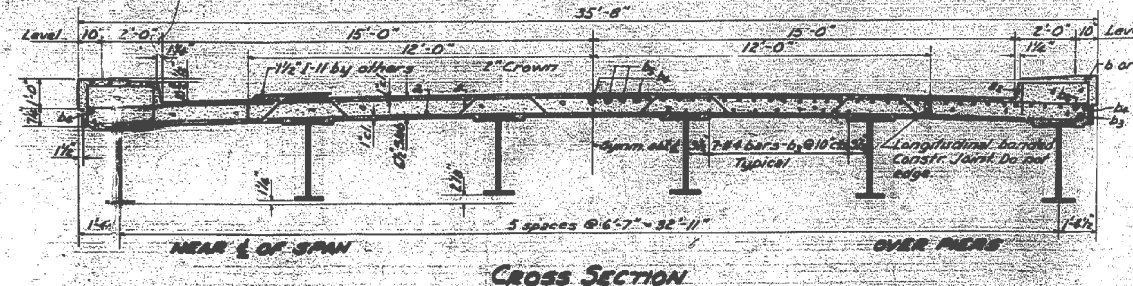

CROSS SECTION

SUPERSTRUCTURE  
CRAWFISH CREEK  
S.B.I. RT. 1 SEC. 12-B-2  
WABASH COUNTY  
STATION 135+50

PRINT DRIVER: LEO E. BARNETT  
SCALE: 1/4" = 1'-0"  
FILE NAME: C:\PLOT\12-B-2\12-B-2.DWG



USER NAME = has	DESIGNED - MTD	REVISED -
ESCA PROJECT NO. 933.14	CHECKED - RDP	REVISED -
PLOT SCALE = 0.1667 / IN.	DRAWN - HAS	REVISED -
PLOT DATE = 6/10/2014	CHECKED - 01/31/13	REVISED -

STATE OF ILLINOIS  
DEPARTMENT OF TRANSPORTATION

EXISTING STRUCTURE PLANS - SN 093-0003  
FOR INFORMATION ONLY

SHEET NO. 2 OF 6 SHEETS

F.A.P. RTE.	SECTION	COUNTY	TOTAL SHEETS	SHEET NO.
332	(12,B2)B-1	WABASH	68	53
CONTRACT NO. 74219			ILLINOIS FED. AID PROJECT	