

STATE OF ILLINOIS  
DEPARTMENT OF TRANSPORTATION

F.A.U. RTE.	SECTION	COUNTY	TOTAL SHEETS	SHEET NO.
379	(119) N	KENDALL	29	1
		ILLINOIS	CONTRACT NO. 66F63	

INDEX OF SHEETS

- 1 COVER SHEET
- 2 GENERAL NOTES
- 3-6 SUMMARY OF QUANTITIES
- 7 TYPICAL SECTIONS
- 8 SCHEDULES
- 9 REMOVAL PLAN
- 10-12 PLAN AND PROFILE
- 13 EROSION CONTROL PLAN
- 14 PAVEMENT MARKING PLAN
- 15 DETAILS
- 16-29 CROSS SECTIONS

STANDARDS

- 000001-06 STANDARD SYMBOLS, ABBREVIATIONS AND PATTERNS
- 001006 DECIMAL OF AN INCH AND OF A FOOT
- 280001-07 TEMPORARY EROSION CONTROL SYSTEMS
- 482001-02 HMA SHOULDER ADJACENT TO FLEXIBLE PAVEMENT
- 482011-03 HMA SHOULDER STRIPS/SHOULDERS WITH RS OR WIDENING & RS PROJECTS
- 542011-01 CONCRETE END SECTIONS FOR ELLIPTICAL PIPE CULVERTS 15" (375mm) THRU 72" (1800 mm) EQUIVALENT DIAMETER
- 542306-03 PRECAST REINFORCED CONCRETE ELLIPTICAL FLARED END SECTION
- 542406-02 METAL END SECTION FOR PIPE ARCHES
- 642006 SHOULDER RUMBLE STRIPS, 8 INCH
- 701201-04 LANE CLOSURE, 2L, 2W, DAY ONLY, FOR SPEEDS ≥ 45 MPH
- 701306-03 LANE CLOSURE, 2L, 2W, SLOW MOVING OPERATIONS DAY ONLY, FOR SPEEDS ≥ 45 MPH
- 701311-03 LANE CLOSURE, 2L, 2W, MOVING OPERATIONS - DAY ONLY
- 701326-04 LANE CLOSURE, 2L, 2W, PAVEMENT WIDENING, FOR SPEEDS ≥ 45 MPH
- 701901-05 TRAFFIC CONTROL DEVICES
- 720001-01 SIGN PANEL MOUNTING DETAILS
- 720006-04 SIGN PANEL ERECTION DETAILS
- 781001-04 TYPICAL APPLICATIONS RAISED REFLECTIVE PAVEMENT MARKERS

PROPOSED  
HIGHWAY PLANS

FAU ROUTE 379 (IL 126)  
SECTION (119) N  
PROJECT  
INTERSECTION IMPROVEMENT  
KENDALL COUNTY

C-93-114-16



MINOR ARTERIAL  
2015 ADT = 7350  
P.V. = 90.2% S.U. = 4.4% M.U. = 5.4%

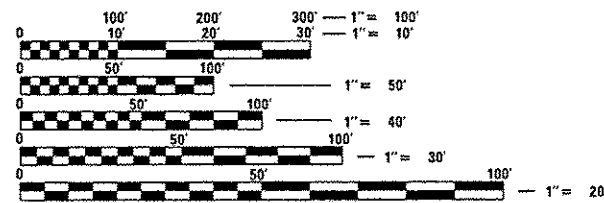

FULL SIZE PLANS HAVE BEEN PREPARED USING STANDARD ENGINEERING SCALES. REDUCED SIZED PLANS WILL NOT CONFORM TO STANDARD SCALES. IN MAKING MEASUREMENTS ON REDUCED PLANS, THE ABOVE SCALES MAY BE USED.

J.U.L.I.E.  
JOINT UTILITY LOCATION INFORMATION FOR EXCAVATION  
1-800-892-0123  
OR 811

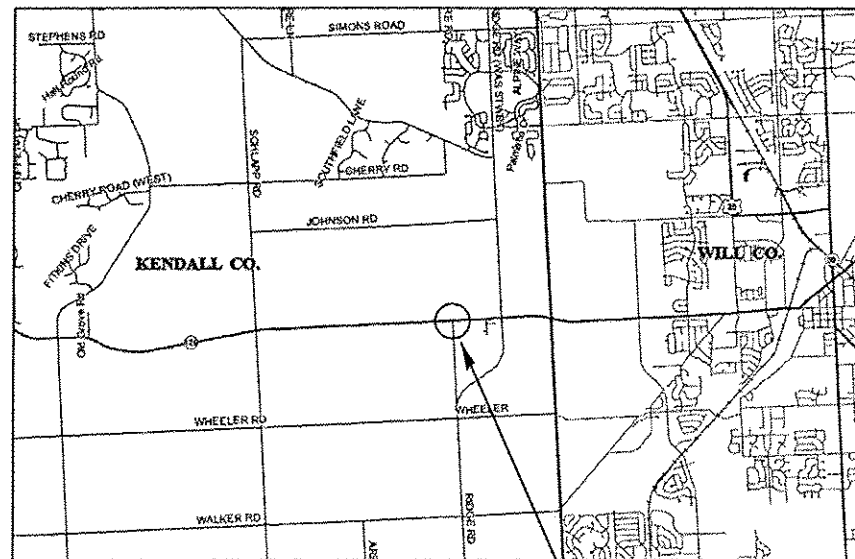

PROJECT LOCATION  
IL 126 AND OLD RIDGE RD  
STA. 504+88 TO STA. 510+94

GROSS & NET LENGTH = 628 FT. = 0.119 MILES

PROJECT ENGINEER: JOE KANNEL, P.E.  
UNIT CHIEF: MARC BUDZYNSKI  
DISTRICT 3 NO. (815) 434-6131  
CONTRACT NO. 66F63

STATE OF ILLINOIS  
DEPARTMENT OF TRANSPORTATION

SUBMITTED Aug 5 2016  
Kevin Marchuk P.E.  
REGIONAL ENGINEER

Aug 12 2016  
Maureen M. Addis P.E.  
ENGINEER OF DESIGN AND ENVIRONMENT

Aug 12 2016  
Tracie A. [Signature]  
DIRECTOR OF PROGRAM DEVELOPMENT

PRINTED BY THE AUTHORITY  
OF THE STATE OF ILLINOIS

**GENERAL NOTES**

THE THICKNESS OF HMA SHOWN ON THE PLANS IS THE NOMINAL THICKNESS. DEVIATIONS FROM THE NOMINAL THICKNESS WILL BE PERMITTED WHEN SUCH DEVIATIONS OCCUR DUE TO IRREGULARITIES IN THE EXISTING SURFACE OR BASE ON WHICH THE HMA IS PLACED.

THE HMA SURFACE OF ALL MAILBOX TURNOUTS, PRIVATE ENTRANCES, COMMERCIAL ENTRANCES, AND SIDE ROADS SHALL BE MADE NEATLY, IN A WORKMANLIKE MANNER, AND SHALL ACCURATELY CONFORM TO THE SHAPES AND DIMENSIONS SHOWN ON THE PLAN DETAILS. IF REQUIRED BY THE ENGINEER, THE CONTRACTOR SHALL SAW CUT THE HMA SURFACE TO CONFORM TO THE SHAPES AND DIMENSIONS SHOWN ON THE PLAN DETAILS. THIS WORK WILL BE INCLUDED IN THE COST OF THE HMA SURFACE.

BEFORE ORDERING PIPE CULVERTS OR PIPE DRAINS, THE CONTRACTOR SHALL CONSULT THE ENGINEER FOR EXACT LENGTHS.

THE ENGINEER WILL BE THE SOLE JUDGE CONCERNING CURING TIME FOR THE VARIOUS HMA LIFTS.

FOR STABILIZATION, ALL TYPE III BARRICADES WILL REQUIRE A MINIMUM OF FOUR SAND BAGS PER BARRICADE.

SEEDING WILL NOT BE PERMITTED AT ANY TIME WHEN THE GROUND IS FROZEN, WET, OR IN AN UNTILLABLE CONDITION. LOCATIONS TO BE SEEDED WILL BE DETERMINED BY THE ENGINEER.

THE FINISHED EARTHWORK SHALL HAVE A VEGETATION SUSTAINING SOIL COVERING THE TOP FOUR INCHES ( 100 MILLIMETERS) IN AREAS TO BE SEEDED OR SODDED. THE VEGETATION SUSTAINING SOIL REQUIRED WILL NOT BE PAID FOR SEPARATELY BUT WILL BE INCLUDED IN THE COST OF FURNISHED EXCAVATION.

ALL EXCAVATED MATERIAL, WHICH INCLUDES DIGGING OR GRADING OF ANY SOIL OR FILL MATERIAL, WITH THE EXCEPTION OF AGGREGATE FILLS, MUST BE INCORPORATED WITHIN THE IDOT RIGHT OF WAY DUE TO ENVIRONMENTAL DOCUMENTATION REQUIREMENTS.

ALL ELEVATIONS REFERRING TO U.S.G.S. MEAN SEA LEVEL DATUM.

ABANDONED UNDERGROUND UTILITIES THAT CONFLICT WITH CONSTRUCTION SHALL BE DISPOSED OF OUTSIDE THE LIMITS OF THE RIGHT OF WAY ACCORDING TO ARTICLE 202.03 OF THE STANDARD SPECIFICATIONS AND AS DIRECTED BY THE ENGINEER. THIS WORK WILL NOT BE PAID FOR SEPARATELY, BUT WILL BE INCLUDED IN THE COST OF FURNISHED EXCAVATION.

ANY REFERENCE TO A STANDARD IN THESE PLANS SHALL BE INTERPRETED TO MEAN THE EDITION AS INDICATED BY THE SUBNUMBER SHOWN IN THE LIST OF STANDARDS OR THE COPY INCLUDED IN THESE PLANS.

THE FOLLOWING RATES OF APPLICATION HAVE BEEN USED IN CALCULATING PLAN QUANTITIES:

GRANULAR MATERIALS	2.05	TONS / CU YD
HMA RESURFACING	112	LBS / SQ YD / IN
SHORT TERM PAVEMENT MARKING	10	FT /100 FT OF APPLICATION
MIX FOR CRACKS, JTS & FLGWYS	0.0003	TONS / SQ YD
LEVEL BINDER (HAND METHOD)	0.0005	TONS / SQ YD

THE CONTRACTOR'S ATTENTION IS DIRECTED TO THE PRESENCE OF DEPARTMENT-OWNED UNDERGROUND ELECTRICAL CABLE WITHIN THE LIMITS OF THE PROPOSED IMPROVEMENT. THE CONTRACTOR SHALL REQUEST THE ILLINOIS DEPARTMENT OF TRANSPORTATION IN OTTAWA (815-434-8417) TO LOCATE THE UNDERGROUND FACILITIES, PROVIDING A MINIMUM OF 72 HOURS NOTICE. THE DEPARTMENT IS NOT A MEMBER OF THE JOINT UTILITY LOCATING INFORMATION FOR EXCAVATORS (JULIE) SYSTEM.

ALL DAMAGE TO DEPARTMENT OWNED UNDERGROUND FACILITIES, CAUSED BY THE CONTRACTOR SHALL BE REPAIRED TO THE SATISFACTION OF THE DEPARTMENT AT THE CONTRACTOR'S EXPENSE. THIS SHALL INCLUDE ALL TEMPORARY REPAIRS REQUIRED TO KEEP THE FACILITY OPERATIONAL WHILE MATERIAL IS BEING OBTAINED TO MAKE PERMANENT REPAIRS. SPLICING OF ELECTRIC CABLE WILL NOT BE ALLOWED. ELECTRIC CABLE SHALL BE REPLACED FROM POLE TO POLE OR CONTROLLER.

THE CONTRACTOR SHALL CONTACT JULIE AT LEAST 48 HOURS PRIOR TO EXCAVATION TO DETERMINE WHICH UTILITIES ARE IN THE AREA.

LOCATION(S):	HMA MIXTURE REQUIREMENT TABLE					
	ENTIRE PROJECT					
MIXTURE USE(S):	BINDER COURSE	LEVELING BINDER	SURFACE COURSE	INCIDENTAL	SHOULDER BOTTOM LIFT(S)	SHOULDER TOP LIFT
BINDER GRADE (PG):	PG 64-22	PG 64-22	PG 64-22	PG 64-22	PG 64-22	PG 64-22
DESIGN AIR VOIDS:	4.0% @ N50	4.0% @ N50	4.0% @ N50	4.0% @ N50	4.0% @ N50	4.0% @ N50
MIXTURE COMPOSITION: (MIXTURE GRADATION)	IL 19.0	IL 9.5 FG	IL 9.5	IL 9.5	IL 19.0	IL 9.5
FRICTION AGGREGATE:	N/A	N/A	MIXTURE D	MIXTURE C	N/A	MIXTURE C
MIXTURE WEIGHT:	112.0 LB/SY/IN	112.0 LB/SY/IN	112.0 LB/SY/IN	112.0 LB/SY/IN	112.0 LB/SY/IN	112.0 LB/SY/IN
QUALITY MANAGEMENT PROGRAM:	OC/OA	OC/OA	OC/OA	OC/OA	OC/OA	OC/OA
SUBLOT SIZE:	N/A	N/A	N/A	N/A	N/A	N/A
DENSITY TEST METHOD:	CORES/NUCLEAR	GROWTH CURVE	CORES/NUCLEAR	SATISFACTION OF ENGINEER	CORES/NUCLEAR	CORES/NUCLEAR

STATE OF ILLINOIS  
DEPARTMENT OF TRANSPORTATION  
DISTRICT THREE  
AS BUILT INFORMATION

\_\_\_\_\_  
SUPERVISING CONSTRUCTION FIELD ENGINEER

\_\_\_\_\_  
RESIDENT ENGINEER / TECHNICIAN

START & END DATES  
OF CONSTRUCTION:

INSPECTORS:

STATE OF ILLINOIS  
DEPARTMENT OF TRANSPORTATION  
DISTRICT THREE

PREPARED BY: Tom Blouin  
DISTRICT STUDIES & PLANS ENGINEER

DATE: August 5, 2016

EXAMINED BY: Hughes  
DISTRICT CONSTRUCTION ENGINEER

Wayne J. Phillips  
DISTRICT MATERIALS ENGINEER

Tom H. Hagan  
DISTRICT OPERATIONS ENGINEER

STATE OF ILLINOIS  
DEPARTMENT OF TRANSPORTATION

GENERAL NOTES

F.A.U. RTE.	SECTION	COUNTY	TOTAL SHEETS	SHEET NO.
379	(119) N	KENDALL	29	2
CONTRACT NO. 66F63				
ILLINOIS FED. AID PROJECT				

SCALE: SHEET OF SHEETS STA. TO STA.

FILE NAME *	USER NAME * budzynskm	DESIGNED -	REVISED -
Default	Documents\DOT Offices\District 3\Projects\0366\Drawings\0366\0366\F63-shr-cover.dwg	CHECKED -	REVISED -
	PLOT SCALE * 100.0000' / in	DATE -	REVISED -
	PLOT DATE * 8/5/2016		







CODE NO.	ITEM	UNIT	100 % STATE TOTAL QUANTITY	CONSTR. CODE	
				ROADWAY 0005	RURAL
X4402800	ISLAND PAVEMENT REMOVAL	50 YD	6.6	6.6	
Z0030850	TEMPORARY INFORMATION SIGNING	50 FT	42	42	

2

FILE NAME *	USER NAME * budzynahm	DESIGNED -	REVISED -	<b>STATE OF ILLINOIS DEPARTMENT OF TRANSPORTATION</b>	<b>SUMMARY OF QUANTITIES</b>				F.A.U. RTE.	SECTION	COUNTY	TOTAL SHEETS	SHEET NO.
p:\1\1084EB10NTEG.illinois.gov\FW100T\Documents\DOT Offices\District 3\Projects\0361\Drawings\6AD\sheets\0366F63.sht-cover		CHECKED -	REVISED -		379	(119) N	KENDALL	29	6				
PLOT SCALE * 100.0000 ' / 1"		DATE -	REVISED -		SCALE: SHEET OF SHEETS STA. TO STA.				CONTRACT NO. 66F63				
PLOT DATE * 8/5/2016									ILLINOIS FED. AID PROJECT				

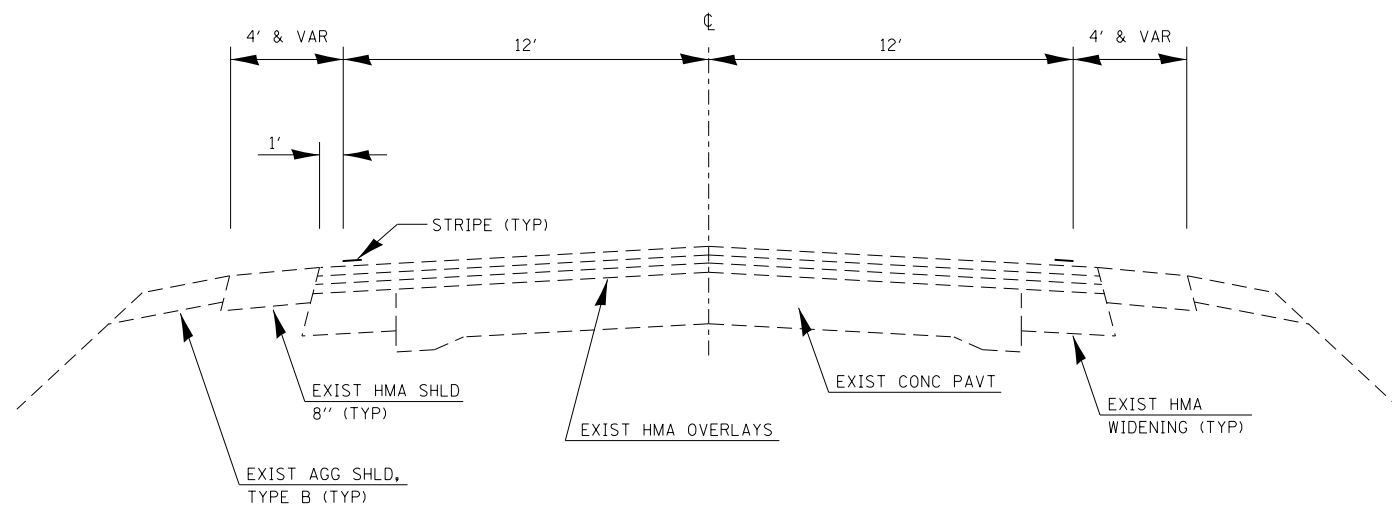

**EXISTING TYPICAL SECTION – IL 126**

STA 504+66 TO STA 510+94

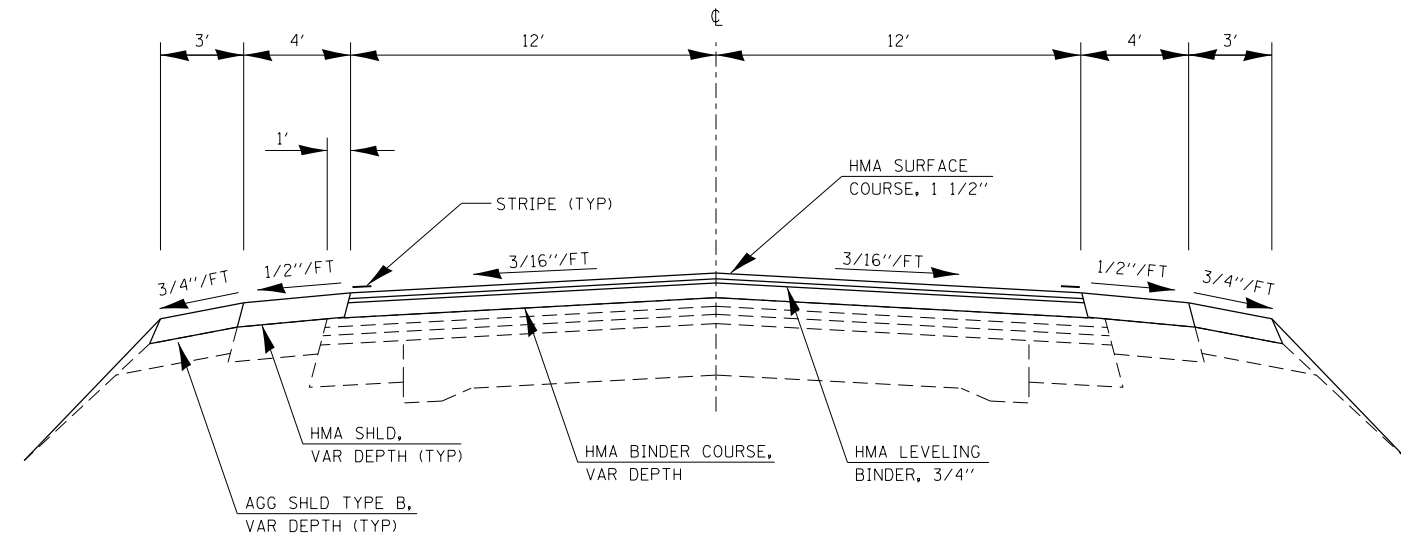

**PROPOSED TYPICAL SECTION – IL 126**

STA 504+66 TO STA 510+94

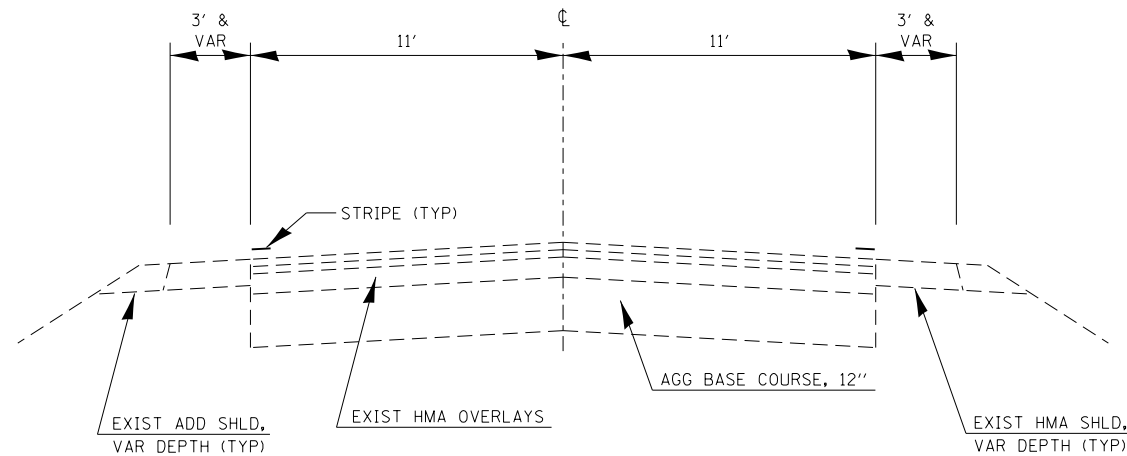

**EXISTING TYPICAL SECTION – OLD RIDGE RD**

STA 127+91 TO STA 130+00

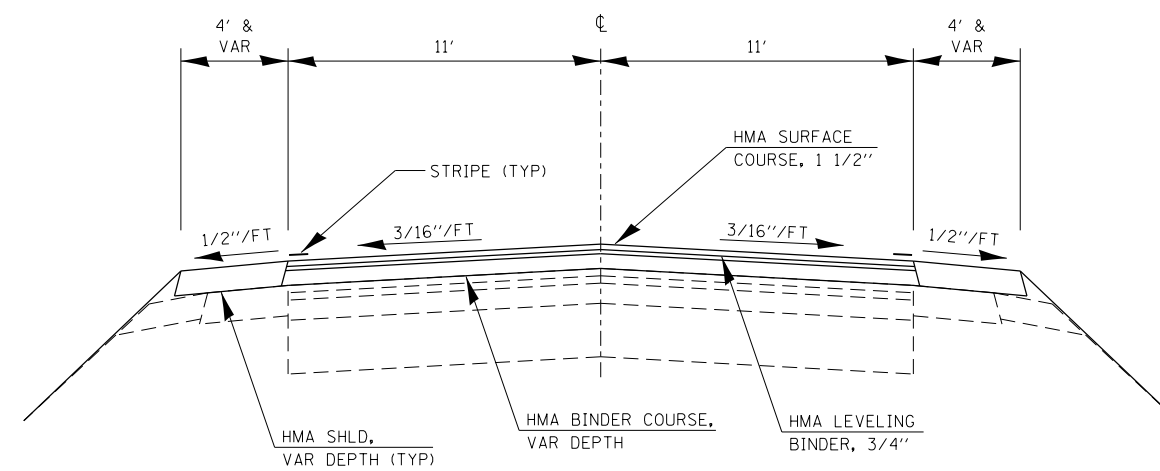

**PROPOSED TYPICAL SECTION – OLD RIDGE RD**

STA 127+91 TO STA 130+00

FILE NAME =	USER NAME = budzynskim	DESIGNED -	REVISED -
Default		CHECKED -	REVISED -
	PLOT DATE = 8/5/2016	DATE -	REVISED -

**STATE OF ILLINOIS  
DEPARTMENT OF TRANSPORTATION**

**TYPICAL SECTIONS**

SCALE: SHEET OF SHEETS STA. TO STA.

F.A.U. RTÉ.	SECTION	COUNTY	TOTAL SHEETS	SHEET NO.
379	(119) N	KENDALL	29	7
CONTRACT NO. 66F63				
ILLINOIS FED. AID PROJECT				

PAVEMENT RESURFACING SCHEDULE													
LOCATION	HMA BIND CSE IL-19.0, N50 VAR DEPTH	LEV BIND (MM) IL-9.5FG, N50 3/4"	LEV BIND (HM) IL-9.5FG, N50 3/4"	HMA SURF CSE MIX "D", N50 1 1/2"	INCIDENTAL HMA SURF	HMA SHLD VAR DEPTH	AGG SHLD VAR DEPTH	BIT MATLS PRIME COAT	MIX FOR CR JTS FLGWYS	HMA SURF REMOVAL 1 1/2"	HMA SURF REMOVAL BUTT JOINT	PAVEMENT REMOVAL	SHOULDER RUMBLE STRIPS 8"
	TON	TON	TON	TON	TON	TON	TON	POUND	TON	SQ YD	SQ YD	SQ YD	FOOT
IL 126	424	52	1.2	122	23	175	110	2130	0.7	-	426	475	1000
OLD RIDGE RD*	152	18	0.4	50	4	70	-	745	0.2	46	200	330	-
<b>TOTAL</b>	<b>576</b>	<b>70</b>	<b>1.6</b>	<b>172</b>	<b>27</b>	<b>245</b>	<b>110</b>	<b>2875</b>	<b>0.9</b>	<b>46</b>	<b>626</b>	<b>805</b>	<b>1000</b>

\*INCLUDES QUANTITIES FOR EACH RADIUS

LANDSCAPING AND EROSION CONTROL SCHEDULE									
LOCATION	SEEDING CL 1A	NITROGEN FERT NUTR	PHOSPHORUS FERT NUTR	POTASSIUM FERT NUTR	EROSION CONTROL BLANKET	PERIMETER EROSION BARRIER	INLET AND PIPE PROTECTION	TEMP EROSION CONTROL SEEDING	TEMP EROSION CONTROL BLANKET
	ACRE	POUND	POUND	POUND	SQ YD	FOOT	EACH	POUND	SQ YD
NW QUADRANT	0.07	7	7	7	310	205		7	310
NE QUADRANT	0.13	12	12	12	605	340	1	13	605
SW QUADRANT	0.13	12	12	12	630	345	1	13	630
SE QUADRANT	0.21	19	19	19	1005	470	1	21	1005
<b>TOTAL</b>	<b>0.54</b>	<b>50</b>	<b>50</b>	<b>50</b>	<b>2550</b>	<b>1360</b>	<b>3</b>	<b>54</b>	<b>2550</b>

PAVEMENT MARKING SCHEDULE							
LOCATION	PAINT PAVEMENT MARKINGS TWO APPLICATIONS			SHORT TERM PVMT MKING	SHORT TERM PAVT MK REM	RAISED REF PVT MKR (AMBER)	RAISED REF PVT MKR REM
	4" WHITE	4" YELLOW	24" WHITE	FOOT	SQ FT	EACH	EACH
	FOOT	FOOT	FOOT	FOOT	SQ FT	EACH	EACH
EDGELINES	3180						
IL 126 CENTERLINE		2512		251	21	8	8
OLD RIDGE RD CENTERLINE		744		74	6		
STOP BAR			42	84	7		
<b>TOTAL</b>	<b>3180</b>	<b>3256</b>	<b>42</b>	<b>410</b>	<b>34</b>	<b>8</b>	<b>8</b>

EARTHWORK SCHEDULE				
LOCATION	EARTH EXCAVATION	EARTH EX ADJUSTED FOR SHRINKAGE (NOTE 1)	EMBANKMENT	EARTHWORK BALANCE WASTE (+) OR SHORTAGE (-)
	CU YD	CU YD	CU YD	CU YD
IL 126	0	0	315	-315
OLD RIDGE RD	5	4	160	-156
<b>TOTAL</b>	<b>5</b>	<b>4</b>	<b>475</b>	<b>-471</b>

NOTE 1. ESTIMATED SHRINKAGE FACTOR IS 25%



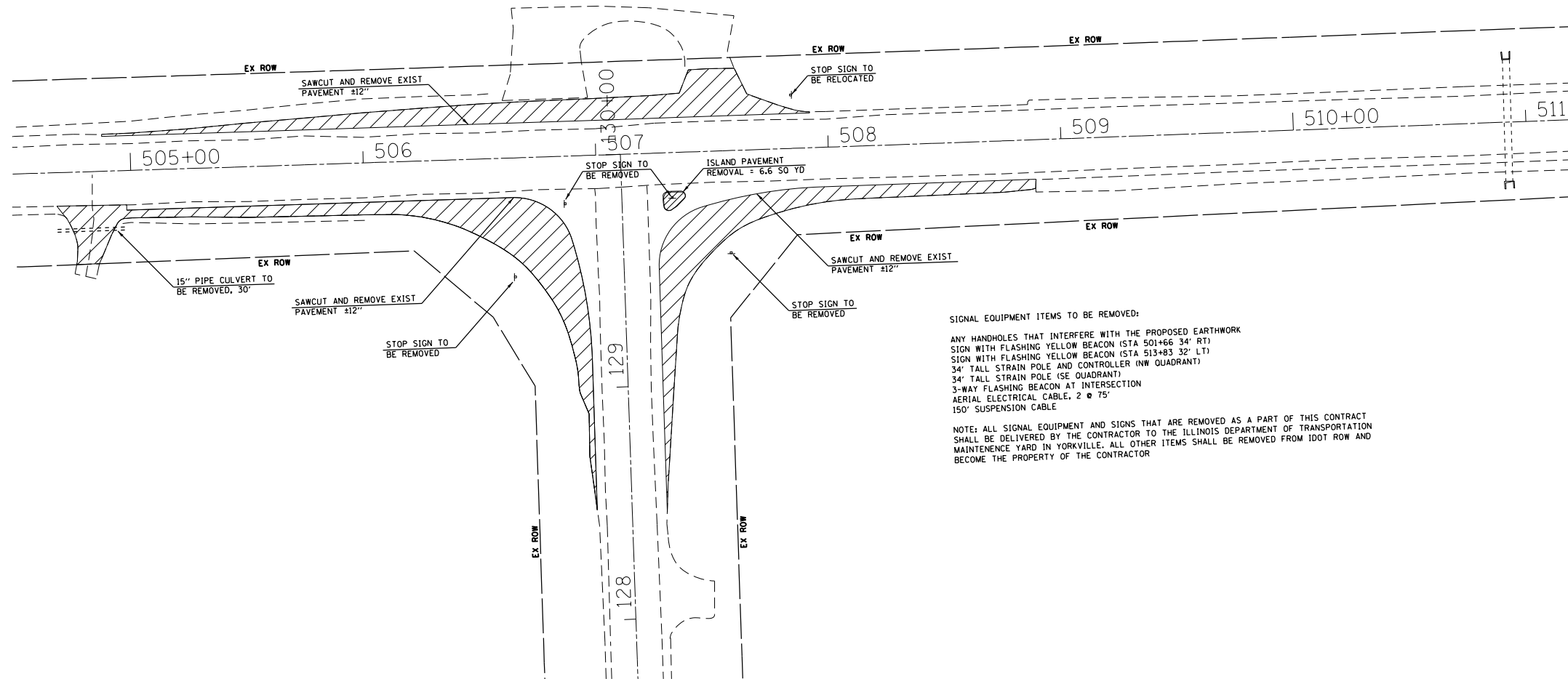

SIGNAL EQUIPMENT ITEMS TO BE REMOVED:  
 ANY HANDHOLES THAT INTERFERE WITH THE PROPOSED EARTHWORK  
 SIGN WITH FLASHING YELLOW BEACON (STA 501+66 34' RT)  
 SIGN WITH FLASHING YELLOW BEACON (STA 513+83 32' LT)  
 34' TALL STRAIN POLE AND CONTROLLER (NW QUADRANT)  
 34' TALL STRAIN POLE (SE QUADRANT)  
 3-WAY FLASHING BEACON AT INTERSECTION  
 AERIAL ELECTRICAL CABLE, 2 @ 75'  
 150' SUSPENSION CABLE

NOTE: ALL SIGNAL EQUIPMENT AND SIGNS THAT ARE REMOVED AS A PART OF THIS CONTRACT SHALL BE DELIVERED BY THE CONTRACTOR TO THE ILLINOIS DEPARTMENT OF TRANSPORTATION MAINTENANCE YARD IN YORKVILLE. ALL OTHER ITEMS SHALL BE REMOVED FROM IDOT ROW AND BECOME THE PROPERTY OF THE CONTRACTOR

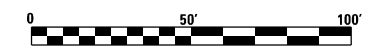

FILE NAME =	USER NAME = budzynskim	DESIGNED -	REVISED -
p:\11\084EBID\INTEG.illinois.gov\PI\DOT\Documents\IDOT Offices\District 3\Projects\03666\DRAWING\DATA\CAD\Sheets\03666F63-sht-cover.dwg		DRAWN -	REVISED -
Default	PLOT SCALE = 60.0000' / in.	CHECKED -	REVISED -
	PLOT DATE = 8/5/2016	DATE -	REVISED -

**STATE OF ILLINOIS  
DEPARTMENT OF TRANSPORTATION**

**REMOVAL PLAN**

SCALE: SHEET OF SHEETS STA. TO STA.

F.A.U. RTE.	SECTION	COUNTY	TOTAL SHEETS	SHEET NO.
379	(119) N	KENDALL	29	9
<b>CONTRACT NO. 66F63</b>				
ILLINOIS FED. AID PROJECT				



PLAN	SURVEYED	DATE
	PLOTTED	
	ALIGNED	
	CHECKED	
	FILED	
	CADD FILE NAME	
	NO.	

PROFILE	SURVEYED	DATE
	PLOTTED	
	GRADES CHECKED	
	STRUCTURE NOTATIONS CHKD	
	NO.	

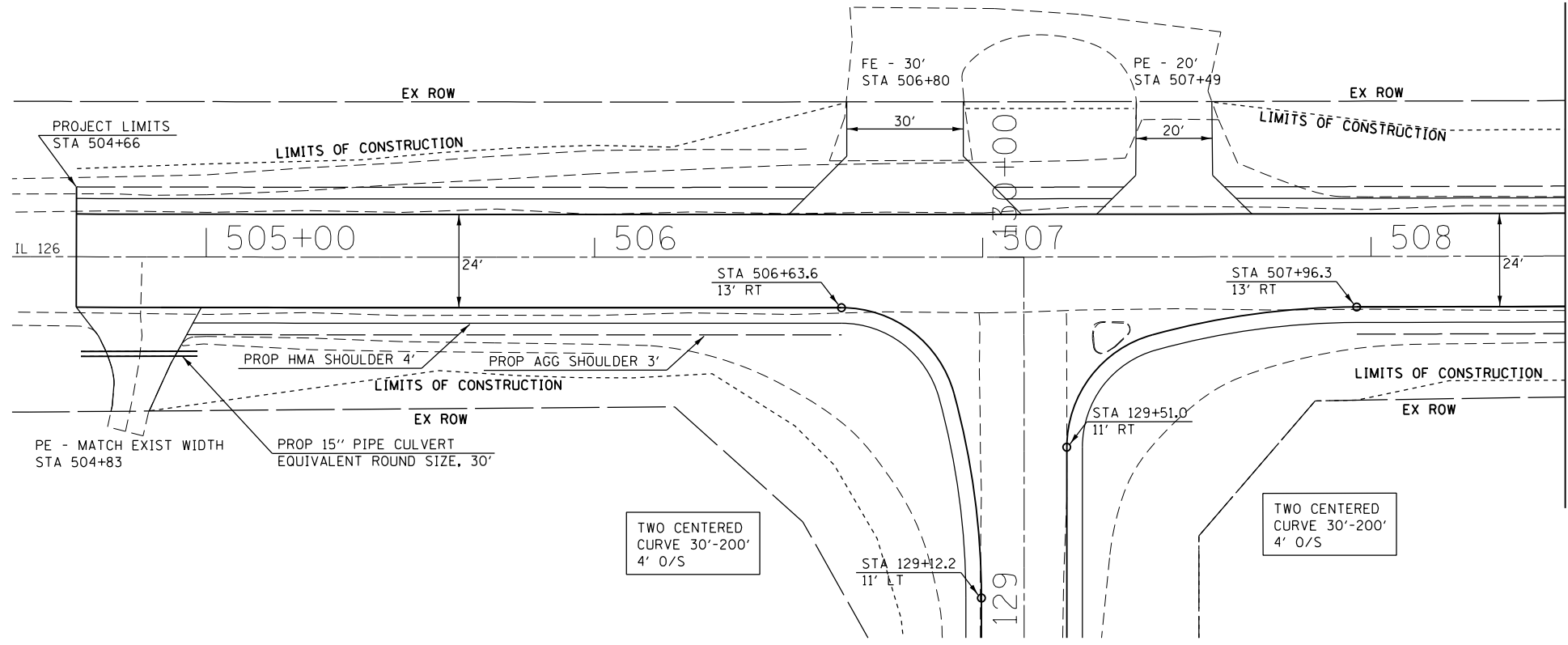

MATCHLINE STA. 508+50

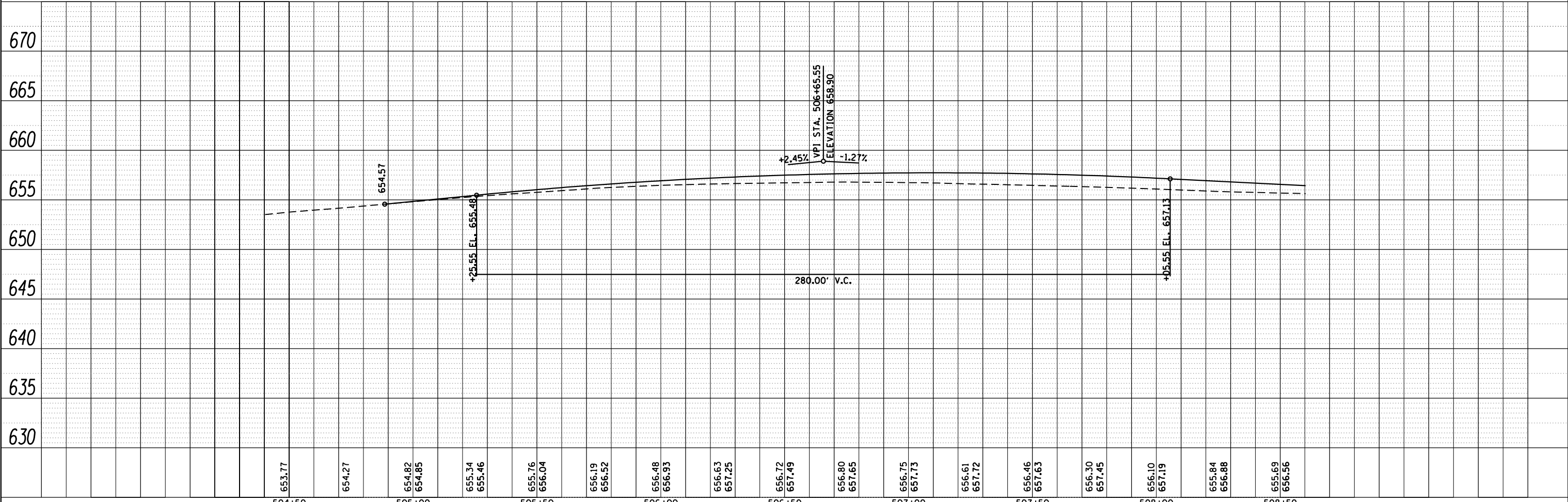
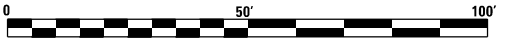

FILE NAME =	USER NAME = budzynskim	DESIGNED -	REVISED -	<b>STATE OF ILLINOIS DEPARTMENT OF TRANSPORTATION</b>	<b>PLAN AND PROFILE - IL 126</b>				F.A.U. RTE.	SECTION	COUNTY	TOTAL SHEETS	SHEET NO.
Default		CHECKED -	REVISED -		379	(119) N	KENDALL	29	10				
		DATE -	REVISED -		SCALE:      SHEET      OF      SHEETS      STA.      TO      STA.				<b>CONTRACT NO. 66F63</b>				
					ILLINOIS FED. AID PROJECT								

PLAN	SURVEYED	BY	DATE
	PLOTTED		
	ALIGNED		
	CHECKED		
	FILED		
	CADD FILE NAME		
NO.			

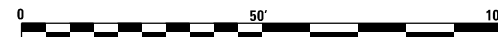
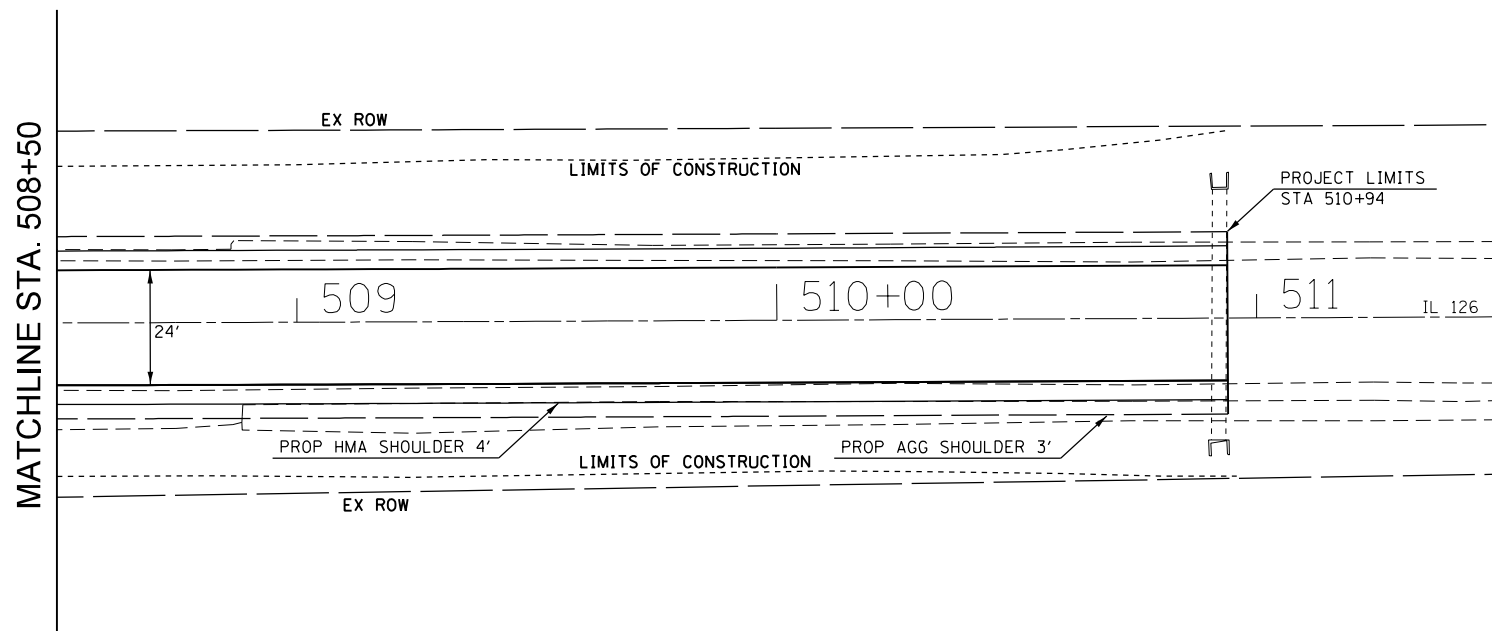

PROFILE	SURVEYED	BY	DATE
	PLOTTED		
	GRADES CHECKED		
	STRUCTURE NOTATIONS CHKD		
NO.			

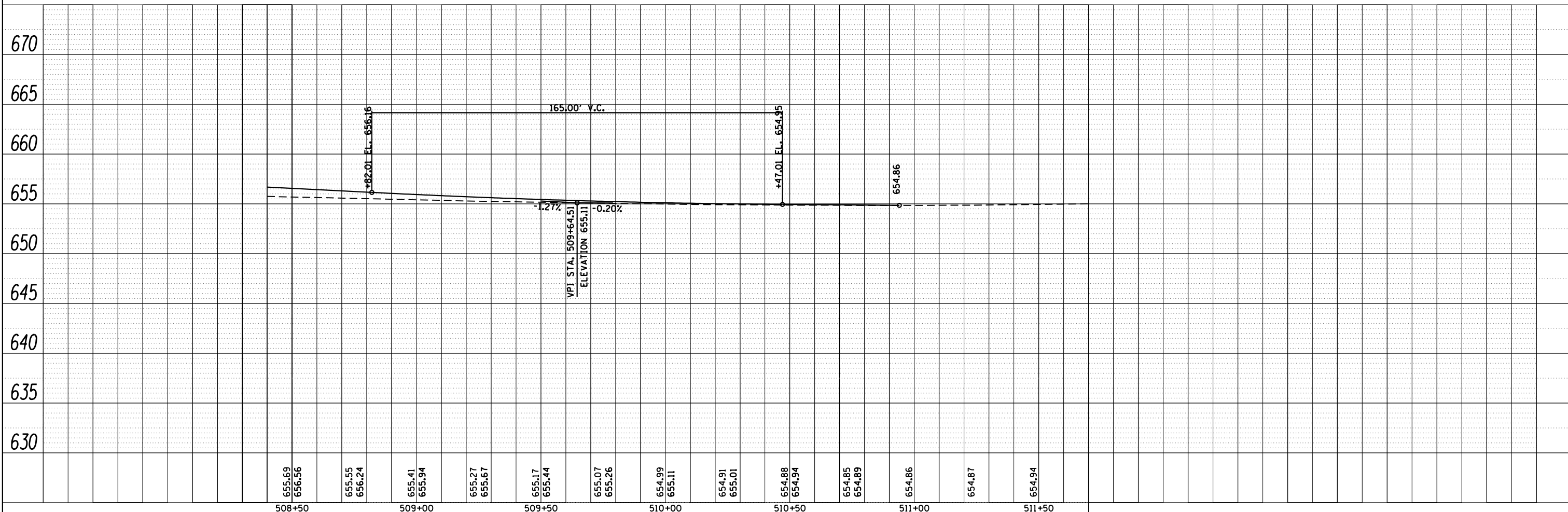

FILE NAME =	USER NAME = budzynskim	DESIGNED -	REVISED -	<b>STATE OF ILLINOIS DEPARTMENT OF TRANSPORTATION</b>	<b>PLAN AND PROFILE - IL 126</b>				F.A.U. RTE.	SECTION	COUNTY	TOTAL SHEETS	SHEET NO.
Default		CHECKED -	REVISED -						379	(119) N	KENDALL	29	11
		DATE -	REVISED -		SCALE: SHEET OF SHEETS STA. TO STA.				CONTRACT NO. 66F63				
					ILLINOIS FED. AID PROJECT								

PLAN	SURVEYED	DATE
	PLOTTED	
	ALIGNED	
	CHECKED	
	FILED	
	CADD FILE NAME	
NOTE BOOK NO.		

PROFILE	SURVEYED	DATE
	PLOTTED	
	GRADES CHECKED	
	STRUCTURE NOTATIONS CHECKED	
NOTE BOOK NO.		

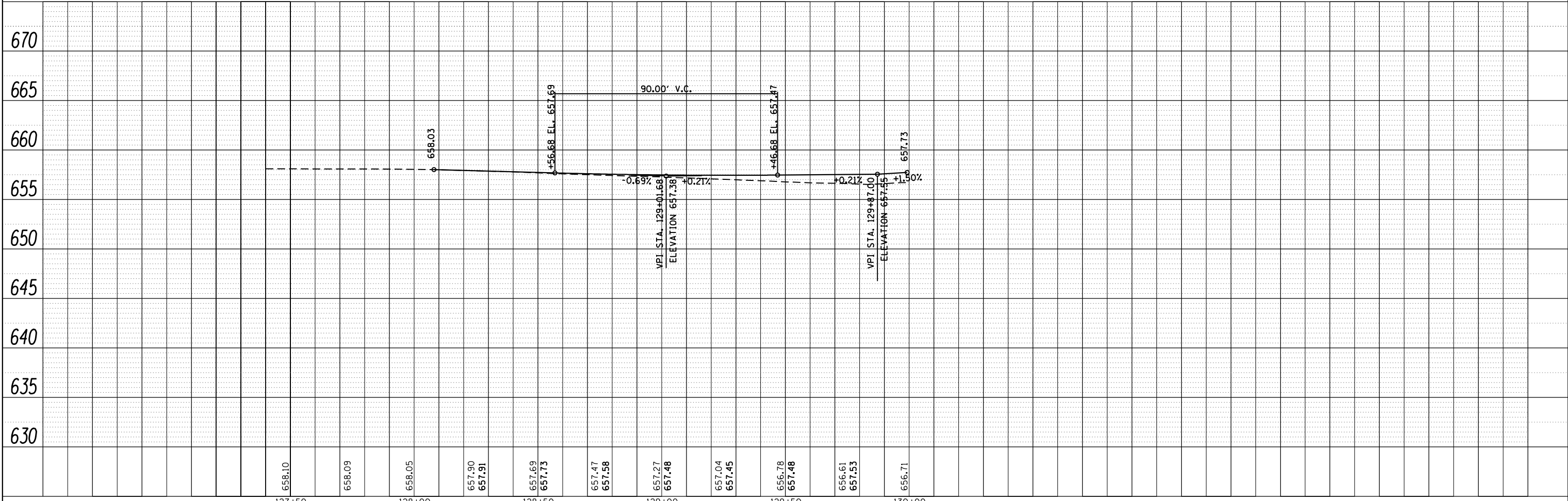
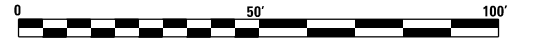
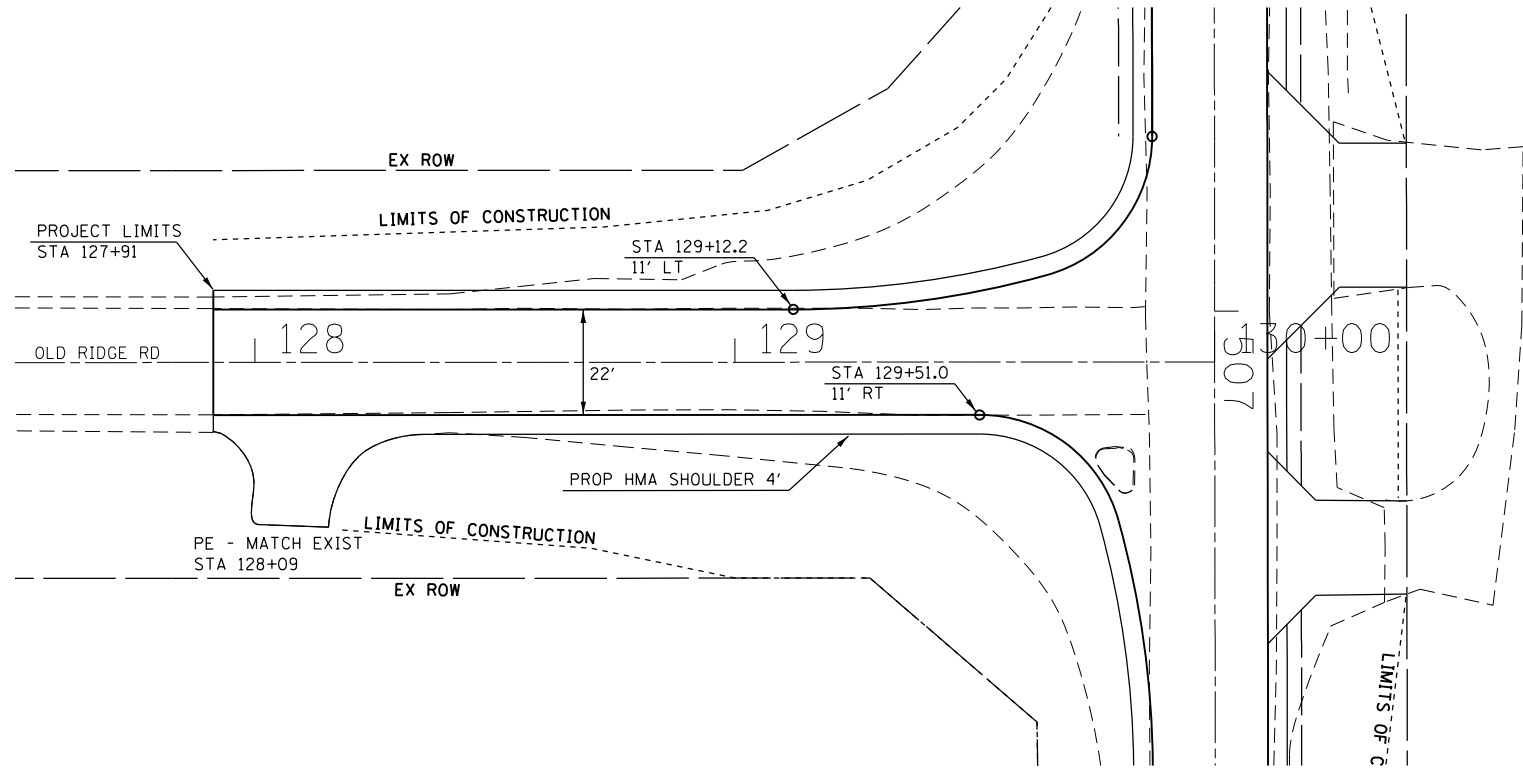

FILE NAME =	USER NAME = budzynskm	DESIGNED -	REVISED -	<b>STATE OF ILLINOIS DEPARTMENT OF TRANSPORTATION</b>	<b>PLAN AND PROFILE - OLD RIDGE RD</b>	F.A.U. RTE.	SECTION	COUNTY	TOTAL SHEETS	SHEET NO.
Default	PLOT SCALE = 40.0000' / in.	CHECKED -	REVISED -			379	(119) N	KENDALL	29	12
	PLOT DATE = 8/5/2016	DATE -	REVISED -			CONTRACT NO. 66F63				
						ILLINOIS FED. AID PROJECT				

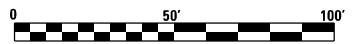
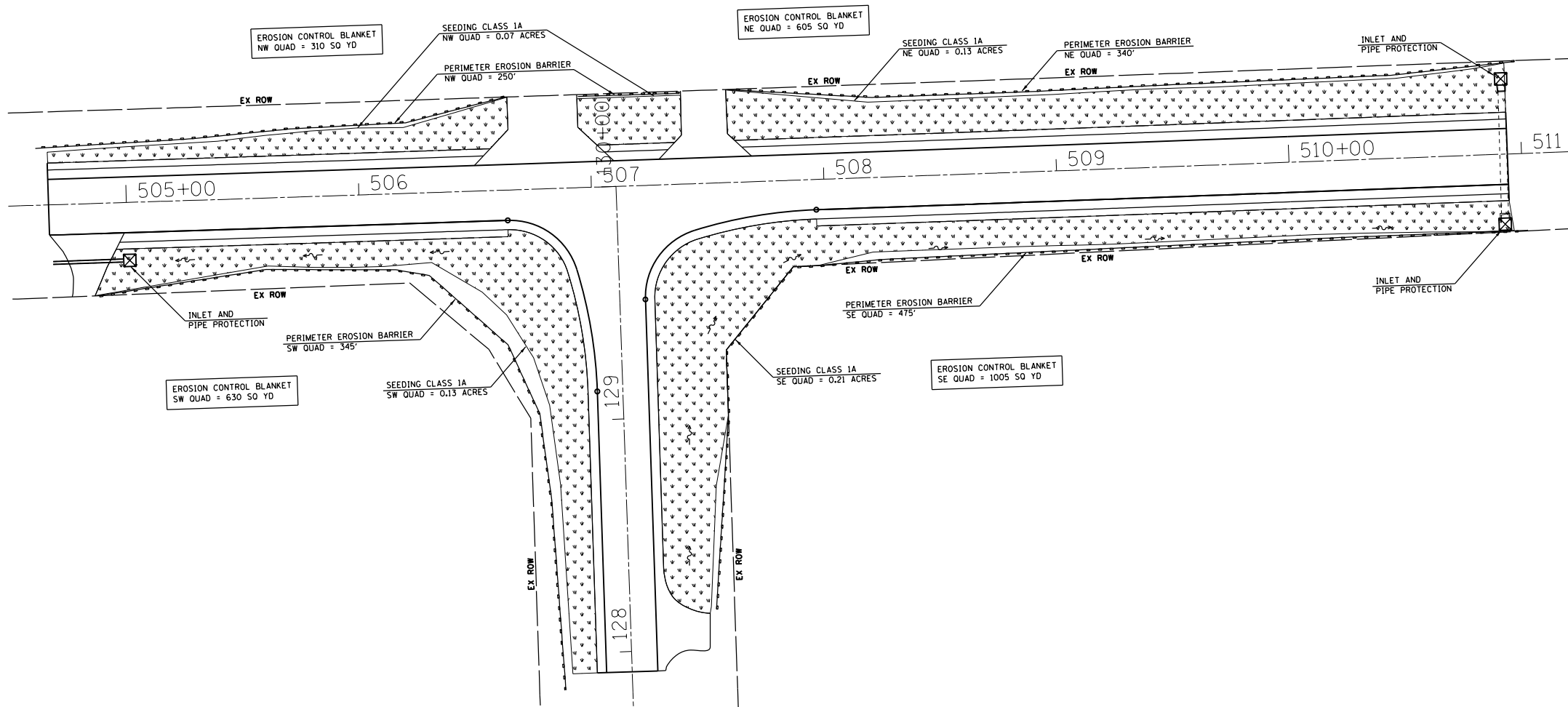

FILE NAME =	USER NAME = budzynskim	DESIGNED -	REVISED -
p:\11\084EBID\INTEG.illinois.gov\PIWID\Documents\DOT Offices\District 3\Projects\03666\DRAWING\DATA\CAD\Sheets\03666F63-sht-cover.dwg		CHECKED -	REVISED -
Default	PLOT DATE = 8/5/2016	DATE -	REVISED -

**STATE OF ILLINOIS  
DEPARTMENT OF TRANSPORTATION**

**EROSION CONTROL PLAN**

SCALE: SHEET OF SHEETS STA. TO STA.

F.A.U. RTE.	SECTION	COUNTY	TOTAL SHEETS	SHEET NO.
379	(119) N	KENDALL	29	13
<b>CONTRACT NO. 66F63</b>				
ILLINOIS FED. AID PROJECT				

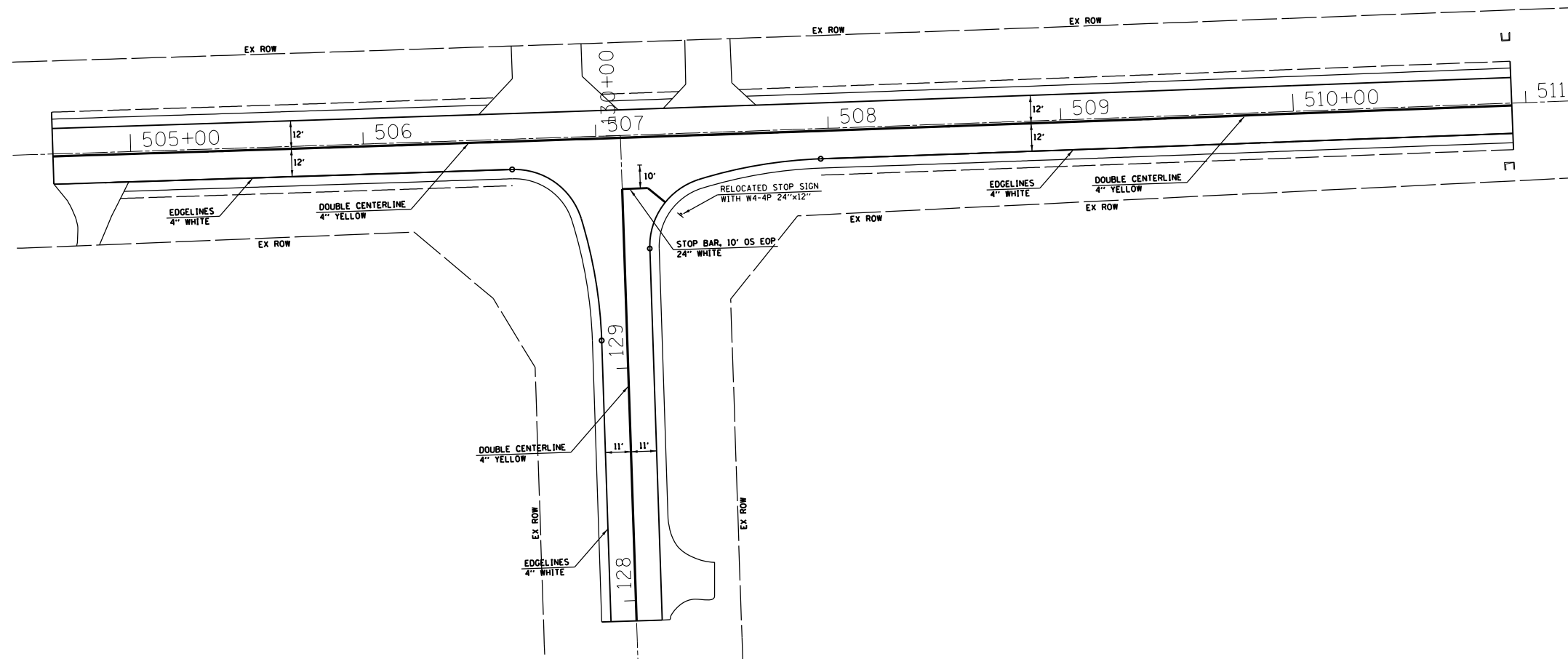

FILE NAME =	USER NAME = budzynskim	DESIGNED -	REVISED -
p:\11\084EBIDINTEG.illinois.gov\PI\DOT\Documents\DOT Offices\District 3\Projects\0366\DRAWING\DATA\CAD\Sheets\0366F63-sht-cover.dwg		CHECKED -	REVISED -
Default	PLOT DATE = 8/5/2016	DATE -	REVISED -

**STATE OF ILLINOIS  
DEPARTMENT OF TRANSPORTATION**

**PAVEMENT MARKING PLAN**

SCALE: SHEET OF SHEETS STA. TO STA.

F.A.U. RTE.	SECTION	COUNTY	TOTAL SHEETS	SHEET NO.
379	(119) N	KENDALL	29	14
<b>CONTRACT NO. 66F63</b>				
ILLINOIS FED. AID PROJECT				

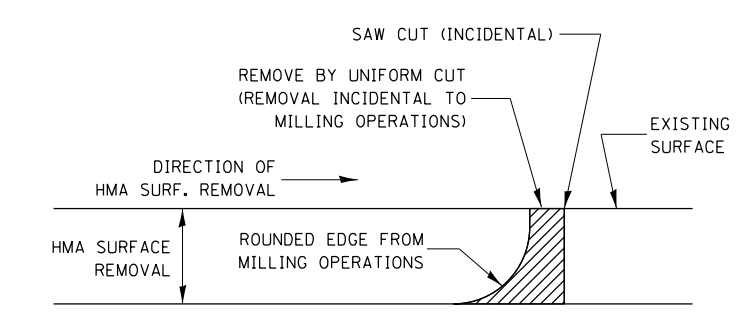
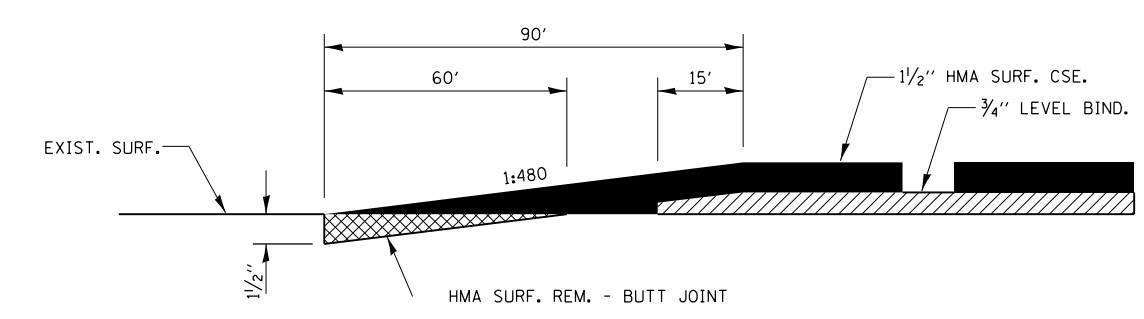
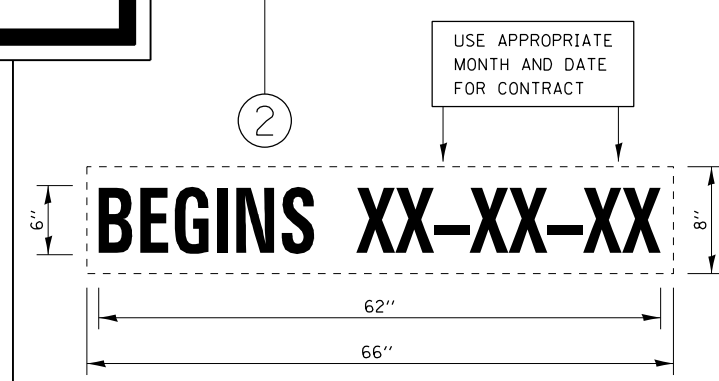
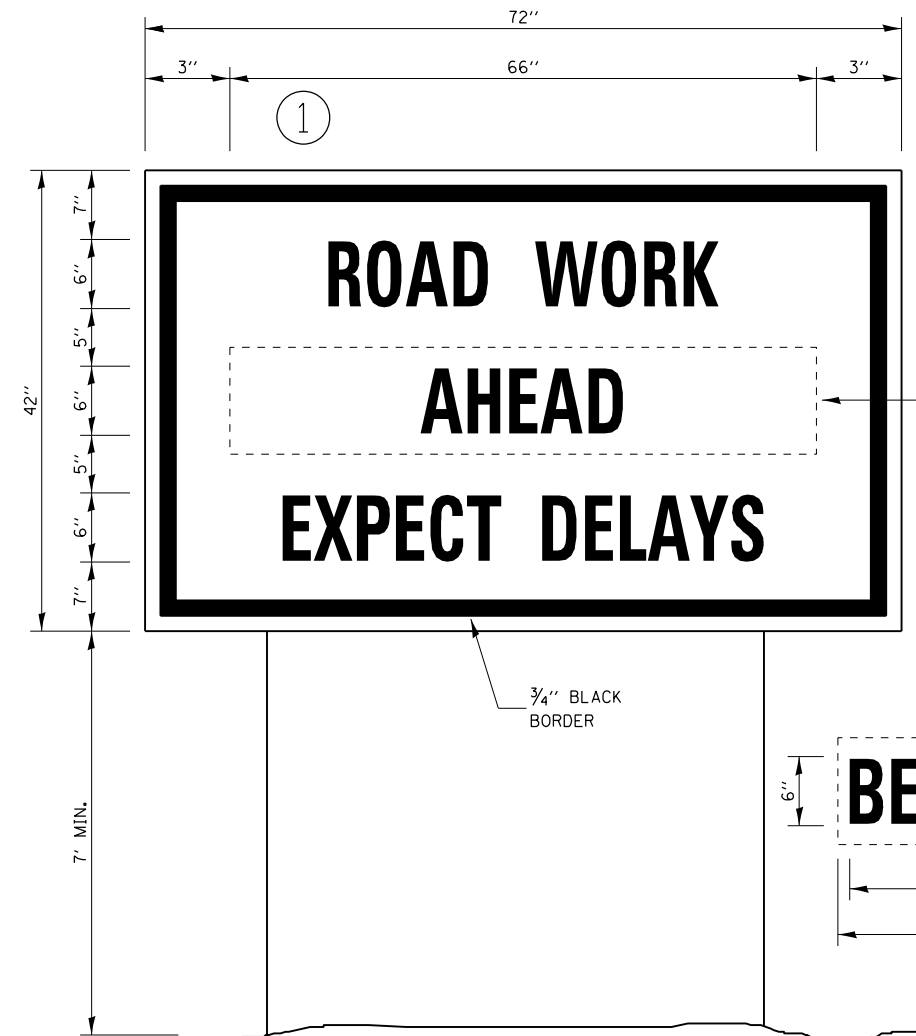

NOTE:  
WHEN MILLING OPERATIONS PRODUCE A ROUNDED EDGE, THEN A SAW CUT SHALL BE USED TO MANUFACTURE A PERPENDICULAR EDGE AS SHOWN IN THE DETAIL. THE ENGINEER SHALL BE THE SOLE JUDGE CONCERNING THE USE OF THIS DETAIL

**HMA DETAIL AT BUTT JOINTS**

**TEMPORARY INFORMATION SIGNING**

- NOTES:
1. USE 6" D BLACK LETTERING ON FLOURESENT ORANGE BACKGROUND.
  2. ERECT SIGNS AT LOCATIONS IN ADVANCE OF THE "ROAD CONSTRUCTION AHEAD" SIGNS AS DIRECTED BY THE ENGINEER.
  3. ERECT SIGN ① WITH INSTALLED PANEL ② A MINIMUM OF ONE WEEK PRIOR TO THE START OF THE LANE CLOSURE.
  4. REMOVE PANEL ② ON THAT DATE.
  5. SEE SPECIAL PROVISION "TEMPORARY INFORMATION SIGNING" FOR ADDITIONAL INFORMATION.
  6. WILL BE PAID FOR PER SQ FT AS "TEMPORARY INFORMATION SIGNING". EACH SIGN = 21 SQ FT AND THE DATE PANEL ② WILL NOT BE MEASURED SEPARATELY FOR PAYMENT.

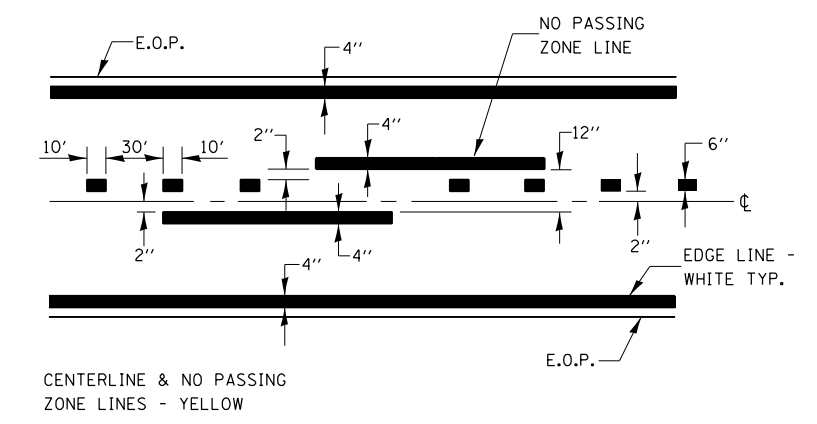

**PAVEMENT MARKING**

FILE NAME =	USER NAME = budzynskim	DESIGNED -	REVISED -	<b>STATE OF ILLINOIS DEPARTMENT OF TRANSPORTATION</b>	<b>DETAILS</b>			F.A.U. RTE.	SECTION	COUNTY	TOTAL SHEETS	SHEET NO.
pw:\11\084EBIDINTEG.illinois.gov\PI\DOT\Documents\DOT Offices\District 3\Projects\D3666\Drawings\CADsheets\D36663-shr-cover.dwg	PLOT SCALE = 100.0000' / 1in.	CHECKED -	REVISED -					379	(119) N	KENDALL	29	15
Default	PLOT DATE = 8/5/2016	DATE -	REVISED -		SCALE: SHEET OF SHEETS STA. TO STA.			CONTRACT NO. 66F63				
											ILLINOIS FED. AID PROJECT	

ORIGINAL SURVEY	SURVEYED	BY	DATE
NOTE BOOK	PLOTTED		
	TEMPLATE		
	AREAS		
	AREAS CHECKED		

FINAL SURVEY	SURVEYED	BY	DATE
NOTE BOOK	PLOTTED		
	TEMPLATE		
	AREAS		
	AREAS CHECKED		

FILE NAME :  
 D:\110848BID\INTG\111nos\gpr\1001\Documents\1001\1001\Drawings\Drawings\0366\F3-corridor.dgn  
 USER NAME : budgrskm  
 PLOT SCALE : 28.0000 / in.  
 PLOT DATE : 8/5/2016

DESIGNED :  
 CHECKED :  
 DATE :

REVISED :  
 REVISED :  
 REVISED :

**STATE OF ILLINOIS**  
**DEPARTMENT OF TRANSPORTATION**

SCALE :  
 SHEET OF SHEETS STA. 504+50.00 R2 TO STA. 504+83.00 R2

**CROSS SECTIONS - IL 126**  
 FAULT REF. 319 SECTION (119) N COUNTY KENNALL CONTRACT NO. 66F63 TOTAL SHEET NO. 29 SHEETS 16 ILLINOIS FED. AID PROJECT

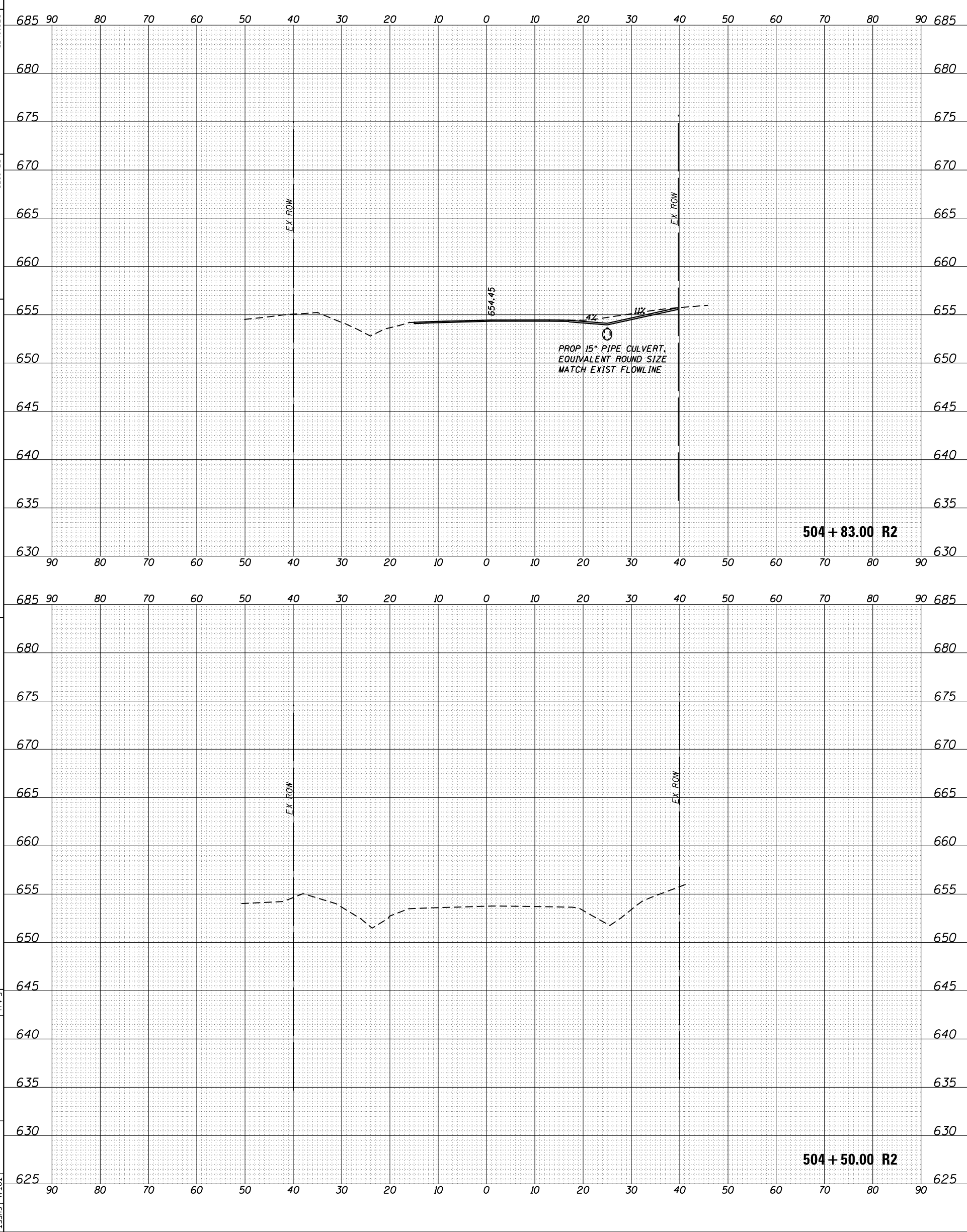







ORIGINAL SURVEY	SURVEYED	BY	DATE
NOTE BOOK	PLOTTED		
	TEMPLATE		
	AREAS		
	AREAS CHECKED		

FINAL SURVEY	SURVEYED	BY	DATE
NOTE BOOK	PLOTTED		
	TEMPLATE		
	AREAS		
	AREAS CHECKED		

FILE NAME :  
 path:\IL094EBID\NTG\IL11nos\gpr\I001\_Documents\I001\_0ffices\District\_3\Projects\0366\F3\CD\RAW\NWD\amimga\_0366\F3-corridor.dgn  
 USER NAME : budgrskm  
 PLOT SCALE : 28,0000' / in.  
 PLOT DATE : 8/5/2016

DESIGNED :  
 CHECKED :  
 DATE :

REVISED :  
 REVISED :  
 REVISED :

STATE OF ILLINOIS  
 DEPARTMENT OF TRANSPORTATION

SCALE :  
 SHEET OF SHEETS : STA. 506+80.00 R2 TO STA. 507+00.00 R2  
 CROSS SECTIONS - IL 126

FAU. REF. 319  
 SECTION 1191 N  
 COUNTY KENDALL  
 TOTAL SHEET NO. 29  
 SHEETS 19  
 CONTRACT NO. 66F63  
 ILLINOIS FED. AID PROJECT

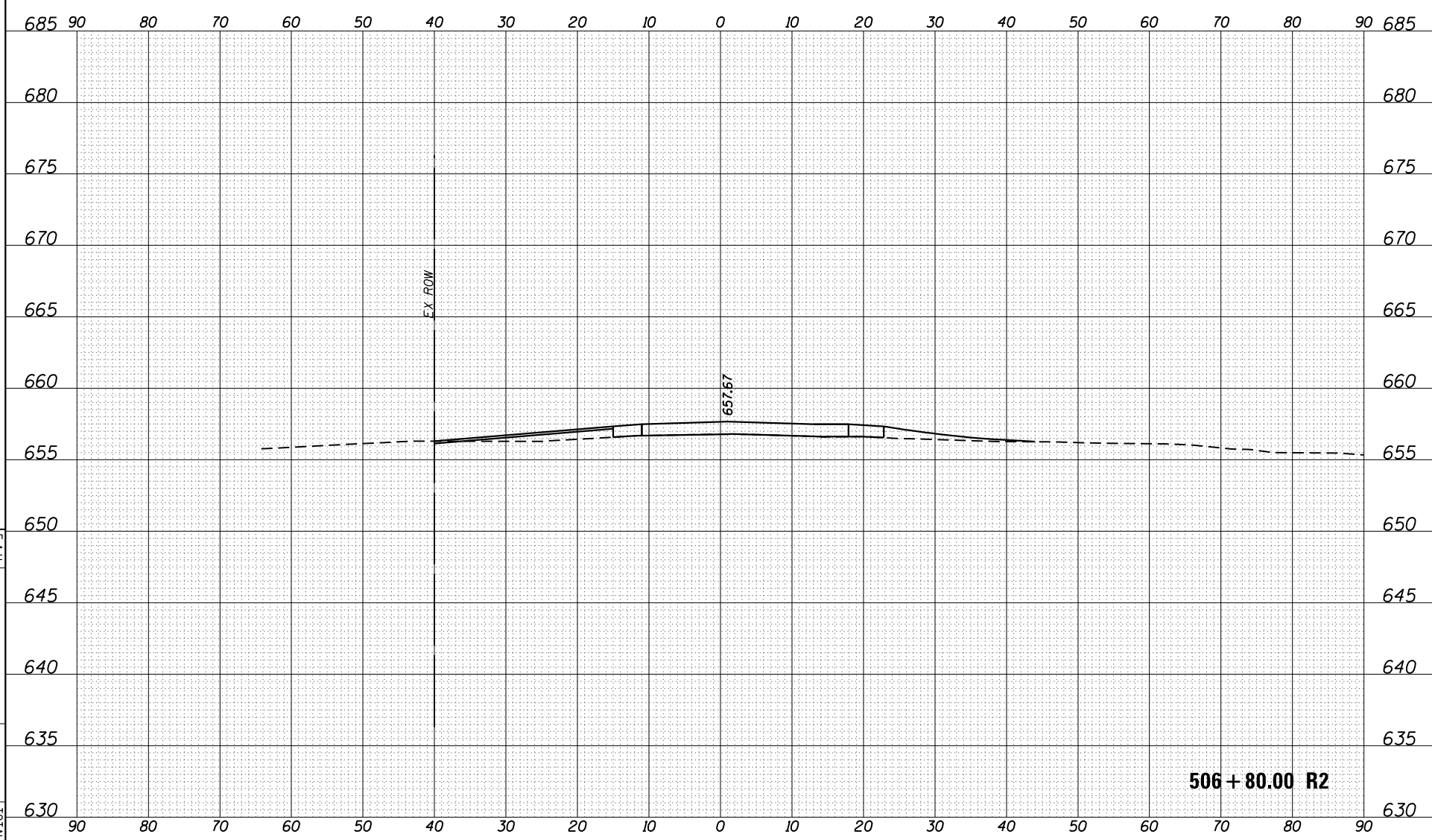
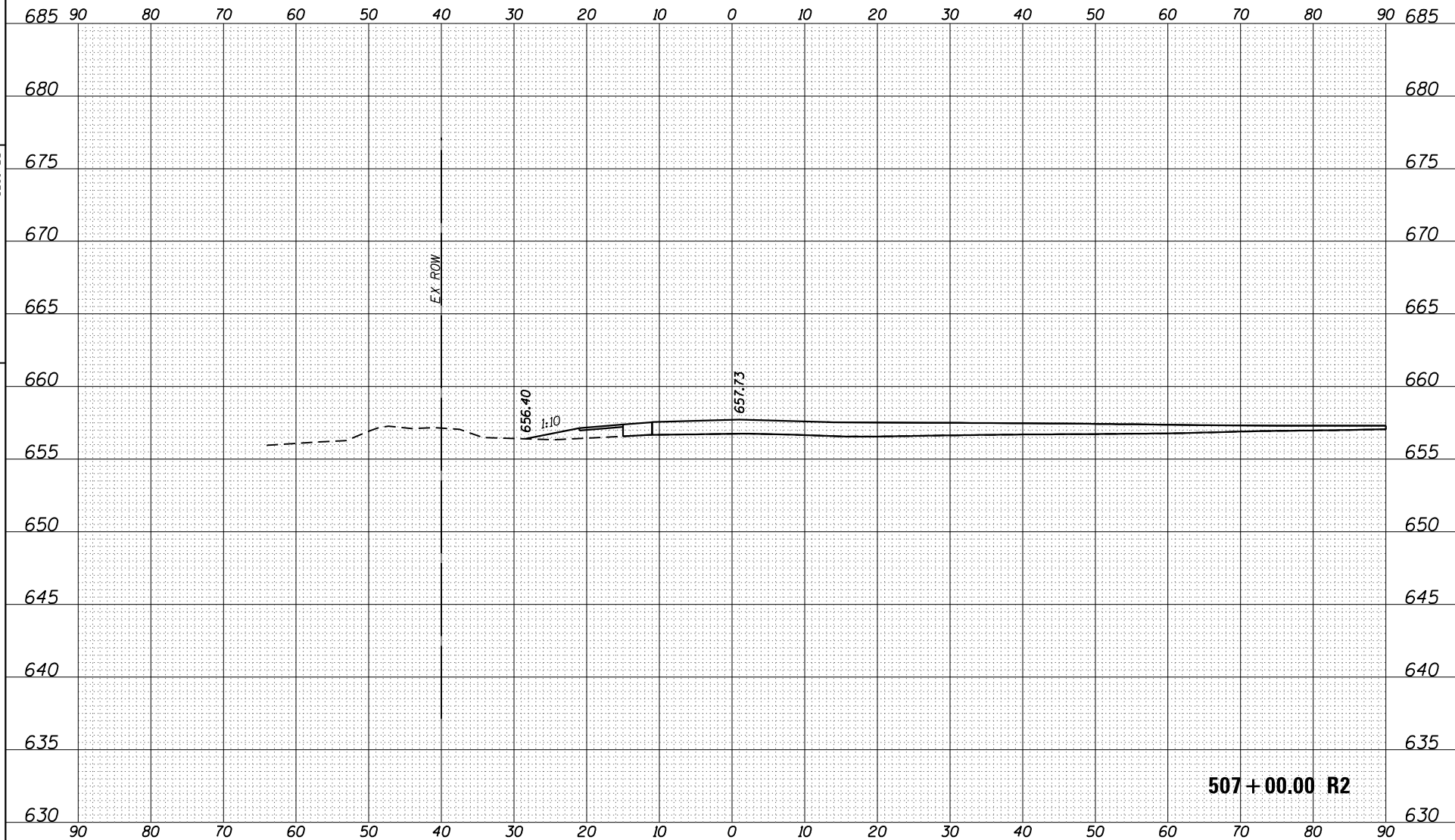



ORIGINAL SURVEY	SURVEYED	BY	DATE
NOTE BOOK	PLOTTED		
	TEMPLATE		
	AREAS		
	AREAS CHECKED		

FINAL SURVEY	SURVEYED	BY	DATE
NOTE BOOK	PLOTTED		
	TEMPLATE		
	AREAS		
	AREAS CHECKED		

FILE NAME :  
 path:\IL084E8B1D\ITG\11nos\gpr\1001\Documents\1001\001\Areas\District\_3\Projects\0366\F3\CD\DR\AM\1001\amimg\0366\F3-corridor.dgn  
 USER NAME : budgprskm  
 PLOT SCALE : 28.0000 / in.  
 PLOT DATE : 8/5/2016

DESIGNED :  
 CHECKED :  
 DATE :  
 REVISED :  
 REVISED :  
 REVISED :

STATE OF ILLINOIS  
 DEPARTMENT OF TRANSPORTATION

SCALE :  
 SHEET OF SHEETS STA. 508+00.00 R2 TO STA. 508+50.00 R2  
 CROSS SECTIONS - IL 126  
 E.A.U. R/E. 319 SECTION 1191 N COUNTY KENDALL TOTAL SHEET NO. 29 SHEETS 21 CONTRACT NO. 66F63 ILLINOIS FED. AID PROJECT

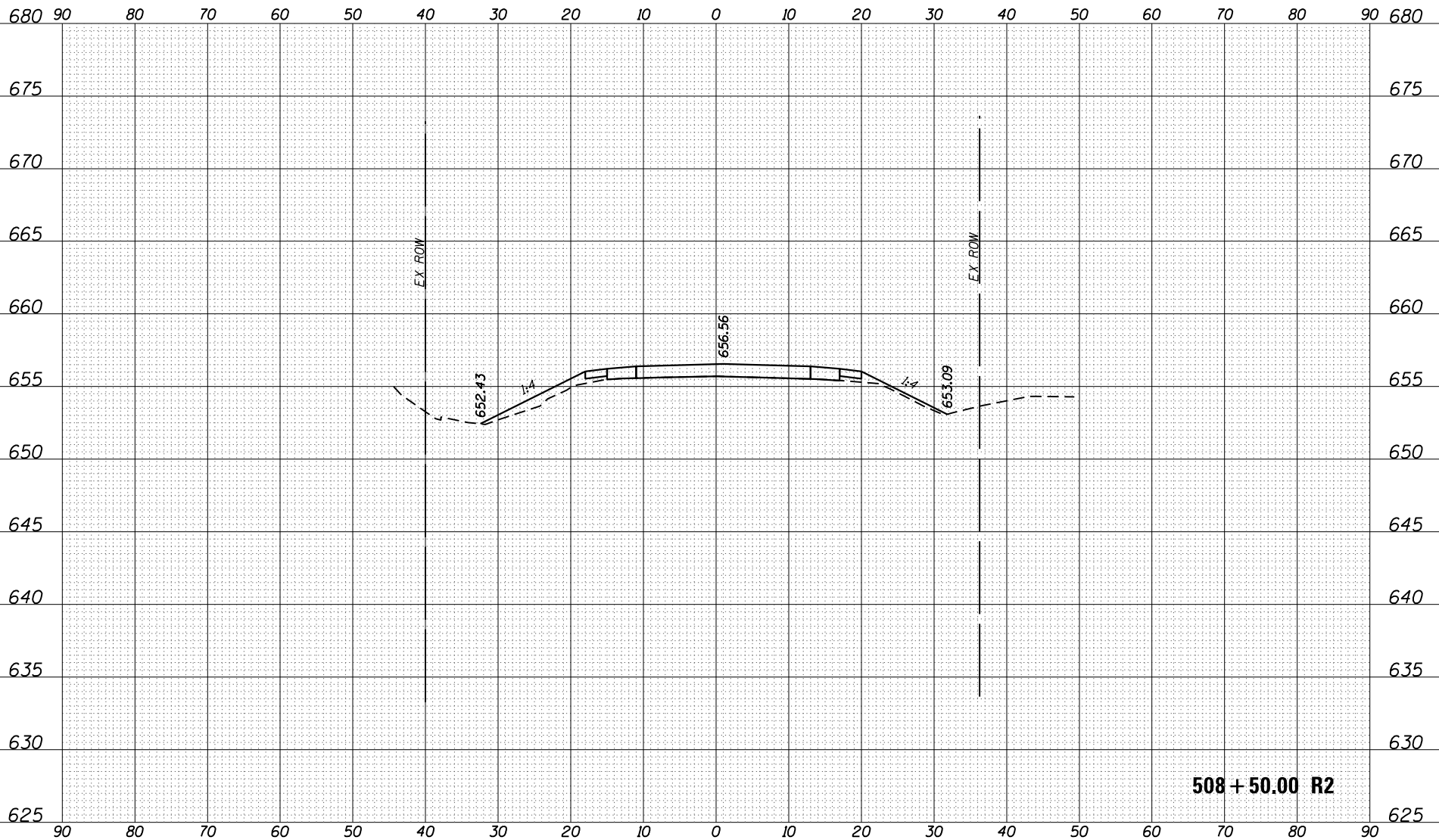

508 + 50.00 R2

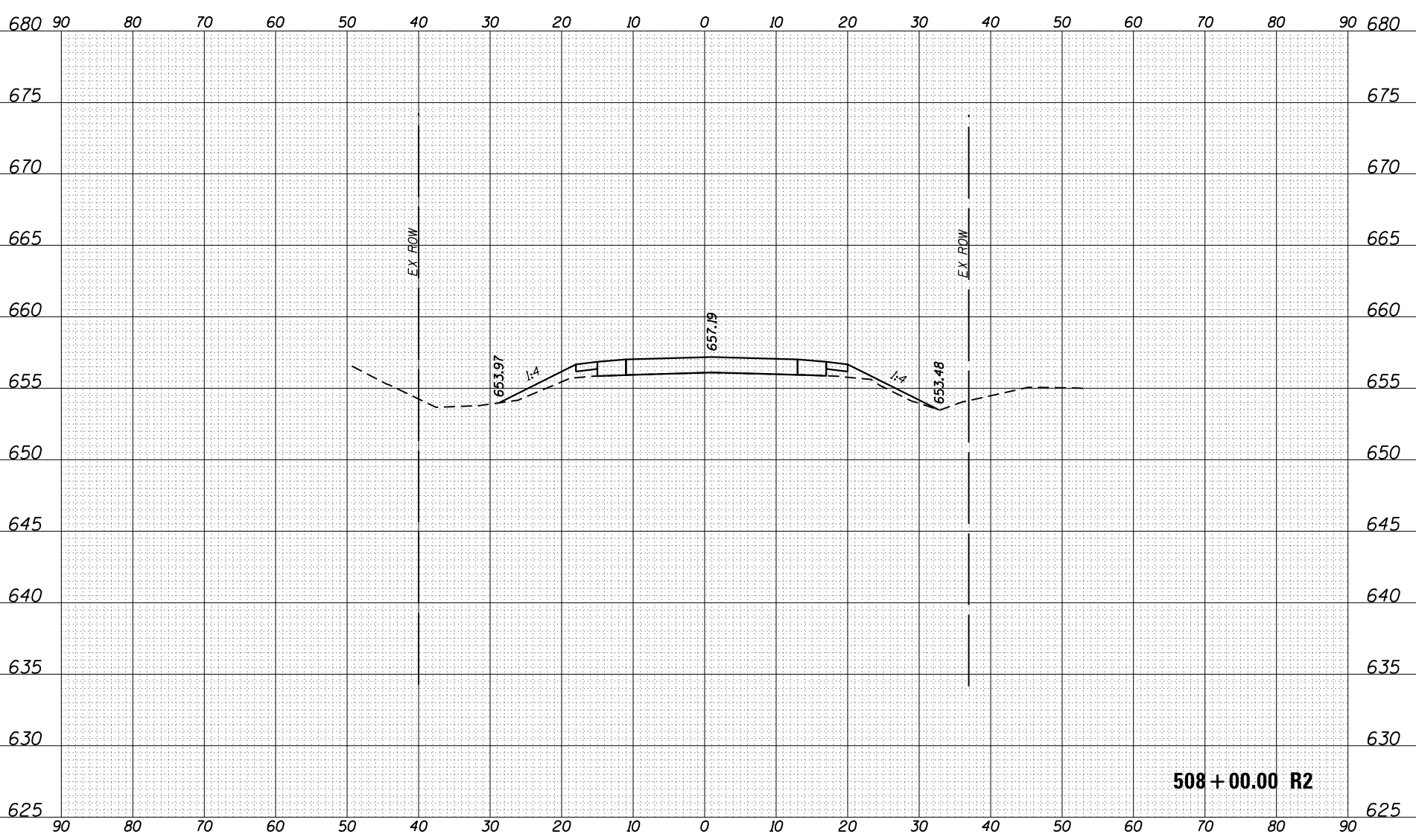

508 + 00.00 R2

ORIGINAL SURVEY	SURVEYED	BY	DATE
NOTE BOOK	PLOTTED		
	TEMPLATE		
	AREAS		
	AREAS CHECKED		

FINAL SURVEY	SURVEYED	BY	DATE
NOTE BOOK	PLOTTED		
	TEMPLATE		
	AREAS		
	AREAS CHECKED		

FILE NAME :  
 path:\IL084E8BID\NTFC\11nos\gpr\1001 Documents\1001 Offices\District 3\Projects\0366\F3\CD\RA\MM\ddr-amrimg-0366\F3-corridor.dgn  
 USER NAME : budgrskm  
 PLOT SCALE : 28.0000 / in.  
 PLOT DATE : 8/5/2016

DESIGNED :  
 CHECKED :  
 DATE :

REVISED :  
 REVISED :  
 REVISED :

STATE OF ILLINOIS  
 DEPARTMENT OF TRANSPORTATION

CROSS SECTIONS - IL 126  
 SCALE: SHEET OF SHEETS STA. 509+00.00 R2 TO STA. 509+50.00 R2

FAU. REF. 319 SECTION (119) N COUNTY KENDALL CONTRACT NO. 66F63 TOTAL SHEET NO. 29 OF 22 ILLINOIS FED. AID PROJECT

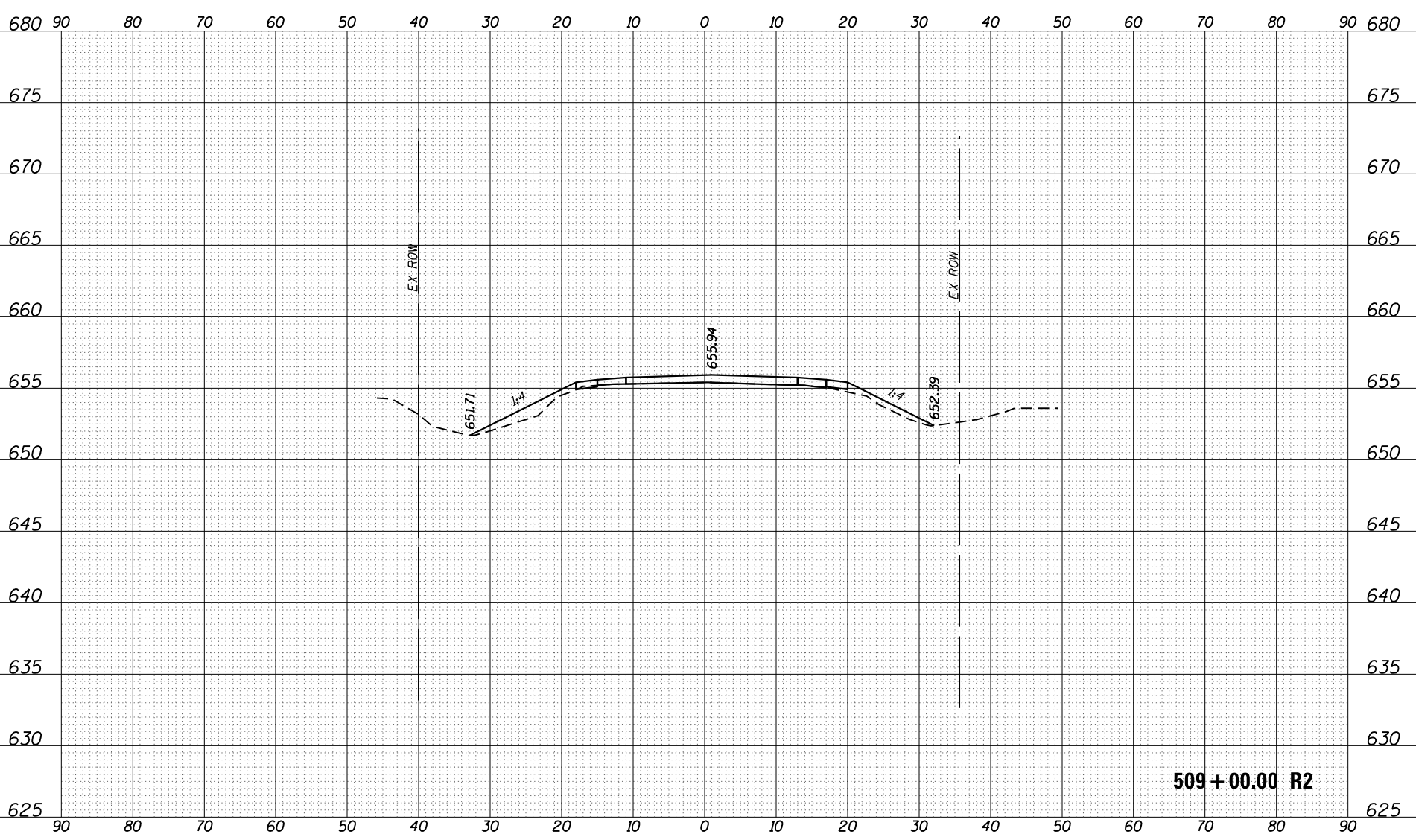
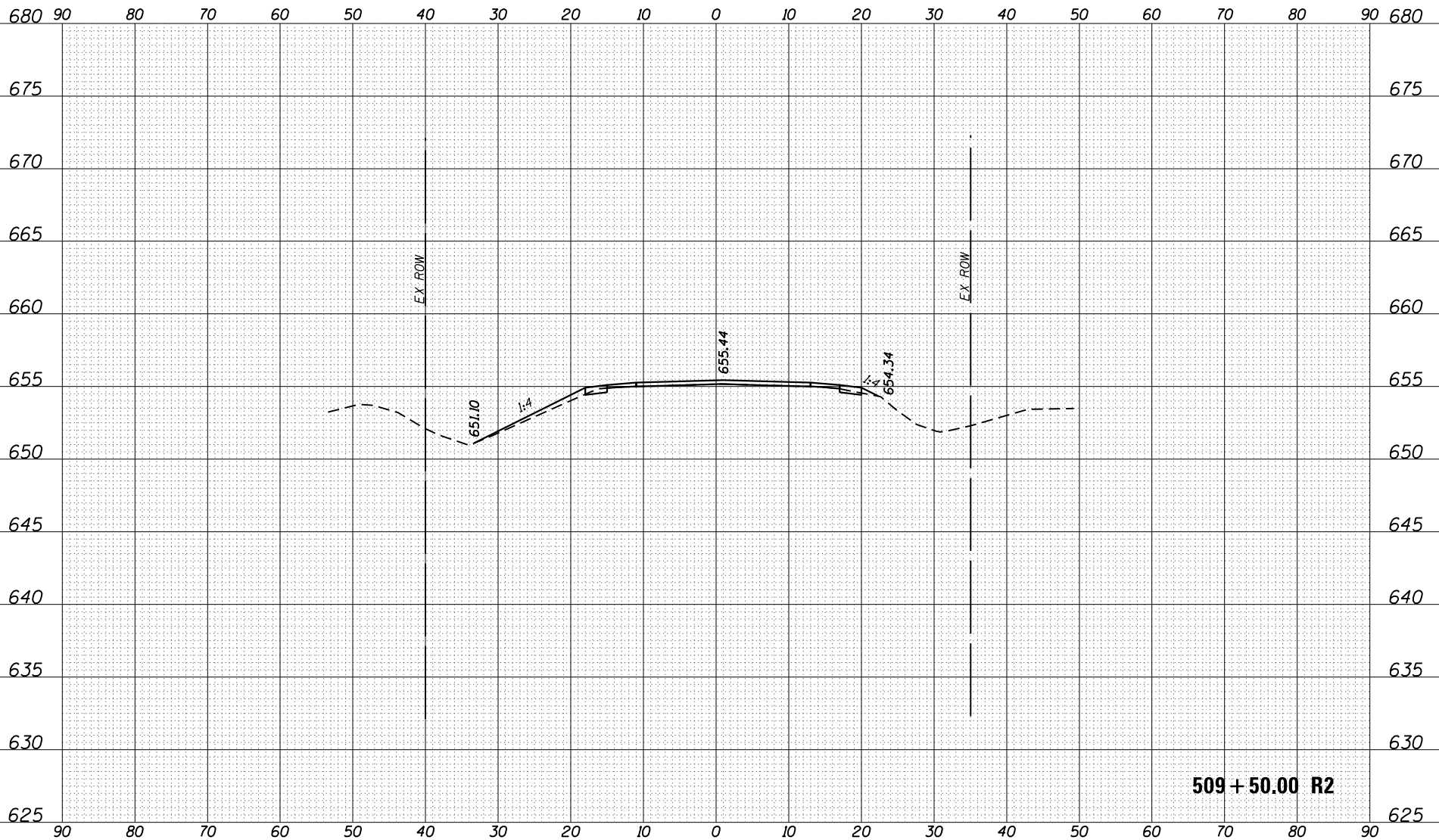

ORIGINAL SURVEY	SURVEYED	BY	DATE
NOTE BOOK	PLOTTED		
	TEMPLATE		
	AREAS		
	AREAS CHECKED		

FINAL SURVEY	SURVEYED	BY	DATE
NOTE BOOK	PLOTTED		
	TEMPLATE		
	AREAS		
	AREAS CHECKED		

FILE NAME :  
 path:\IL0948E8D0\NTEG\11nos+gpr\1001 Documents\1001  
 USER NAME : budgfrskm  
 OFFICE : District 3 Projects\0366F63\0948E8D0\1001-omg\0366F63-corridor.dgn  
 PLOT SCALE : 28.0000 / in.  
 PLOT DATE : 8/5/2016

DESIGNED :  
 CHECKED :  
 DATE :

REVISED :  
 REVISED :  
 REVISED :

STATE OF ILLINOIS  
 DEPARTMENT OF TRANSPORTATION

CROSS SECTIONS - IL 126  
 SCALE :  
 SHEET OF SHEETS STA. 510+00.00 R2 TO STA. 510+50.00 R2

FAU. RT# 319 SECTION 1191 N COUNTY KENNALL TOTAL SHEET NO. 29 SHEETS 23 CONTRACT NO. 66F63 ILLINOIS FED. AID PROJECT

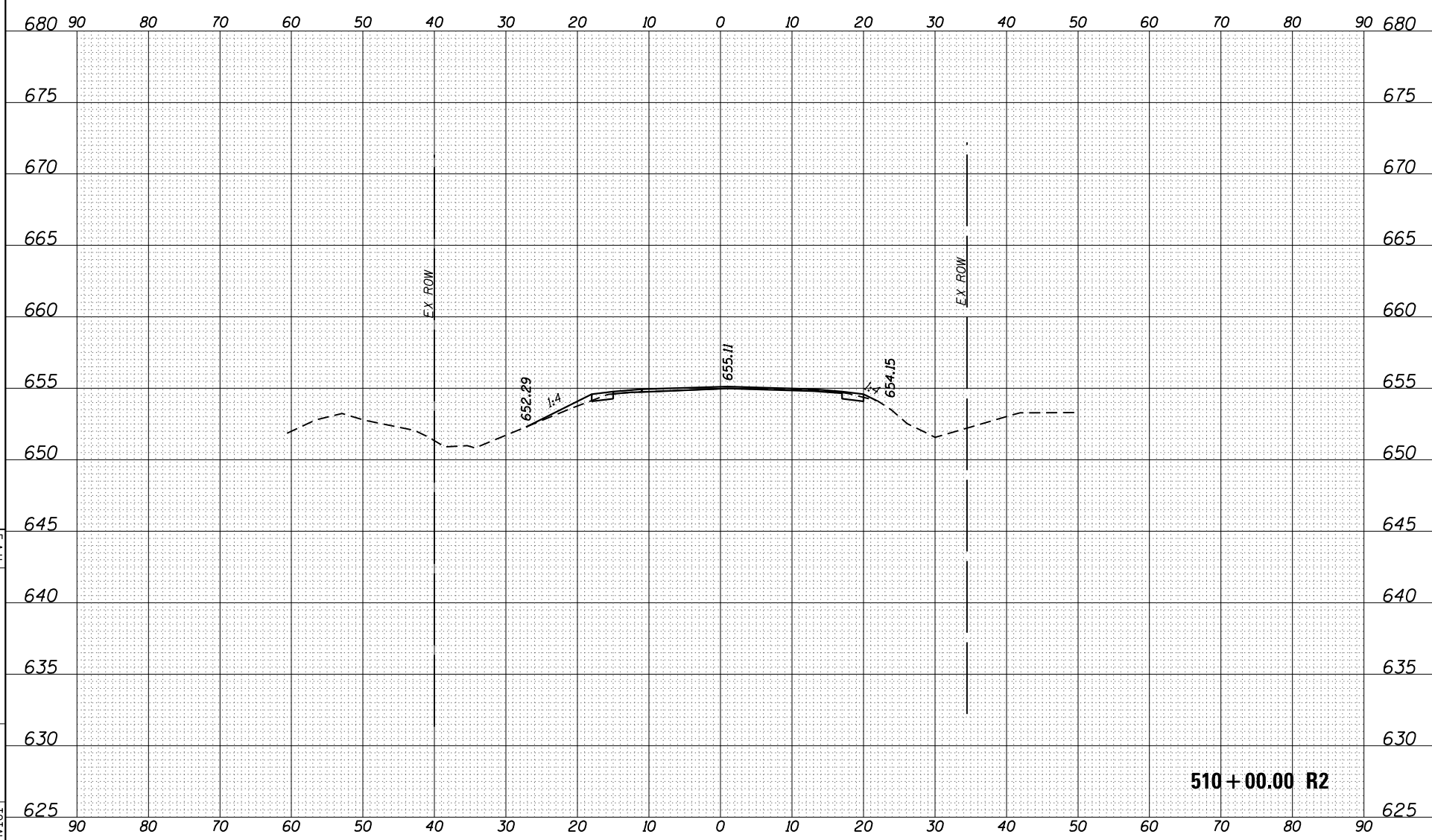
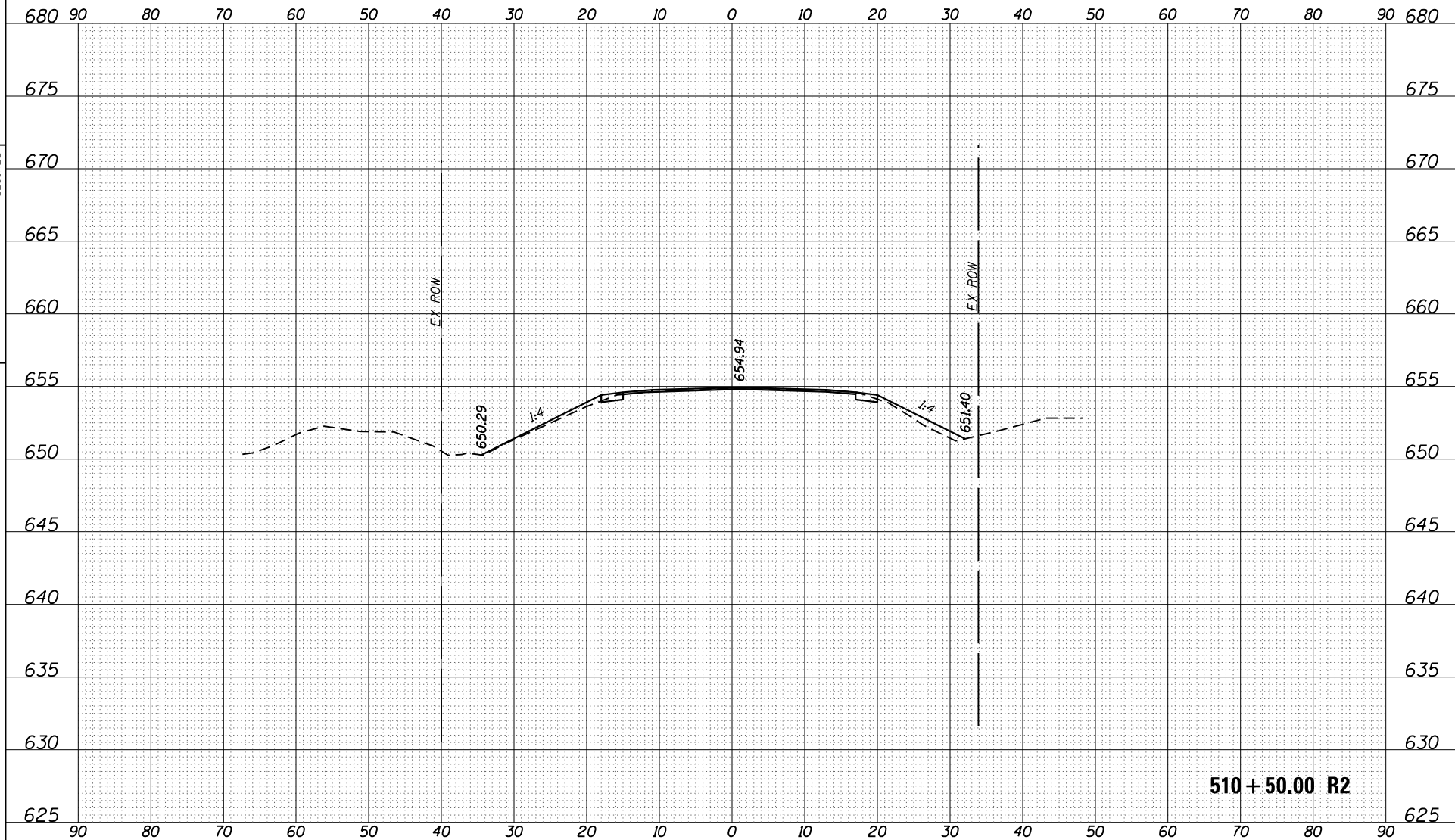

ORIGINAL SURVEY	SURVEYED	BY	DATE
NOTE BOOK	PLOTTED		
	TEMPLATE		
	AREAS		
	AREAS CHECKED		

FINAL SURVEY	SURVEYED	BY	DATE
NOTE BOOK	PLOTTED		
	TEMPLATE		
	AREAS		
	AREAS CHECKED		

FILE NAME :  
 path:\IL094E8D10F6C4\11nos+gpr\1001 Documents\1001 Offices\District 3\Projects\0366F63\0366F63-corridor.dgn  
 USER NAME : budgprskm  
 PLOT SCALE : 28.0000 / in.  
 PLOT DATE : 8/5/2016

DESIGNED :  
 CHECKED :  
 DATE :

REVISED :  
 REVISED :  
 REVISED :

STATE OF ILLINOIS  
 DEPARTMENT OF TRANSPORTATION

CROSS SECTIONS - IL 126  
 SHEET OF SHEETS STA. 511+00.00 R2 TO STA. 511+50.00 R2

SCALE:  
 SHEET OF SHEETS STA. 511+00.00 R2 TO STA. 511+50.00 R2  
 F.A.U. R/E: 319  
 SECTION: (1)91 N  
 COUNTY: KENDALL  
 TOTAL SHEET NO.: 29  
 SHEETS: 24  
 CONTRACT NO.: 66F63  
 ILLINOIS FED. AID PROJECT

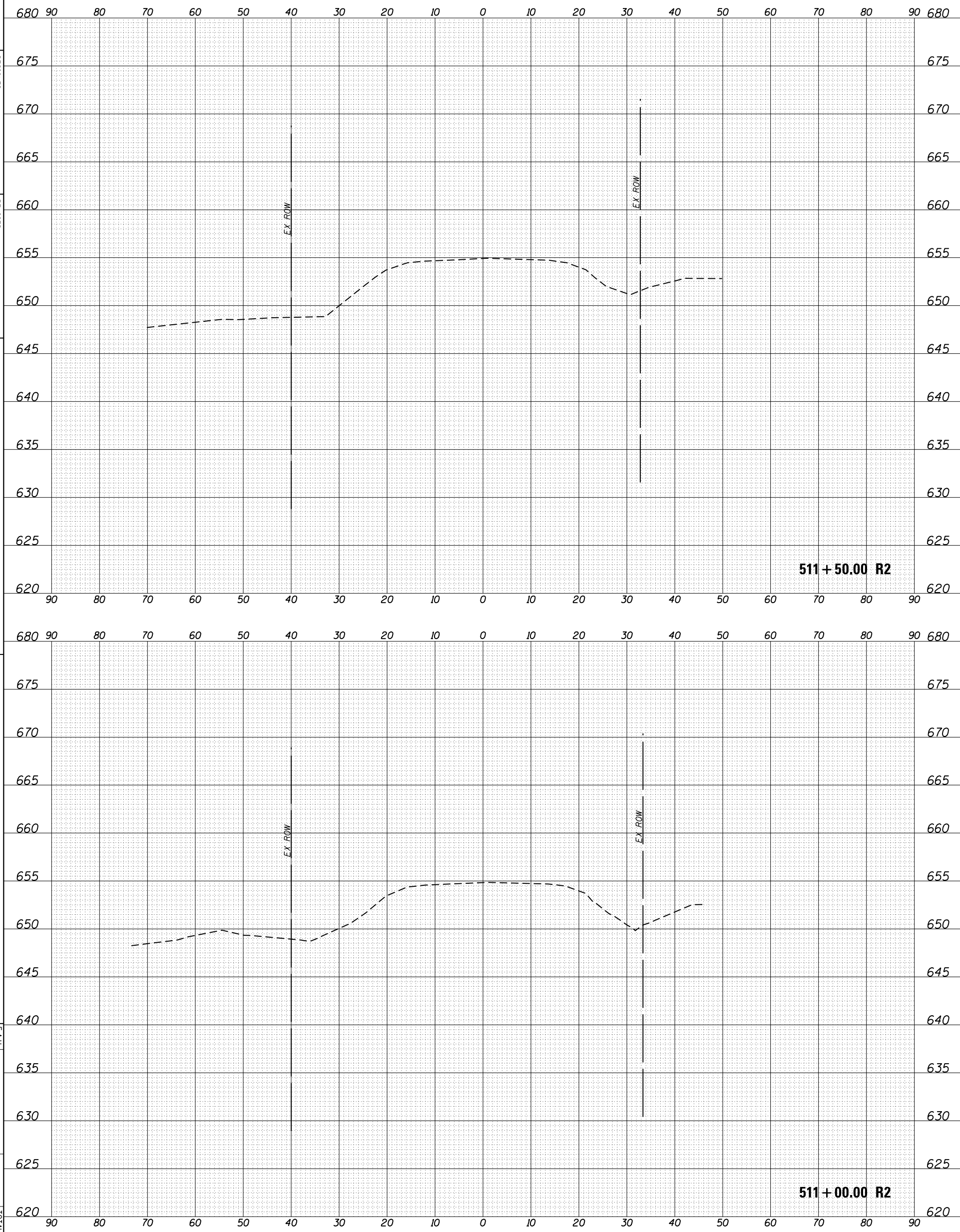





ORIGINAL SURVEY	SURVEYED	BY	DATE
NOTE BOOK	PLOTTED		
	TEMPLATE		
	AREAS		
	AREAS CHECKED		

FINAL SURVEY	SURVEYED	BY	DATE
NOTE BOOK	PLOTTED		
	TEMPLATE		
	AREAS		
	AREAS CHECKED		

FILE NAME :  
 par\\11084EBID\NTG\G\11nos\sgp\FM\DOT Documents\11001 Offices\District 3\Projects\0366\F3\CD\RAW\NWD\drawing\0366\F3-corridor.dgn  
 USER NAME : budgrskm  
 PLOT SCALE : 28,000' / in.  
 PLOT DATE : 8/5/2016

DESIGNED :  
 CHECKED :  
 DATE :

REVISED :  
 REVISED :  
 REVISED :

STATE OF ILLINOIS  
 DEPARTMENT OF TRANSPORTATION

SCALE :  
 SHEET OF SHEETS STA. 128+09.00 R1 TO STA. 128+25.00 R1

CROSS SECTIONS - OLD RIDGE RD  
 E.A.U. 319  
 SECTION 1191 N  
 COUNTY KENDALL  
 TOTAL SHEET NO. 29  
 SHEETS 26  
 ILLINOIS FED. AID PROJECT CONTRACT NO. 66F63

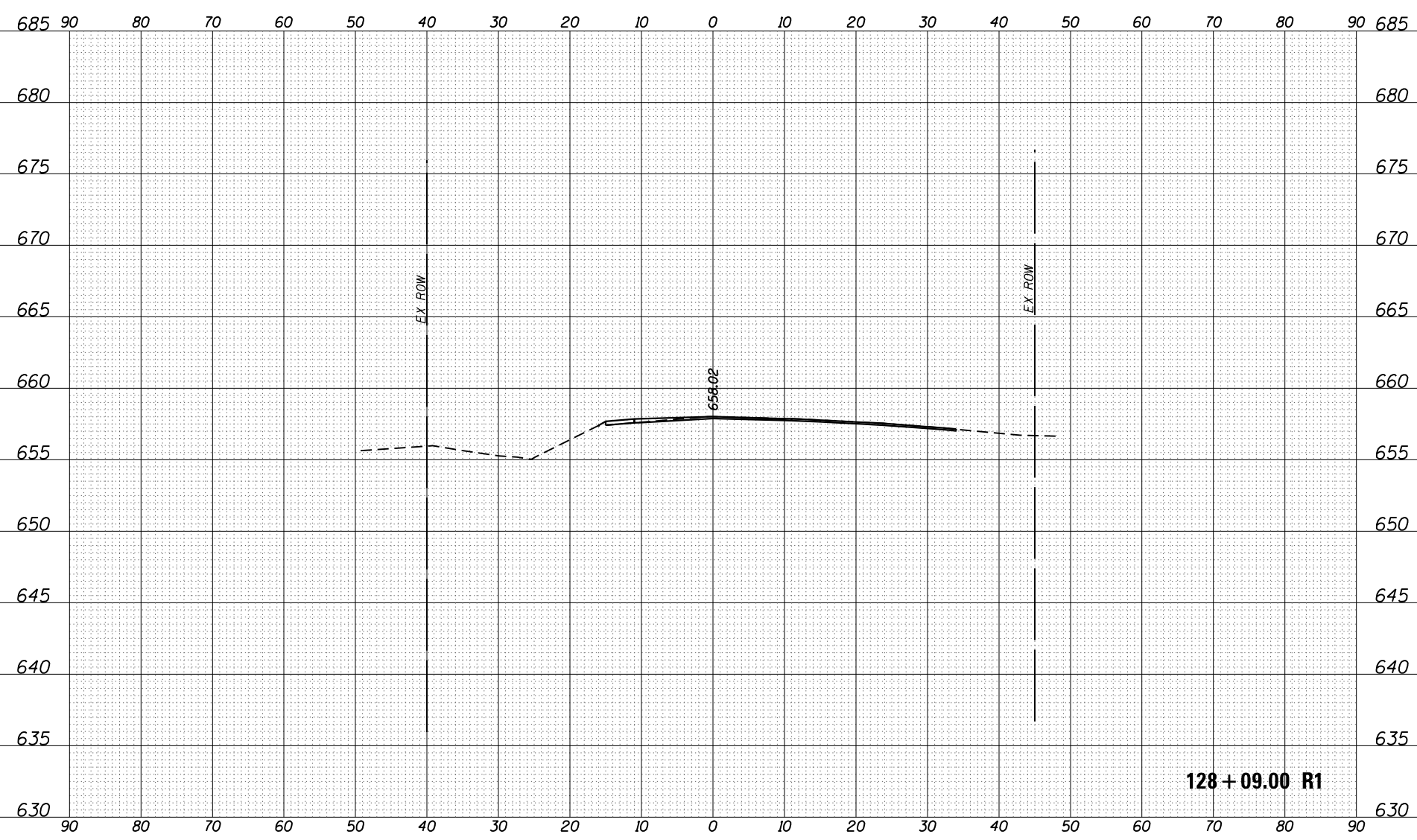
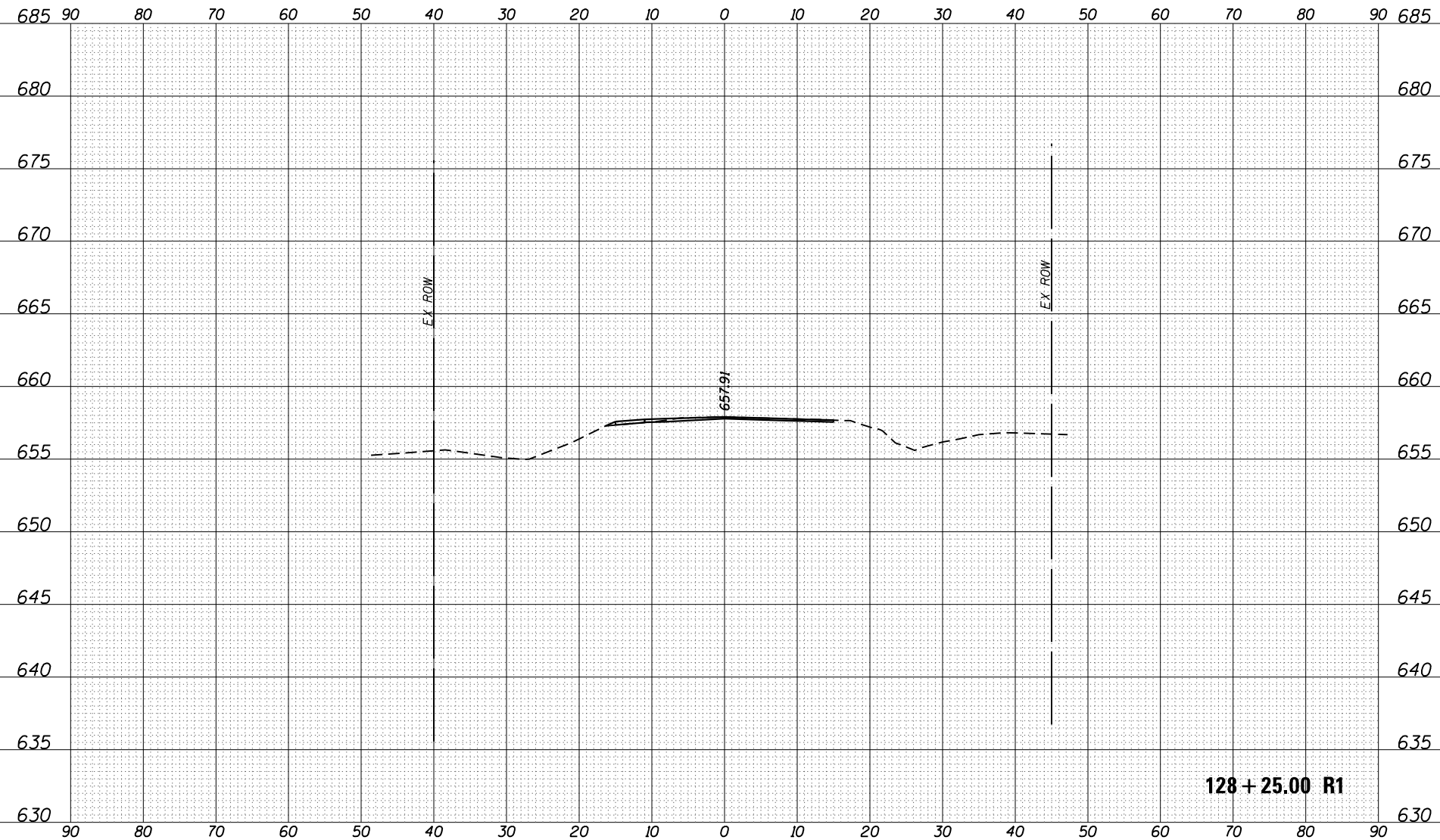

ORIGINAL SURVEY	SURVEYED	BY	DATE
NOTE BOOK	PLOTTED		
	TEMPLATE		
	AREAS		
	AREAS CHECKED		

FINAL SURVEY	SURVEYED	BY	DATE
NOTE BOOK	PLOTTED		
	TEMPLATE		
	AREAS		
	AREAS CHECKED		

FILE NAME :  
 par\\11084EBID\NTFC\111nos\sgp\p\1001 Documents\1001 Offices\District 3\Projects\0366\F3\CD\DRAWING\0366\F3-corridor.dgn  
 USER NAME : budjgrskm  
 PLOT SCALE : 28.0000 / in.  
 PLOT DATE : 8/5/2016

DESIGNED :  
 CHECKED :  
 DATE :

REVISED :  
 REVISED :  
 REVISED :  
 DATE :

STATE OF ILLINOIS  
 DEPARTMENT OF TRANSPORTATION

CROSS SECTIONS - OLD RIDGE RD  
 SHEET OF SHEETS STA. 128+50.00 R1 TO STA. 128+75.00 R1

FAU. RFE. 319 SECTION (119) N COUNTY KENALL CONTRACT NO. 66F63 TOTAL SHEET SHEETS 29 27 ILLINOIS FED. AID PROJECT

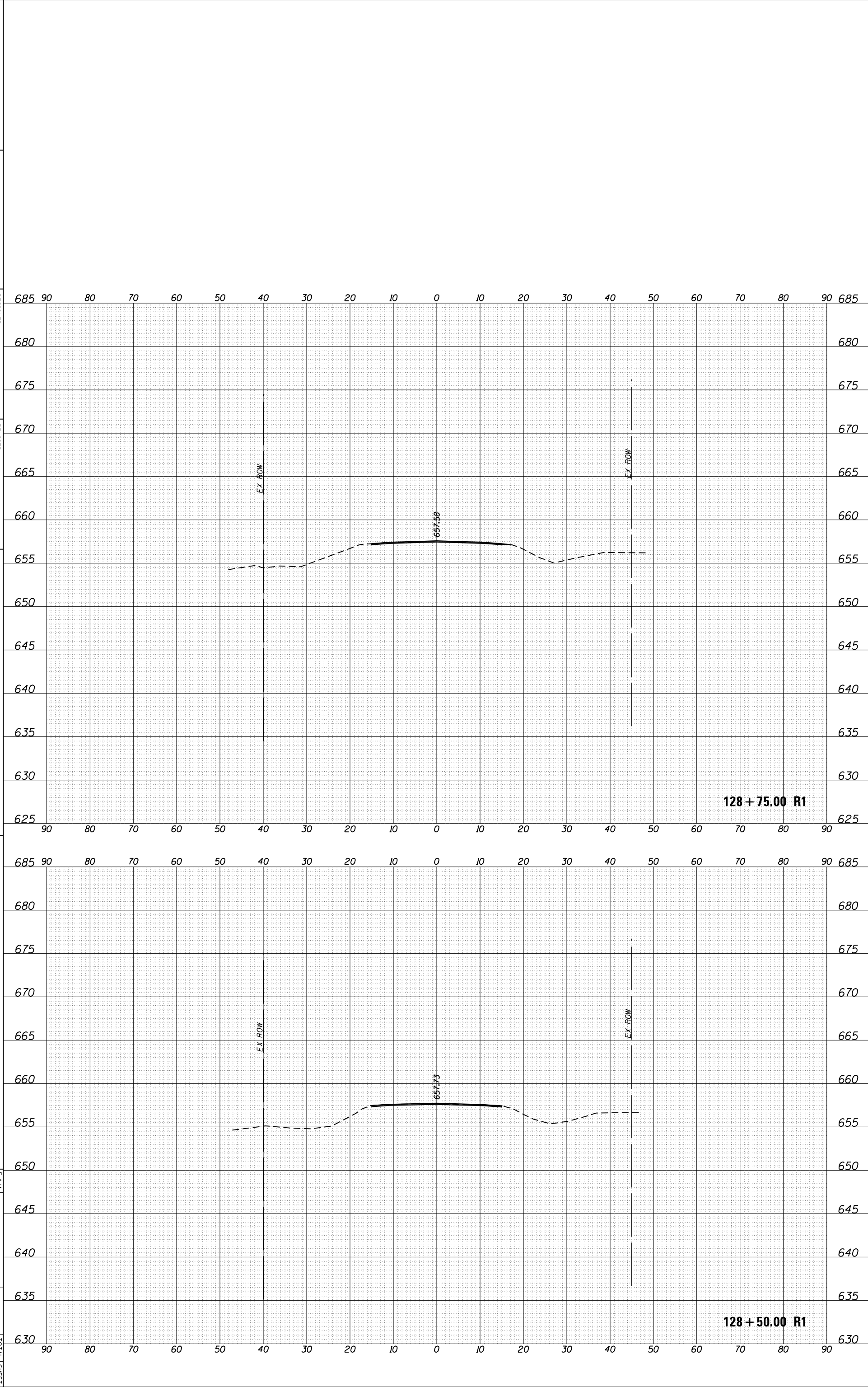

ORIGINAL SURVEY	SURVEYED _____	BY _____	DATE _____
NOTE BOOK	PLOTTED _____		
	TEMPLATE _____		
	AREAS _____		
	AREAS CHECKED _____		

FINAL SURVEY	SURVEYED _____	BY _____	DATE _____
NOTE BOOK	PLOTTED _____		
	TEMPLATE _____		
	AREAS _____		
	AREAS CHECKED _____		

FILE NAME :   
 USER NAME : budgrskm  
 DESIGNED :   
 CHECKED :   
 DATE :   
 REVISED :   
 REVISED :   
 REVISED :   
 DEPARTMENT OF TRANSPORTATION  
 SCALE :   
 SHEET OF SHEETS STA. 129+00.00 RI TO STA. 129+25.00 RI  
 CROSS SECTIONS - OLD RIDGE RD  
 E.A.U. REF. 319 SECTION 1191 N COUNTY KENDALL TOTAL SHEET NO. 29 SHEETS 28  
 ILLINOIS FED. AID PROJECT CONTRACT NO. 66F63

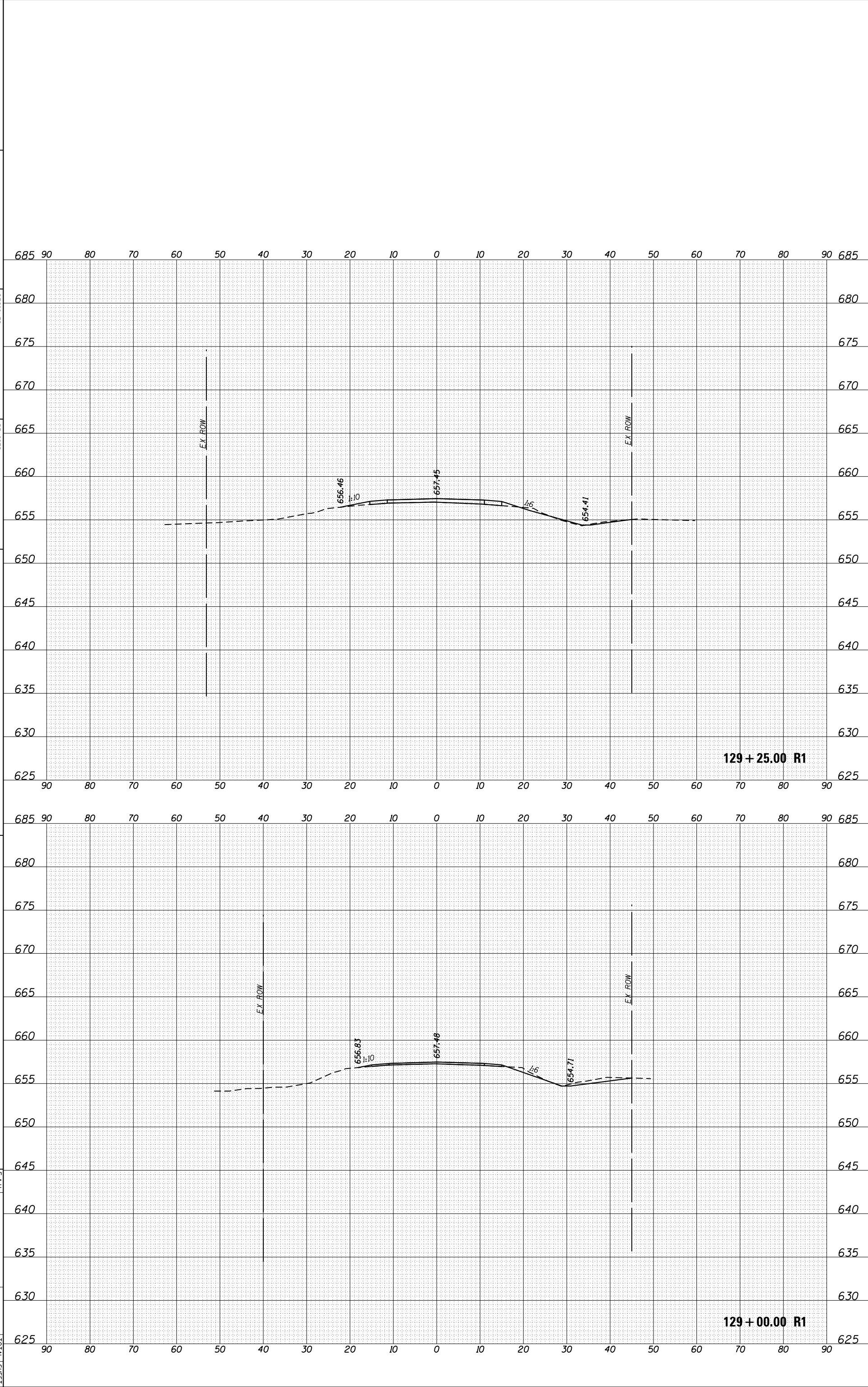

ORIGINAL SURVEY	SURVEYED	BY	DATE
NOTE BOOK	PLOTTED		
	TEMPLATE		
	AREAS		
NO.	AREAS CHECKED		

FINAL SURVEY	SURVEYED	BY	DATE
NOTE BOOK	PLOTTED		
	TEMPLATE		
	AREAS		
NO.	AREAS CHECKED		

FILE NAME :  
 par\\110848BID\NTFC\11nos\sgp\m\DOT Documents\11DOT Offices\District 3\Projects\0366\F3\CD\DRAWING\Old\_ridge\amings\_0366\F3-corridor.dgn  
 USER NAME : budgrskm  
 PLOT SCALE : 28,000' / in.  
 PLOT DATE : 8/5/2016

DESIGNED :  
 CHECKED :  
 DATE :

REVISID :  
 REVISID :  
 REVISID :

STATE OF ILLINOIS  
 DEPARTMENT OF TRANSPORTATION

CROSS SECTIONS - OLD RIDGE RD

SCALE: SHEET OF SHEETS STA. 129+50.00 R1 TO STA. 129+75.00 R1

FAU. REF. 319 SECTION (119) N COUNTY KENNALL CONTRACT NO. 66F63 TOTAL SHEET NO. 29

ILLINOIS FED. AID PROJECT

