

ROUTE	SECTION	COUNTY	TOT. SHEETS	SHEET
FAS 826	15-00212-00-RS	JEFFERSON	4	1
JEFFERSON COUNTY ROAD DISTRICT				

INDEX OF SHEETS	
1.	COVER SHEET, LOCATION MAP, SCHEDULE OF QUANTITIES
2.	GENERAL NOTES, TYPICAL EXISTING AND PROPOSED CROSS-SECTIONS (1)
3.	STRIPING SCHEDULE, MILLING SCHEDULE, HOT MIX QUANTITIES, PROPOSED CROSS-SECTION (2)
4.	CROSS-SECTION ON STRUCTURE

STATE OF ILLINOIS
DEPARTMENT OF TRANSPORTATION
DIVISION OF HIGHWAYS

PLANS FOR PROPOSED
FEDERAL AID SECONDARY PROJECT

FAS 826 / CH 10 / E. RICHVIEW ROAD
SECTION 15-00212-00-RS
JEFFERSON COUNTY
PROJECT # RS-0826(116)
JOB # C-99-526-16
CONTRACT 99569

SCHEDULE OF QUANTITIES

CODE NUMBER	ITEM	UNIT OF MEASURE	QUANTITY
20200600	EXCAVATING AND GRADING EXISTING SHOULDER	UNIT	476
40200800	AGGREGATE SURFACE COURSE, TYPE B	TON	135
40600290	BITUMINOUS MATERIALS (TACK COAT)	POUNDS	50509
40600625	LEVELING BINDER (MACHINE METHOD), N50	TON	1618
40600982	HOT-MIX ASPHALT SURFACE REMOVAL - BUTT JOINT	SQ YD	1575
40600990	TEMPORARY RAMP	SQ YD	210
40603310	HOT-MIX ASPHALT SURFACE COURSE, MIX "C", N50	TON	4859
44000157	HOT-MIX ASPHALT SURFACE REMOVAL, 2"	SQ YD	255
44000161	HOT-MIX ASPHALT SURFACE REMOVAL, 3"	SQ YD	225
48101200	AGGREGATE SHOULDERS, TYPE B	TON	680
48203017	HOT-MIX ASPHALT SHOULDERS, 5"	SQ YD	5291
67100100	MOBILIZATION	L SUM	1
70100460	TRAFFIC CONTROL AND PROTECTION, STANDARD 701306	L SUM	1
70300100	SHORT TERM PAVEMENT MARKING	FOOT	4833
70300150	SHORT TERM PAVEMENT MARKING REMOVAL	SQ FT	810
78000200	THERMOPLASTIC PAVEMENT MARKING LINE 4"	FOOT	63939

STANDARDS Δ SPECIALTY ITEMS

- 000001-06
- 701006-05
- 701306-03
- 701311-03
- 701901-05
- 780001-05
- BLR 21-9
- BLR 22-7

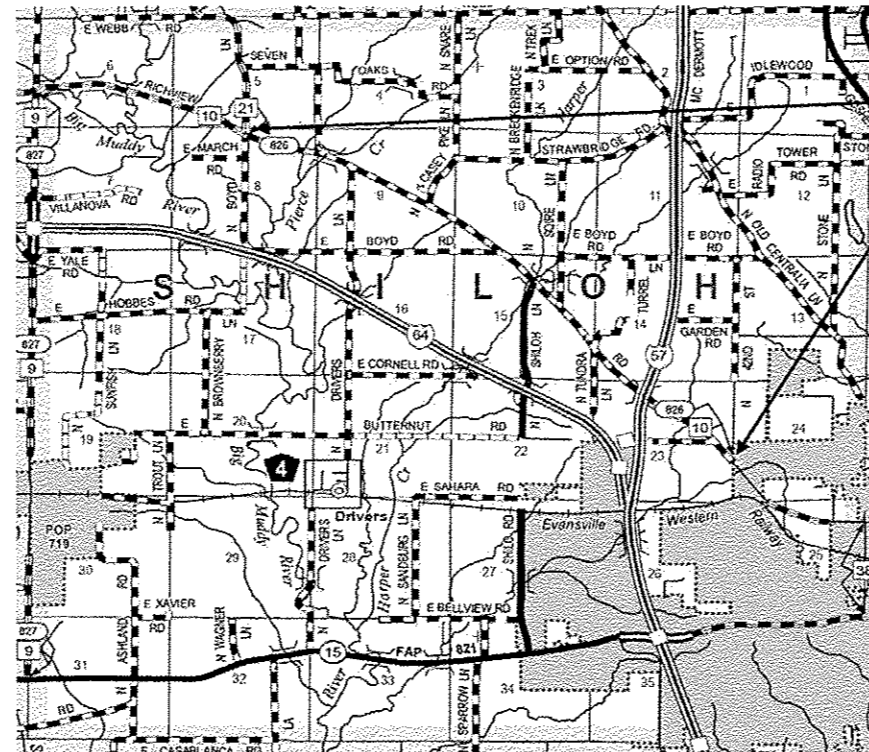

SECTION 15-00212-00-RS
BEGINS 0+00
ENDS 241+68



TOTAL SECTION LENGTH = 24,168 FEET = 4.577 MILES
NET LENGTH = 23,817 FEET = 4.510 MILES
SN 041-3016 and 041-0051 OMITTED

FUNCTIONAL CLASSIFICATION: RURAL MAJOR COLLECTOR

APPROVED

6-28, 2016

[Signature]

COUNTY ENGINEER

JEFFERSON COUNTY HIGHWAY DEPARTMENT
750 OLD FAIRFIELD ROAD
MT. VERNON, IL 62864
PH (618) 244-8031
LICENSE EXP. 11-30-2017

PASSED

JULY 11, 2016

[Signature]

DISTRICT 9 ENGINEER OF
LOCAL ROADS AND STREETS

RELEASING FOR BID

BASED ON

LIMITED REVIEW JULY 11, 2016

[Signature]

JEFFREY L. KEIRN, P.E.
REGION 5 ENGINEER
STATE OF ILLINOIS
DEPARTMENT OF TRANSPORTATION
DISTRICT 9

ROUTE	SECTION	COUNTY	TOT. SHEETS	SHEET
FAS 826	15-00212-00-RS	JEFFERSON	4	2
JEFFERSON COUNTY ROAD DISTRICT				

CONTRACT No. 99569

GENERAL NOTES

THIS SECTION SHALL CONSIST OF HOT-MIX ASPHALT SURFACE COURSE MIX "C" N50. ALL WORK SHALL BE IN ACCORDANCE WITH THE PLANS, SPECIAL PROVISIONS, THE STANDARD SPECIFICATIONS FOR ROAD AND BRIDGE CONSTRUCTION ADOPTED APRIL 1, 2016 BY THE ILLINOIS DEPARTMENT OF TRANSPORTATION AND RECURRING SPECIAL PROVISIONS.

THE EXISTING GRADE, ALIGNMENT, DRAINAGE STRUCTURES AND BASE COURSE WERE CONSTRUCTED UNDER 82-G, PROJECT S-546(5) AND PROJECT DS-546(6) 1958. RESURFACED IN 1978 UNDER SECTION 78-00117-00-RS AND RESURFACED IN 2001 UNDER SECTION 98-00117-01-RS

TYPICAL EXISTING CROSS SECTION
0+00 TO 241+68

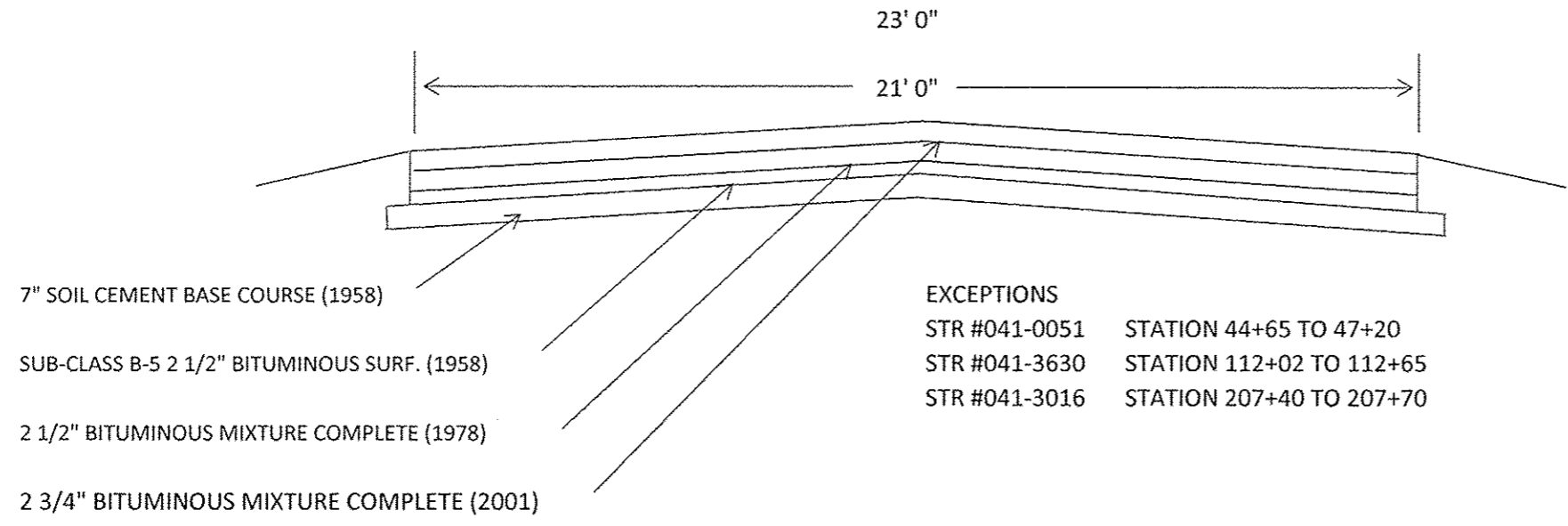

- EXCEPTIONS
- STR #041-0051 STATION 44+65 TO 47+20
 - STR #041-3630 STATION 112+02 TO 112+65
 - STR #041-3016 STATION 207+40 TO 207+70

PROPOSED CROSS-SECTION 114+00 TO 241+68

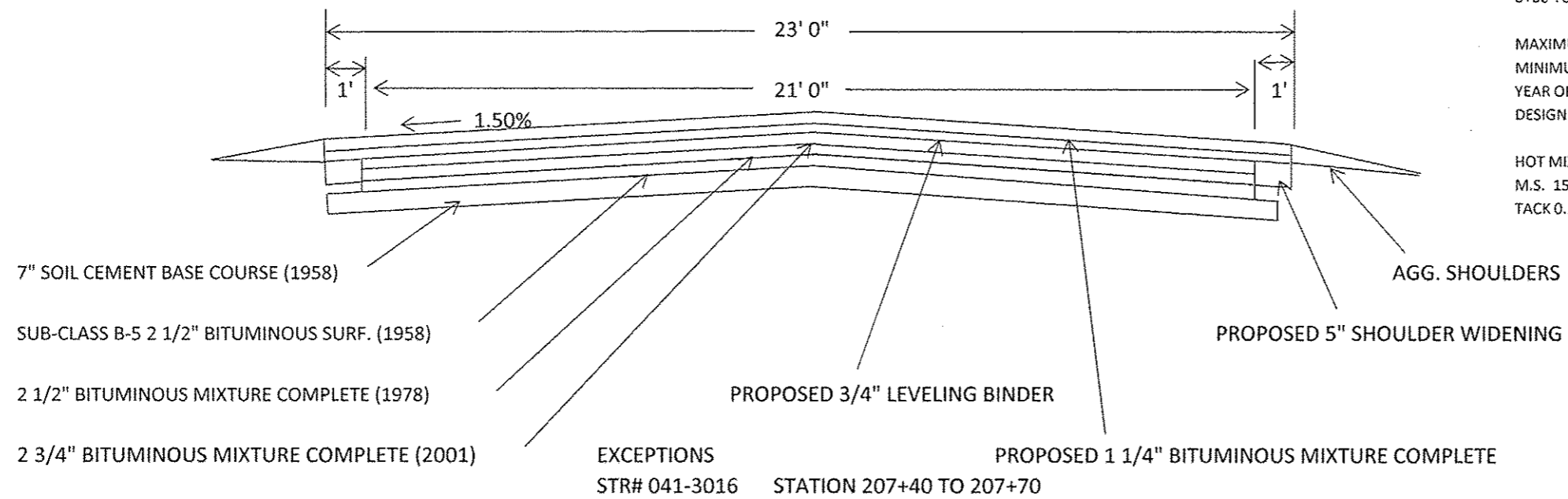

- EXCEPTIONS
- STR# 041-3016 STATION 207+40 TO 207+70

STATION	ADT	PV	SU	MU
0+00 TO 241+68	2650	840	10	--

MAXIMUM GRADE 2.5%
MINIMUM SIGHT DISTANCE > 400'
YEAR OF IMPROVEMENT 2016
DESIGN SPEED 55 MPH

HOT MIX ASPHALT THICKNESS 1 1/2" TO 2"
M.S. 1500 MINIMUM
TACK 0.10 GAL / SY

ROUTE	SECTION	COUNTY	TOT. SHEETS	SHEET
FAS 826	15-00212-00-RS	JEFFERSON	4	3
JEFFERSON COUNTY ROAD DISTRICT				

CONTRACT NO.
99569

STRIPING SCHEDULE							
NO PASSING ZONE				CENTERLINE		EDGELINE	
EASTBOUND		WESTBOUND		BEGINNING	ENDING	BEGINNING	ENDING
BEGINNING	ENDING	BEGINNING	ENDING	BEGINNING	ENDING	BEGINNING	ENDING
13+17	24+26	0+00	18+61	0+00	13+17	0+00	241+68
43+32	56+64	27+13	49+06	18+61	43+32		
69+97	76+12	61+91	68+86	49+06	198+55		
198+55	214+91	191+50	207+47	207+47	241+68		
TOTAL = 4,692 LF		TOTAL = 6,346 LF		TOTAL = 5,540 LF		TOTAL = 47,361 FT	

PAVEMENT MILLING NON-BRIDGE			
2" MILLING SCHEDULE			
WIDTH	BEG. STA.	END STA.	DIR.
5 FT	159+65	160+15	WBL
5 FT	163+94	164+50	WBL
10 FT	194+50	196+00	WBL
3" MILLING SCHEDULE			
10 FT	220+03	218+10	WBL

HOT MIX SURFACE AND LEVELING BINDER	
MATERIAL PURPOSE	TONS
RESURFACING	5977
SIDERoadS, INTERSECTIONS, P.E. AND F.E	500
TOTAL	6477
CONVERSION FACTOR 115 LBS / SY / IN	

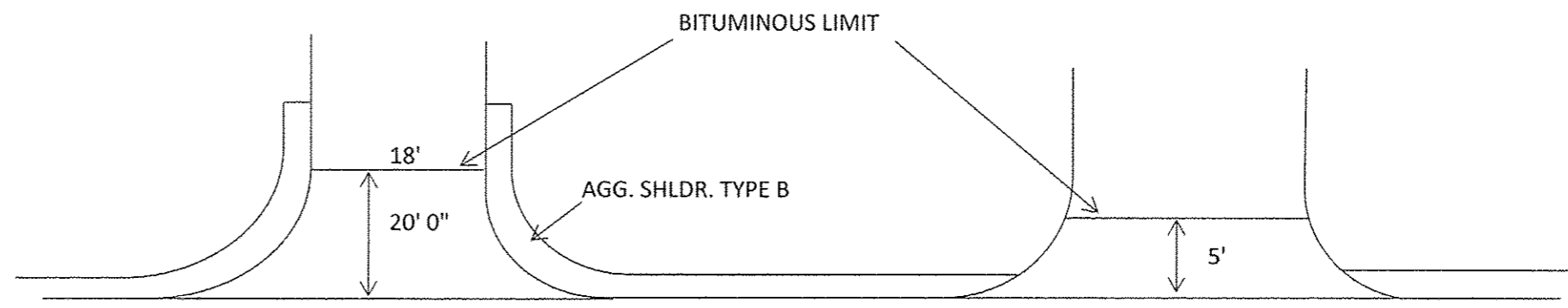

PROPOSED CROSS-SECTION 0+00 TO 114+00

DETAIL OF SIDE ROAD INTERSECTION (11 EACH)

DETAIL OF PRIVATE ENTRANCE

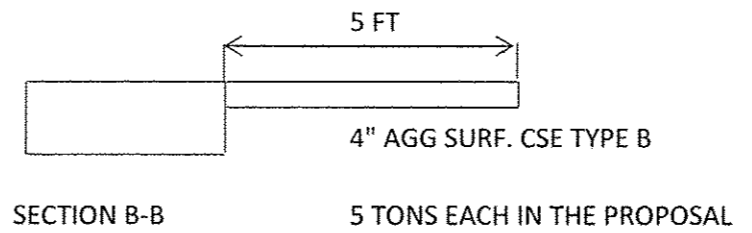
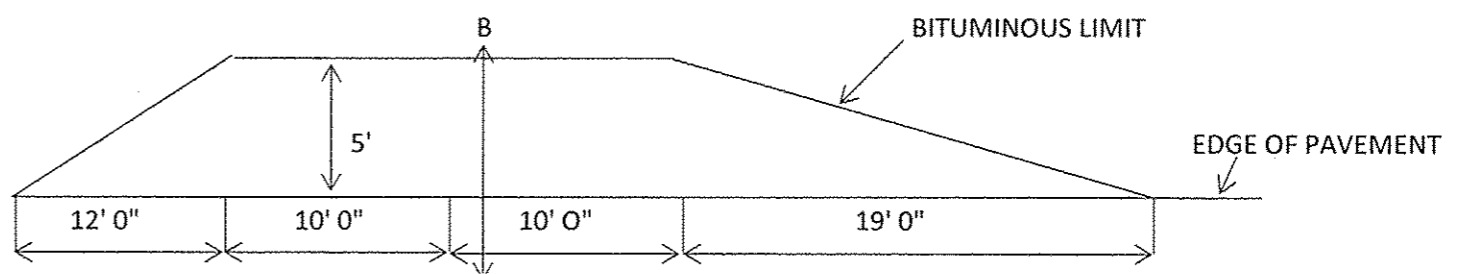
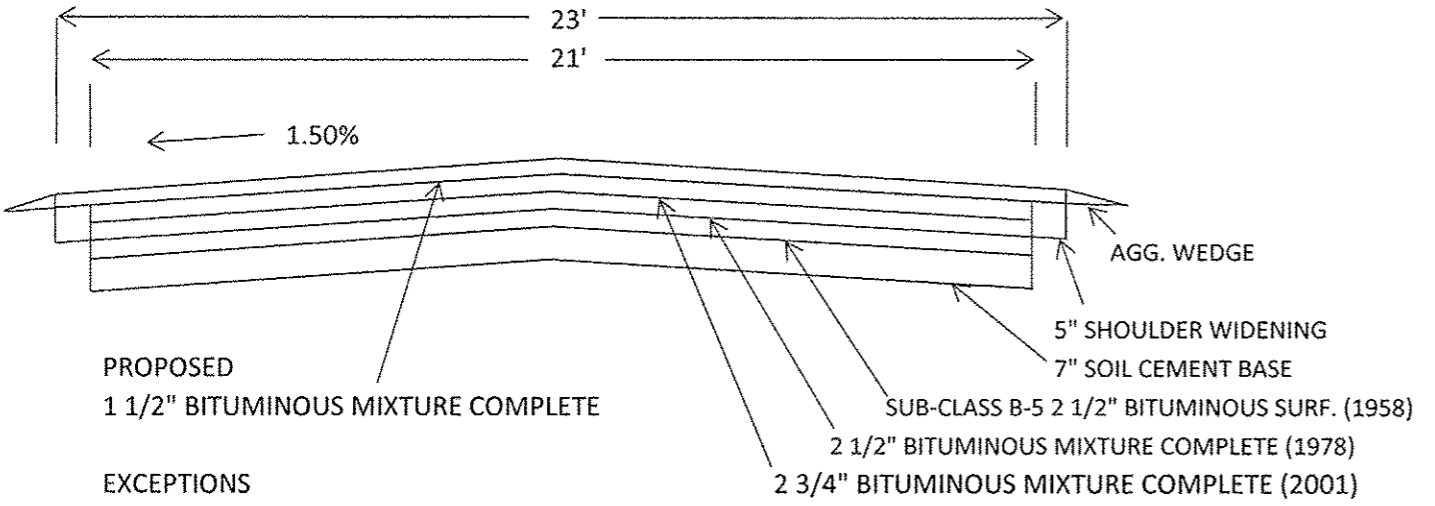

PROPOSED
1 1/2" BITUMINOUS MIXTURE COMPLETE

EXCEPTIONS
STR #041-0051 STATION 44+65 TO 47+20
STR #041-3630 STATION 112+02 TO 112+65

AGG. WEDGE

5" SHOULDER WIDENING

7" SOIL CEMENT BASE

SUB-CLASS B-5 2 1/2" BITUMINOUS SURF. (1958)

2 1/2" BITUMINOUS MIXTURE COMPLETE (1978)

2 3/4" BITUMINOUS MIXTURE COMPLETE (2001)

DETAIL OF MAILBOX TURNOUT

SECTION B-B 5 TONS EACH IN THE PROPOSAL

ROUTE	SECTION	COUNTY	TOT. SHEETS	SHEET
FAS 826	15-00212-00-RS	JEFFERSON	4	4
JEFFERSON COUNTY ROAD DISTRICT				

CONTRACT NO. 99569

