

STAGE 3
STA. ±315+61 TO STA. ±328+09

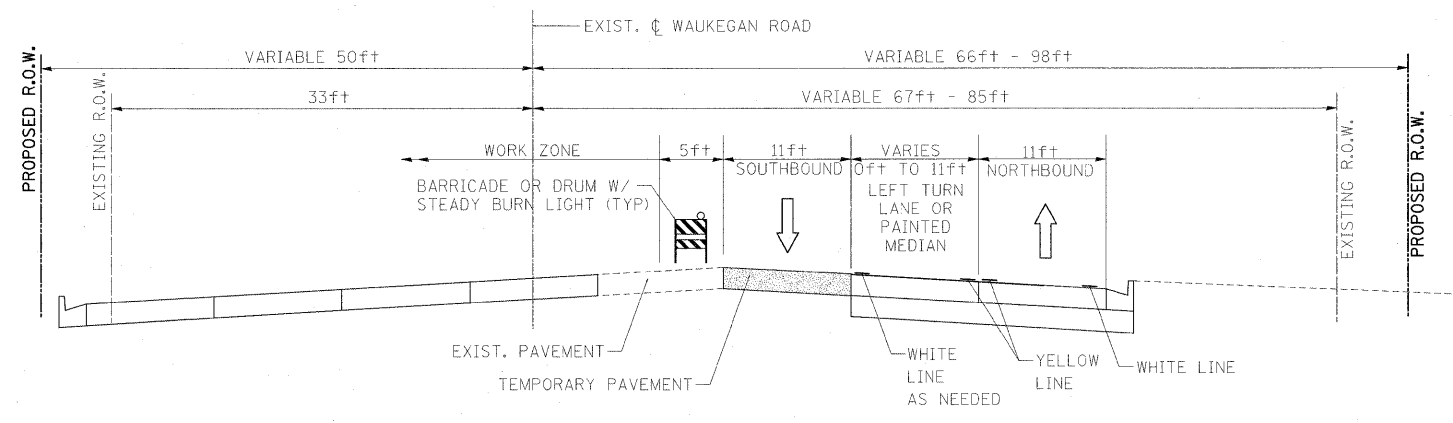

STAGE 3
STA. ±328+09 TO STA. ±334+56

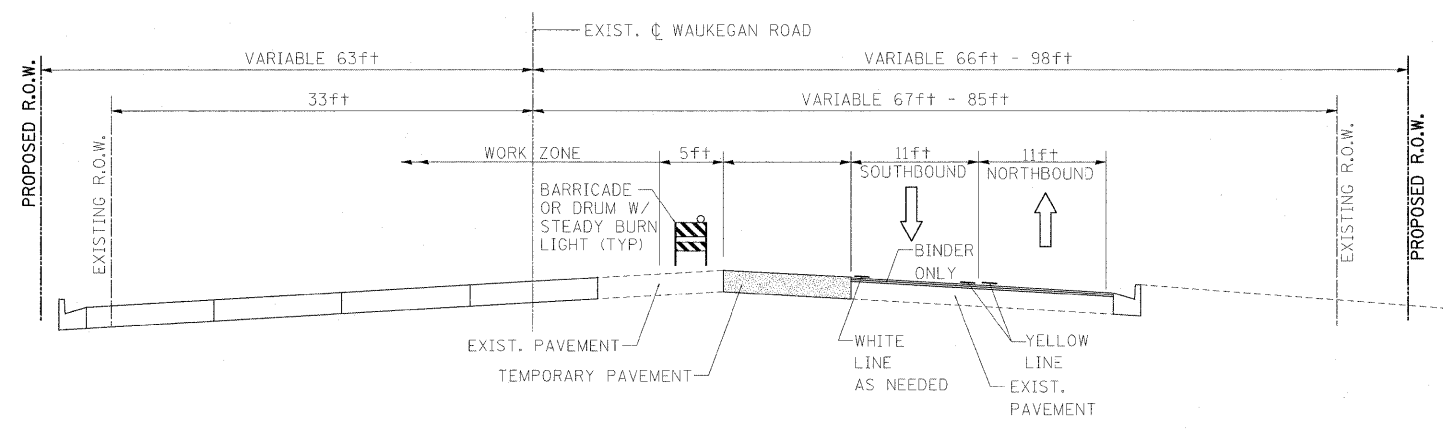

STAGE 3
STA. 315+61 TO STA. 324+36 (CURB AND GUTTER TO BE COMPLETED ON RIGHT SIDE)
STA. ±334+55 TO STA. ±337+53

FILE NAME =	USER NAME = #USER#
W:\ILRTE22\2009 REVISIONS\CADD Sheets\160860-sht-staging-tpicol.dgn	
PLOT SCALE = #SCALE#	
PLOT DATE = 5/15/2010	

DESIGNED - LP	REVISOR -
DRAWN - DC	REVISOR -
CHECKED - JP	REVISOR -
DATE - 05/14/2010	REVISOR -

DESIGNED - LP	REVISOR -
DRAWN - DC	REVISOR -
CHECKED - JP	REVISOR -
DATE - 05/14/2010	REVISOR -

**STATE OF ILLINOIS
DEPARTMENT OF TRANSPORTATION**

**WAUKEGAN ROAD
MAINTENANCE OF TRAFFIC TYPICAL SECTIONS, STAGE 3**

SCALE: NTS SHEET NO. 41 OF 232 SHEETS STA. TO STA.

F.A.P. RTE.	SECTION	COUNTY	TOTAL SHEETS	SHEET NO.
337	20R-4	LAKE	232	41
CONTRACT NO. 60860				
ILLINOIS FED. AID PROJECT				