



LEGEND:

- PROPOSED MANHOLE
- PROPOSED CATCH BASIN
- PROPOSED STORM SEWER
- ▶ PROPOSED FLARED END SECTION
- EXISTING MANHOLE
- EXISTING CATCH BASIN
- EXISTING INLET
- ▶ EXISTING FLARED END SECTION
- EXISTING STORM SEWER
- - - EXISTING PIPE CULVERT

PLAN	SURVEYED	DATE
	PLOTTED	
	NOTED	
	CHECKED	
	FILED	
	NO.	

PROFILE	SURVEYED	DATE
	PLOTTED	
	NOTED	
	CHECKED	
	FILED	
	NO.	

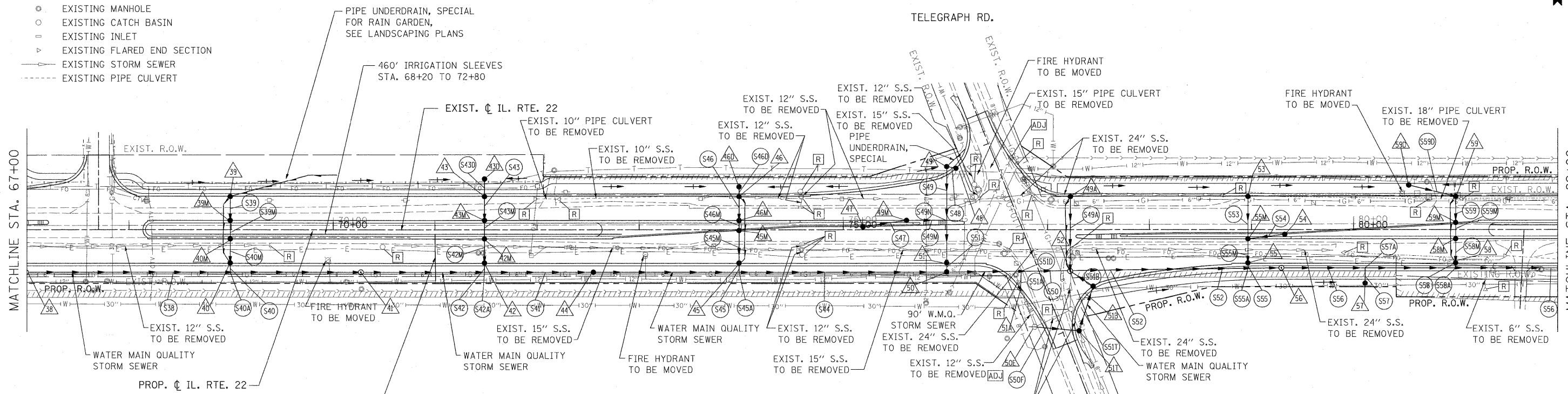

- △ PROPOSED STORM STRUCTURE
- PROPOSED STORM SEWER
- [R] EXISTING STRUCTURE TO BE REMOVED
- [AB] EXISTING STORM SEWER TO BE ABANDONED
- [ADJ] EXISTING STRUCTURE TO BE ADJUSTED
- [C] EXISTING STRUCTURE TO BE CLEANED

NOTE:
STORM WATER STRUCTURE OFFSET LOCATIONS GIVEN ON THE DETAILED PLANS ARE TO THE FOLLOWING POINTS: A) FOR STRUCTURES FALLING IN THE CURB LINE - TO THE EDGE OF PAVEMENT; B) FOR ALL OTHER STRUCTURE LOCATIONS - TO THE CENTER OF THE STRUCTURE.

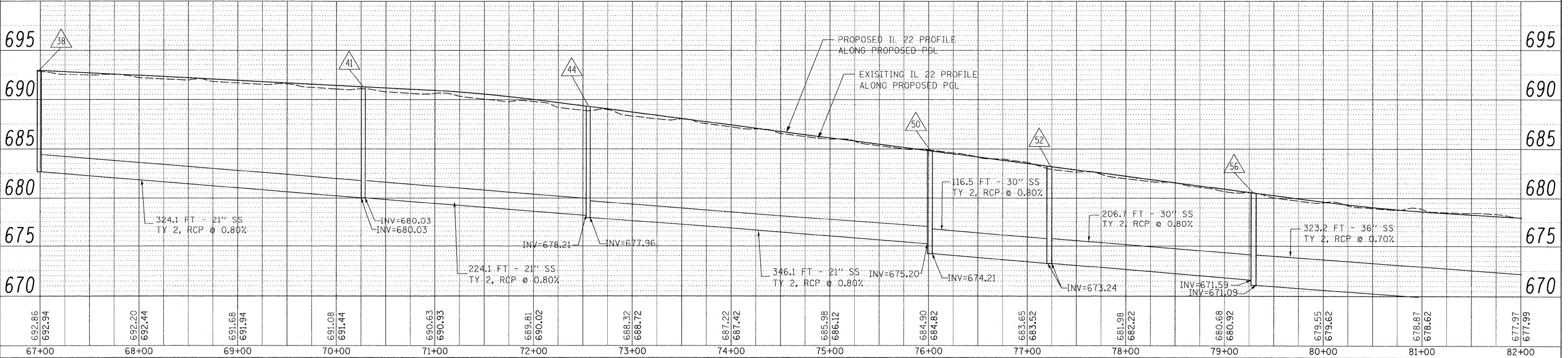

FILE NAME =	USER NAME = #USER#	DESIGNED - LP	REVISED -	STATE OF ILLINOIS DEPARTMENT OF TRANSPORTATION				IL ROUTE 22 DRAINAGE PLAN AND PROFILE				F.A.P. RTE.	SECTION	COUNTY	TOTAL SHEETS	SHEET NO.			
W:\ILRTE22\2009 REVISIONS\CADD Sheets\08060-shr-drain.dgn	08060-shr-drain.dgn	DRAWN - MC	REVISED -									337	20R-4	LAKE	232	94			
PLOT SCALE = #SCALE#		CHECKED - JP	REVISED -	SCALE: 1"=50'				SHEET NO. 94 OF 232 SHEETS				STA. 67+00 TO STA. 82+00				CONTRACT NO. 60860			
PLOT DATE = 5/15/2010		DATE - 05/14/2010	REVISED -																