

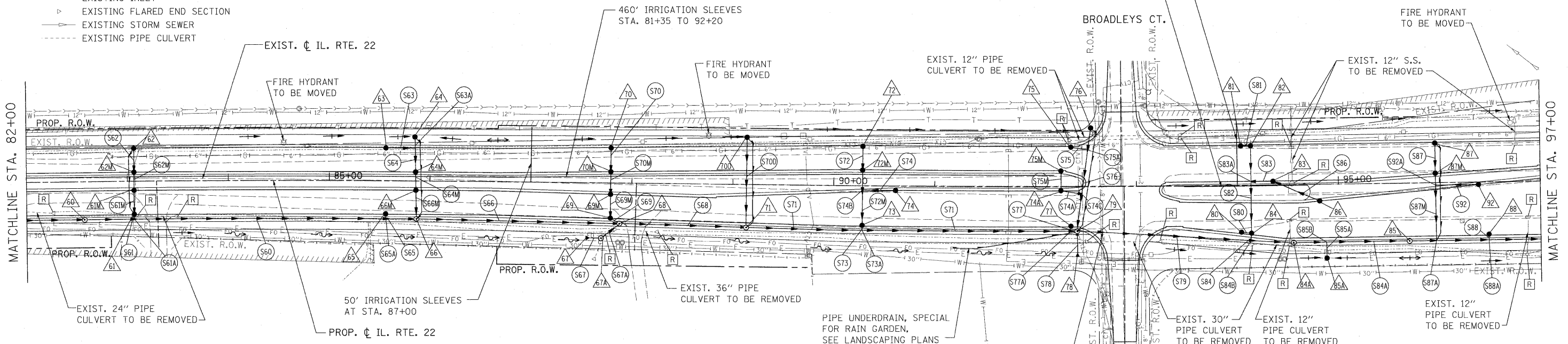

- LEGEND:**
- PROPOSED MANHOLE
 - PROPOSED CATCH BASIN
 - PROPOSED STORM SEWER
 - ▶ PROPOSED FLARED END SECTION
 - EXISTING MANHOLE
 - EXISTING CATCH BASIN
 - EXISTING INLET
 - ▶ EXISTING FLARED END SECTION
 - EXISTING STORM SEWER
 - - - EXISTING PIPE CULVERT



- △ PROPOSED STORM STRUCTURE
- PROPOSED STORM SEWER
- R EXISTING STRUCTURE TO BE REMOVED
- AB EXISTING STORM SEWER TO BE ABANDONED
- ADJ EXISTING STRUCTURE TO BE ADJUSTED
- C EXISTING STRUCTURE TO BE CLEANED

RELOCATE WATER VALVE AND LOWER WM
 B/STM=662.15 T/WM=660.65
 4-45° BENDS

30' of WATER MAIN QUALITY STORM SEWER SANITARY SEWER INFORMATION UNAVAILABLE, CONTRACTOR TO FIELD VERIFY

NOTE:
 STORM WATER STRUCTURE OFFSET LOCATIONS GIVEN ON THE DETAILED PLANS ARE TO THE FOLLOWING POINTS: A) FOR STRUCTURES FALLING IN THE CURB LINE - TO THE EDGE OF PAVEMENT; B) FOR ALL OTHER STRUCTURE LOCATIONS - TO THE CENTER OF THE STRUCTURE.

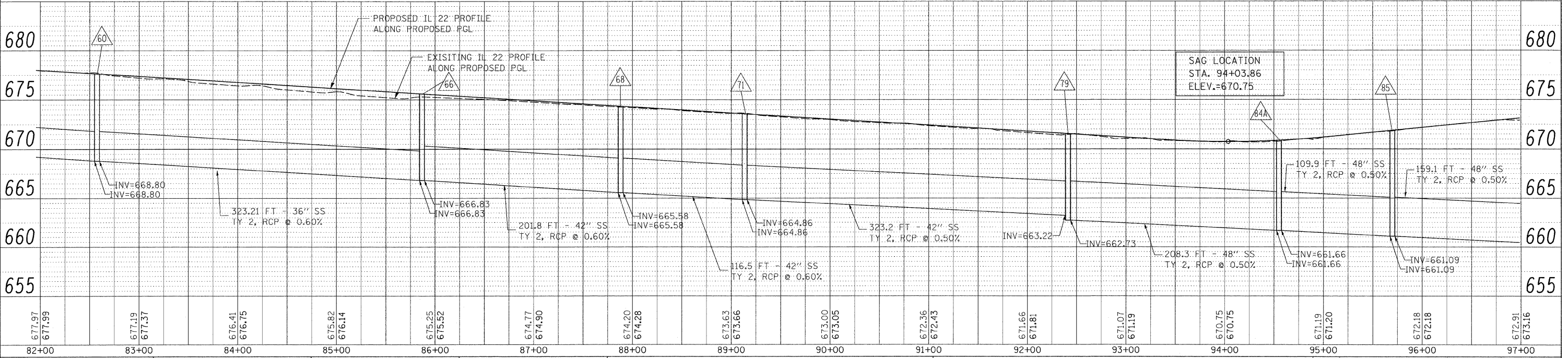

PLAN	SURVEYED	DATE
	PLOTTED	
	NOTE BOOK	
	NO. _____	

PROFILE	SURVEYED	DATE
	PLOTTED	
	NOTE BOOK	
	NO. _____	

FILE NAME = W:\ILRTE22\2009 REVISIONS\CADD Sheets\DR	USER NAME = #USER#	DESIGNED - LP	REVISED -	STATE OF ILLINOIS DEPARTMENT OF TRANSPORTATION		IL. ROUTE 22 DRAINAGE PLAN AND PROFILE		F.A.P. RTE. 337	SECTION 20R-4	COUNTY LAKE	TOTAL SHEETS 232	SHEET NO. 95
PLOT SCALE = #SCALE#	CHECKED - JP	DATE - 05/14/2010	REVISED -					SCALE: 1"=50'		SHEET NO. 95 OF 232 SHEETS		STA. 82+00 TO STA. 97+00