

THE TRAFFIC SIGNAL CONTROL EQUIPMENT FOR THIS PROJECT SHALL BE "ECONOLITE" TO MATCH THE EXISTING ADJACENT SYSTEM.

RESTORATION OF WORK AREA, RESTORATION OF THE TRAFFIC SIGNAL WORK AREA SHALL BE INCIDENTAL TO THE RELATED PAY ITEM SUCH AS FOUNDATION, CONDUIT, HANDHOLE, TRENCH AND BACKFILL, ETC., AND NO EXTRA COMPENSATION SHALL BE ALLOWED. ALL ROADWAY SURFACES SUCH AS SHOULDERS, MEDIANS, SIDEWALKS, PAVEMENT, ETC. SHALL BE REPLACED IN KIND. ALL DAMAGE TO MOWED LAWNS SHALL BE REPLACED WITH AN APPROVED SOD, AND ALL DAMAGE TO UNMOWED FIELDS SHALL BE SEEDED IN ACCORDANCE WITH STANDARD SPECIFICATIONS 252 AND 250 RESPECTIVELY.

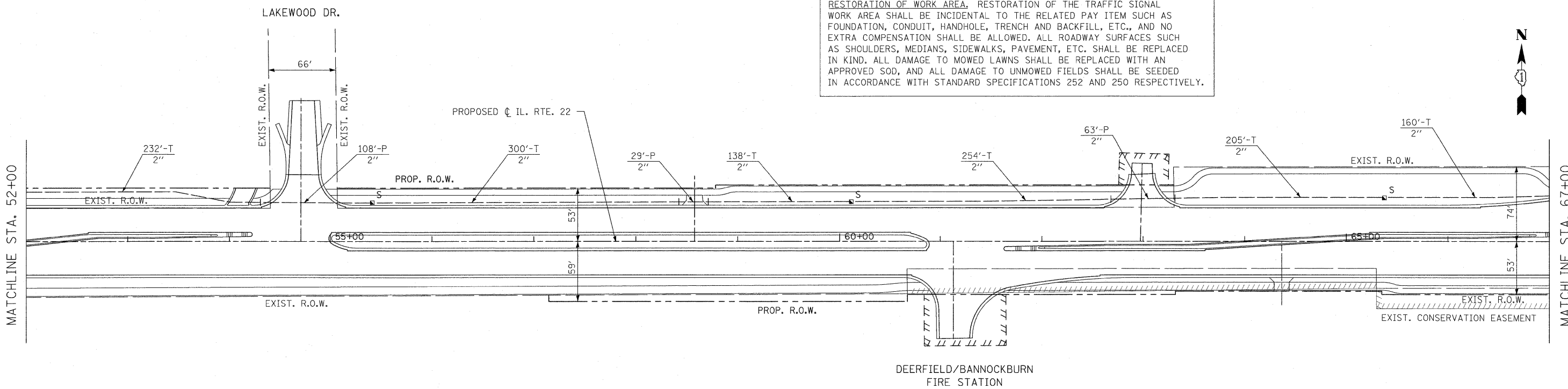

FILE NAME = W:\ILRTE22\2009 REVISIONS\CADD Sheets\160860-sh1-ta-INTER.dgn  
 USER NAME = #USER#  
 PLOT SCALE = #SCALE#  
 PLOT DATE = 5/15/2010

DESIGNED - LP  
 DRAWN - DC  
 CHECKED - JP  
 DATE - 05/14/2010

REVISED -  
 REVISED -  
 REVISED -  
 REVISED -

STATE OF ILLINOIS  
 DEPARTMENT OF TRANSPORTATION

IL. ROUTE 22  
 INTERCONNECT PLAN (1 OF 6)

SCALE: 1"=50'  
 SHEET NO. 164 OF 232 SHEETS  
 STA. 45+50.89 TO STA. 67+00.00

F.A.P. RTE.	SECTION	COUNTY	TOTAL SHEETS	SHEET NO.
337	20R-4	LAKE	232	164
			CONTRACT NO. 60860	
ILLINOIS FED. AID PROJECT				