

NOTE:  
THE COMPLETE REMOVAL OF EXISTING WOODEN PILES BENEATH THE EXISTING APPROACH SLABS WHICH CONFLICT WITH THE PROPOSED WORK SHALL NOT BE PAID FOR SEPERATELY BUT SHALL BE INCLUDED IN THE CONTRACT UNIT PRICE FOR STRUCTURE EXCAVATION.

PLAN	DATE
SURVEYED	BY
ALIGNED	BY
CHECKED	BY
RT. OF WAY CHECKED	BY
NO.	NO.
NO.	NO.
NO.	NO.
NO.	NO.

PROFILE	DATE
SURVEYED	BY
GRADES CHECKED	BY
NO.	NO.
NO.	NO.
NO.	NO.
NO.	NO.

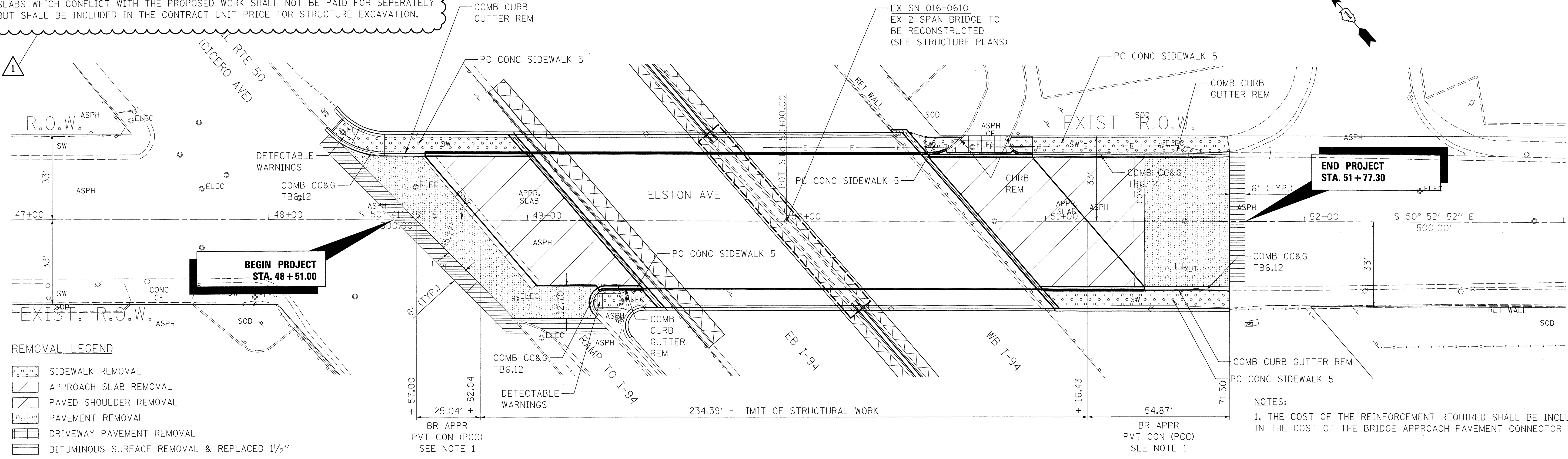

- REMOVAL LEGEND
- SIDEWALK REMOVAL
  - APPROACH SLAB REMOVAL
  - PAVED SHOULDER REMOVAL
  - PAVEMENT REMOVAL
  - DRIVEWAY PAVEMENT REMOVAL
  - BITUMINOUS SURFACE REMOVAL & REPLACED 1 1/2"

NOTES:  
1. THE COST OF THE REINFORCEMENT REQUIRED SHALL BE INCLUDED IN THE COST OF THE BRIDGE APPROACH PAVEMENT CONNECTOR (PCC).



FILE NAME =	USER NAME = #USER#	DESIGNED -	REVISED -	<b>STATE OF ILLINOIS DEPARTMENT OF TRANSPORTATION</b>	<b>PLAN AND PROFILE ELSTON AVE</b>				F.A.I. RTE. 94	SECTION 0101.8B	COUNTY COOK	TOTAL SHEETS 139	SHEET NO. 16
#FILE#		DRAWN -	REVISED -		SCALE: 1:20	SHEET NO. 1 OF 1 SHEETS	STA.	TO STA.	ILLINOIS FED. AID PROJECT				
		CHECKED -	REVISED -										
		DATE -	REVISED -										