

SIGNAL CONSTRUCTION SEQUENCE

1. INSTALL TEMPORARY WOOD POLES, SPAN & TETHER WIRE SIGNAL HEADS, AND ELECTRIC CABLE.
2. TURN OFF SIGNAL, CONNECT TEMPORARY SPAN WIRE CABLE TO SIGNAL JUNCTION BOXES ON THE NORTH EAST AND SOUTH WEST LIGHT POLES. DISCONNECT & REMOVE SIGNAL CABLE FROM THE SOUTHEAST AND NORTHWEST JUNCTION BOXES, PULL CABLE INTO ADJACENT MANHOLES AND STORE FOR FUTURE REINSTALLATION. PLACE TEMPORARY SIGNALS INTO OPERATION WITH MODIFIED SEQUENCE OF OPERATION & SIGNAL TIMING. REMOVE LIGHT POLE, BRACKET ARM LUMINAIRE, MAST ARM, TRAFFIC & PEDESTRIAN SIGNAL IN THE SOUTHEAST QUADRANT AND BAG OR REMOVE THE ALL OF THE SAME ON THE NORTHWEST QUADRANT AS DIRECTED BY THE ENGINEER. STORE REMOVED ITEMS FOR FUTURE REINSTALLATION.
3. ADJUST MANHOLE FRAMES & LIDS AS REQUIRED TO MEET PROPOSED IMPROVEMENTS. INSTALL NEW FOUNDATION FOR THE SOUTHEAST LIGHT POLE AND MAST ARM.
4. REINSTALL LIGHT POLES, BRACKET ARMS, LUMINAIRE, MAST ARMS, TRAFFIC AND PEDESTRIAN SIGNALS ON THE PRESERVED OR NEW CONCRETE FOUNDATIONS IN THE NORTHWEST AND SOUTHEAST QUADRANTS.
5. TURN OFF TEMPORARY SIGNAL, DISCONNECT TEMPORARY SPAN WIRE ELECTRIC CABLE. RECONNECT ORIGINAL ELECTRIC CABLE STORED IN MANHOLES TO ORIGINAL LIGHTING & SIGNAL EQUIPMENT ON LIGHT POLES IN THE NORTHWEST AND SOUTHEAST QUADRANTS. PLACE ORIGINAL SIGNAL SYSTEM BACK INTO OPERATION, WITH ORIGINAL SEQUENCE OF OPERATION AND SIGNAL TIMING.
6. REMOVE ALL TEMPORARY SIGNAL EQUIPMENT. INCLUDING TEMPORARY WOOD POLES, SPAN & TETHER WIRE, TEMPORARY ELECTRIC CABLE AND APPURTENANCES.

THIS CONSTRUCTION SEQUENCE SHALL NOT BE MODIFIED WITHOUT THE PRIOR APPROVAL OF THE ENGINEER.

TO BE BAGGED AND LEFT IN PLACE OR REMOVE AND REINSTALL POLE, MAST ARM, SIGNALS, AND PEDESTRIAN EQUIPMENT.

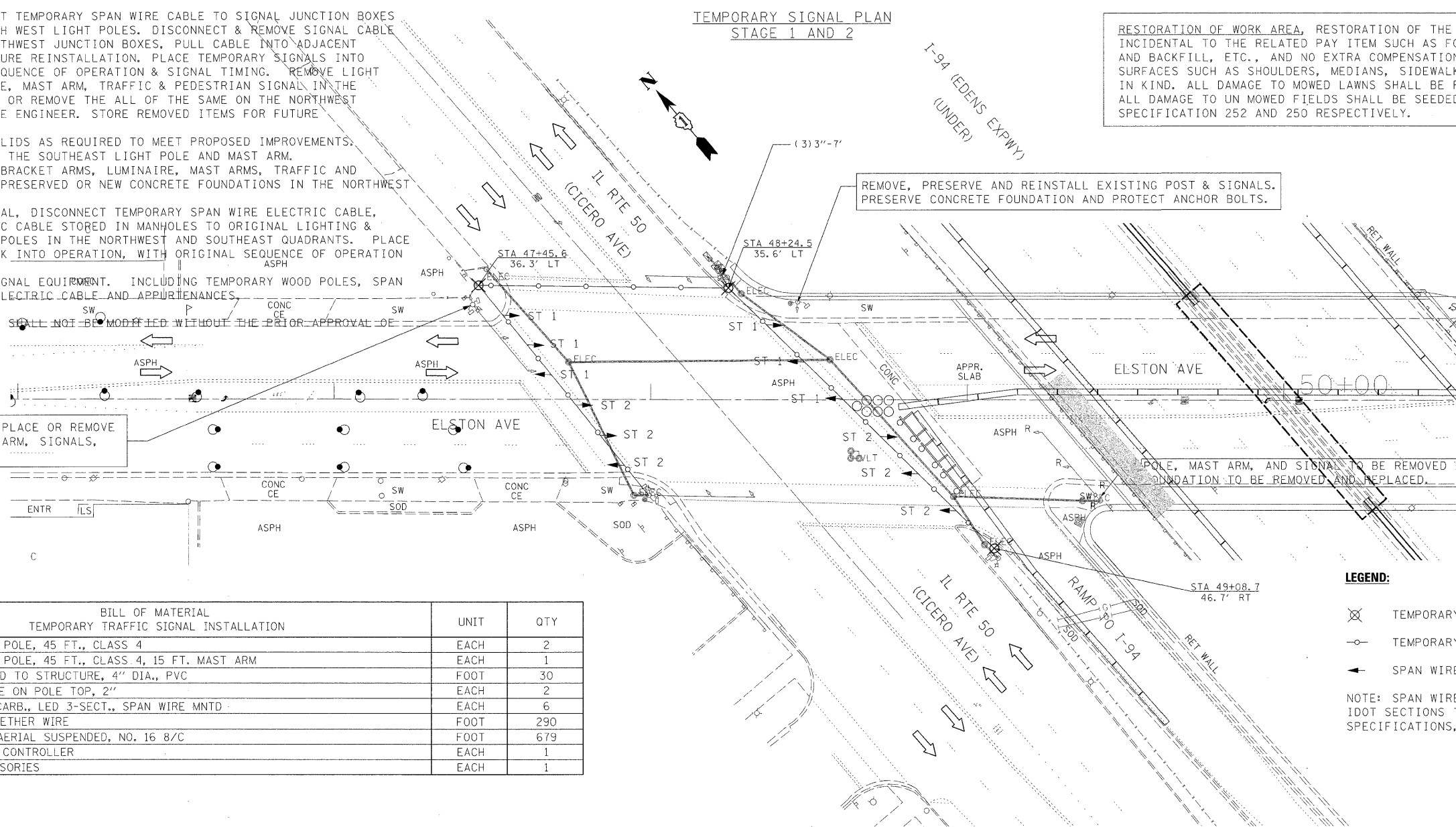

RESTORATION OF WORK AREA, RESTORATION OF THE TRAFFIC SIGNAL WORK AREA SHALL BE INCIDENTAL TO THE RELATED PAY ITEM SUCH AS FOUNDATION, CONDUIT, HANDHOLE, TRENCH AND BACKFILL, ETC., AND NO EXTRA COMPENSATION SHALL BE ALLOWED. ALL ROADWAY SURFACES SUCH AS SHOULDERS, MEDIANS, SIDEWALKS, PAVEMENT, ETC. SHALL BE REPLACED IN KIND. ALL DAMAGE TO MOWED LAWNS SHALL BE REPLACED WITH AN APPROVED SOD, AND ALL DAMAGE TO UN MOWED FIELDS SHALL BE SEEDED IN ACCORDANCE WITH STANDARD SPECIFICATION 252 AND 250 RESPECTIVELY.

BILL OF MATERIAL TEMPORARY TRAFFIC SIGNAL INSTALLATION		UNIT	QTY
TEMPORARY WOOD POLE, 45 FT., CLASS 4	EACH	2	
TEMPORARY WOOD POLE, 45 FT., CLASS 4, 15 FT. MAST ARM	EACH	1	
CONDUIT ATTACHED TO STRUCTURE, 4" DIA., PVC	FOOT	30	
SERVICE ENTRANCE ON POLE TOP, 2"	EACH	2	
SIGNAL HD, POLYCARB., LED 3-SECT., SPAN WIRE MNTD	EACH	6	
SPAN WIRE AND TETHER WIRE	FOOT	290	
HARNESS CABLE, AERIAL SUSPENDED, NO. 16 8/C	FOOT	679	
MODIFY EXISTING CONTROLLER	EACH	1	
SPAN WIRE ACCESSORIES	EACH	1	

LEGEND:

- ⊗ TEMPORARY WOOD POLE, CLASS 4, 45' MIN.
- TEMPORARY SPAN & TETHER WIRE
- ← SPAN WIRE MOUNTED SIGNAL HEAD

NOTE: SPAN WIRE INSTALLATION SHALL CONFORM TO IDOT SECTIONS 780, 872, AND 1077.04 OF THE STANDARD SPECIFICATIONS, AND AND HIGHWAY STANDARD 880001.

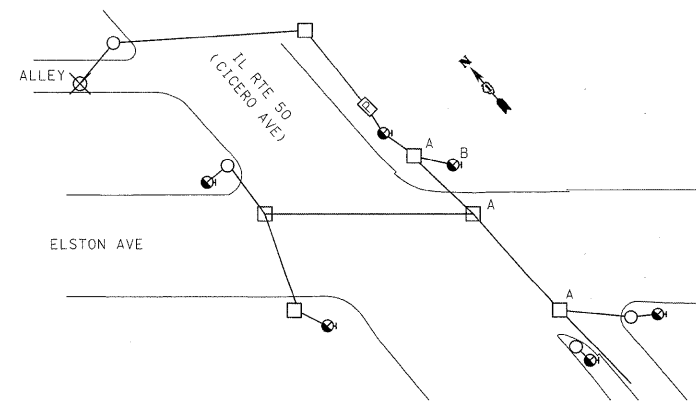

FOUNDATION REMOVAL PLAN
NOT TO SCALE

REMOVAL NOTES:

- A - ADJUST EXISTING MANHOLE FRAME & LID
- B - PRESERVE EXISTING CONCRETE FOUNDATION AND PROTECT ANCHOR BOLTS
- C - REMOVE EXISTING MAST ARM ASSEMBLY
- D - REMOVE EXISTING SIGNAL HEADS
- E - REMOVE EXISTING PEDESTRIAN HEADS
- F - COVER AND DE-ENERGIZE WB SIGNAL HEAD DURING CONSTRUCTION (AS DETERMINED BY ENGINEER)
- G - COVER AND DE-ENERGIZE SB TURN ARROWS DURING CONSTRUCTION
- H - PULL ELECTRICAL CABLE BACK TO MANHOLE, DE-ENERGIZE, STORE
- J - COVER AND DE-ENERGIZE PEDESTRIAN SIGNAL HEAD
- ITEMS C, D, E: REMOVE AND STORE FOR REINSTALLATION

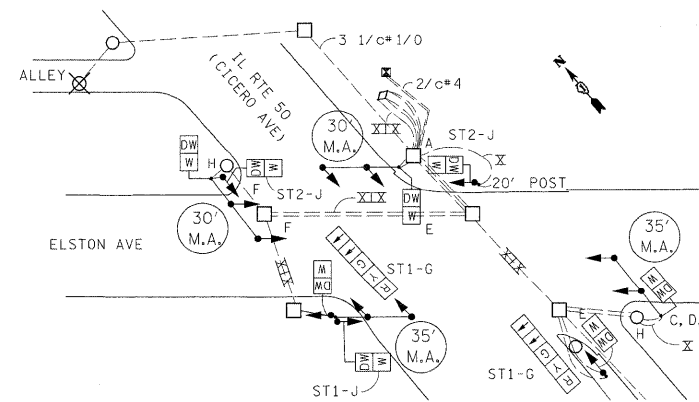

SIGNAL AND CABLE REMOVAL PLAN
NOT TO SCALE

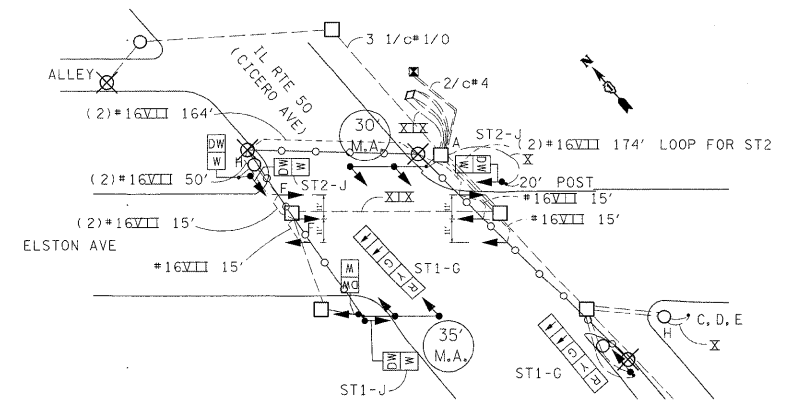

SIGNAL AND CABLE PLAN