

\$PENTBL\$

\$PLTDV\$

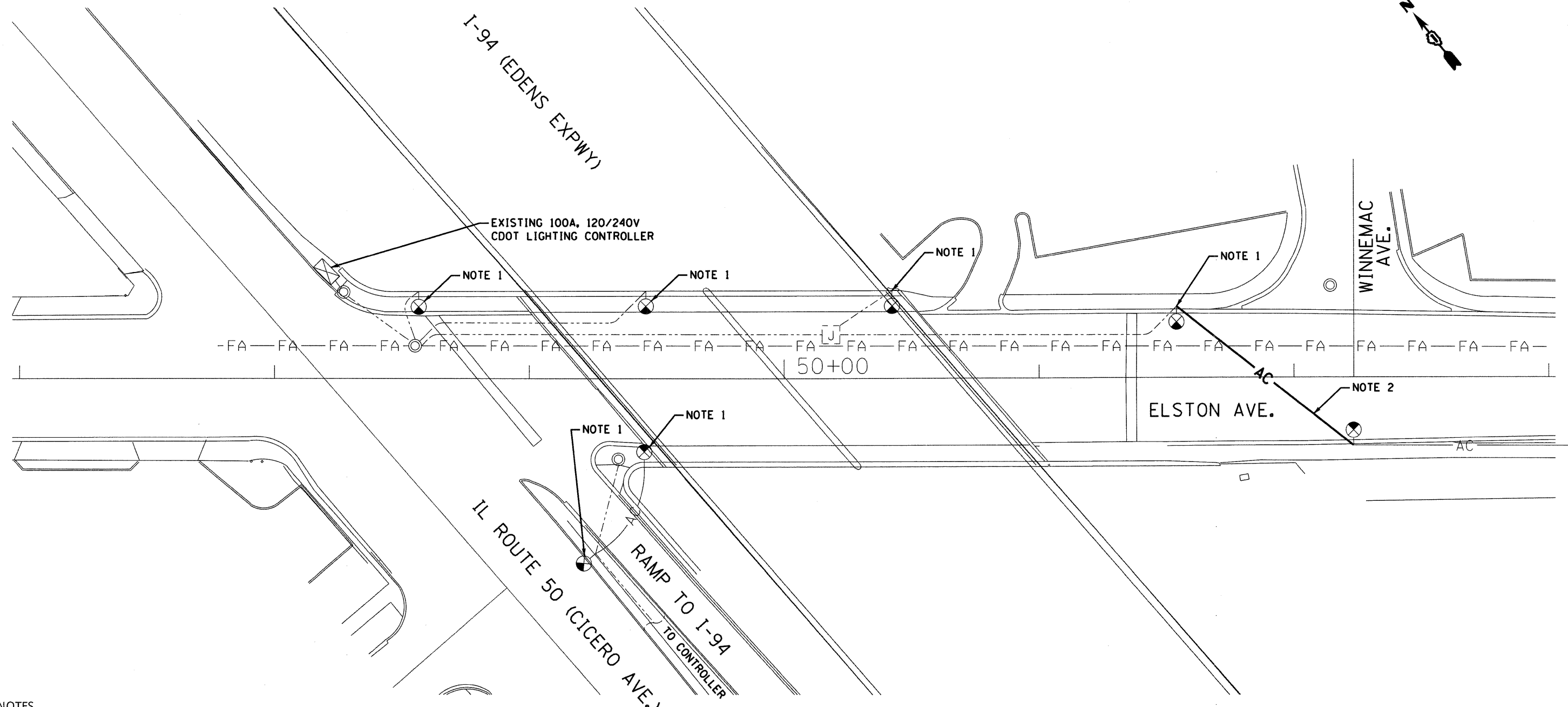

NOTES

- 1. EXISTING LIGHT UNITS TO REMAIN IN SERVICE FOR TEMPORARY LIGHTING DURING STAGE 1 CONSTRUCTION.
- 2. INSTALL 3-1/C #2 AERIAL CABLE WITH MESSENGER WIRE.

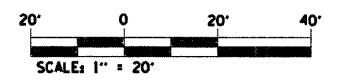

E-5

FILE NAME = #FILES#
 PLOT DATE = #DATE#

SPAAN Tech, Inc.
 311 S. Wacker Drive, Suite 2400
 Chicago, Illinois 60606
 phone: 312-277-8800
 fax: 312-277-8808
 web: www.SpaanTech.com

DESIGNED	I. A. B.	REVISED	-
DRAWN	R. B. G.	REVISED	-
CHECKED	A. D. O.	REVISED	-
DATE	MAY 2010	REVISED	-

**STATE OF ILLINOIS
 DEPARTMENT OF TRANSPORTATION**

**TEMPORARY LIGHTING PLAN STAGE 1 - CDOT
 ELSTON AVENUE OVER I-94**
 SCALE: 1" = 20' SHEET NO. OF SHEETS STA. TO STA.

F.A.J. RTE.	SECTION	COUNTY	TOTAL SHEETS	SHEET NO.
94	0101.8B	COOK	139	55
FED. ROAD DIST. NO. - ILLINOIS FED. AID PROJECT			CONTRACT NO. 60C18	